

FOR KCC USE:  
 EFFECTIVE DATE: 3-12-00  
 DISTRICT # 1  
 SGA  Yes  No

FORM C-1 7/91  
 FORM MUST BE TYPED  
 FORM MUST BE SIGNED  
 ALL BLANKS MUST BE FILLED

State of Kansas  
 NOTICE OF INTENTION TO DRILL

Must be approved by the K.C.C. five (5) days prior to commencing well

Expected Spud Date 3 20 2000  
 Month day year  
 Spot 165' S - SW - NW Sec 15 - Twp 33S, Rg. 12

East  
 West

.....2145..... feet from ~~South~~ North Line of Section  
 .....330..... feet from East / ~~West~~ Line of Section

OPERATOR: LICENSE # 6484  
 Name: ANDERSON ENERGY, INC.  
 Address: 1305 E. WATERMAN, STE A  
 City/State/Zip: WICHITA, KANSAS 67211  
 Contact Person: THORNTON ANDERSON  
 Phone: 316-265-7929

IS SECTION  REGULAR  IRREGULAR?  
 (Note: Locate well on the Section Plat on Reverse Side)  
 County: BARBER

CONTRACTOR: License # 5929  
 Name: DUKE DRILLING COMPANY

Lease Name: MAGNISON-PROTHE Well # 1-15  
 Field Name: BOGGS

Well Drilled For:	Well Class:	Type Equipment:
<input checked="" type="checkbox"/> Oil <input checked="" type="checkbox"/> Enh Rec	<input checked="" type="checkbox"/> Infield	<input checked="" type="checkbox"/> Mud Rotary
<input type="checkbox"/> Gas <input type="checkbox"/> Storage	<input type="checkbox"/> Pool Extension	<input type="checkbox"/> Air Rotary
<input type="checkbox"/> OWWO <input type="checkbox"/> Disposal	<input type="checkbox"/> Wildcat	<input type="checkbox"/> Cable
<input type="checkbox"/> Seismic: # of Holes	<input type="checkbox"/> Other	

Is this a Prorated / Spaced Field?  yes  no  
 Target Formation (s): SIMPSON  
 Nearest Lease or unit boundary: 330'  
 Ground Surface Elevation: 1500' EST. .... feet MSL

If OWWO: old well information as follows:  
 Operator: .....  
 Well Name: .....  
 Comp. Date: ..... Old Total Depth .....

Water well within one - quarter mile:  yes  no  
 Public water supply well within one mile:  yes  no  
 Depth to bottom of fresh water: 100  
 Depth to bottom of usable water: 100 180'

Directional, Deviated or Horizontal wellbore?  yes  no  
 If yes, true vertical depth: .....  
 Bottom Hole Location: .....

Surface Pipe by Alternate:  1  2  
 Length of Surface Pipe Planned to be set: 200'  
 Length of Conductor pipe required: NONE  
 Projected Total Depth: 5000  
 Formation at Total Depth: ARBUCKLE

Water Source for Drilling Operations: .....  
 Well  Farm Pond  other

DWR Permit #: .....  
 Will Cores Be Taken?:  yes  no  
 If yes, proposed zone: .....

**AFFIDAVIT**

The undersigned hereby affirms that the drilling, completion and eventual plugging of this well will comply with K.S.A. 55-101, et. seq.  
 It is agreed that the following minimum requirements will be met:

1. Notify the appropriate district office prior to spudding of well;
2. A copy of the approved notice of Intent to drill shall be posted on each drilling rig;
3. The minimum amount of surface pipe as specified below shall be set by circulating cement to the top; in all cases surface pipe shall be set through all unconsolidated materials plus a minimum of 20 feet into the underlying formation;
4. If the well is dry hole, an agreement between the operator and the district office on plug length and placement is necessary prior to plugging;
5. The appropriate district office will be notified before well is either plugged or production casing is cemented in;
6. IF AN ALTERNATE II COMPLETION, PRODUCTION PIPE SHALL BE CEMENTED FROM BELOW ANY USABLE WATER TO SURFACE WITHIN 120 DAYS OF SPUD DATE. IN ALL CASES, NOTIFY DISTRICT OFFICE PRIOR TO ANY CEMENTING.

I hereby certify that the statements made herein are true and to the best of my knowledge and belief.

Date: 3/3/00 Signature of Operator or Agent: [Signature] Title: President

FOR KCC USE:  
 API # 15-007-22615-0000  
 Conductor pipe required NONE feet  
 Minimum surface pipe required 200' feet per Alt  X  
 Approved by: D PW 3-7-2000  
 This authorization expires: 9-7-2000  
 (This authorization void if drilling not started within 6 months of effective date.)  
 Spud date: \_\_\_\_\_ Agent: \_\_\_\_\_

**REMEMBER TO:**

- File Drill Pit Application (form CDP - 1) with Intent to Drill;
- File Completion Form ACO -1 within 120 days of spud date;
- File acreage attribution plat according to field proration orders;
- Notify appropriate district office 48 hours prior to workover or re-entry;
- Submit plugging report (CP-4) after plugging is completed;
- Obtain written approval before disposing or injecting salt water.

Mall to: KCC - Conservation Division, 130 S. Market - Room 2078, Wichita, Kansas 67202.

15  
 33  
 12  
 RECEIVED  
 STATE CORPORATION COMMISSION  
 MAR 6 - 2000  
 CONSERVATION DIVISION  
 Wichita Kansas

**IN ALL CASES PLOT THE INTENDED WELL ON THE PLAT BELOW**

**PLAT OF ACREAGE ATTRIBUTABLE TO A WELL IN A PRORATED OR SPACED FIELD**

**If the intended well is in a prorated or spaced field, please fully complete this side of the form. If the intended well is in a prorated or spaced field complete the plat below showing that the well will be properly located in relationship to other wells producing from the common source of supply. Please show all the wells within 1 mile of the boundaries of the proposed acreage attribution unit for gas wells and within 1/2 mile of the boundaries of the proposed acreage attribution unit for oil wells.**

API NO. 15- \_\_\_\_\_  
 OPERATOR; ANDERSON ENERGY, INC.  
 LEASE MAGNISON-PROTHE  
 WELL NUMBER 1-15  
 FIELD BOGGS

LOCATION OF WELL: COUNTY BARBER  
 2145 feet from south/north line of section  
 330 feet from east/west line of section  
 SECTION 15 TWP 33 RG 12W

NUMBER OF ACRES ATTRIBUTABLE TO WELL 10  
 QTR/QTR/QTR OF ACREAGE SW - SW - NW

IS SECTION X REGULAR or \_\_\_\_\_ IRREGULAR  
 IF SECTION IS IRREGULAR, LOCATE WELL FROM NEAREST  
 CORNER BOUNDARY.

Section corner used: NW

**PLAT**

(Show location of the well and shade attributable acreage for prorated or spaced wells.)  
 (Show footage to the nearest lease or unit boundary line.)

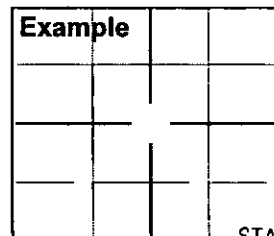
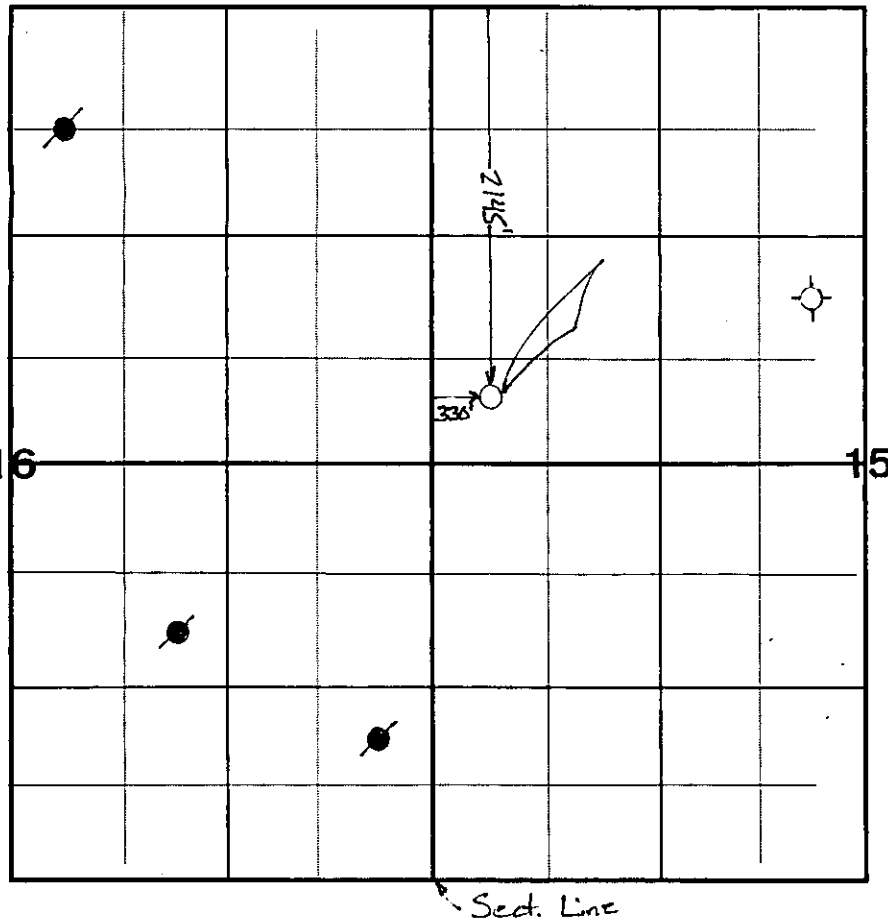

RECEIVED  
 STATE CORPORATION COMMISSION

SEWARD CO.

MAR 6 - 2000

CONSERVATION DIVISION  
 Wichita, Kansas

**In plotting the proposed location of the well, you must show:**

- The manner in which you are using the depicted plat by identifying section lines, i.e. 1 section, 1 section with 8 surrounding sections, 4 sections, etc.;**
- the distance of the proposed drilling location from the section's south/north and east/west; and**
- the distance to the nearest lease or unit boundary line.**