

EFFECTIVE DATE: 1-14-96
DISTRICT # 1
SGA Yes No

State of Kansas
NOTICE OF INTENTION TO DRILL

FORM MUST BE SIGNED
ALL BLANKS MUST BE FILLED

Must be approved by the K.C.C. five (5) days prior to commencing well

Expected Spud Date 1 24 96
Month day year

Spot C SE SE Sec 12 Twp 31 S, Rg 11 East
xx West
660 feet from South / North Line of Section

OPERATOR: LICENSE # 31532
Name: BISON PRODUCTION COMPANY
Address: 9320 E. CENTRAL
City/State/Zip: WICHITA, KANSAS 67206
Contact Person: C.J. LETT
Phone: 316-636-1801

660 feet from East / West Line of Section
IS SECTION xx REGULAR IRREGULAR?
(Note: Locate well on the Section Plat on Reverse Side)
County: Barber
Lease Name: Leibst Well #: 1-12
Field Name: Wildcat

CONTRACTOR: License #: 5929
Name: DUKE DRILLING COMPANY

Is this a Prorated / Spaced Field? yes x no
Target Formation (s): Mississippi
Nearest Lease or unit boundary: 660
Ground Surface Elevation: 1775 est. feet MSL
Water well within one - quarter mile: yes x no
Public water supply well within one mile: yes x no
Depth to bottom of fresh water: 150
Depth to bottom of usable water: 180 180
Surface Pipe by Alternate: x 1 2
Length of Surface Pipe Planned to be set: 250
Length of Conductor pipe required: 0
Projected Total Depth: 4550
Formation at Total Depth: Mississippi
Water Source for Drilling Operations: Well Farm Pond xx other

Well Drilled For: Well Class: Type Equipment:
Oil Enh Rec Infield x Mud Rotary
x Gas Storage Pool Extension Air Rotary
OWWO Disposal x Wildcat Cable
Seismic: # of Holes Other
Other

If OWWO: old well information as follows:
Operator:
Well Name:
Comp. Date: Old Total Depth

Directional, Deviated or Horizontal wellbore? yes x no
If yes, true vertical depth:
Bottom Hole Location:

AFFIDAVIT

The undersigned hereby affirms that the drilling, completion and eventual plugging of this well will comply with K.S.A. 55-101, et. seq. It is agreed that the following minimum requirements will be met:

1. Notify the appropriate district office prior to spudding of well;
2. A copy of the approved notice of intent to drill shall be posted on each drilling rig;
3. The minimum amount of surface pipe as specified below shall be set by circulating cement to the top; in all cases surface pipe shall be set through all unconsolidated materials plus a minimum of 20 feet into the underlying formation;
4. If the well is dry hole, an agreement between the operator and the district office on plug length and placement is necessary prior to plugging;
5. The appropriate district office will be notified before well is either plugged or production casing is cemented in;
6. IF AN ALTERNATE II COMPLETION, PRODUCTION PIPE SHALL BE CEMENTED FROM BELOW ANY USABLE WATER TO SURFACE WITHIN 120 DAYS OF SPUD DATE. IN ALL CASES, NOTIFY DISTRICT OFFICE PRIOR TO ANY CEMENTING.

I hereby certify that the statements made herein are true and to the best of my knowledge and belief.

Date January 5, 1996 Signature of Operator or Agent [Signature] Title President

FOR KCC USE:
API # 15- 007-224920000
Conductor pipe required NONE feet
Minimum surface pipe required 200 feet per Alt (1) X
Approved by: JK 1-9-96
This authorization expires: 7-9-96
(This authorization void if drilling not started within 6 months of effective date.)
Spud date: _____ Agent: _____

RECEIVED
STATE CORPORATION COMMISSION
JAN 08 1996
1-8-96
CONSERVATION DIVISION
WICHITA, KANSAS

REMEMBER TO:

- File Drill Pit Application (form CDP - 1) with Intent to Drill;
- File Completion Form ACO -1 within 120 days of spud date;
- File acreage attribution plat according to field proration orders;
- Notify appropriate district office 48 hours prior to workover or re-entry;
- Submit plugging report (CP-4) after plugging is completed;
- Obtain written approval before disposing or injecting salt water.

Mail to: KCC - Conservation Division, 130 S. Market - Room 2078, Wichita, Kansas 67202.

PLAT OF ACREAGE ATTRIBUTABLE TO A WELL IN A PRORATED OR SPACED FIELD

If the intended well is in a prorated or spaced field, please fully complete this side of the form. If the intended well is in a prorated or spaced field complete the plat below showing that the well will be properly located in relationship to other wells producing from the common source of supply. Please show all the wells within 1 mile of the boundaries of the proposed acreage attribution unit for gas wells and within 1/2 mile of the boundaries of the proposed acreage attribution unit for oil wells.

API NO. 15- _____
 OPERATOR BISON PRODUCTION COMPANY
 LEASE Leibst
 WELL NUMBER 1-12
 FIELD Wildcat

LOCATION OF WELL: COUNTY Barber
660' feet from south/north line of section
660' feet from east/west line of section
 SECTION 12 TWP 31S RG 11W

NUMBER OF ACRES ATTRIBUTABLE TO WELL 160
 QTR/QTR/QTR OF ACREAGE SE

IS SECTION x REGULAR or _____ IRREGULAR
IF SECTION IS IRREGULAR, LOCATE WELL FROM NEAREST CORNER BOUNDARY.

Section corner used: SE

PLAT

(Show location of the well and shade attributable acreage for prorated or spaced wells.)
 (Show footage to the nearest lease or unit boundary line.)

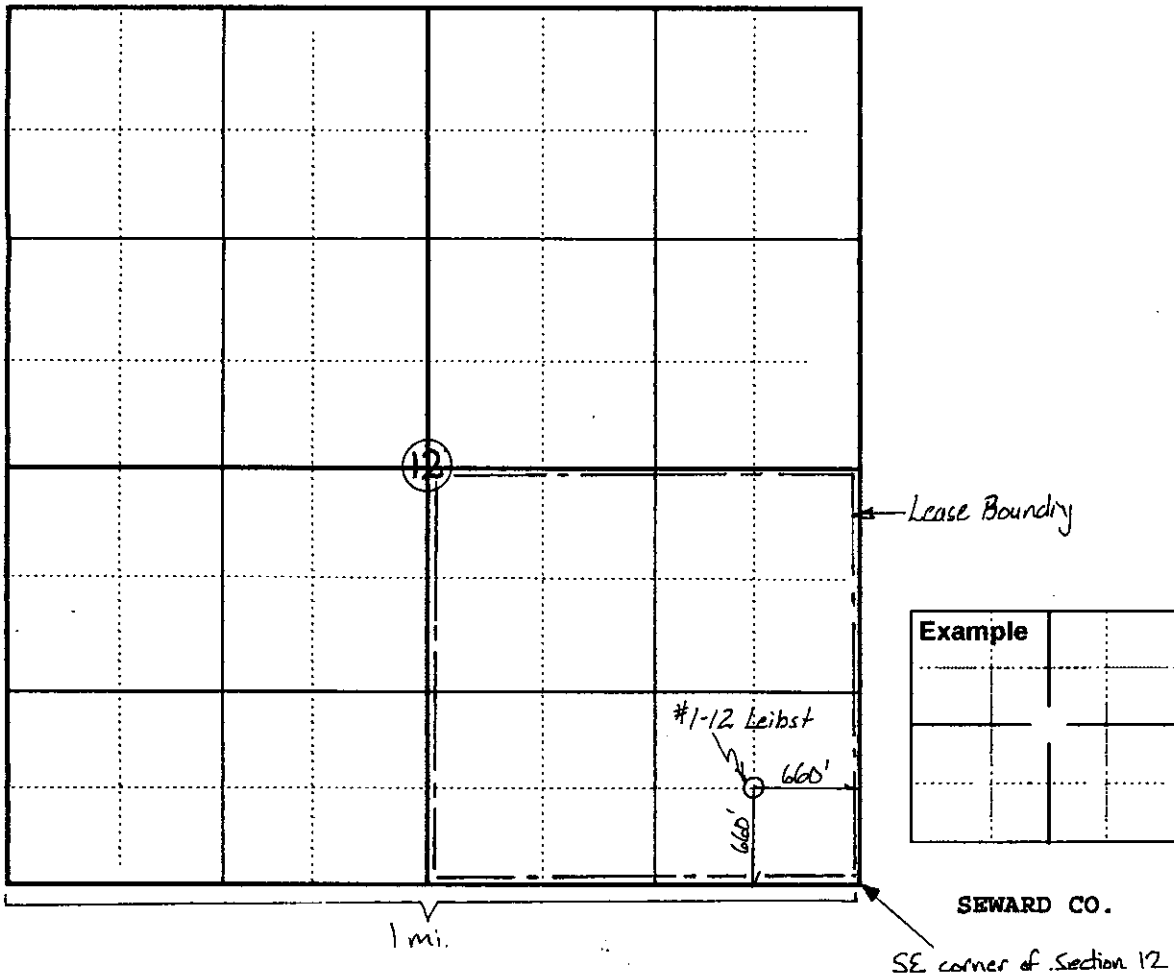

In plotting the proposed location of the well, you must show:

- 1) The manner in which you are using the depicted plat by identifying section lines, i.e. 1 section, 1 section with 8 surrounding sections, 4 sections, etc.;
- 2) the distance of the proposed drilling location from the section's south/north and east/west; and
- 3) the distance to the nearest lease or unit boundary line.