

FOR KCC USE:

COR

FORM C-1 7/91

EFFECTIVE DATE: 11-4-95

FORM MUST BE TYPED

DISTRICT # _____

State of Kansas

FORM MUST BE SIGNED

SGA? Yes No

NOTICE OF INTENTION TO DRILL

ALL BLANKS MUST BE FILLED

Must be approved by the K.C.C. five (5) days prior to commencing well.

Expected Spud Date 11 07 95
month day year

Spot 5 1/2 NE SE Sec 36 Twp 19S, Rg 16 East West

OPERATOR: License # 5086
Name: Pintail Petroleum, Ltd.
Address: 225 N. Market, Ste. 300
City/State/Zip: Wichita, KS 67202
Contact Person: Innes Phillips
Phone: 316/263-2243

1650 feet from South / North line of Section
660 feet from East / West line of Section

IS SECTION X REGULAR _____ IRREGULAR?

(NOTE: Locate well on the Section Plat on Reverse Side)

County: Rush

Lease Name: Werhahn Well #: 1

Field Name: Wildcat

Is this a Prorated/Spaced Field? yes XX no

Target Formation(s): Arbuckle

Nearest lease or unit boundary: 660

Ground Surface Elevation: 1975 feet MSL

Water well within one-quarter mile: yes X no

Public water supply well within one mile: yes X no

Depth to bottom of fresh water: 180

Depth to bottom of usable water: 280

* Surface Pipe by Alternate: X 1 ... 2

* Length of Surface Pipe Planned to be set: 600

Length of Conductor pipe required: N/A

Projected Total Depth: 3900

Formation at Total Depth: Arbuckle

Water Source for Drilling Operations:

... well ... farm pond X other

CONTRACTOR: License #: 4958
Name: Mallard Joint Venture, Inc.

Well Drilled For: Well Class: Type Equipment:

XX Oil ... Enh Rec ... Infield XX Mud Rotary
... Gas ... Storage ... Pool Ext. ... Air Rotary
... OWO ... Disposal XX Wildcat ... Cable
... Seismic; ... # of Holes ... Other
... Other

If OWO: old well information as follows:

Operator: _____

Well Name: _____

Comp. Date: _____ Old Total Depth _____

Directional, Deviated or Horizontal wellbore? yes X no

If yes, true vertical depth: _____

Bottom Hole Location: _____

Will Cores Be Taken?: yes X no

If yes, proposed zone: _____

WAS: ALT II ; 1000' surf. casg to SET

AFFIDAVIT

IS: ALT 1 ; 600' surf. casg to SET

The undersigned hereby affirms that the drilling, completion and eventual plugging of this well will comply with K.S.A. 55-101, et. seq.

It is agreed that the following minimum requirements will be met:

1. Notify the appropriate district office prior to spudding of well;
2. A copy of the approved notice of intent to drill shall be posted on each drilling rig;
3. The minimum amount of surface pipe as specified below shall be set by circulating cement to the top; in all cases surface pipe shall be set through all unconsolidated materials plus a minimum of 20 feet into the underlying formation;
4. If the well is dry hole, an agreement between the operator and the district office on plug length and placement is necessary prior to plugging;
5. The appropriate district office will be notified before well is either plugged or production casing is cemented in;
6. IF AN ALTERNATE II COMPLETION, PRODUCTION PIPE SHALL BE CEMENTED FROM BELOW ANY USABLE WATER TO SURFACE WITHIN 120 DAYS OF SPUD DATE. IN ALL CASES, NOTIFY DISTRICT OFFICE PRIOR TO ANY CEMENTING.

I hereby certify that the statements made herein are true and to the best of my knowledge and belief.

Date: 11/14/95 Signature of Operator or Agent: Best A. Olsen Title: Geologist

FOR KCC USE:
 API # 15- 165-21684 0000
 Conductor pipe required NONE feet
 Minimum surface pipe required 300 feet per Alt. 1 X
 Approved by: DPW 11-15-95; ORIG JK 10-30-95
 This authorization expires: 4-30-96
 (This authorization void if drilling not started within 6 months of effective date.)
 Spud date: _____ Agent: _____

REMEMBER TO:

- File Drill Pit Application (form CDP-1) with Intent to Drill;
- File Completion Form ACO-1 within 120 days of spud date;
- File acreage attribution plat according to field proration orders;
- Notify appropriate district office 48 hours prior to workover or re-entry;
- Submit plugging report (CP-4) after plugging is completed;
- Obtain written approval before disposing or injecting salt water.

Mail to: KCC - Conservation Division, 130 S. Market - Room 2078, Wichita, Kansas 67202.

RECEIVED
STATE CORPORATION COMMISSION
NOV 15 1995
11-15-95
CONSERVATION DIVISION
Wichita, Kansas

36
19
16
3

IN ALL CASES PLOT THE INTENDED WELL ON THE PLAT BELOW

PLAT OF ACREAGE ATTRIBUTABLE TO A WELL IN A PRORATED OR SPACED FIELD

If the intended well is in a prorated or spaced field, please fully complete this side of the form. If the intended well is in a prorated or spaced field complete the plat below showing that the well will be properly located in relationship to other wells producing from the common source of supply. Please show all the wells within 1 mile of the boundaries of the proposed acreage attribution unit for gas wells and within 1/2 mile of the boundaries of the proposed acreage attribution unit for oil wells.

API NO. 15- 165-2168400000
 OPERATOR Pintail Petroleum, Ltd. LOCATION OF WELL: COUNTY Rush
 LEASE Werhahn 1650 feet from south/north line of section
 WELL NUMBER #1 660 feet from east/west line of section
 FIELD Wildcat SECTION 36 TWP 19S RG 16W

NUMBER OF ACRES ATTRIBUTABLE TO WELL _____ IS SECTION X REGULAR or _____ IRREGULAR
 QTR/QTR/QTR OF ACREAGE s 1/2 - NE - SE **IF SECTION IS IRREGULAR, LOCATE WELL FROM NEAREST CORNER BOUNDARY.**

Section corner used: _____ NE _____ NW _____ SE _____ SW

PLAT

(Show location of the well and shade attributable acreage for prorated or spaced wells.)
 (Show footage to the nearest lease or unit boundary line.)

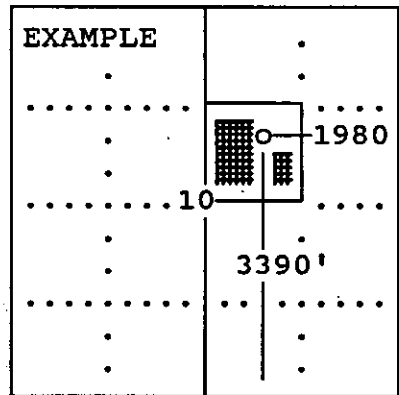
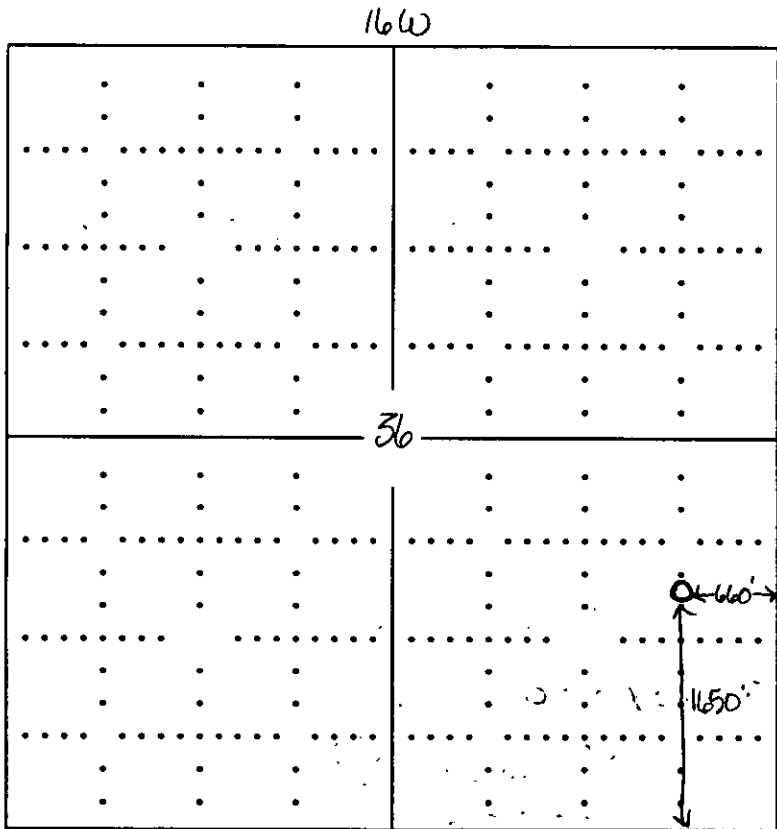

SEWARD CO.

In plotting the proposed location of the well, you must show:

- 1) The manner in which you are using the depicted plat by identifying section lines, i.e. 1 section, 1 section with 8 surrounding sections, 4 sections, etc.;
- 2) the distance of the proposed drilling location from the section's south/north and east/west; and
- 3) the distance to the nearest lease or unit boundary line.