

STATE OF KANSAS
STATE CORPORATION COMMISSION

WELL PLUGGING RECORD

Give All Information Completely
Make Required Affidavit
Mail or Deliver Report to
Conservation Division
State Corporation Comm.
245 North Water
Wichita, KS 67202

Barber County, Sec. 4 Twp. 34S Rge. 11 ~~NE~~ W
Location as "NE/CNW/SW" or footage from lines
C NW SE

Lease Owner Hawkins Oil & Gas, Inc.
Lease Name HOG-Forrester Well No. 1-4
Office Address Box 1869, Liberal, Kansas 67901
Character of Well (Completed as Oil, Gas or Dry Hole) dry hole

Date Well completed 7-10 1980
Application for plugging filed 1-16 1981
Application for plugging approved 1-18 1981
Plugging commenced 1-20 1981
Plugging completed 1-23 1981

Reason for abandonment of well or producing formation dry hole

If a producing well is abandoned, date of last production N/A 19

Was permission obtained from the Conservation Division or its agents before plugging was commenced? yes

Name of Conservation Agent who supervised plugging of this well Morris Leslie
Producing formation _____ Depth to top _____ Bottom _____ Total Depth of Well 4750'
Show depth and thickness of all water, oil and gas formations.

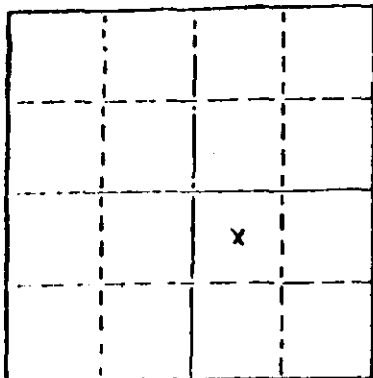

Locate well correctly on above Section Plot

OIL, GAS OR WATER RECORDS

CASING RECORD

FORMATION	CONTENT	FROM	TO	SIZE	PUT IN	PULLED OUT
				8 5/8"	370'	none
				4 1/2"	4713'	2614'

Describe in detail the manner in which the well was plugged, indicating where the mud fluid was placed and the method or methods used in introducing it into the hold. If cement or other plugs were used, state the character of same and depth placed, from _____ feet to _____ feet for each plug set.

Plugged well as follows: pumped 35 sacks of cement and 1 sack of hulls from 4578' to 4110' - pumped 40 sacks of cement from 360' to 410' - put 10 sacks of cement from 33' to 3' - cut off and capped 8 5/8" surface casing 3' below ground level.

(If additional description is necessary, use BACK of this sheet)

Name of Plugging Contractor Sargent's Casing Pulling Service, Box 506, Liberal, Kansas 67901 #51

STATE OF KANSAS COUNTY OF Seward, ss.
Ned E. Lowry (employee of owner) or ~~(XXXXXX XXXX XXXX XXXX)~~

of the above-described well, being first duly sworn on oath, says: That I have knowledge of the facts, statements, and matters herein contained and the log of the above-described well as filed and that the same are true and correct. So help me God.

(Signature) Ned E. Lowry, Agent
Box 1869, Liberal, Kansas 67901
(Address)

SUBSCRIBED AND SWORN before me this 28th day of January, 1981

My commission expires _____

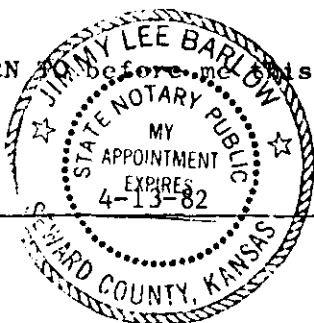

Jimmy Lee Barlow
Notary Public.

KANSAS

WELL COMPLETION REPORT AND DRILLER'S LOG

S. 4 T. 34 S R. 11 E W

Loc. C NW SE

County Barber

API No. 15 — 007 — 20,925-00-00
County Number

Operator
Hawkins Oil & Gas, Inc.

Address
Box 1869 Liberal, Kansas 67901

Well No. #1-4 Lease Name Hog-Forrester

Footage Location
1980 feet from (S) line 1980 feet from (E) line

Principal Contractor DaMac Drilling, Inc. Geologist

Spud Date 7-1-80 Date Completed Drilling 7-10-80 Total Depth 4750' P.B.T.D. 4662'

Directional Deviation N/A Oil and/or Gas Purchaser

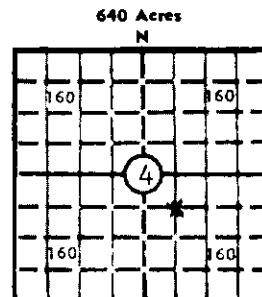

Locate well correctly
Elev.: Gr. 1372'
DF 1381' KB -

CASING RECORD

Report of all strings set — surface, intermediate, production, etc.

Purpose of string	Size hole drilled	Size casing set (in O.D.)	Weight lbs/ft.	Setting depth	Type cement	Sacks	Type and percent additives
Surface	12 1/2"	8 5/8"	20#	370'	common	275	2% gel, 3% cc
Production	7 7/8"	4 1/2"	10.5#	4713'	common	50	8% gel, 10% salt, 12 1/2# gilsonite
					50/50 pozmix	200	18% salt, 12 1/2# gilsonite

LINER RECORD

PERFORATION RECORD

Top, ft.	Bottom, ft.	Sacks cement	Shots per ft.	Size & type	Depth interval
			2	.38 DML	4570'-4578'

Size	Setting depth	Packer set at

ACID, FRACTURE, SHOT, CEMENT SQUEEZE RECORD

Amount and kind of material used	Depth interval treated
500 gal 15% acid	4570-4578 1-29-81

STAMP: CONSERVATION DIVISION, WICHITA, KANSAS

INITIAL PRODUCTION

Date of first production	Producing method (flowing, pumping, gas lift, etc.)
RATE OF PRODUCTION PER 24 HOURS	Oil bbls. Gas MCF Water bbls. Gas-oil ratio CFPB
Disposition of gas (vented, used on lease or sold)	Producing interval (s)

INSTRUCTIONS: As provided in KCC Rule 82-2-125, within 90 days after completion of a well, one completed copy of this Drillers Log shall be transmitted to the State Geological Survey of Kansas, 4150 Monroe Street, Wichita, Kansas 67209. Copies of this form are available from the Conservation Division, State Corporation Commission, 245 No. Water, Wichita, Kansas 67202. Phone AC 316-522-2206. If confidential custody is desired, please note Rule 82-2-125. Drillers Logs will be on open file in the Oil and Gas Division, State Geological Survey of Kansas, Lawrence, Kansas 66044.

	Date Received
Date January 28, 1981	
Title Agent/Hawkins Oil & Gas, Inc.	
Signature <i>[Handwritten Signature]</i>	

USE ADDITIONAL SHEETS, IF NECESSARY, TO COMPLETE WELL RECORD.

FORMATION DESCRIPTION, CONTENTS, ETC.	TOP	BOTTOM	NAME	DEPTH
Surface Sand	0	373		
Red Bed	373	762		
Shale	762	1591		
Red Bed, shale	1591	1885		
Shale	1885	2315		
Lime, shale	2315	4558		
Lime	4558	4750 RTD		

WELL LOG		Show all important zones of porosity and contents thereof; cored intervals, and all drill-stem tests, including depth interval tested, cushion used, time tool open, flowing and shut-in pressures, and recoveries.	
SHOW GEOLOGICAL MARKERS, LOGS RUN, OR OTHER DESCRIPTIVE INFORMATION.			
Operator HAWKINS OIL & GAS, INC.	Well No. I-4	Lease Name HOG-Forrester	S 4 T34S R 11 E W
DESIGNATE TYPE OF COMP.: OIL, GAS, DRY HOLE, SWDW, ETC.		dry hole	