

STATE OF KANSAS
STATE CORPORATION COMMISSION

WELL PLUGGING RECORD

Give All Information Completely
Make Required Affidavit
Mail or Deliver Report to:
Conservation Division
State Corporation Commission
800 Bitting Building
Wichita, Kansas

Barber County. Sec. 10 Twp. 34 Rge. 11 (X) W (W)

Location as "NE/CNW%SW%" or footage from lines NW NW NW
Lease Owner Petroleum, Incorporated
Lease Name Zimmerman "D" Well No. 1
Office Address Route 2, Great Bend, Kansas
Character of Well (completed as Oil, Gas or Dry Hole) Dry Hole
Date well completed August 17 19 56
Application for plugging filed August 20 19 56
Application for plugging approved August 17 19 56
Plugging commenced August 17 19 56
Plugging completed August 17 19 56
Reason for abandonment of well or producing formation No Producing Zones

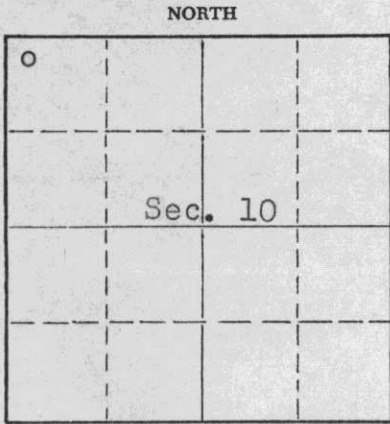

Locate well correctly on above Section Plat

If a producing well is abandoned, date of last production None 19
Was permission obtained from the Conservation Division or its agents before plugging was commenced? Yes

Name of Conservation Agent who supervised plugging of this well M.A. Rives Pratt, Kansas
Producing formation ----- Depth to top ----- Bottom ----- Total Depth of Well 4704 Feet
Show depth and thickness of all water, oil and gas formations.

OIL, GAS OR WATER RECORDS

CASING RECORD

FORMATION	CONTENT	FROM	TO	SIZE	PUT IN	PULLED OUT
				8 5/8" OD	331'	None

Describe in detail the manner in which the well was plugged, indicating where the mud fluid was placed and the method or methods used in introducing it into the hole. If cement or other plugs were used, state the character of same and depth placed, from _____ feet to _____ feet for each plug set.

Mud up with heavy mud to 300', pushed down 1/4 sack hulls followed by wooden plug. Placed 20 sacks cement through drill pipe on to plug. Mud up to 35' and place 1/4 sack hulls to 35' followed by wooden plug and 10 sacks cement to base of well cellar.

(If additional description is necessary, use BACK of this sheet)

Name of Plugging Contractor Garvey Drilling Co.
Address Route 2, Great Bend, Kansas

STATE OF KANSAS, COUNTY OF BARTON, ss.
Jack Perkins (employee of owner) or (owner or operator) of the above-described well, being first duly sworn on oath, says: That I have knowledge of the facts, statements, and matters herein contained and the log of the above-described well as filed and that the same are true and correct. So help me God.

(Signature) Jack Perkins
Route 2, Great Bend, Kansas
(Address)

SUBSCRIBED AND SWORN to before me this 20th day of August, 1956

Led A. Brown Notary Public.

My commission expires July 11, 1960

PLUGGING
FILE SEC. 10 T. 34 R. 11 W
BOOK PAGE 91 LINE 26

RECEIVED
STATE CORPORATION COMMISSION
AUG 21 1956
CONSERVATION DIVISION
Wichita, Kansas

WELL LOG

COMPANY PETROLEUM, INCORPORATED

SEC. 10 T. 34S R. 11W

FARM Zimmerman 'D' NO. 1

LOC. NW,NW,NW

TOTAL DEPTH 4704'

COUNTY Barber Co., Kansas

COMM. August 1, 1956

COMP. August 17, 1956

CONTRACTOR GARVEY DRILLING COMPANY

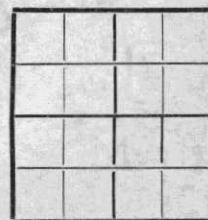

CASING 8 5/8" @ 331' W/225 sax.

ELEVATION 1358' KB

PRODUCTION D & A

FIGURES INDICATE BOTTOM OF FORMATIONS

18	Surface sand
335	Sand & red bed
600	Red bed
950	Shale & shells
1050	Anhydrite & shale
1314	Shale
1470	Shale & lime
1500	Shale & shells
1641	Lime & shale
2191	Lime XXXXXX
2800	Lime & shale
3011	Lime
3212	Broken Lime
3356	Lime & shale
3440	Lime & sand
3560	Lime & shale
3633	Lime
3720	Sandy shale & lime
3877	Shale & lime
4005	Sandy shale & lime
4124	Lime & shale
4191	Lime
4221	Cherty lime
4422	Lime
4520	Lime & shale
4535	Sand & chert
4590	Chert
4676	Cherty lime
4695	Shale
4704	Lime & chert
4704	T. D.

PLUGGING	
FILE SEC	10 T. 34 R. 11W
BOOK PAGE	91 LINE 26

RECEIVED
STATE CORPORATION COMMISSION
AUG 21 1956
CONSERVATION DIVISION

State of KANSAS }
County of BARTON } SS:

I, Verne A. Morris of Garvey Drilling Company

upon oath state that the above and foregoing is a true and correct copy of the log of the #1 Zimmerman 'D' well

Verne A. Morris

Subscribed and sworn to before me this 20th day of August 1956

My Commission Expires: July 11, 1960

Led A. Brewer
NOTARY PUBLIC