

15-007-21544-00-00

WELL PLUGGING RECORD

Give All Information Completely
 Make Required Affidavit

COUNTY Barber SEC. 7 TWP. 32S RGE. 12W E/W
 Location as in quarters or footage from lines:
C SE NE

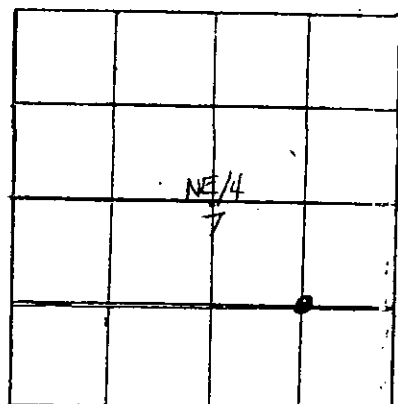

Locate Well
 correctly on above
 Section Platt.

Lease Owner WESX Petroleum, Inc.
 Lease Name Aubley Well No. 1
 Office Address P.O. Box 1609, Great Bend, KS 67530
 Character of Well (Completed as Oil, Gas or Dry Hole): Dry Hole
 Date Well Completed 1-7-83
 Application for plugging filed 1-7-83
 Plugging commenced 1-7-83
 Plugging completed 1-7-83 1:00 a.m.
 Reason for abandonment of well or producing formation D & A

Was permission obtained from the Conservation Division or it's
 Agent's before plugging was commenced? yes

Name of Conservation Agent who supervised plugging of this well Steve Durrant

Producing formation _____ Depth to top _____ bottom _____ T.D. 4270'

Show depth and thickness of all water, oil and gas formations.

OIL, GAS OR WATER RECORDS

Casing Record

Formation	Content	From	To	Size	Put in	Pulled Out
				8 5/8"	304'	none

Describe in detail the manner in which the well was plugged, indicating where the mud
 fluid was placed and the method or methods used in introducing it into the hold. If cement
 or other plugs were used, state the character of same and depth placed, from _____ feet
 to _____ feet for each plug set.

- 70 sx @ 900'
- 40 sx @ 360'
- 10 sx & wooden plug @ 40'
- 10 sx in rathole
- 130 sx 50/50 poz, 4% gel, 3% cc

RECEIVED
 STATE CORPORATION COMMISSION

JAN 31 1983

CONSERVATION DIVISION
 Wichita, Kansas

(If additional description is necessary, use BACK of this sheet)
 Name of Plugging Contractor Mustang Drilling & Exploration, Inc.

STATE OF Kansas COUNTY OF Barton, ss.
Bill Nelson (employee of owner) or (owner or operator) of the
 above-described well, being first duly sworn on oath, says: That I have knowledge of the
 facts, statements, and matters herein contained and the log of the above-described well as
 filed and that the same are true and correct. So help me God.

(Signature) Bill Nelson
P.O. Box 1609, Great Bend, KS
 (Address)

SUBSCRIBED AND SWORN TO before me this 24th day of January, 1983

Pam Shaffer
 Notary Public.

My Comm. Expires: 9-30-86
 NOTARY PUBLIC - State of Kansas
 PAM SHAFFER