

STATE CORPORATION COMMISSION OF KANSAS  
OIL & GAS CONSERVATION DIVISION  
WELL COMPLETION OR RECOMPLETION FORM  
ACO-1 WELL HISTORY  
DESCRIPTION OF WELL AND LEASE

API No. 15-007-21846-A  
County Barber FROM CONFIDENTIAL  
N/2 NE 1/4 Sec. 11 Twp. 34S Rge. 13 East  
X West

Operator: License # 5171  
Name TXO Production Corporation  
Address 1660 Lincoln Street, Suite 1800  
City/State/Zip Denver, CO 80264

4190 Ft North from Southeast Corner of Section  
1760 Ft West from Southeast Corner of Section  
(Note: Locate well in section plat below)

Purchaser.....

Lease Name Donovan Well # B-1 OWWO

Operator Contact Person Les Smith  
Phone (303) 861-4246

Field Name.....

Producing Formation.....

Contractor: License # 5107  
Name H-30 Drilling, Inc.

Elevation: Ground 1651 KB 1656

Wellsite Geologist.....  
Phone.....

Section Plat

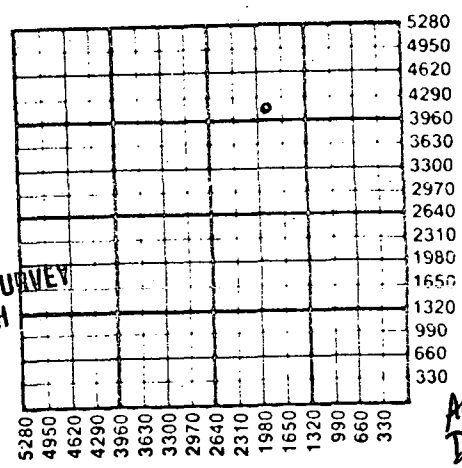

ALT I  
DFA

Designate Type of Completion  
    New Well   X   Re-Entry     Workover

    Oil     SWD     Temp Abd.  
    Gas     Inj     Delayed Comp.  
  X   Dry     Other (Core, Water Supply etc.)

If OWWO: old well info as follows:  
Operator.....  
Well Name.....  
Comp. Date..... Old Total Depth.....

WATER SUPPLY INFORMATION

Disposition of Produced Water:     Disposal  
Docket #.....     Repressuring

WELL HISTORY

Drilling Method:  
  X   Mud Rotary     Air Rotary     Cable

6-18-89 6-18-89 6-18-89  
Spud Date Date Reached TD Completion Date  
992'  
Total Depth PBTD DWCC

Amount of Surface Pipe Set and Cemented at 267 feet  
Multiple Stage Cementing Collar Used?     Yes     No  
If yes, show depth set.....feet  
If alternate 2 completion, cement circulated  
from.....feet depth to.....w/.....SX cmt  
Cement Company Name.....  
Invoice #.....

Questions on this portion of the ACO-1 call:  
Water Resources Board (913) 296-3717

Source of Water:  
Division of Water Resources Permit #.....

    Groundwater.....Ft North from Southeast Corner  
(Well) .....Ft West from Southeast Corner of  
Sec Twp Rge East West

    Surface Water.....Ft North from Southeast Corner  
(Stream, pond etc).....Ft West from Southeast Corner  
Sec Twp Rge East West

    Other (explain).....  
(purchased from city, R.W.D. #)

INSTRUCTIONS: This form shall be completed in duplicate and filed with the Kansas Corporation Commission, 200 Colorado Derby Building, Wichita, Kansas 67202, within 90 days after completion or recompletion of any well. Rule 82-3-130 and 82-3-107 apply.  
Information on side two of this form will be held confidential for a period of 12 months if requested in writing and submitted with the form. See rule 82-3-107 for confidentiality in excess of 12 months.  
One copy of all wireline logs and drillers time log shall be attached with this form. Submit CP-4 form with all plugged wells. Submit CP-111 form with all temporarily abandoned wells.

All requirements of the statutes, rules and regulations promulgated to regulate the oil and gas industry have been fully complied with and the statements herein are complete and correct to the best of my knowledge.

Signature Les Smith  
Title DRUG/PROD. ENGINEER Date 10/17/89

K.C.C. OFFICE USE ONLY  
 Letter of Confidentiality Attached  
 Wireline Log Received  
 Drillers Timelog Received  
Distribution  
 KCC  SWD/Rep  NGPA  
 KGS  Plug  Other  
(Specify)

Subscribed and sworn to before me this 17 day of October  
1989.  
Notary Public Char Stecki  
Date Commission Expires Feb 8, 1993

SIDE TWO

Operator Name TXO Production Corporation Lease Name Donovan Well # B-1 OWWO

Sec. 11 Twp. 34S Rge. 13 East West County Barber RELEASED

JAN 18 1991

WELL LOG

INSTRUCTIONS: Show important tops and base of formations penetrated. Detail all cores. Report all drill stem tests giving interval tested, time tool open and closed, flowing and shut-in pressures, whether shut-in pressure reached static level, hydrostatic pressures, bottom hole temperature, fluid recovery, and flow rates if gas to surface during test. Attach extra sheet if more space is needed. Attach copy of log.

FROM CONFIDENTIAL

Drill Stem Tests Taken  Yes  No  
 Samples Sent to Geological Survey  Yes  No  
 Cores Taken  Yes  No

Formation Description  
 Log  Sample

Name	Top	Bottom
Washed down to	0	992'
Rotary Total Depth		992'

CASING RECORD <input type="checkbox"/> New <input type="checkbox"/> Used							
Report all strings set-conductor, surface, intermediate, production, etc.							
Purpose of String	Size Hole Drilled	Size Casing Set (in O.D.)	Weight Lbs/Ft.	Setting Depth	Type of Cement	#Sacks Used	Type and Percent Additives
Surface			30 lbs	267'	C-A	225	
PERFORATION RECORD				Acid, Fracture, Shot, Cement Squeeze Record			
Shots Per Foot	Specify Footage of Each Interval Perforated			(Amount and Kind of Material Used)		Depth	
TUBING RECORD							
Size	Set At	Packer at	Liner Run <input type="checkbox"/> Yes <input type="checkbox"/> No				
Date of First Production		Producing Method					
		<input type="checkbox"/> Flowing <input type="checkbox"/> Pumping <input type="checkbox"/> Gas Lift <input type="checkbox"/> Other (explain).....					
Estimated Production Per 24 Hours	Oil	Gas	Water	Gas-Oil Ratio	Gravity		
	Bbls	MCF	Bbls	CFPB			

METHOD OF COMPLETION

Production Interval

Disposition of gas:  Vented  Open Hole  Perforation  
 Sold  Other (Specify) .....  
 Used on Lease  Dually Completed  
 Commingled

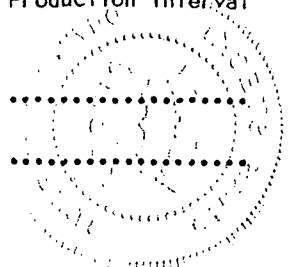

Must be approved by the K.C.C. five (5) days prior to commencing well

Expected Spud Date: April 15 1989  
month day year

N $\frac{1}{2}$  NE $\frac{1}{4}$  Sec 11 Twp 34 S, Rg 13 East West

OPERATOR: License # 5171  
Name: TXO Production Co.  
Address: 1660 Lincoln Center Bldg. #1800  
City/State/Zip: Denver, CO 80264  
Contact Person: Cory West  
Phone: (303) 861-4246

4190 feet from South line of Section  
1760 feet from East line of Section  
(Note: Locate well on Section Plat Below)

CONTRACTOR: License # 5389  
Name: Eagle Drilling, Inc. H-30

County: Barber  
Lease Name: Donovan Well #: B-1  
Field Name:  
Is this a Prorated Field? yes X no  
Target Formation(s): Miss  
Nearest lease or unit boundary: 1090  
Ground Surface Elevation: 1651 feet MSL  
Domestic well within 330 feet: yes X no  
Municipal well within one mile: yes X no  
Depth to bottom of fresh water: 250 180  
Depth to bottom of usable water: 250 180  
Surface Pipe by Alternate: X 1 2  
Length of Surface Pipe ~~from~~ set: 267  
Length of Conductor pipe required: N/A  
Projected Total Depth: 4900  
Formation at Total Depth: Miss  
Water Source for Drilling Operations:  
... well ... farm pond ... other

Well Drilled For: Well Class: Type Equipment:  
... Oil ... Inj X Infield X Mud Rotary  
X Gas ... Storage ... Pool Ext. ... Air Rotary  
X OAWO ... Disposal ... Wildcat ... Cable  
... Seismic; ... # of Holes

If OAWO: old well information as follows:  
Operator: Molz Oil  
Well Name: Donovan E-1  
Comp. Date: 07-02-84 Old Total Depth: 5250

Directional, Deviated or Horizontal wellbore? yes XX no  
If yes, total depth location:

DWR Permit #:  
Will Cores Be Taken? yes no  
If yes, proposed zone:

Spud 6-16-89 59 PM

267' alt 1 Reg

PUSHER  
TD 990' FORMATION  
SURFACE PIPE 10 3/4 @ 267  
ANEHYDRITE ELEVATION  
STARTING TIME & DATE 11:00 P.M. sub-18-89  
COMPLETION TIME & DATE 1:00 P.M. sub-18-89  
1st PLUG @ 600 FT. W/ 50 SX  
2nd PLUG @ 310 FT. W/ 50 SX  
3rd PLUG @ 40 FT. W/ 10 SX  
4th PLUG @ FT. W/ SX  
RAT HOLE CIRCULATED W/ 15 SX  
MOUSE HOLE CIRCULATED W/ SX  
WATER WELL PLUGGED W/ SX  
CEMENT COMPANY B.J. Titus  
TECHNICIAN

RECEIVED  
STATE CORPORATION COMMISSION  
JUN 22 1989  
CONSERVATION DIVISION  
Wichita, Kansas

60/40/6

5280	1980
4950	1650
4620	1320
4290	990
3960	660
3630	330
3300	
2970	
2640	
2310	
1980	
1650	
1320	
990	
660	
330	

Spud date: \_\_\_\_\_ agent: \_\_\_\_\_

- REMEMBER TO:
- File Drill Pit Application (form CDP-1) with Intent to Drill;
  - File Completion Form ACO-1 within 120 days of spud date;
  - File acreage attribution plat according to field proration orders;
  - Notify appropriate district office 48 hours prior to workover or re-entry;
  - Submit plugging report (CP-4) after plugging is completed;
  - Obtain written approval before disposing or injecting salt water.