

WELL PLUGGING RECORD

Give All Information Completely
Make Required Affidavit
Mail or Deliver Report to:
Conservation Division
State Corporation Commission
See Bitting Building
Wichita, Kansas

NORTH

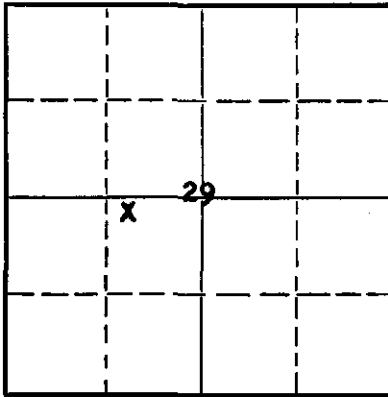

Locate well correctly on above Section Plat

BARBER County, Sec. 29 Twp. 31S Rge. 10 (M) W (W)
Location as "NE/CNW $\frac{1}{4}$ SW $\frac{1}{4}$ " or footage from lines NW-NE-SW
Lease Owner ORAS A. SHAW
Lease Name FRANK McREYNOLDS Well No. _____
Office Address 1405 PHILTOWER BLDG. TULSA, OKLAHOMA
Character of Well (completed as Oil, Gas or Dry Hole) DRY HOLE
Date well completed 3-24-53 19_____
Application for plugging filed SAME 19_____
Application for plugging approved SAME 19_____
Plugging commenced 3-25-53 19_____
Plugging completed 3-25-53 19_____
Reason for abandonment of well or producing formation _____

If a producing well is abandoned, date of last production _____ 19_____
Was permission obtained from the Conservation Division or its agents before plugging was commenced? YES

Name of Conservation Agent who supervised plugging of this well M. A. RIVER
Producing formation _____ Depth to top _____ Bottom _____ Total Depth of Well 5912 Feet
Show depth and thickness of all water, oil and gas formations.

OIL, GAS OR WATER RECORDS

CASING RECORD

Formation	Content	From	To	Size	Put In	Pulled Out
				10 3/4"	238	NONE

Describe in detail the manner in which the well was plugged, indicating where the mud fluid was placed and the method or methods used in introducing it into the hole. If cement or other plugs were used, state the character of same and depth placed, from _____ feet to _____ feet for each plug set.

WELL FILLED WITH MUD TO BOTTOM OF SURFACE PIPE. A PLUG MADE OF A SACK AND COTTON SEED HULLS WAS PLACED IN THE SURFACE PIPE AT 235' AND CEMENT PLUG OF APPROX. 20 FEET SPOTTED ON TOP OF HULLS. PIPE WAS FILLED UP WITH MUD TO WITHIN APPROX. 35 FEET OF TOP, AND THEN FILLED TO TOP OF SURFACE WITH CEMENT. WELL WAS ALLOWED TO STAND OPEN UNTIL PLUG HAD SET AND HAD BEEN INSPECTED, AND THEN A STEEL CAP WAS SCREWED INTO TOP OF SURFACE PIPE AND CELLAR FILLED IN.

RE
STATE CONTROL DIVISION
APR 1953 4-7-53
CONSERVATION DIVISION
Wichita, Kansas

Name of Plugging Contractor DOAK DRILLING COMPANY
Address Box 1108 BRISTOW, OKLAHOMA

STATE OF _____, COUNTY OF _____, ss.
_____, (employee of owner) or (owner or operator) of the above-described well,
being first duly sworn on oath, says: That I have knowledge of the facts, statements, and matters herein contained and the log of the above-described well as filed and that the same are true and correct. So help me God.

(Signature) William M. Hughes

SUBSCRIBED AND SWORN to before me this 2 day of April, 1953
Jane E. Hummel Notary Public.

My commission expires 4-3-53
23-8390-1 6-51-20M

PLUGGING
FILE SEC 29 T 31 R 10 W
BOOK PAGE 87 LINE 42

COUNTY BARBER, KANSAS, SEC. 29, TWP. 31S., RGE. 10W.
 FARM NAME FRANK McREYNOLDS, WELL NO. 10

1027 10634

WELL RECORD
 OIL AND GAS CONSERVATION DEPARTMENT

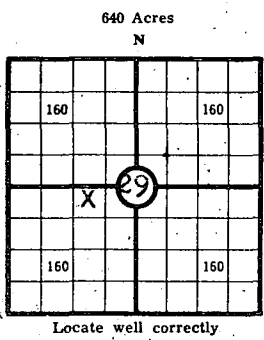

COUNTY BARBER SEC. 29 TWP. 31S RGE. 10W
 COMPANY OPERATING ORAS A. SHAW
 OFFICE ADDRESS 1405 PHILTOWER BLDG., TULSA, OKLA.
 FARM NAME FRANK McREYNOLDS WELL NO. 1
 DRILLING STARTED 2-14 1953, DRILLING FINISHED 3-24 1953
 DATE OF FIRST PRODUCTION NONE COMPLETED
 WELL LOCATED NW $\frac{1}{4}$ NE $\frac{1}{4}$ SW $\frac{1}{4}$ North of South
 Line and _____ ft. East of West Line of Quarter Section
 Elevation (Relative to sea-level) DERRICK FLOOR 1677 GROUND
 CHARACTER OF WELL (Oil, gas or dryhole) DRY

OIL OR GAS SANDS OR ZONES

Name	From	To	Name	From	To
1			4		
2			5		
3			6		

Perforating Record If Any

Shot Record

Formation	From	To	No. of Shots	Formation	From	To	Size of Shot

CASING RECORD

Amount Set						Amount Pulled		Packer Record	
Size	Wt.	Thds.	Make	Ft.	In.	Size	Length	Depth Set	Make
10 3/4"	32#	8	Lw.	238					

Liner Record: Amount _____ Kind _____ Top _____ Bottom _____

CEMENTING AND MUDDING

Size	Amount Set		Sacks Cement	Chemical		Method of Cementing	Amount	Mudding Method	Results (See Note)
	Ft.	In.		Gal.	Make				
10 3/4	238		225	POZMEX &	HALLIBURTON				
			4	CALC. CHLOR DE					

Note: What method was used to protect sands if outer strings were pulled? _____

NOTE: Were bottom hole plugs used? _____ If so, state kind, depth set and results obtained _____

TOOLS USED

Rotary Tools were used from 0 feet to 5912 Cable tools were used from _____ feet to _____

feet, and from _____ feet to _____ feet, and from _____ feet to _____

Type Rig NATIONAL T-32 DOAK DRILLING COMPANY

INITIAL PRODUCTION TEST

Describe initial test: whether by flow through tubing or casing or by pumping _____

Amount of Oil Production _____ bbls. Size of choke, if any _____ Length of test _____ Water _____

Production _____ bbls. Gravity of oil _____ Type of Pump if pump is used, describe _____

Give detailed description and thickness of all formations drilled through, contents of sand, whether dry, water, oil or gas.

Formation	Top	Bottom	Formation	Top	Bottom
RED BED	0	750			
RED BED & SHALE	750	1315			
SHALE & SHELLS	1315	1630			
LIME & SHALE	1630	1930			
SHALE & SHELLS	1930	3048			
LIME & SHALE	3048	3665			
LIME	3665	3708			
SAND	3708	3743			
SAND & SHALE	3743	3850			
LIME & SAND	3850	3860			
LIME & SHALE	3860	3940			
LIME	3940	4152			
LIME & SHALE	4152	4232			
LIME	4232	4282			
LIME & SHALE	4282	4460			
LIME	4460	4537			
LIME & CHERT	4537	4563			
LIME	4563	4587			
LIME & SHALE	4587	4713			
LIME	4713	4742			
LIME & SAND	4742	4767			
LIME	4767	4775			
SAND	4775	4803			
SANDY DOLOMITE	4803	4850			
LIME & SHALE	4850	4861			
DOLOMITE	4861	5855			
SAND	5855	5883			
QUARTZITE	5883	5912			

PLUGGING
 FILE SEC. 29 T. 31 S. R. 10 W.
 BOOK PAGE 27 LINE 32

RECEIVED
 OIL AND GAS CONSERVATION COMMISSION

APR 2 1953

CONSERVATION DIVISION
 Wichita, Kansas

I, the undersigned, being first duly sworn upon oath, state that this well record is true, correct and complete according to the records of this office and to the best of my knowledge and belief.

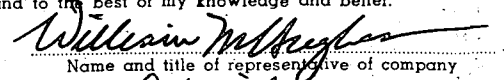
 Name and title of representative of company

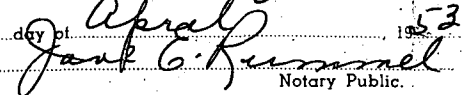
Subscribed and sworn to before me this 7 day of April 1953
 My Commission expires 4-3-53

 Notary Public.