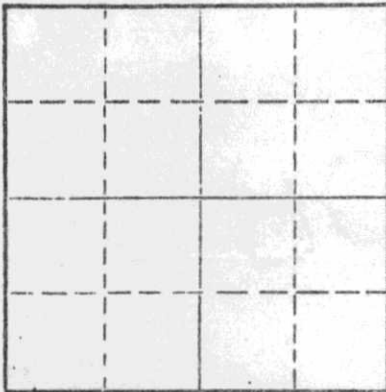

STATE OF KANSAS
STATE CORPORATION COMMISSION

Form CP-4

Give All Information Completely
Make Required Affidavit
Mail or Deliver Report to:
Conservation Division
State Corporation Commission
P. O. Box 17027Wichita, Kansas 67217
NORTHLocate well correctly on above
Section Plat

WELL PLUGGING RECORD

Barber County, Sec. 8 Twp. 31 Rge. 10 (E) (W)
 Location as "NE/CNW/SW4" or footage from lines C S/W S/E
 Lease Owner Hooover & Brackeen
 Lease Name 3232x11611 Bennett #1 Well No. 73102
 Office Address 3232 Liberty Tower, Oklahoma City, Oklahoma
 Character of Well (completed as Oil, Gas or Dry Hole) _____
 Date well completed _____ 19____
 Application for plugging filed _____ 19____
 Application for plugging approved _____ 19____
 Plugging commenced 2/13/73 _____ 19____
 Plugging completed 2/19/73 _____ 19____
 Reason for abandonment of well or producing formation depleted.
 If a producing well is abandoned, date of last production _____ 19____
 Was permission obtained from the Conservation Division or its agents before plugging was commenced? yes

Name of Conservation Agent who supervised plugging of this well Biberstein
 Producing formation _____ Depth to top _____ Bottom _____ Total Depth of Well 4547 Feet
 Show depth and thickness of all water, oil and gas formations.

OIL, GAS OR WATER RECORDS

CASING RECORD

FORMATION	CONTENT	FROM	TO	SIZE	PUT IN	PULLED OUT
				8-5/8	271	none
				5 1/2"	4547'	3701

Describe in detail the manner in which the well was plugged, indicating where the mud fluid was placed and the method or methods used in introducing it into the hole. If cement or other plugs were used, state the character of same and depth placed, from _____ feet to _____ feet for each plug set.

Ran sand to 4480' and ran 5 sacks cement. Shot pipe at 2859',
 loaded hole with water. Shot pipe at 3764', 3700', pulled 116 joints
 and tallied pipe. Set rock bridge at 450', ran 7 yards ready mix.

PLUGGING COMPLETE.

RECEIVED
STATE CORPORATION COMMISSION

FEB 26 1973

CONSERVATION DIVISION
Wichita, Kansas

(If additional description is necessary, use BACK of this sheet)
 Name of Plugging Contractor KNIGHT CASING PULLING CO., INC.
 Address CHASE, KANSAS

STATE OF KANSAS, COUNTY OF RICE, ss.
NOEL J. KNIGHT (employee of owner) or (owner or operator) of the above-described
 well, being first duly sworn on oath, says: That I have knowledge of the facts, statements, and matters herein contained and the log of the
 above-described well as filed and that the same are true and correct. So help me God.

(Signature) _____

CHASE, KANSAS

(Address)

SUBSCRIBED AND SWORN TO before me this 23rd day of February, 19 73

My commission expires _____



MARGARET MELCHER
 NOTARY PUBLIC
 Rice County, Kansas
 My Commission Expires
 Feb. 15, 1975

Notary Public.

HOOVER AND BRACKEN Oil Properties, Inc.
3232 Liberty Tower
Oklahoma City, Oklahoma 73102

DRILLERS WELL LOG

#1 Bennett

Commenced R.D. 12-15-72
Completed R.D. 12-26-72
Rotary Total Depth 4547'

C SW SE - Section 8-31S-10W
Barber County, Kansas
Elevation: 1761 GL, 1766 DF; 1768KB
Initial Production: Gas
Contractor: Thomas Drilling Co.

STRATA	DEPTH
Sand	0 - 40
Sand, Red Bed	40 - 273
Red Bed	273 - 425
Red Bed, Shale	425 - 1345
Shale, Anhydrite	1345 - 1817
Lime, Shale	1817 - 2458
Lime	2458 - 2700
Lime, Shale	2700 - 2880
Lime	2880 - 3017
Lime, Shale	3017 - 3360
Lime	3360 - 4547 RTD

RECEIVED
STATE CORPORATION COMMISSION
JAN 29 1973
CONSERVATION DIVISION
Wichita, Kansas

I hereby certify that the above is a true and correct log of said well as reflected by the daily drilling reports.

THOMAS DRILLING COMPANY

By T. H. McCasland, Jr.
T. H. McCasland, Jr., President

Signed and sworn to in my presence this 5th day of January, 1973, by T. H. McCasland, Jr., acting agent of Hoover and Bracken

Josephine Bentley
Josephine Bentley, Notary Public

My commission expires:

3-24-75

RECEIVED
STATE CORPORATION COMMISSION

JAN 29 1973

KANSAS CORPORATION COMMISSION

CONSERVATION DIVISION
Wichita, Kansas

WELL RECORD

(Mail to Kansas Geological Survey, 4150 Monroe Street, Wichita, Kansas 67209)

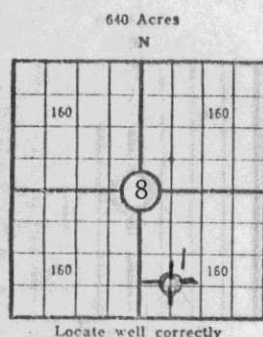

Lease Name: Bennett Well No. 1
Well Located: C SW SE
SEC 8 TWP 31S RGE 10W
Operator: Hoover and Bracken Oil Properties, Inc.
Address: 3232 Liberty Tower, Oklahoma City, Oklahoma 73102
Elevation: Ground 1761 D.F. 1766 K.B. 1768
Type Well: (Oil, gas, dry hole) GAS

Drilling Commenced: 12-15- 19 72 Drilling Completed: 12-26 19 72
Well Completed: 12-26 19 72 Total Depth 4547'
Initial Production: _____

Casing Record

Size: 8-5/8" Set at 271' Size: 5 1/2" Set at 4547'
Size: _____ Set at _____ Size: _____ Set at _____

Liner Record

Size: -- Set from _____ To _____

Cementing

Casing Size	Sacks	Type Cement and Additives
<u>8-5/8"</u>	<u>225</u>	<u>Poz w/3% HA5 w/1/4# floseal/sack</u>
<u>5-1/2"</u>	<u>100</u>	<u>50-50 Poz w/18% salt, 12 1/2# gilsonite, 3/4 of 1% CFR-2, 10 bbls brine ahead.</u>

Perforations

Formation	Perforated Interval and Number Shots
<u>Mississippian chat</u>	<u>4510-28; 36 holes</u>
_____	_____
_____	_____

Electric Log Run (Show type log and depths covered)

Welex Gamma-Guard 4550-271'
Welex Compensated Accoustic-Caliper log 4450-3100'. Subterreanean Logging, Gamma-ray-collar, scattered Gamma log 4541-3500'.

(Fill in formation and related information on reverse side)

FORMATION, TESTING AND COMPLETION RECORD

Show Drill Stem Tests,
Well Stimulation and
Production Tests

Formation	Top	Bottom
DST	4500'	4522'
Mississippian Chat	4510'	4528'
<p>Open 15 min., closed 1 hr., open 1 hr. closed 1½ hrs. IFF 18 psi ICF 1527' S F P 12 psi FCF 1424'; Hydr mud 2139' and 2114'. Rec. 39' G.C.M. Gas to surface in 30 min. TSTM.</p> <p>Perts 4510'-28', 36 holes, Show gas. Acidized 1000 gals, rec. est 200 MCF gas. Fracture treated 7500 lbs. sand and 7500 gals gelled water. Swabbed show gas, 1½ bbls salty water per hr. P & A 1-24-73.</p>		

RECEIVED
STATE CORPORATION COMMISSION
JAN 29 1973
CONSERVATION DIVISION
Wichita, Kansas