

STATE CORPORATION COMMISSION OF KANSAS
OIL & GAS CONSERVATION DIVISION
WELL COMPLETION OR RECOMPLETION FORM
ACO-1 WELL HISTORY
DESCRIPTION OF WELL AND LEASE

5

API NO. 15-007-22,164-00-00

County Barber

C. W/2. NW. NE... Sec. 13... Twp. 30... Rge. 12... XX West

4620... Ft North from Southeast Corner of Section
2310... Ft West from Southeast Corner of Section
(Note: Locate well in section plat below)

Lease Name McEntire Well # 1

Field Name NEW FIELD Kumborg, SE

Producing Formation INDIAN CAVE

Elevation: Ground 1884 KB 1892

Operator: License # 5923
Name American Petroleum Company, Inc.
Address 3500 North Bock Road
Bldg. 1300
City/State/Zip Wichita, KS 67226

Purchaser CENTRAL STATES GAS COMPANY
BOX 407 PRATT, KS. 67124

Operator Contact Person JAMES T. BARVAIS
Phone (316) 684-5273

Contractor: License # 5929
Name Duke Drilling Co., Inc.

Wellsite Geologist WILLIAM CLARK
Phone (316) 684-5273

Designate Type of Completion
 New Well Re-Entry Workover
 Oil SWD Temp Abd
 Gas Inj Delayed Comp.
 Dry Other (Core, Water Supply etc.)

If ONWG: old well info as follows:
Operator
Well Name
Comp. Date Old Total Depth

WELL HISTORY

Drilling Method:
 Mud Rotary Air Rotary Cable
9-19-87 9-29-87 1-5-88
Spud Date Date Reached TD Completion Date
4728
Total Depth PBTD

Amount of Surface Pipe Set and Cemented at 262 feet
Multiple Stage Cementing Collar Used? Yes No
If yes, show depth set...feet
If alternate 2 completion, cement circulated
from...feet depth to...w/...SX cmt
Cement Company Name
Invoice #

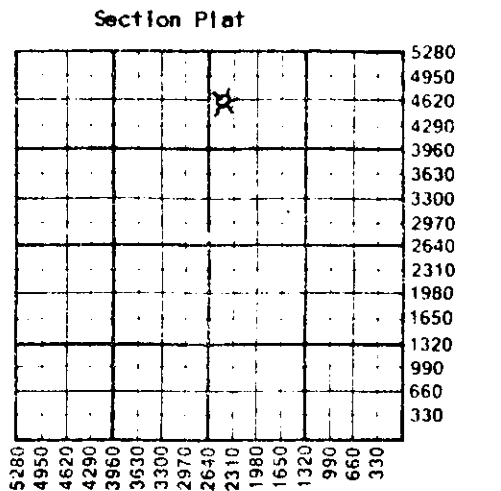

WATER SUPPLY INFORMATION

Disposition of Produced Water: Disposal
Docket # Repressuring

Questions on this portion of the ACO-1 call:

Water Resources Board (913) 296-3717

Source of Water:
Division of Water Resources Permit # applied for...

Groundwater 4620...Ft North from Southeast Corner
(Well) 2310...Ft West from Southeast Corner of
Sec 13 Twp 30 Rge 12 East XX West

Surface Water...Ft North from Southeast Corner
(Stream, pond etc)...Ft West from Southeast Corner
Sec Twp Rge East West

Other (explain)
(purchased from city, R.W.D. #)

INSTRUCTIONS: This form shall be completed in triplicate and filed with the Kansas Corporation Commission, 200 Colorado Derby Building, Wichita, Kansas 67202, within 120 days of the spud date of any well. Rule 82-3-130, 82-3-107 and 82-3-106 apply. Information on side two of this form will be held confidential for a period of 12 months if requested in writing and submitted with the form. See rule 82-3-107 for confidentiality in excess of 12 months. One copy of all wireline logs and drillers time log shall be attached with this form. Submit CP-4 form with all plugged wells. Submit CP-111 form with all temporarily abandoned wells.

All requirements of the statutes, rules and regulations promulgated to regulate the oil and gas industry have been fully complied with and the statements herein are complete and correct to the best of my knowledge.

Signature JAMES T. BARVAIS
Title PRESIDENT Date 1-06-88

Subscribed and sworn to before me this 6TH day of JANUARY 1988
Notary Public Marcia L. Alterman
Date Commission Expires 2/5/90

K.C.C. OFFICE USE ONLY
 Letter of Confidentiality Attached
 Wireline Log Received
 Drillers Time Log Received
Distribution
 KCC SWD/Rep NGPA
 KGS Plug Other
(Specify)

Sec. 13 Twp. 30 Rge. 12 W



SIDE TWO

Operator Name American Petroleum Company, Inc. Lease Name McEntire Well # 1

Sec. 13 Twp. 30 Rge. 12 East West County Barber

WELL LOG

INSTRUCTIONS: Show important tops and base of formations penetrated. Detail all cores. Report all drill stem tests giving interval tested, time tool open and closed, flowing and shut-in pressures, whether shut-in pressure reached static level, hydrostatic pressures, bottom hole temperature, fluid recovery, and flow rates if gas to surface during test. Attach extra sheet if more space is needed. Attach copy of log.

Drill Stem Tests Taken Yes No
 Samples Sent to Geological Survey Yes No
 Cores Taken Yes No

Formation Description
 Log Sample

DST #1 30-60-60-90 INTERVAL 2634' TO 2665'
 TEMPERATURE 95
 IHP 1291 FHP 1270
 IFP 604 - 578 FFP 588 - 575
 ICIP 1004 FCIP 993
 RECOVERED 1.96 BW & 3,331,000 CFPD (GAS)

Name	Top	Bottom
ONAGA	2761'	
HOWARD	3208'	
TOPEKA	3365'	
HEEBNER	3718'	
LANSING	3904'	
BKC	4331'	
MISSISSIPPI	4386'	
KINDERHOOK	4429'	
VIOLA	4595'	
SIMPSON	4668'	
RDT	4732'	

DST #2 35-63-30-93 INTERVAL 2753' TO 2825'
 TEMPERATURE 98
 IHP 1320 FHP 1306
 IFP 255 - 443 FFP 381 - 464
 ICIP 1008 FCIP 1005
 RECOVERED 330 MSW & 817,000 CFPD (GAS)

DST #3 30-15-5-0 INTERVAL 2974' TO 2985'
 TEMPERATURE 97
 IHP 1493 FHP 1493
 IFP 49 - 49 FFP 49 - 49
 ICIP 49 FCIP 0
 RECOVERED 5' DRILLING MUD

DST #4 30-63-30-63 INTERVAL 3742' - 3750'
 TEMPERATURE 119
 IHP 1896 FHP 1841
 IFP 60 - 70 FFP 100 - 100
 ICIP 1440 FCIP 1435
 RECOVERED 210' OF MUDDY SALT WATER & 77,500 CFPD (GAS)

CASING RECORD <input checked="" type="checkbox"/> New <input type="checkbox"/> Used							
Report all strings set-conductor, surface, intermediate, production, etc.							
Purpose of String	Size Hole Drilled	Size Casing Set (In O.D.)	Weight Lbs/Ft.	Setting Depth	Type of Cement	#Sacks Used	Type and Percent Additives
Surface Casing	12 1/4"	8-5/8"	20#	262'	60/40 PGZ	160	2% GPJ, 3% C.C.
PRODUCTION	7 7/8"	5 1/2"	14#	3917'	COMMON & POZ MIX	300	10% SALT
PERFORATION RECORD				Acid, Fracture, Shot, Cement Squeeze Record (Amount and Kind of Material Used)			
Shots Per Foot	Specify Footage of Each Interval Perforated					Depth	
4 SPF	2784' TO 2786' (8 HOLES)			NATURAL			
TUBING RECORD				Liner Run <input type="checkbox"/> Yes <input checked="" type="checkbox"/> No			
Date of First Production		Size	Set At	Packer at			
JANUARY 5, 1988		2 7/8"	2786'	NONE			
Producing Method							
Flowing <input checked="" type="checkbox"/> Pumping <input type="checkbox"/> Gas Lift <input type="checkbox"/> Other (explain).....							
Estimated Production Per 24 Hours	Oil	Gas	Water	Gas-Oil Ratio	Gravity		
NONE	NONE bbls	1,000 MCF	8 bbls				

METHOD OF COMPLETION Production Interval

Disposition of gas: Vented Sold Used on Lease
 Open Hole Perforation Other (Specify) 2784' TO 2786'
 Dually Completed Conningled

Operator Name American Petroleum Company, Inc. Lease Name McEntire Well # 1

Sec. 13 Twp. 30 Rge. 12 East West County Barber

WELL LOG

INSTRUCTIONS: Show important tops and base of formations penetrated. Detail all cores. Report all drill stem tests giving interval tested, time tool open and closed, flowing and shut-in pressures, whether shut-in pressure reached static level, hydrostatic pressures, bottom hole temperature, fluid recovery, and flow rates if gas to surface during test. Attach extra sheet if more space is needed. Attach copy of log.

Drill Stem Tests Taken Yes No
 Samples Sent to Geological Survey Yes No
 Cores Taken Yes No

Formation Description
 Log Sample

DST #1 30-60-60-90 INTERVAL 2634' TO 2665'
 TEMPERATURE 95
 IHP 1291 FHP 1270
 IFP 604 - 578 FFP 588 - 575
 ICIP 1004 FCIP 993
 RECOVERED 1.96 BW & 3,331,000 CFPD (GAS)

Name	Top	Bottom
ONAGA	2761'	
HOWARD	3208'	
TOPEKA	3365'	
HEEBNER	3718'	
LANSING	3904'	
BKC	4331'	
MISSISSIPPI	4386'	
KINDERHOOK	4429'	
VIOLA	4595'	
SIMPSON	4668'	
RDT	4732'	

DST #2 35-63-30-93 INTERVAL 2753' TO 2825'
 TEMPERATURE 98
 IHP 1320 FHP 1306
 IFP 255 - 443 FFP 381 - 464
 ICIP 1008 FCIP 1005
 RECOVERED 330 MSW & 817,000 CFPD (GAS)

DST #3 30-15-5-0 INTERVAL 2974' TO 2985'
 TEMPERATURE 97
 IHP 1493 FHP 1493
 IFP 49 - 49 FFP 49 - 49
 ICIP 49 FCIP 0
 RECOVERED 5' DRILLING MUD

DST #4 30-63-30-63 INTERVAL 3742' - 3757'
 TEMPERATURE 119
 IHP 1896 FHP 1841
 IFP 60 - 70 FFP 100 - 100
 ICIP 1440 FCIP 1435
 RECOVERED 210' OF MUDDY SALT WATER
 & 77,500 CFPD (GAS)

CASING RECORD New Used
 Report all strings set-conductor, surface, intermediate, production, etc.

Purpose of String	Size Hole Drilled	Size Casing Set (in O.D.)	Weight Lbs/Ft.	Setting Depth	Type of Cement	#Sacks Used	Type and Percent Additives
Surface Casing	12 1/4"	8-5/8"	20#	262'	60/40 Pozz	160	2% gel., 3% c.c.
PRODUCTION	7 7/8"	5 1/2"	14#	3917'	COMMON & POZMIX	300	10% SALT

PERFORATION RECORD
 Shots Per Foot: Specify Footage of Each Interval Perforated
 Acid, Fracture, Shot, Cement Squeeze Record (Amount and Kind of Material Used) Depth

4 SPF	2784' TO 2786' (8 HOLES)	NATURAL	
-------	--------------------------	---------	--

TUBING RECORD
 Size: 2 7/8" Set At: 2786' Packer at: NONE
 Liner Run Yes No

Date of First Production: JANUARY 5, 1988
 Producing Method: Flowing Pumping Gas Lift Other (explain)

Estimated Production Per 24 Hours	Oil	Gas	Water	Gas-Oil Ratio	Gravity
	NONE	1,000	8	RELEASED	

METHOD OF COMPLETION FROM CONFIDENTIAL Production Interval

Disposition of gas: Vented Sold Used on Lease
 Open Hole Perforation Other (Specify) 2784' TO 2786'
 Dually Completed Conmingle

