

* AMENDED

SIDE ONE

STATE CORPORATION COMMISSION OF KANSAS
OIL & GAS CONSERVATION DIVISION
WELL COMPLETION OR RECOMPLETION FORM
ACO-1 WELL HISTORY
DESCRIPTION OF WELL AND LEASE

Operator: License # 5171
Name TXO Production Corp.
Address 1660 Lincoln Street - Suite 1800
City/State/Zip Denver, Colorado 80264

Purchaser VESTA ENERGY

Operator Contact Person Gary E. Wurdeman
Phone (303) 861-4246

Contractor: License # 5864
Name Lobo Drilling Company

Wellsite Geologist Ken LeBlanc
Phone

Designate Type of Completion
 New Well Re-Entry Workover
 Oil SWD Temp. Abd
 Gas Inj Delayed Comp.
 Dry Other (Core, Water Supply etc.)

If OWWO: old well info as follows:
Operator
Well Name
Comp. Date Old Total Depth

WELL HISTORY

Drilling Method:
 Mud Rotary Air Rotary Cable
12-05-88 12-13-88 12/24/88
Spud Date Date Reached TD Completion Date
5000'
Total Depth PBTD
Amount of Surface Pipe Set and Cemented at 447 feet
Multiple Stage Cementing Collar Used? Yes No
If yes, show depth set feet
If alternate 2 completion, cement circulated from feet depth to w/ SX cmt
Cement Company Name
Invoice #

API NO. 15-007-22,214
County Barber
C. SE SE Sec. 32 Twp. 33 Rge. 13 East
X West

660 Ft North from Southeast Corner of Section
660 610 Ft West from Southeast Corner of Section
(Note: Locate well in section plat below)

Lease Name Spriggs Well # B-1
Field Name Sooter Aetra Gas Area

Producing Formation Missippian
Elevation: Ground 1832' 1837' KB

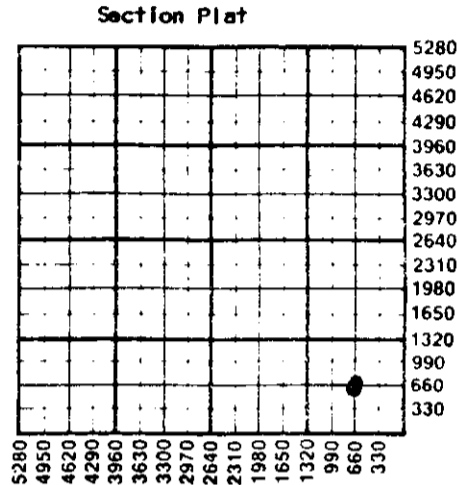

RECEIVED
STATE CORPORATION COMMISSION
CONSERVATION DIVISION
Wichita, Kansas
1-13-89
CONSERVATION DIVISION
Wichita, Kansas

WATER SUPPLY INFORMATION
Disposition of Produced Water: Disposal
Docket # Repressuring

Questions on this portion of the ACO-1 call:
Water Resources Board (913) 296-3717
Source of Water:
Division of Water Resources Permit #
 Groundwater...Ft North from Southeast Corner (Well) ...Ft West from Southeast Corner of Sec Twp Rge East West
 Surface Water 660 Ft North from Southeast Corner (Stream, pond etc) 660 Ft West from Southeast Corner Sec 20 Twp 33 Rge 13 East X West
Other (explain)
(purchased from city, R.W.D. #)

INSTRUCTIONS: This form shall be completed in triplicate and filed with the Kansas Corporation Commission, 200 Colorado Derby Building, Wichita, Kansas 67202, within 120 days of the spud date of any well. Rule 82-3-130, 82-3-107 and 82-3-106 apply. Information on side two of this form will be held confidential for a period of 12 months if requested in writing and submitted with the form. See rule 82-3-107 for confidentiality in excess of 12 months. One copy of all wireline logs and drillers time log shall be attached with this form. Submit CP-4 form with all plugged wells. Submit CP-111 form with all temporarily abandoned wells.

All requirements of the statutes, rules and regulations promulgated to regulate the oil and gas industry have been fully complied with and the statements herein are complete and correct to the best of my knowledge.

Signature Les Smith
Title Drilling and Production Engineer Date 1/11/89
Subscribed and sworn to before me this day of February 1989
Notary Public
Date Commission Expires

K.C.C. OFFICE USE ONLY
 Letter of Confidentiality Attached
 Wireline Log Received
 Drillers Timelog Received
Distribution
 KCC SWD/Rep NGPA
 KGS Plug Other (Specify)
1-13-89
Form ACO-1 (5-86)

Sec 32 Twp 33 Rge 13 E