

ORIGINAL

ORIGINAL

SIDE ONE

-00-01

STATE CORPORATION COMMISSION OF KANSAS
OIL & GAS CONSERVATION DIVISION
WELL COMPLETION FORM
ACO-1 WELL HISTORY
DESCRIPTION OF WELL AND LEASE

API NO. 15- 007-21,210-K
County Barber
C NE SW Sec. 18 Twp. 30 Rge. 13 East
1980 West
3300 Ft. North from Southeast Corner of Section
3300 Ft. West from Southeast Corner of Section
(NOTE: Locate well in section plat below.)

Operator: License # 5046
Name: Raymond Oil Company, Inc.
Address P.O. Box 48788
Wichita, KS 67201

Lease Name Rauhut Well # 1
Field Name Knackstedt
Producing Formation Viola Chert

Purchaser:
Operator Contact Person: Patrick R. Raymond
Phone (316) 267-4214

Elevation: Ground 1843 KB 1848
Total Depth 4750' PBSD

Contractor: Name: Lobo Drilling Co.
License: 5864
Wellsite Geologist: Tim Hellman

Designate Type of Completion
 New Well Re-Entry Workover
 Oil SWD Temp. Abd.
 Gas Inj Delayed Comp.
 Dry Other (Core, Water Supply, etc.)

If OMMO: old well info as follows:
Operator: Woolsey Petroleum Corp.
Well Name: #1 Rauhut
Comp. Date 8-25-81 Old Total Depth 4750'

Drilling Method:
 Mud Rotary Air Rotary Cable
09-29-89 10-01-89 10-30-89
Spud Date Date Reached TD Completion Date

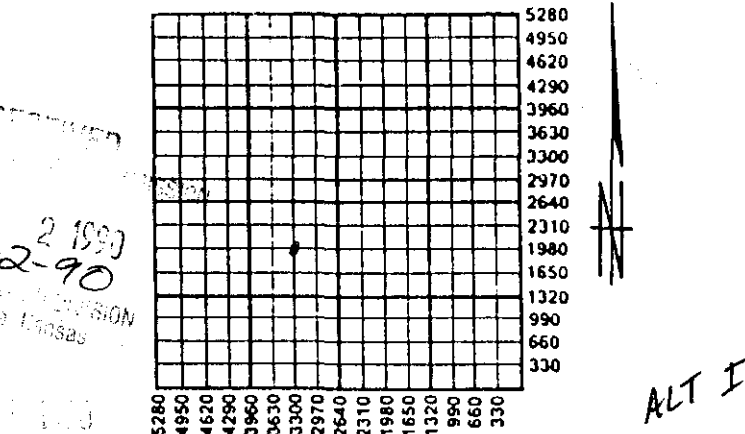

Amount of Surface Pipe Set and Cemented at 999' Feet
Multiple Stage Cementing Collar Used? Yes No
If yes, show depth set N/A Feet
If Alternate II completion, cement circulated from _____
feet depth to _____ w/ _____ sx cmt.

INSTRUCTIONS: This form shall be completed in triplicate and filed with the Kansas Corporation Commission, 200 Colorado Derby Building, Wichita, Kansas 67202, within 120 days of the spud date of any well. Rule 82-3-130, 82-3-107 and 82-3-106 apply. Information on side two of this form will be held confidential for a period of 12 months if requested in writing and submitted with the form. See rule 82-3-107 for confidentiality in excess of 12 months. One copy of all wireline logs and drillers time log shall be attached with this form. ALL CEMENTING TICKETS MUST BE ATTACHED. Submit CP-4 form with all plugged wells. Submit CP-111 form with all temporarily abandoned wells. Any recompletion, workover or conversion of a well requires filing of ACO-2 within 120 days from commencement date of such work.

All requirements of the statutes, rules and regulations promulgated to regulate the oil and gas industry have been fully complied with and the statements herein are complete and correct to the best of my knowledge.

Signature Pat Raymond
Title Vice President Date 1-31-90

Subscribed and sworn to before me this 31st day of January, 1990.
Notary Public Sharron A. Hill
Date Commission Expires 7-28-91

K.C.C. OFFICE USE ONLY
F Letter of Confidentiality Attached
C Wireline Log Received
C Drillers Timelog Received
Distribution
 KCC SWD/Rep NGPA
 KGS Plug Other
(Specify)



P1

JAN 1990

SIDE TWO

Operator Name Raymond Oil Company, Inc. Lease Name Rauhut Well # 1
 Sec. 18 Twp. 30 Rge. 13 East West
 County Barber

INSTRUCTIONS: Show important tops and base of formations penetrated. Detail all cores. Report all drill stem tests giving interval tested, time tool open and closed, flowing and shut-in pressures, whether shut-in pressure reached static level, hydrostatic pressures, bottom hole temperature, fluid recovery, and flow rates if gas to surface during test. Attach extra sheet if more space is needed. Attach copy of log.

Drill Stem Tests Taken Yes No
 (Attach Additional Sheets.)
 Samples Sent to Geological Survey Yes No
 Cores Taken Yes No
 Electric Log Run Yes No
 (Submit Copy.)

Formation Description
 Log Sample
 Name Top Bottom

DST #1 (Viola) 4556-4607 (straddle) 45-60-45-60
 Recd 360' GCM & 2740' GSW. IFP 294#-1125#,
 ISIP 1661#, FFP 1456#-1459#, FSIP 1661#.
 BHT 130° F. DST non-conclusive because
 of lower packer failing to hold.

CASING RECORD <input type="checkbox"/> New <input type="checkbox"/> Used							
Report all strings set-conductor, surface, intermediate, production, etc.							
Purpose of String	Size Hole Drilled	Size Casing Set (In O.D.)	Weight Lbs./ft.	Setting Depth	Type of Cement	# Sacks Used	Type and Percent Additives
Surface Pipe	12 1/2"	8-5/8"		999'		500	
Production	7-7/8"	5 1/2"	15.5#	4745'	60/40poz	175	
PERFORATION RECORD				Acid, Fracture, Shot, Cement Squeeze Record (Amount and Kind of Material Used) Depth			
Shots Per Foot	Specify footage of Each Interval Perforated						
2	4564-4594			300 gal 10% acetic acid + 1200 gal Frac w/20,000 # SP & 650 bbl fluid			
TUBING RECORD				Liner Run <input type="checkbox"/> Yes <input checked="" type="checkbox"/> No			
	Size	Set At	Packer At				
	2 1/2"	4642	4642				
Date of First Production	Producing Method <input type="checkbox"/> Flowing <input checked="" type="checkbox"/> Pumping <input type="checkbox"/> Gas Lift <input type="checkbox"/> Other (Explain)						
October 14, 1989							
Estimated Production Per 24 Hours	Oil	Bbls.	Gas TSTM	Mcf	Water	Bbls.	Gas-Oil Ratio Gravity
	4				17		

Disposition of Gas: Vented Sold Used on Lease (If vented, submit ACD-18.)
 METHOD OF COMPLETION: Open Hole Perforation Dually Completed Commingled
 Other (Specify) _____
 Production Interval _____