

STATE OF KANSAS
STATE CORPORATION COMMISSION

Give All Information Completely
Make Required Affidavit
Mail or Deliver Report to:
Conservation Division
State Corporation Commission
211 No. Broadway
Wichita, Kansas

WELL PLUGGING RECORD

BARBER County, Sec. 34 Twp. 34s. Rge. 13w (E) (W) X
Location as "NE/CNWxSWx" or footage from lines NE NE SW
Lease Owner PETROLEUM, INC.
Lease Name ROBERTS Well No. 1
Office Address ROUTE 2, GREAT BEND, KANSAS
Character of Well (completed as Oil, Gas or Dry Hole) GAS
Date well completed JUNE 29, 19 56
Application for plugging filed AUGUST 16, 19 62
Application for plugging approved SEPTEMBER 5, 19 62
Plugging commenced AUGUST 28, 19 62
Plugging completed AUGUST 31, 19 62
Reason for abandonment of well or producing formation DEPLETION OF PRODUCIBLE FORMATIONS.
If a producing well is abandoned, date of last production 10-24 19 61
Was permission obtained from the Conservation Division or its agents before plugging was commenced? YES

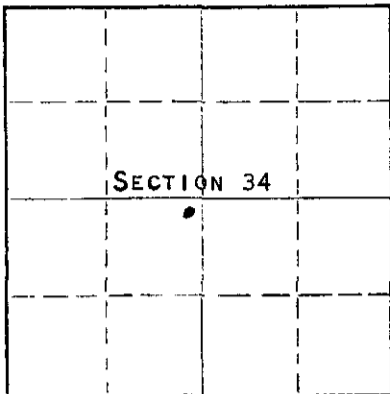

Locate well correctly on above Section Plat

Name of Conservation Agent who supervised plugging of this well HERMAN JUSTICE
Producing formation ELGIN Depth to top 3650 Bottom Total Depth of Well 4910 Feet
Show depth and thickness of all water, oil and gas formations.

OIL, GAS OR WATER RECORDS

CASING RECORD

FORMATION	CONTENT	FROM	TO	SIZE	PUT IN	PULLED OUT
ELGIN	GAS & WATER	3662	3672	8-5/8"	265'	NONE
		3665	3669	4-1/2"	3800'	3222'

Describe in detail the manner in which the well was plugged, indicating where the mud fluid was placed and the method or methods used in introducing it into the hole. If cement or other plugs were used, state the character of same and depth placed, from feet to feet for each plug set.

PLUGGED BACK T.D. 3725.50'

FILLED HOLE WITH CRUSHED ROCK TO 3640. PLACED 5 SACKS CEMENT ONTO CRUSHED ROCK. MADE SOLID ROCK BRIDGE AT 250'. PLACED 20 SACKS CEMENT ONTO ROCK BRIDGE. MUDDED UP WITH HEAVY MUD TO 30', FOLLOWED BY 10 SACKS CEMENT TO BASE OF WELL CELLAR.

RECEIVED
STATE CORPORATION COMMISSION
9-13-62
SEP 13 1962

CONSERVATION DIVISION
Wichita, Kansas

(If additional description is necessary, use BACK of this sheet)

Name of Plugging Contractor SOUTHWEST CASING PULLING CO., INC.
Address BOX 364, GREAT BEND, KANSAS

STATE OF KANSAS, COUNTY OF BARTON, ss.
DON SEARLE (employee of owner) or (owner or operator) of the above-described well, being first duly sworn on oath, says: That I have knowledge of the facts, statements, and matters herein contained and the log of the above-described well as filed and that the same are true and correct. So help me God. DON SEARLE, DIST. PROD. SUPT.
(Signature) *Don Searle*
ROUTE 2, GREAT BEND, KANSAS (Address)

SUBSCRIBED AND SWORN to before me this 10TH day of SEPTEMBER, 19 62

Arthur J. Miles
Notary Public.

My commission expires APRIL 14, 1963.

WELL LOG

COMPANY **Petroleum, Inc.**

SEC. 34 T. 34S R. 13W

FARM **ROBERTS** NO. 1

LOC. **NE NE SW**
2310' FSL
2310' FWL

TOTAL DEPTH **4910'**

COUNTY **Barber**

COMM. **June 4, 1956** COMP. **June 21, 1956**

CONTRACTOR **Garvey Drilling Company**

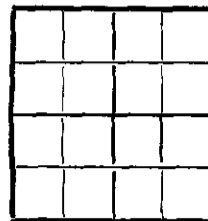

CASING **8-5/8" @ 265' w/225 sax**
4-1/2" @ 3801' w/100 sax

ELEVATION **1522' DF**

PRODUCTION **Elgin**

FIGURES INDICATE BOTTOM OF FORMATIONS

40	Surface Soil
185	Red Bed
265	Red Bed & Red Rock
780	Red Bed
1100	Red Bed & Shale
1110	Anhydrite
1285	Shale
1305	Salt
1700	Shale & Shells
2245	Lime & Shale
2710	Lime
3702	Lime & Shale
3800	Lime, Sand & Shale
3859	Sand & Shale
4096	Shale & Lime
4303	Lime
4375	Lime & Shale
4572	Lime
4838	Lime & Shale
4910	Lime

Sample Tops

Elgin	3650 (-2126)
Heebner	3891 (-2367)
Douglas	3908 (-2384)
Lansing	4073 (-2549)
Kansas City	4393 (-2869)
Mississippi	4790 (-3266)

RTD 4910'

RECEIVED
STATE CORPORATION COMMISSION
SEP 13 1962
CONSERVATION DIVISION
Wichita, Kansas

State of KANSAS }
County of SEDGWICK } SS:

I, Cullen Thomas of Petroleum, Inc.

upon oath state that the above and foregoing is a true and correct copy of the log of the ROBERTS #1 well

Cullen Thomas

Subscribed and sworn to before me this 29th day of June 19 56

My Commission Expires: September 2, 1959

Frances Sloan
NOTARY PUBLIC

FRANCES SLOAN, Notary Public
My Commission expires Sept. 2, 1959