

WELL PLUGGING RECORD

Give All Information Completely
Make Required Affidavit
Mail or Deliver Report to:
Conservation Division
State Corporation Commission
800 Bitting Building
Wichita, Kansas

Harper County, Sec. 21 Twp. 33S Rge. (E) 7 (W)

Location as "NE/CNW*SW*" or footage from lines _____
Lease Owner Jones, Shelburne & Farmer, Inc.
Lease Name Elliott Well No. 1
Office Address Russell, Kansas
Character of Well (completed as Oil, Gas or Dry Hole) Dry
Date well completed 3-9 19 55
Application for plugging filed 3-9 19 55
Application for plugging approved 3-9 19 55
Plugging commenced 3-9 19 55
Plugging completed 3-9 19 55
Reason for abandonment of well or producing formation Dry

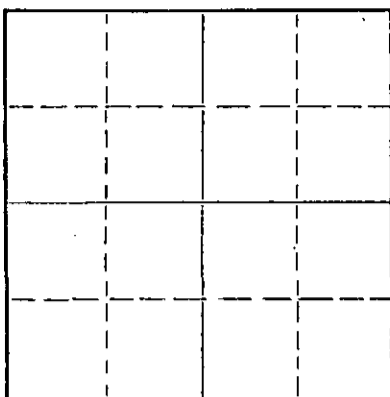

Locate well correctly on above
Section Plat

If a producing well is abandoned, date of last production _____ 19____
Was permission obtained from the Conservation Division or its agents before plugging was commenced? Yes

Name of Conservation Agent who supervised plugging of this well Ruel Durkee
Producing formation _____ Depth to top _____ Bottom _____ Total Depth of Well 5187 Feet
Show depth and thickness of all water, oil and gas formations.

OIL, GAS OR WATER RECORDS

CASING RECORD

FORMATION	CONTENT	FROM	TO	SIZE	PUT IN	PULLED OUT
				8-5/8	240	None

Describe in detail the manner in which the well was plugged, indicating where the mud fluid was placed and the method or methods used in introducing it into the hole. If cement or other plugs were used, state the character of same and depth placed, from _____ feet to _____ feet for each plug set.

- Hole filled to 150 feet with heavy mud
- Halliburton plug pushed to 210' and 1/2 sack hulls
- 20 sacks cement spotted on top of plug through drill pipe by Halliburton
- Hole filled to 40 feet with heavy mud
- Second Halliburton plug pushed to 40 feet
- 1/2 sack of hulls dumped on top of plug
- Hole filled to top with 10 sacks cement

3-22-55
3-22-55
3-22-55
CONSERVATION DIVISION
WICHITA, KANSAS

(If additional description is necessary, use BACK of this sheet)

Name of Plugging Contractor Jones, Shelburne & Farmer, Inc.
Address Russell, Kansas

STATE OF Kansas, COUNTY OF Russell, ss.
John O. Farmer (employee of owner) or (owner or operator) of the above-described well, being first duly sworn on oath, says: That I have knowledge of the facts, statements, and matters herein contained and the log of the above-described well as filed and that the same are true and correct. So help me God.

(Signature) John O. Farmer
Russell, Kansas (Address)

SUBSCRIBED AND SWORN TO before me this 15th day of March, 19 55
Leicester L. Lacey Notary Public.

My commission expires October 11, 1958

PLUGGING
FILE SEC 21 T 33S R 7W
BOOK PAGE 103 LINE 39

OPERATOR Jones, Shelburne & Farmer, Inc.

FORMATION RECORD

ADDRESS Russell, Kansas

Give detailed description and thickness of all formations drilled through, contents of sand, whether dry, water, oil or gas.

COUNTY Harper, SEC. 21, TWP. 33S, RGE. 7W
 COMPANY OPERATING Jones, Shelburne & Farmer, Inc.
 OFFICE ADDRESS Russell, Kansas
 FARM NAME Elliott WELL NO. 1
 DRILLING STARTED 2-10-55, DRILLING FINISHED 3-9-55
 DATE OF FIRST PRODUCTION _____ COMPLETED _____
 WELL LOCATED SW 1/4, SE 1/4, NW 1/4, North of South
 Line and _____ ft. East of West Line of Quarter Section
 Elevation (Relative to sea level) DERRICK FLOOR 1318 GROUND 1313
 CHARACTER OF WELL (Oil, gas or dryhole) Dry Hole

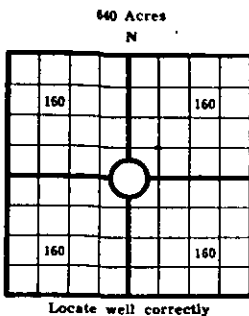

Locate well correctly

OIL OR GAS SANDS OR ZONES

Name	From	To	Name	From	To
1			4		
2			5		
3			6		

Perforating Record if Any

Shot Record

Formation	From	To	No. of Shots	Formation	From	To	Size of Shot

CASING RECORD

Amount Set						Amount Pulled				Packer Record	
Size	Wt.	Thds.	Make	Ft.	In.	Ft.	In.	Size	Length	Depth Set	Make
8-5/8				246							

Liner Record: Amount _____ Kind _____ Top _____ Bottom _____

CEMENTING AND MUDDING

Size	Amount Set		Sacks Cement	Chemical		Method of Cementing	Amount	Mudding Method	Results (See Note)
	Ft.	In.		Gal.	Make				
8-5/8	246		200						

Note: What method was used to protect sands if outer strings were pulled?

NO. _____ Were bottom hole plugs used? If so, state kind, depth set and results obtained

TOOLS USED

Rotary Tools were used from _____ feet to _____ feet. Cable tools were used from _____ feet to _____ feet. _____ and from _____ feet to _____ feet, and from _____ feet to _____ feet.

INITIAL PRODUCTION TEST

Describe initial test whether by flow through tubing or casing or by pumping _____

Amount of production _____ bbls. Size of choke, if any _____ Length of test _____ Water

Production _____ bbls. Gravity of oil _____ Type of Pump if pump is used, describe _____

Formation	Top	Bottom	Formation	Top	Bottom
Sand	0	40	Mississippi	4585	4820
Shale shell & clay	40	75	Shale & lime	4820	4968
Sand & shale	75	105	Simpson	4968	5050
Sand & shale	105	135	Shale	5050	5075
Shale shells & sand strands	135	225	Shale & sand chert	5075	5085
Shale	225	775	Shale	5085	5105
Shale & shells	775	1230	Shale sand & chert	5105	5125
Anhydrite?	1230	1280	Sand & Arbuckle	5125	5145
Lime & shale	1280	2435	Arbuckle	5145	5187
Shale & lime	2435	3000	TOPS:		
Sandy lime & shale	3000	3150	Elevation	1320	RB
Sand Lime & Shale	3150	3170	Lansing	3922	
Shale & lime	3170	3345	Base of KC	4150	
Lime & shale	3345	3390	Base of Fort Scott	4384	
Sandy lime & Shale	3390	3520	Mississippi	4527	
Shale sandy	3520	3580	Kinderhook	4818	
Lime	3580	3715	Chattanooga	4901	
Shale & lime	3715	3770	Viola	4925	
Sandy lime & shale	3770	4010	Simpson	4858	
Shale & lime	4010	4180	Arbuckle	5137	
Lime	4180	4440	T.D.	5187	
Lime & shale	4440	4495			
Shale	4495	4520			
Sand Shale & Chert	4520	4540			
Chert & shale	4540	4550			
Mississippi	4550	4585			
Mississippi					
Lime & chert					

I, the undersigned, being first duly sworn upon oath, state that this well record is true, correct and complete according to the records of this office and to the best of my knowledge and belief.

John H. Farmer Vice-President
 Name and title of representative of company

Subscribed and sworn to before me this 15th day of March, 1955.

My Commission expires 10-11-58
Lucille Kennedy
 Notary Public

FARM NAME Elliott WELL NO. 1 COUNTY Harper SEC. 21, TWP. 33S, RGE. 7W

PLUGGING
 AT SEC 21/33S/7W
 10/23/59