

Give All Information Completely
Make Required Affidavit
Mail or Deliver Report to:
Conservation Division
State Corporation Commission
212 North Market, Insurance Bldg.
Wichita, Kansas

R

15-077-00080-00-00

WELL PLUGGING RECORD

NORTH

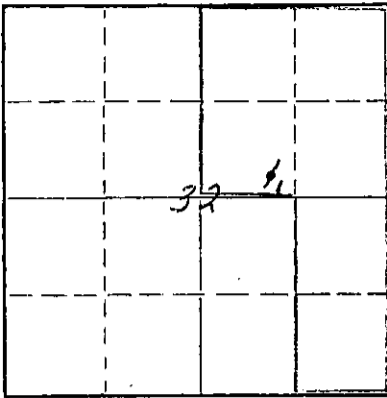

Locate well correctly on above Section Plat

Harper County, Sec. 32 Twp. 34S Rge. (E) 6 (W)
Location as "NE/CNW&SW" or footage from lines. SE/4 SW/4 NE/4
Lease Owner Skelly Oil Company
Lease Name M. M. Burnett Well No. 1
Office Address Box 1650, Tulsa, Oklahoma
Character of Well (completed as Oil, Gas or Dry Hole) Dry Hole
Date well completed January 17, 19 61
Application for plugging filed January 16, 19 61
Application for plugging approved January 20, 19 61
Plugging commenced January 17, 19 61
Plugging completed January 17, 19 61
Reason for abandonment of well or producing formation Dry Hole

If a producing well is abandoned, date of last production 19
Was permission obtained from the Conservation Division or its agents before plugging was commenced? Yes (verbally)

Name of Conservation Agent who supervised plugging of this well Mr. Fred Hampel
Producing formation None Depth to top Bottom Total Depth of Well 5349 Feet
Show depth and thickness of all water, oil and gas formations.

OIL, GAS OR WATER RECORDS

CASING RECORD

FORMATION	CONTENT	FROM	TO	SIZE OD	PUT IN	PULLED OUT
Simpson Sand	Dry	5280'	5349'	8-5/8"	334'	None

Describe in detail the manner in which the well was plugged, indicating where the mud fluid was placed and the method or methods used in introducing it into the hole. If cement or other plugs were used, state the character of same and depth placed, from feet to feet for each plug set.

Mud laden fluid	5349' to 300'
Rock bridge	300' to 290'
15 sacks of cement	290' to 255'
Mud	255' to 40'
Rock bridge	40' to 30'
10 sacks of cement	30' to 6'
Surface soil	6' to Surface

RECEIVED
STATE CORPORATION COMMISSION

FEB 1961

CONSERVATION DIVISION
Wichita, Kansas

(If additional description is necessary, use BACK of this sheet)
Name of Plugging Contractor Claude Wentworth Drilling Co., Inc.
Address 2701 East 15th, Tulsa, Oklahoma

STATE OF Kansas, COUNTY OF Reno, ss.
H. E. Wamsley (employee of owner) or (owner of property) of the above-described well, being first duly sworn on oath, says: That I have knowledge of the facts, statements, and matters herein contained and the log of the above-described well as filed and that the same are true and correct. So help me God.

(Signature) [Signature]
Box 391, Hutchinson, Kansas (Address)

SUBSCRIBED AND SWORN TO before me this 7th day of February, 19 61

My commission expires April 7, 1963 [Signature] Notary Public.



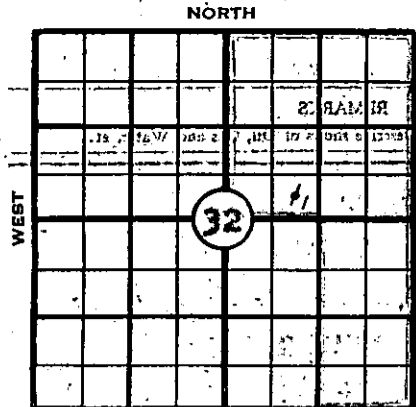

RECORD OF FORMATIONS

SKELLY OIL COMPANY

MOTION TOP FORMATION

Well Record

Lease Name and No. **D. M. Burnett Lse. #50728** Well No. **1**
 Lease Description **NE/4 and E/2 SE/4 Section 32-340-6W,**
Warner County, Kansas (240 Acres)

Location Staked **December 9, 1960** by **P. L. Die**
1650 feet from **Co. 1** line **2310** feet from **north** line
 of **Sec. 32**

Elev. **KB** **1364'**
 D.F.

Elev. G.L. **1357'**

Drilling Contractor **Glaude Wentworth Drilling Co., Inc.**

Work Com'd. **Dec. 14, 1960** Drilling Com'd. **Dec. 15, 1960** Reached Total Depth **Jan. 16, 1961**

Rotary Drilling from **Surf** to **5340'** Cable Tool Drilling from _____ to _____

Well Completed **January 17, 1961** Total Depth **5340'** P.B.T.D.

Initial Completion Test _____ 19____

Pressures: F.C.P. _____ R.T.P. _____ S.I.C.P. _____ S.I.T.P. _____

PRODUCING FROM

FORMATION	thru	OPEN HOLE PERFORATIONS	TOP	BOTTOM	Total No. Shots
DRY HOLE					
FORMATION	thru	OPEN HOLE PERFORATIONS	TOP	BOTTOM	Total No. Shots
FORMATION	thru	OPEN HOLE PERFORATIONS	TOP	BOTTOM	Total No. Shots
FORMATION	thru	OPEN HOLE PERFORATIONS	TOP	BOTTOM	Total No. Shots

CASING RECORD

STRINGS	SIZE	WHERE SET (Depth)	CEMENTING RECORD		All Measurements were taken from top of Derrick Floor which is 9 ft. from top of surface casing
			Sacks Used	Top Cem't Bh'd. Cas'g.	
Surface	8-5/8"	343'	225	Surface	
Intermediate					
Production					
Liner					Top Liner: _____

Size	Wt.	Thds.	Kind	Cond.	Jts.	LEFT IN				PULLED OUT			
						LTM		WTM		LTM		WTM	
						Feet	In.	Feet	In.	Feet	In.	Feet	In.
8-5/8"	22.7	91	Arco SW R3 A	A	9	334	0	334	0				

SIGNIFICANT GEOLOGICAL FORMATIONS

SOURCE NAME	TOP	BOTTOM	GAS		OIL		REMARKS
			FROM	TO	FROM	TO	
Elgin Sand	3245'						RECEIVED STATE CORPORATION COMMISSION FEB 9 1961 2-8-61 CONSERVATION DIVISION Wichita, Kansas
Heebner Shale	3364'						
Stalnaker Sand	3744'						
Kansas City	4045'						
Harston	4370'						
Cherokee	4552'						
Mississipi	4726'						
Kinderhook	5165'						
Viola Lims	5242'						
Simpson Sand	5280'						

TREATMENT RECORD

DATE	TYPE TREATMENT	INTERVAL TREATED	AMOUNT OF TREATMENT

WORKOVER RECORD

TYPE WORK	DATE COM'D.	DATE COMP.	Plugged back or Deepened		PROD. BEFORE	PROD. AFTER
			FROM	TO		

5270	5270	5270	5270
5270	5270	5270	5270

5270	5270	5270	5270
5270	5270	5270	5270
5270	5270	5270	5270
5270	5270	5270	5270

5270	5270	5270	5270
5270	5270	5270	5270
5270	5270	5270	5270
5270	5270	5270	5270

5270	5270	5270	5270
5270	5270	5270	5270
5270	5270	5270	5270
5270	5270	5270	5270

5270	5270	5270	5270
5270	5270	5270	5270
5270	5270	5270	5270
5270	5270	5270	5270

5270	5270	5270	5270
5270	5270	5270	5270
5270	5270	5270	5270
5270	5270	5270	5270

5270	5270	5270	5270
5270	5270	5270	5270
5270	5270	5270	5270
5270	5270	5270	5270

5270	5270	5270	5270
5270	5270	5270	5270
5270	5270	5270	5270
5270	5270	5270	5270

5270	5270	5270	5270
5270	5270	5270	5270

Sand, light gray to buff,
medium grained, part
slightly dolomitic, poor
to fair porosity, small
show free oil

5279 5287

Top Simpson Sand 5280'

Sand, white, medium grained,
poor porosity, no shows

5287 5290

DRILL STEM TEST NO. 4
(5282'-5290' (28') open 50
minutes, good blow air through-
out test, recovered 75'
watery mud, 180' muddy salt
water, 360' salt water, IENP-
2160' 20 mins., IFF-128',
FFP-315', FLHP-2130' 20 mins.
Ran Schlumberger Micro-Latero-
log and Laterolog Surveys

Sand

5290 5349

TOTAL DEPTH

5349'

Total Depth Reached 1/16/61

As there were no commercial shows of oil or gas found in drilling and testing through the Simpson Sand, regular authority was granted to plug and abandon the well.

On January 17, 1961, plugged the well as follows:

Mud laden fluid	5349' to 300'
Rock bridge	300' to 290'
15 sacks cement	290' to 255'
Mud	255' to 40'
Rock bridge	40' to 30'
10 sacks cement	30' to 6'
Surface soil	6' to Surface

Plugged and abandoned 1/17/61.

<u>SLOPE TEST DATA</u>	
<u>DEPTH</u>	<u>ANGLE IN DEGREES</u>
150'-450'	0
592'	1/2
1522'	1/2
2000'	1/2
2500'	1/2
2980'	1-1/2
3319'	2
3905'	1/4
4230'	1/2