

15-007-10035-0000

STATE OF KANSAS
STATE CORPORATION COMMISSION

WELL PLUGGING RECORD

Give All Information Completely
Make Required Affidavit
Mail or Deliver Report to:
Conservation Division
State Corporation Commission
800 Bittling Building
Wichita, Kansas

BARBER County. Sec. 29 Twp. 31 Rge. 11 ~~W~~ W (W)

Location as "NE/CNW&SW" or footage from lines SW NW NW
Lease Owner PETROLEUM, INC. (PURCHASED FROM MAX BEREN)
Lease Name WHELAN Well No. 1
Office Address ROUTE #2, GREAT BEND, KANSAS
Character of Well (completed as Oil, Gas or Dry Hole) GAS
Date well completed OCTOBER 28 19 47
Application for plugging filed OCTOBER 2 19 56
Application for plugging approved OCTOBER 4 19 56
Plugging commenced OCTOBER 1 19 56
Plugging completed OCTOBER 8 19 56

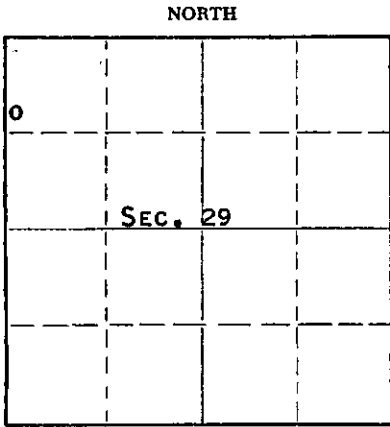

Locate well correctly on above
Section Plat

Reason for abandonment of well or producing formation
DEPLETION OF PRODUCIBLE ZONES
If a producing well is abandoned, date of last production JULY 19 56
Was permission obtained from the Conservation Division or its agents before plugging was commenced? YES

Name of Conservation Agent who supervised plugging of this well M. A. RIVES, PRATT, KANSAS
Producing formation DOUGLAS Depth to top Bottom Total Depth of Well 4393 Feet
Show depth and thickness of all water, oil and gas formations.

OIL, GAS OR WATER RECORDS

CASING RECORD

FORMATION	CONTENT	FROM	TO	SIZE	PUT IN	PULLED OUT
MISSISSIPPI	OIL & WATER	4346'	4393'	8-5/8"	158'	NONE
DOUGLAS	GAS & WATER	3630'	3638'	5 1/2"	4346'	3000'

Describe in detail the manner in which the well was plugged, indicating where the mud fluid was placed and the method or methods used in introducing it into the hole. If cement or other plugs were used, state the character of same and depth placed, from feet to feet for each plug set.

(PLUGGED BACK TO 3687' AFTER OIL ZONE DEPLETED)

FILLED HOLE WITH CRUSHED ROCK FROM 3687' TO 3620', AND PLACED 5 SACKS CEMENT ON TOP OF ROCK. MUDDING UP TO 200' AND PLACED SOLID ROCK BRIDGE ON TOP OF MUD. PLACED 25 SACKS CEMENT ON TOP OF ROCK BRIDGE AND MUDDING UP TO 30'. MADE SOLID ROCK BRIDGE AT 30' AND FILLED HOLE TO BASE OF WELL CELLAR WITH 10 SACKS CEMENT.

RECEIVED
STATE CORPORATION COMMISSION
OCT 20 1956
10-20-56
CONSERVATION DIVISION
Wichita, Kansas

(If additional description is necessary, use BACK of this sheet)

Name of Plugging Contractor MORGAN WELL PLUGGING SERVICE
Address 102 WEST 18TH STREET, HUTCHINSON, KANSAS

STATE OF KANSAS, COUNTY OF BARTON, ss.
DON SEARLE (employee of owner) or (owner or operator) of the above-described

well, being first duly sworn on oath, says: That I have knowledge of the facts, statements, and matters herein contained and the log of the above-described well as filed and that the same are true and correct. So help me God.

(Signature) Don Searle

ROUTE #2, GREAT BEND, KANSAS
(Address)

SUBSCRIBED AND SWORN TO before me this 16TH day of OCTOBER, 19 56

Zed T. Brown
Notary Public.

My commission expires JULY 11, 1960

PLUGGING
FILE SEC. 29 T. 31 R. 11 W
BOOK PAGE 104 LINE 29

DRILLERS LOG

Company: Glenn W. Peel Oil Producer,
Max Beren

Sec. 29, Twp. 31S, Rge 11W
SW NW NW

Farm Whelan Well No. 1

County: Barber, Kansas

Total Depth: 4393'

Conn: 9-20-47; Comp: 10-28-47
Contractor: Glenn Peel Drilling Co., Inc.

Elevation

Production: Minimum Well

Casing: 158' 8 5/8" Cem. 0 to 4349' - Rotary
4346' 5 1/2" Cem. 4349' to 4393' - Cable Tools

Figures below indicate bottom of formations

Sand and shale	0 - 40
Shale and shells	159
Red bed, shale & shells	640
Shale and shells	1575
Lime and shale	1760
Anhydrite & lime	1880
Lime and shale	2110
Lime w/shale streaks	2225
Shale and shells	2510
Lime w/shale streaks	2595
Shale and shells	2820
Shale	2890
Lime	3180
Lime w/cherty streaks	3195
Lime	3225
Lime w/shale streaks	3750
Sand and lime	3760
Lime and sand	3795
Lime and shale	3970
Broken lime	4045
Lime w/shale streaks	4110
Lime	4300
Shale	4338
Sand	4344
Mississippi lime	4349
T. D. for Rotary	4349

Cable Tools:

Top Mississippi Lime (D. F.) - 4342

Chat (show gas)	4368
Chat (Increase oil)	4389
Shot with 30 qts. N. G.	
Chat	4391
Sand	4393
P. B. to 4391	
T. D. for Cable Tools	4393

This is to certify that, to the best of our knowledge, the above information is true and correct.

GLENN PEEL DRILLING CO., INC.

By J. B. Andrews

Subscribed and sworn to before me this 22nd day of January, 1948.

Marian M. Herbert

My commission expires June 4, 1951.

PLUGGING	
FILE SEC. 29 T. 31 R. 11W	
BOOK PAGE 104 LINE 29	

COPY

DO NOT WRITE IN THESE SPACES
OCT 20 1950
10-20-50
CONSERVATION DIVISION
Wichita, Kansas