

FOR KCC USE:

FORM C-1 7/91

FORM MUST BE TYPED

FORM MUST BE SIGNED

ALL BLANKS MUST BE FILLED

EFFECTIVE DATE: 4-13-99

State of Kansas
NOTICE OF INTENTION TO DRILL

Must be approved by the K.C.C. five (5) days prior to commencing well.

DISTRICT # 1
SGA? Yes No

Expected Spud Date April 12, 1999
month day year

210' Spot
120' E of SW NE NE Sec 32 Twp 33 S, Rg 13 East
West

OPERATOR: License # 09026
Name: Clark Exploration
Address: 75 Falcon Hills Drive
City/State/Zip: Highland Ranch, CO 80126
Contact Person: Douglas H. McGinness, II
Phone: (316) 269-9052

990 feet from South North line of Section
1200 feet from East West line of Section
IS SECTION REGULAR IRREGULAR?

(NOTE: Locate well on the Section Plat on Reverse Side)
County: Barber

Lease Name: Clark Ranch Well #: 1
Field Name: Aetna

Is this a Prorated/Spaced Field? yes no
Target Formation(s): Synderville Sand & Miss

Nearest lease or unit boundary: 330
Ground Surface Elevation: 1826 feet MSL

Water well within one-quarter mile: yes no
Public water supply well within one mile: yes no

Depth to bottom of fresh water: 100
Depth to bottom of usable water: 180

Surface Pipe by Alternate: X 1 2
Length of Surface Pipe Planned to be set: 240

Length of Conductor pipe required: N/A
Projected Total Depth: 5100 5100

Formation at Total Depth: Mississippi
Water Source for Drilling Operations:

... well farm pond other

CONTRACTOR: License #: 5929
Name: Duke Drilling Company, Inc.

Well Drilled For: Well Class: Type Equipment:
Oil Enh Rec Infield Mud Rotary
X Gas Storage Pool Ext. Air Rotary
OWO Disposal Wildcat Cable
Seismic; # of Holes Other

If OWO: old well information as follows:
Operator:
Well Name:
Comp. Date: Old Total Depth

Directional, Deviated or Horizontal wellbore? yes no
If yes, true vertical depth:
Bottom Hole Location:

Will Cores Be Taken? yes no
If yes, proposed zone:

AFFIDAVIT

The undersigned hereby affirms that the drilling, completion and eventual plugging of this well will comply with K.S.A. 55-101, et. seq.

It is agreed that the following minimum requirements will be met:

1. Notify the appropriate district office prior to spudding of well;
2. A copy of the approved notice of intent to drill shall be posted on each drilling rig;
3. The minimum amount of surface pipe as specified below shall be set by circulating cement to the top; in all cases surface pipe shall be set through all unconsolidated materials plus a minimum of 20 feet into the underlying formation;
4. If the well is dry hole, an agreement between the operator and the district office on plug length and placement is necessary prior to plugging;
5. The appropriate district office will be notified before well is either plugged or production casing is cemented in;
6. IF AN ALTERNATE II COMPLETION, PRODUCTION PIPE SHALL BE CEMENTED FROM BELOW ANY USABLE WATER TO SURFACE WITHIN 120 DAYS OF SPUD DATE. IN ALL CASES, NOTIFY DISTRICT OFFICE PRIOR TO ANY CEMENTING.

I hereby certify that the statements made herein are true and to the best of my knowledge and belief.

Date: 4/7/99 Signature of Operator or Agent: [Signature] Title: Agent

FOR KCC USE:
 API # 15- 007-225960000
 Conductor pipe required NONE feet
 Minimum surface pipe required 200 feet per Alt. (1) X
 Approved by: JK 4-8-99
 This authorization expires: 10-8-99
 (This authorization void if drilling not started within 6 months of effective date.)
 Spud date: Agent:

RECEIVED
KANSAS CORPORATION COMMISSION

APR 07 1999
4-7-99
CONSERVATION DIVISION
WICHITA, KS

32
33
13W

- REMEMBER TO:
- File Drill Pit Application (form CDP-1) with Intent to Drill;
 - File Completion Form ACO-1 within 120 days of spud date;
 - File acreage attribution plat according to field proration orders;
 - Notify appropriate district office 48 hours prior to workover or re-entry;
 - Submit plugging report (CP-4) after plugging is completed;
 - Obtain written approval before disposing or injecting salt water.

IN ALL CASES PLOT THE INTENDED WELL ON THE PLAT BELOW

PLAT OF ACREAGE ATTRIBUTABLE TO A WELL IN A PRORATED OR SPACED FIELD

If the intended well is in a prorated or spaced field, please fully complete this side of the form. If the intended well is in a prorated or spaced field complete the plat below showing that the well will be properly located in relationship to other wells producing from the common source of supply. Please show all the wells within 1 mile of the boundaries of the proposed acreage attribution unit for gas wells and within 1/2 mile of the boundaries of the proposed acreage attribution unit for oil wells.

API NO. 15- _____
OPERATOR _____
LEASE _____
WELL NUMBER _____
FIELD _____

LOCATION OF WELL: COUNTY _____
_____ feet from south/north line of section
_____ feet from east/west line of section
SECTION _____ TWP _____ RG _____

NUMBER OF ACRES ATTRIBUTABLE TO WELL _____
QTR/QTR/QTR OF ACREAGE _____

IS SECTION _____ REGULAR or _____ IRREGULAR
IF SECTION IS IRREGULAR, LOCATE WELL FROM NEAREST CORNER BOUNDARY.
Section corner used: _____ NE _____ NW _____ SE _____ SW

PLAT

(Show location of the well and shade attributable acreage for prorated or spaced wells.)
(Show footage to the nearest lease or unit boundary line.)

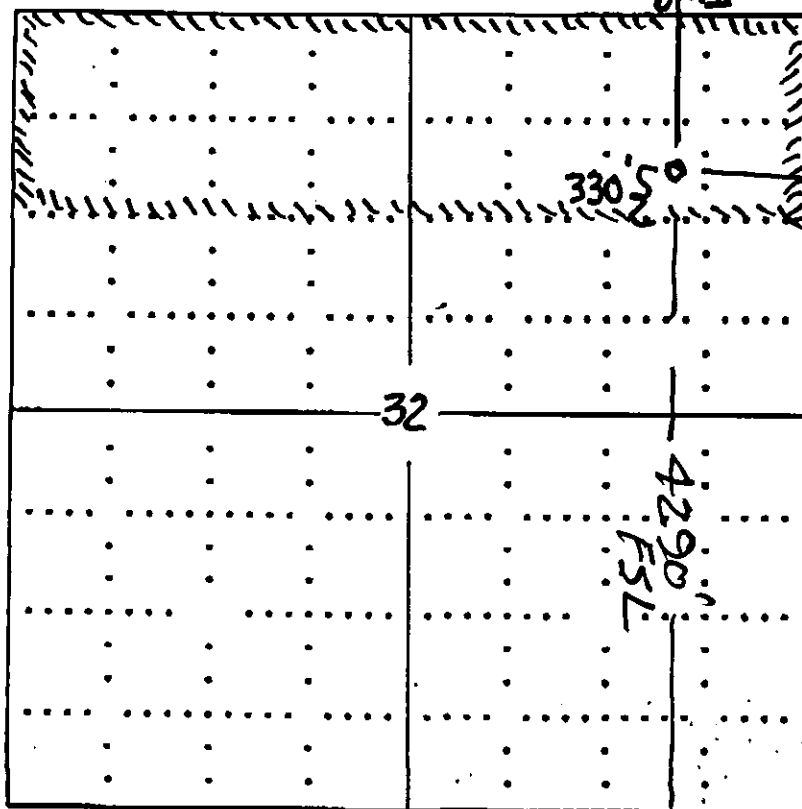

RECEIVED
KANSAS CORPORATION COMMISSION
APR 07 1999
CONSERVATION DIVISION
WICHITA, KS

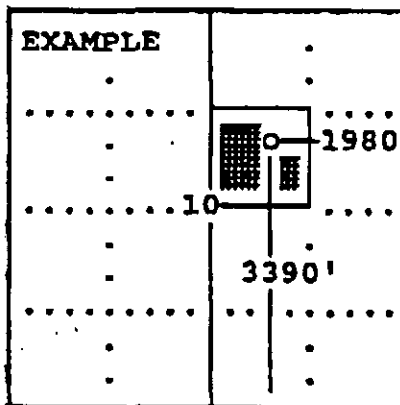

SEWARD CO.

In plotting the proposed location of the well, you must show:

- 1) The manner in which you are using the depicted plat by identifying section lines, i.e. 1 section, 1 section with 8 surrounding sections, 4 sections, etc.;
- 2) the distance of the proposed drilling location from the section's south/north and east/west; and
- 3) the distance to the nearest lease or unit boundary line.