

For KCC Use:  
 Effective Date: 4-4-2001  
 District # 2  
 SGA?  Yes  No

KANSAS CORPORATION COMMISSION  
 OIL & GAS CONSERVATION DIVISION

Form C-1  
 September 1999  
 Form must be Typed  
 Form must be Signed  
 All blanks must be Filled

**NOTICE OF INTENT TO DRILL**

Must be approved by KCC five (5) days prior to commencing well

Expected Spud Date March 1 2001  
month day year

Spot APPROX.  
C - SE - NW Sec 31 Twp. 33S S. R. 7  East  West  
3165 feet from S / N (circle one) Line of Section  
3190 feet from E / W (circle one) Line of Section  
 Is SECTION X Regular  Irregular?

OPERATOR: License# 5003  
 Name: McCoy Petroleum Corporation  
 Address: P.O. Box 780208  
 City/State/Zip: Wichita, KS 67278-0208  
 Contact Person: Scott Hampel  
 Phone: (316) 636-2737

(Note: Locate well on the Section Plat on reverse side)  
 County: Harper  
 Lease Name: TRUBY 'A' OWWO Well #: 1-31  
 Field Name: Wildcat

CONTRACTOR: License# 5123  
 Name: Pickrell Drilling Co., Inc.

Is this a Prorated / Spaced Field?  Yes  No  
 Target Information(s): Mississippian  
 Nearest Lease or unit boundary: 2090'  
 Ground Surface Elevation: 1389 feet MSL

<b>Well Drilled For:</b>	<b>Well Class:</b>	<b>Type Equipment:</b>
<input checked="" type="checkbox"/> Oil	<input type="checkbox"/> Enh Rec	<input checked="" type="checkbox"/> Mud Rotary
<input checked="" type="checkbox"/> Gas	<input type="checkbox"/> Storage	<input type="checkbox"/> Air Rotary
<input checked="" type="checkbox"/> OWWO	<input type="checkbox"/> Disposal	<input type="checkbox"/> Cable
<input type="checkbox"/> Seismic; # of Holes	<input checked="" type="checkbox"/> Wildcat	
<input type="checkbox"/> Other	<input type="checkbox"/> Other	

Water well within One-quarter mile:  Yes  No  
 Public water supply well within one mile:  Yes  No  
 Depth to bottom of fresh water: 50'  
 Depth to bottom of usable water: 180'

If OWWO: old well information as follows:  
 Operator: Barbara Oil Company  
 Well Name: #1 Dunning  
 Original Completion Date: 9/17/73 Original Total Depth: 4720'

Surface Pipe by Alternate: 1 2  
 Length of Surface Pipe Planned to be set: Existing 8 5/8" @ 268'  
 Length of Conductor Pipe required: \_\_\_\_\_  
 Projected Total Depth: 4720'  
 Producing Formation Target: Mississippian

Directional, Deviated or Horizontal wellbore?  Yes  No  
 If Yes, true vertical depth: \_\_\_\_\_  
 Bottom Hole Location: \_\_\_\_\_  
 KCC DKT #: \_\_\_\_\_

Water Source for Drilling Operations:  
 Well  Farm Pond  Other \_\_\_\_\_  
 DWR Permit #: \_\_\_\_\_  
 (Note: Apply for Permit with DWR )  
 Will Cores be taken?  Yes  No  
 If Yes, proposed zone: \_\_\_\_\_

**AFFIDAVIT**

RECEIVED  
 STATE CORPORATION COMMISSION

FEB - 6 2001

The undersigned hereby affirms that the drilling, completion and eventual plugging of this well will comply with K.S.A. 55-101, et. seq.

It is agreed that the following minimum requirements will be met:

1. Notify the appropriate district office **prior** to spudding of well;
2. A copy of the approved notice of intent to drill **shall be** posted on each drilling rig;
3. The minimum amount of surface pipe as specified below **shall be set** by circulating cement to the top. In all cases surface pipe **shall be set** through all unconsolidated materials plus a minimum of 20 feet into the underlying formation.
4. If the well is dry hole, an agreement between the operator and the district office on plug length and placement is necessary **prior to plugging**;
5. The appropriate district office will be notified before well is either plugged or production casing is cemented in;
6. If an ALTERNATE 11 COMPLETION, production pipe shall be cemented from below any usable water to surface within **120 days** of spud date. **In all cases, NOTIFY district office prior to any cementing.**

I hereby certify that the statements made herein are true and to the best of my knowledge and belief.

Date: 2/5/01 Signature of Operator or Agent: Cory N. Baker Title: Geologist

**For KCC Use ONLY**

API # 15 - 077-20209-0001

Conductor pipe required NONE feet

Minimum surface pipe required 268 feet per Alt. 1

Approved by: JK 3-30-2001

This authorization expires: 9-30-2001  
 (This authorization void if drilling not started within 6 months of effective date.)

Spud date: \_\_\_\_\_ Agent: \_\_\_\_\_

**Remember to -**

- File Drill Pit Application (form CDP-1) with Intent to Drill;
- File Completion Form ACO-1 within 120 days of spud date;
- File acreage attribution plat according to field proration orders;
- Notify appropriate district office 48 hours prior to workover or re-entry;
- Submit plugging report (CP-4) after plugging is completed;
- Obtain written approval before disposing or injecting salt water.

31  
33  
7W

IN ALL CASES PLOT THE INTENDED WELL ON THE PLAT BELOW

Plat of acreage attributable to a well in a prorated or spaced field

If the intended well is in a prorated or spaced field, please fully complete this side of the form. If the intended well is in a prorated or spaced field complete the plat below showing that the well will be properly located in relationship to other wells producing from the common source of supply. Please show all the wells and within 1 mile of the boundaries of the proposed acreage attribution unit for gas wells and within 1/2 mile of the boundaries of the proposed acreage attribution unit for oil wells.

API No. 15 - \_\_\_\_\_
Operator: McCoy Petroleum Corporation
Lease: TRUBY 'A' OWWO
Well Number: 1-31
Field: Wildcat

Location of Well: County: Harper
3165 feet from S / N (circle one) Line of Section
3190 feet from E / W (circle one) Line of Section
Sec 31 Twp 33S S. R 7 East West

Number of Acres attributable to well: \_\_\_\_\_
QTR / QTR / QTR of acreage: \_\_\_\_\_

Is Section X Regular or \_\_\_\_\_ Irregular

If Section is Irregular, locate well from nearest corner boundary.

Section corner used: NE NW SE SW

PLAT

(Show location of the well and shade attributable acreage for prorated or spaced wells)

(Show footage to the nearest lease or unit boundary line.)

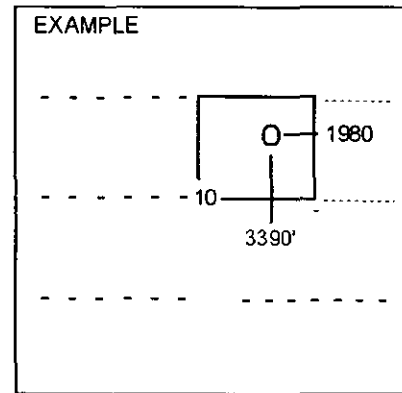
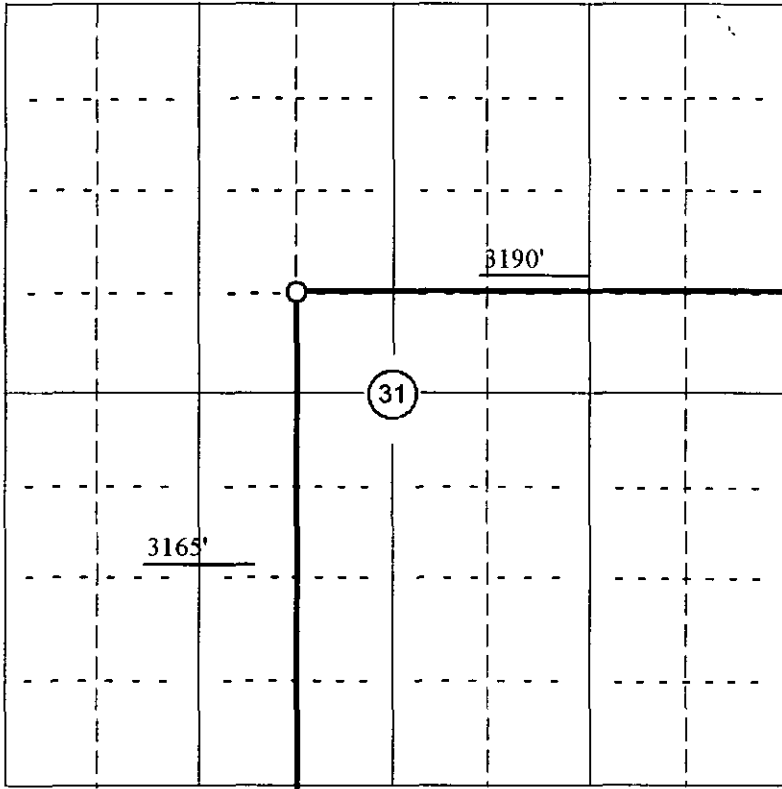

NOTE., In all cases locate the spot of the proposed drilling location.

SEWARD CO. RECEIVED STATE CORPORATION COMMISSION

FEB - 6 2001

In plotting the proposed location of the well, you must show.

- 1. The manner in which you are using the depicted plat by identifying section lines, i.e. 1 section, 1 section with 8 surrounding sections, 4 sections, etc.
2. The distance of the proposed drilling location from the section's south / north and east / west.
3. The distance to the nearest lease or unit boundary line.
4. If proposed location is located within a prorated or spaced field a certificate of acreage attribution plat must be attached: (CO-7 for oil wells; CG-8 for gas wells).