

FOR KCC USE:

FORM C-1 7/91

FORM MUST BE TYPED

FORM MUST BE SIGNED

ALL BLANKS MUST BE FILLED

EFFECTIVE DATE: 6-27-95

State of Kansas

DISTRICT # 1

NOTICE OF INTENTION TO DRILL

SGAT Yes No

Must be approved by the K.C.C. five (5) days prior to commencing well

Expected Spud Date Unknown month day year

Spot SW.NW Sec 11 Twp 30S S, Rg 12 East West

OPERATOR: License # 5047 Name: Rupe Oil Company, Inc. Address: 434 Ohio P.O. Box 783010 City/State/Zip: Wichita, Kansas 67278-3010 Contact Person: William G. Clement Phone: (316) 262-3748

1980 feet from South / North line of Section 660 feet from East / West line of Section

CONTRACTOR: License #: ADVISE ON ACO-1 Name: Unknown

IS SECTION X REGULAR IRREGULAR? County: Barber Lease Name: Hamilton Well #: #1 Field Name: Wildcat Is this a Prorated/Spaced Field? yes X no

Well Drilled For: Well Class: Type Equipment: Oil Enh Rec Infield Mud Rotary Gas Storage Pool Ext Air Rotary OWD Disposal Wildcat Cable Seismic # of Holes Other

Target Formation(s): Nearest lease or unit boundary: 660 Ground Surface Elevation: 1800 EST feet MSL Water well within one-quarter mile: yes X no Public water supply well within one mile: yesXX no

If OWD: old well information as follows: Operator: Rupe Oil Company, Inc Well Name: #1 Hamilton Comp. Date: 5/27/73 Old Total Depth 3550'

Depth to bottom of fresh water: 150 Depth to bottom of usable water: 180 Surface Pipe by Alternate: 1 2 Length of Surface Pipe Planned to be set: 287' of 8.5/8 Length of Conductor pipe required: already in place Projected Total Depth: PTD 3550' Formation at Total Depth: Elgin Water Source for Drilling Operations: well farm pond other

Directional, Deviated or Horizontal wellbore? yes X no If yes, true vertical depth: Bottom Hole Location:

DWR Permit #: Will Cores Be Taken? yes X no If yes, proposed zone:

AFFIDAVIT

The undersigned hereby affirms that the drilling, completion and eventual plugging of this well will comply with K.S.A. 55-101, et. seq. It is agreed that the following minimum requirements will be met:

RECEIVED STATE COMMISSION JUN 21 1995

- 1. Notify the appropriate district office prior to spudding of well; 2. A copy of the approved notice of intent to drill shall be posted on each drilling rig; 3. The minimum amount of surface pipe as specified below shall be set by circulating cement to the top; in all cases surface pipe shall be set through all unconsolidated materials plus a minimum of 20 feet into the underlying formation; 4. If the well is dry hole, an agreement between the operator and the district office on plug length and placement is necessary prior to plugging; 5. The appropriate district office will be notified before well is either plugged or production casing is cemented in; 6. IF AN ALTERNATE II COMPLETION, PRODUCTION PIPE SHALL BE CEMENTED FROM BELOW ANY USABLE WATER TO SURFACE WITHIN 120 DAYS OF SPUD DATE. IN ALL CASES, NOTIFY DISTRICT OFFICE PRIOR TO ANY CEMENTING.

I hereby certify that the statements made herein are true and to the best of my knowledge and belief. Date: June 19, 1995 Signature of Operator or Agent: William G. Clement Title: Staff Geologist

FOR KCC USE: API # 15- 007-202340001 Conductor pipe required NONE feet Minimum surface pipe required 287' feet per Alt. (1) X Approved by: SK 6-22-95 This authorization expires: 12-22-95 (This authorization void if drilling not started within 6 months of effective date.) Spud date: Agent:

REMEMBER TO:

- File Drill Pit Application (form CDP-1) with Intent to Drill; - File Completion Form ACO-1 within 120 days of spud date; - File acreage attribution plat according to field proration orders; - Notify appropriate district office 48 hours prior to workover or re-entry; - Submit plugging report (CP-4) after plugging is completed; - Obtain written approval before disposing or injecting salt water.

Mail to: Conservation Division, 200 Colorado Derby Building, 202 W. First St., Wichita, Kansas 67202-1286.

11 30 180

IN ALL CASES PLOT THE INTENDED WELL ON THE PLAT BELOW

PLAT OF ACREAGE ATTRIBUTABLE TO A WELL IN A PRORATED OR SPACED FIELD

If the intended well is in a prorated or spaced field, please fully complete this side of the form. If the intended well is in a prorated or spaced field complete the plat below showing that the well will be properly located in relationship to other wells producing from the common source of supply. Please show all the wells within 1 mile of the boundaries of the proposed acreage attribution unit for gas wells and within 1/2 mile of the boundaries of the proposed acreage attribution unit for oil wells.

API NO. 15- _____
 OPERATOR _____
 LEASE _____
 WELL NUMBER _____
 FIELD _____

LOCATION OF WELL: COUNTY _____
 _____ feet from south/north line of section
 _____ feet from east/west line of section
 SECTION _____ TWP _____ RG _____

NUMBER OF ACRES ATTRIBUTABLE TO WELL _____
 QTR/QTR/QTR OF ACREAGE _____

IS SECTION _____ REGULAR or _____ IRREGULAR
IF SECTION IS IRREGULAR, LOCATE WELL FROM NEAREST CORNER BOUNDARY.

Section corner used: _____ NE _____ NW _____ SE _____ SW

PLAT

(Show location of the well and shade attributable acreage for prorated or spaced wells.)
 (Show footage to the nearest lease or unit boundary line.)

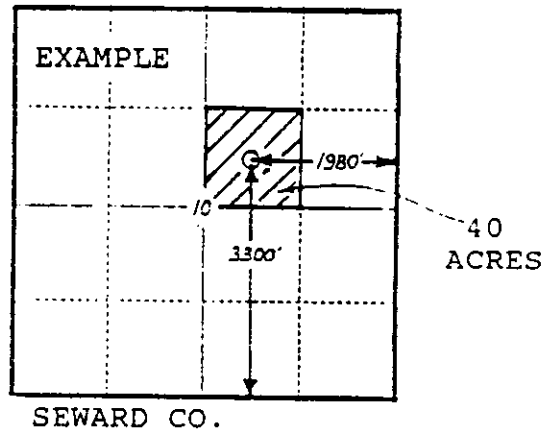
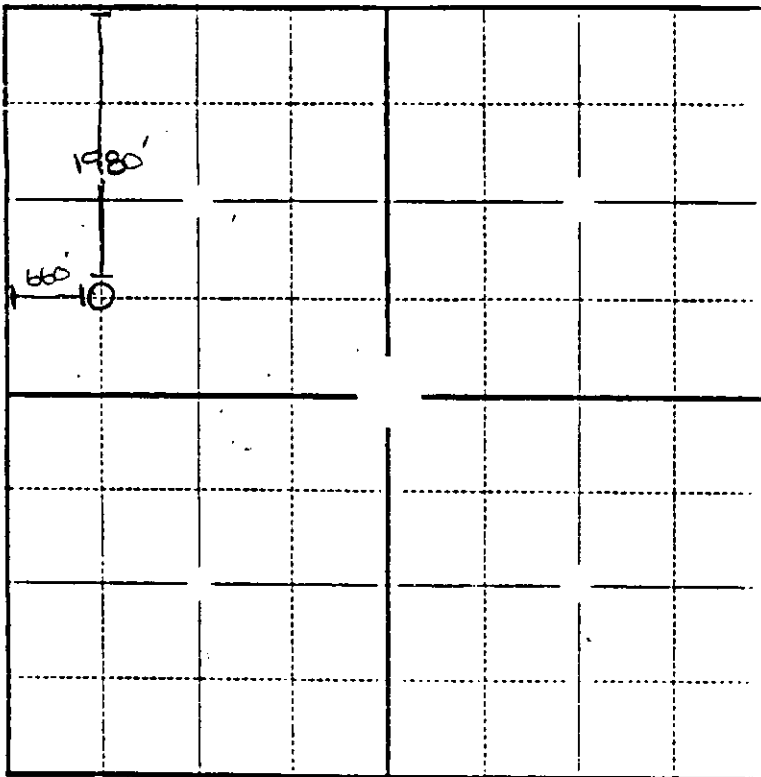

In plotting the proposed location of the well, you must show:

- 1) The manner in which you are using the depicted plat by identifying section lines, i.e. 1 section, 1 section with 8 surrounding sections, 4 sections, etc.;
- 2) the distance of the proposed drilling location from the section's south/north and east/west lines; and
- 3) the distance to the nearest lease or unit boundary line.