

FOR KCC USE:

FORM C-1 7/91

EFFECTIVE DATE: 1-23-2000DISTRICT# 2SGA? Yes ☒ No

State of Kansas

NOTICE OF INTENTION TO DRILL

Must be approved by the K.C.C. Five (5) days prior to commencing well.

FORM MUST BE TYPED

FORM MUST BE SIGNED

ALL BLANKS MUST BE FILLED

Expected Spud Date 1 15 2000
Month day YearSpot SURFACE LOCATIONNW - NW - SE Sec 1 Twp 34 S Rg 9 X East WestOPERATOR: License # 32538
Name Abraxas Petroleum Corporation
Address 500 North Loop 1604 East, Suite 100
City/State/Zip San Antonio TX 78232
Contact Person Will H. Wallace
Phone: (210) 490-4788 (210) 490-8837 fax2,550 feet from South / North line of Section
2,550 feet from East / West line of Section
IS SECTION YES REGULAR IRREGULAR?CONTRACTOR: License # 5929
Name: DUKE DRILLINGCounty: Harper
Lease Name: Carothers Well # 1-1HField Name: Hibbard N.E.Is this a Prorated/Spaced Field? yes X noTarget Formation(s): Warsaw (Mississippian)Nearest Lease or unit boundary: 330 feet (BHL)Ground Surface Elevation: 1,320.0 feet MSLWater well within one-quarter mile: Yes X NoPublic water supply well within one mile: Yes X NoDepth to bottom of fresh water: 110 feetDepth to bottom of usable water: 180 feetSurface Pipe by Alternate: X 1 X 2Length of Surface Pipe Planned to be set: 350 feetProjected Total Depth: 6,650 feet m.d.Formation at Total Depth: Mississippian (Warsaw)

Water Source for Drilling Operations:

X well farm pond other

Well Drilled for: Well Class: Type Equipment:

X Oil Enh Rec X Infield X Mud RotaryX Gas Storage Pool Ext. Air RotaryOWWO Disposal Wildcat CableSeismic # Of Holes OtherOther

If OWWO: old well information as follows:

Operator: _____

Well Name: _____

Comp. Date: _____ Old Total Depth _____

Directional, Deviated or Horizontal Wellbore? X Yes NoIf yes, true vertical depth: 4,648Bottom Hole Location 330 feet FSL & 710 feet FEL Sec 1, T34S, R9WWill Cores Be Taken?: yes X no

If yes, proposed zone: _____

AFFIDAVIT

HORIZONTAL DOCKET No. 195,467-CThe undersigned hereby affirms that the drilling, completion and eventual plugging of this well will comply with K.S.A. 55 - 101, et. seq. (C-28,717)
It is agreed that the following minimum requirements will be met:

1. Notify the appropriate district office prior to spudding of well;
2. A copy of the approved notice of intent to drill shall be posted on each drilling rig;
3. The minimum amount of surface pipe as specified below shall be set by circulating cement to the top: in all cases surface pipe shall be set through all unconsolidated materials plus a minimum of 20 feet into the underlying formation;
4. If the well is dry hole, an agreement between the operator and the district office on plug length and placement is necessary prior to plugging;
5. The appropriate district office will be notified before well is either plug or production casing is cemented in;
6. IF AN ALTERNATE II COMPLETION, PRODUCTION PIPE SHALL BE CEMENTED FROM BELOW ANY USABLE WATER TO SURFACE WITHIN 120 DAYS OF SPUD DATE. IN ALL CASES, NOTIFY DISTRICT OFFICE PRIOR TO ANY CEMENTING.

I hereby certify that the statements made herein are true and to the best of my knowledge and belief,

Date: December 13, 1999 Signature of Operator or Agent Will H. Wallace Title Manager of Operations

FOR KCC USE:	
API # 15 -	<u>077-21376-0189</u>
Conductor pipe required	<u>NONE</u> feet
Minimum surface pipe required	<u>200</u> feet per Alt. <u>(1) X</u>
Approved by:	<u>JK 1-18-2000</u>
This authorization expires:	<u>7-18-2000</u>
(This authorization void if drilling not started within 6 months of effective date.)	
Spud date:	Agent:

RECEIVED
KANSAS CORPORATION COMMISSION

DEC 15 1999

CONSERVATION DIVISION
WICHITA, KS

REMEMBER TO:

- File Drill Pit Application (Form CDP-1) with Intent to Drill;
- File Completion Form ACO-1 within 120 days of spud date;
- File acreage attribution plat according to field proration orders;
- Notify appropriate district office 48 hours prior to workover or re-entry;
- Submit plugging report (CP-4) after plugging is completed;
- Obtain written approval before disposing or injecting salt water.

34
9W

IN ALL CASES PLOT THE INTENDED WELL ON THE PLAT BELOW

PLAT OF ACREAGE ATTRIBUTABLE TO A WELL IN A PRORATED OR SPACED FIELD

If the intended well is in a prorated or spaced field, please fully complete this side of the form. If the intended well is in a prorated or spaced field complete the plat below showing that the well will be properly located in relationship to other wells producing from the common source of supply. Please show all the wells within 1/2 mile of the boundaries of the proposed acreage attribution unit for oil wells.

API NO. 15- _____ LOCATION OF WELL: COUNTY Harper
 OPERATOR Abraxas Petroleum Corporation 2,550 feet from south / north line of section
 LEASE Carothers 2,550 feet from east / west line of section
 WELL NUMBER 1 - 1H SECTION 1 TWP 34S RG 9W
 FIELD Hibbard

NUMBER OF ACRES ATTRIBUTABLE TO WELL 480 IS SECTION Yes REGULAR or _____ IRREGULAR
 QTR/QTR/QTR OF ACREAGE NW - NW - SE IF SECTION IS IRREGULAR, LOCATE WELL FROM NEAREST CORNER BOUNDARY.
 Section corner used: _____ NE _____ NW _____ SE _____ SW

PLAT

(Show location of the well and shade attributable acreage for prorated or spaced wells.)

(Show footage to the nearest lease or unit boundary line.)

Section 1, T34S, R9W HARPER COUNTY

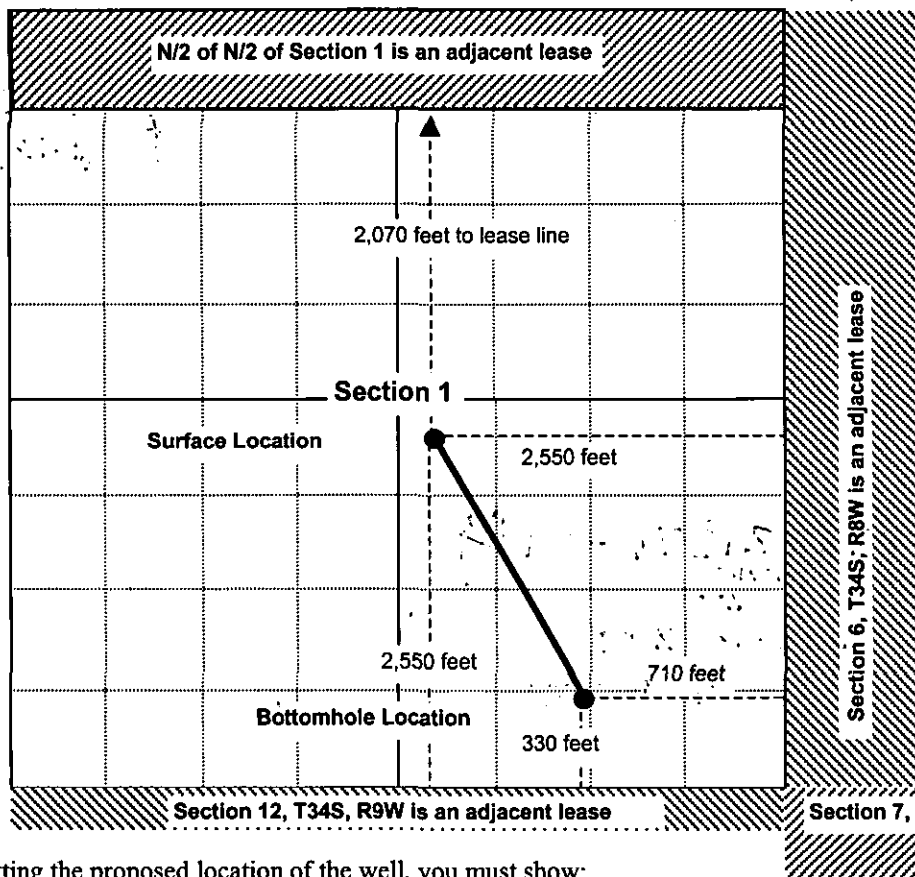

EXAMPLE

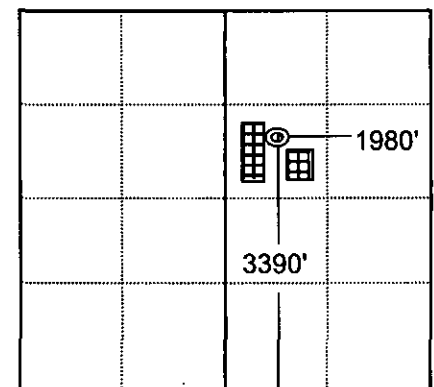

SEWARD CO.

In plotting the proposed location of the well, you must show:

- 1) The manner in which you are using the depicted plat by identifying section lines, i.e. 1 section, 1 section with 8 surrounding sections, 4 sections, etc.:
- 2) the distance of the proposed drilling location from the sections's south/north and east/west; and the distance to the nearest lease or unit boundary line.
- 3) the distance to the nearest lease or unit boundary line