

EFFECTIVE DATE: 12-20-99

State of Kansas

DISTRICT# 2

NOTICE OF INTENTION TO DRILL

SGA? Yes No

Must be approved by the K. C. C. Five (5) days prior to commencing well.

Spot _____ East
NW - NW - SE Sec 1 Twp 34 S. Rg 9 West

Expected Spud Date 1 15 2000
Month day Year

OPERATOR: License # 32539
Name Abraxas Petroleum Corporation
Address 500 North Loop 1804 East, Suite 100
City/State/Zip San Antonio TX 78232
Contact Person Will H. Wallace
Phone: (210) 490 - 4788 (210) 490 - 8837 fax

2,550 feet from South / North line of Section
2,550 feet from East / West line of Section
IS SECTION REGULAR IRREGULAR?

CONTRACTOR: License # ANNISE ON ACO-1
Name: To Be Contracted

*** CONTRACTOR MUST BE LICENSED WITH KCC**

Well Drilled for: Well Class: Type Equipment:
Oil Enh Rec Infield MudRotary
 Gas Storage Pool Ext. Air Rotary
 OWWO Disposal Wildcat Cable
 Seismic # Of Holes Other
Other _____

County: Harper
Lease Name: Carothers Well # 1-1-1H
Field Name: Hibbard N.E.
Is this a Prorated/Spaced Field? yes no
Target Formation(s): Warsaw (Mississippian)
Nearest Lease or unit boundary: 2,070 feet
Ground Surface Elevation: 1,320.0 feet MSL
Water well within one-quarter mile: Yes No
Public water supply well within one mile: Yes No
Depth to bottom of fresh water: 110 feet
Depth to bottom of usable water: 180 feet
Surface Pipe by Alternate: 1 2
Length of Surface Pipe Planned to be set: 350 feet
Projected Total Depth: 4,850 feet
Formation at Total Depth: Oasage
Water Source for Drilling Operations:
 well farm pond other

If OWWO: old well information as follows:
Operator: _____
Well Name: _____
Comp. Date: _____ Old Total Depth _____

Directional, Deviated or Horizontal Wellbore? Yes No

If yes, true vertical depth: _____

Bottom Hole Location _____

(APPLY FOR FROM DWR)
Will Cores Be Taken? yes no
If yes, proposed zone: _____

AFFIDAVIT

*** WELL # ON PLAT MAP ; PIT APPLICATION IS 1-1H**

The undersigned hereby affirms that the drilling, completion and eventual plugging of this well will comply with K. S. A. 55 - 101, et. seq. It is agreed that the following minimum requirements will be met:

- 1. Notify the appropriate district office prior to spudding of well;
- 2. A copy of the approved notice of intent to drill shall be posted on each drilling rig;
- 3. The minimum amount of surface pipe as specified below shall be set by circulating cement to the top: in all cases surface pipe shall be set through all unconsolidated materials plus a minimum of 20 feet into the underlying formation;
- 4. If the well is dry hole, an agreement between the operator and the district office on plug length and placement is necessary prior to plugging;
- 5. The appropriate district office will be notified before well is either plug or production casing is cemented in;
- 6. IF AN ALTERNATE II COMPLETION, PRODUCTION PIPE SHALL BE CEMENTED FROM BELOW ANY USABLE WATER TO SURFACE WITHIN 120 DAYS OF SPUD DATE. IN ALL CASES, NOTIFY DISTRICT OFFICE PRIOR TO ANY CEMENTING.

I hereby certify that the statements made herein are true and to the best of my knowledge and belief,

Date: December 9, 1999 Signature of Operator or Agent Will H. Wallace Title Manager of Operations

FOR KCC USE:
API # 15 - 077-21376-0000
Conductor pipe required NONE feet
Minimum surface pipe required 200 feet per Alt. (1) X
Approved by: JK 12-15-99
This authorization expires: 6-15-2000
(This authorization void if drilling not started within 6 months of effective date.)
Spud date: _____ Agent: _____

RECEIVED
KANSAS CORPORATION COMMISSION

DEC 15 1999

CONSERVATION DIVISION
WICHITA, KS

1
34
9W

- REMEMBER TO:
- File Drill Pit Application (Form CDP-1) with Intent to Drill;
 - File Completion Form ACO-1 within 120 days of spud date;
 - File acreage attribution plat according to field prorations orders;
 - Notify appropriate district office 48 hours prior to workover or re-entry
 - Submit plugging report (CP-4) after plugging is completed;
 - Obtain written approval before disposing or injecting salt water.

IN ALL CASES PLOT THE INTENDED WELL ON THE PLAT BELOW

PLAT OF ACREAGE ATTRIBUTABLE TO A WELL IN A PRORATED OR SPACED FIELD

If the intended well is in a prorated or spaced field, please fully complete this side of the form. If the intended well is in a prorated or spaced field complete the plat below showing that the well will be properly located in relationship to other wells producing from the common source of supply. Please show all the wells within 1/2 mile of the boundaries of the proposed acreage attribution unit for oil wells.

API NO. 15- _____ LOCATION OF WELL: COUNTY Harper

OPERATOR Abraxas Petroleum Corporation 2,550 feet from south / north line of section

LEASE Carothers 2,550 feet from east / west line of section

WELL NUMBER 1 - 1H SECTION 1 TWP. T34S RGA 9W

FIELD Hibbard

NUMBER OF ACRES ATTRIBUTABLE TO WELL 480 IS SECTION Yes REGULAR or _____ IRREGULAR

QTR/QTR/QTR OF ACREAGE NW - NW - SE IF SECTION IS IRREGULAR, LOCATE WELL FROM NEAREST CORNER BOUNDARY.

Section corner used: _____ NE _____ NW _____ SE _____ SW

PLAT

(Show location of the well and shade attributable acreage for prorated or spaced wells.)

(Show footage to the nearest lease or unit boundary line.)

Section 1, T34S, R9W HARPER COUNTY

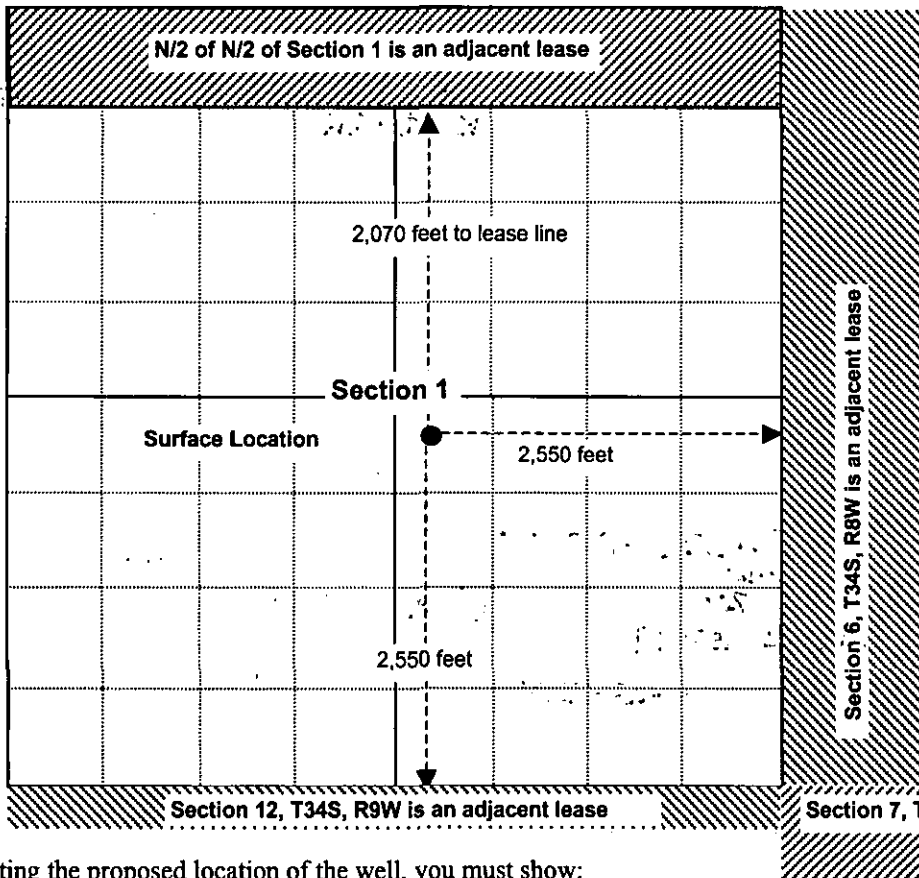

EXAMPLE

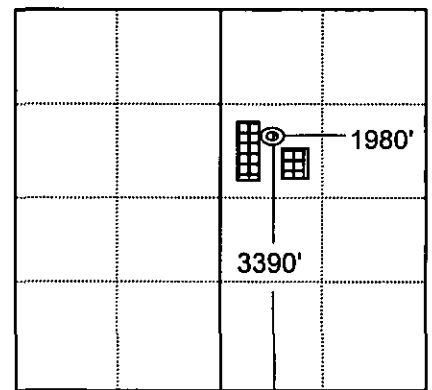

SEWARD CO.

In plotting the proposed location of the well, you must show:

- 1) The manner in which you are using the depicted plat by identifying section lines, i.e. 1 section, 1 section with 8 surrounding sections, 4 sections, etc.:
- 2) the distance of the proposed drilling location from the sections's south/north and east/west; and the distance to the nearest lease or unit boundary line.
- 3) the distance to the nearest lease or unit boundary line