

For KCC Use: 4-24-2001
Effective Date: 2
District # _____
SGA? Yes No

KANSAS CORPORATION COMMISSION
OIL & GAS CONSERVATION DIVISION

Form C-1
September 1999
Form must be Typed
Form must be Signed
All blanks must be Filled

NOTICE OF INTENT TO DRILL

Must be approved by KCC five (5) days prior to commencing well

Expected Spud Date April 23 2001
month day year

Spot _____ - SE - NW Sec 15 Twp. 34S S. R. 8 East West

OPERATOR: License# 5003
Name: McCoy Petroleum Corporation
Address: P.O. Box 780208
City/State/Zip: Wichita, KS 67278-0208
Contact Person: Scott Hampel
Phone: (316) 636-2737

3300 feet from S / N (circle one) Line of Section
3300 feet from E / W (circle one) Line of Section
Is SECTION Regular Irregular?

CONTRACTOR: License# 5123
Name: Pickrell Drilling Co., Inc.

(Note: Locate well on the Section Plat on reverse side)
County: Harper
Lease Name: WURM 'A' Well #: 1-15

Field Name: Wildcat
Is this a Prorated / Spaced Field? Yes No

Target Information(s): Mississippian
Nearest Lease or unit boundary: 660'
Ground Surface Elevation: 1368 feet MSL

Water well within One-quarter mile: Yes No
Public water supply well within one mile: Yes No

Depth to bottom of fresh water: 55'
Depth to bottom of usable water: 180'

Surface Pipe by Alternate: X | 2
Length of Surface Pipe Planned to be set: 240'

Length of Conductor Pipe required: None
Projected Total Depth: 4725'

Producing Formation Target: Mississippian
Water Source for Drilling Operations:
Well Farm Pond Other

DWR Permit #: _____
(Note: Apply for Permit with DWR)

Will Cores be taken? Yes No
If Yes, proposed zone: _____

Well Drilled For: Well Class: Type Equipment:

<input checked="" type="checkbox"/> Oil	<input type="checkbox"/> Enh Rec	<input type="checkbox"/> Infield	<input checked="" type="checkbox"/> Mud Rotary
<input checked="" type="checkbox"/> Gas	<input type="checkbox"/> Storage	<input type="checkbox"/> Pool Ext.	<input type="checkbox"/> Air Rotary
<input type="checkbox"/> OWWO	<input type="checkbox"/> Disposal	<input checked="" type="checkbox"/> Wildcat	<input type="checkbox"/> Cable
<input type="checkbox"/> Seismic; # of Holes _____	<input type="checkbox"/> Other _____		

If OWWO: old well information as follows:

Operator: _____
Well Name: _____
Original Completion Date: _____ Original Total Depth: _____

Directional, Deviated or Horizontal wellbore? Yes No

If Yes, true vertical depth: _____

Bottom Hole Location: _____

KCC DKT #: _____

AFFIDAVIT

The undersigned hereby affirms that the drilling, completion and eventual plugging of this well will comply with K.S.A. 55-101, et. seq.

It is agreed that the following minimum requirements will be met:

1. Notify the appropriate district office **prior** to spudding of well;
2. A copy of the approved notice of intent to drill **shall be** posted on each drilling rig;
3. The minimum amount of surface pipe as specified below **shall be set** by circulating cement to the top; in all cases surface pipe **shall be set** through all unconsolidated materials plus a minimum of 20 feet into the underlying formation.
4. If the well is dry hole, an agreement between the operator and the district office on plug length and placement is necessary **prior to plugging**;
5. The appropriate district office will be notified before well is either plugged or production casing is cemented in;
6. If an ALTERNATE 11 COMPLETION, production pipe shall be cemented from below any usable water to surface within **120 days** of spud date. **In all cases, NOTIFY district office** prior to any cementing.

I hereby certify that the statements made herein are true and to the best of my knowledge and belief.

Date: 4/16/01 Signature of Operator or Agent: Scott E. Hampel Title: Petroleum Engineer

For KCC Use ONLY

API # 15 - 077-21399-0000

Conductor pipe required NONE feet

Minimum surface pipe required 200 feet per Alt 1

Approved by: JK 4-19-2001

This authorization expires: 10-19-2001

(This authorization void if drilling not started within 6 months of effective date.)

Spud date: _____ Agent: _____

Remember to -

- File Drill Pit Application (form CDP-1) with Intent to Drill;
- File Completion Form ACO-1 within 120 days of spud date;
- File acreage attribution plat according to field proration orders;
- Notify appropriate district office 48 hours prior to workover or re-entry;
- Submit plugging report (CP-4) after plugging is completed;
- Obtain written approval before disposing or injecting salt water.

15
34
MB

IN ALL CASES PLOT THE INTENDED WELL ON THE PLAT BELOW

Plat of acreage attributable to a well in a prorated or spaced field

If the intended well is in a prorated or spaced field, please fully complete this side of the form. If the intended well is in a prorated or spaced field complete the plat below showing that the well will be properly located in relationship to other wells producing from the common source of supply. Please show all the wells and within 1 mile of the boundaries of the proposed acreage attribution unit for gas wells and within 1/2 mile of the boundaries of the proposed acreage attribution unit for oil wells.

API No. 15 _____
 Operator: McCoy Petroleum Corporation
 Lease: WURM 'A'
 Well Number: 1-15
 Field: Wildcat
 Number of Acres attributable to well: _____
 QTR / QTR / QTR of acreage: _____

Location of Well: County: Harper

 3300 _____ feet from S / N (circle one) Line of Section
 3300 _____ feet from E / W (circle one) Line of Section
 Sec 15 Twp 34S S. R. 8 East West

Is Section X Regular or _____ Irregular

If Section is Irregular, locate well from nearest corner boundary.
 Section corner used: ___ NE ___ NW -SE ___ SW

PLAT

(Show location of the well and shade acreage for prorated or spaced wells)

(Show footage to the nearest lease or unit boundary line.)

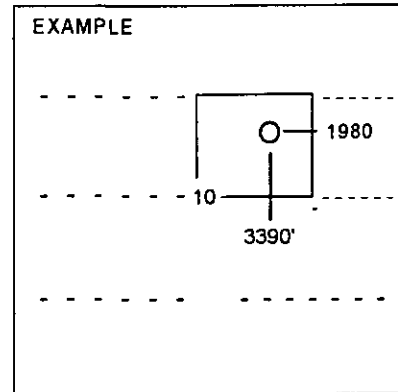
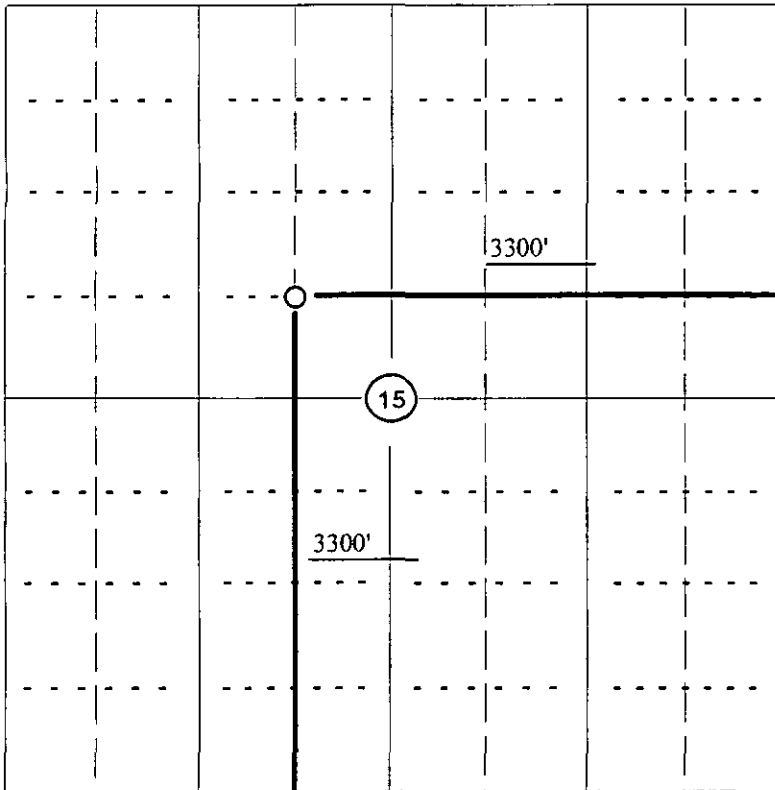

SEWARDCO.

NOTE., In all cases locate the spot of the proposed drilling location.

In plotting the proposed location of the well, you must show.

1. The manner in which you are using the depicted plat by identifying section lines, i.e. 1 section, 1 section with 8 surrounding sections, 4 sections, etc.
2. The distance of the proposed drilling location from the section's south / north and east / west.
3. The distance to the nearest lease or unit boundary line.
4. If proposed location is located within a prorated or spaced field a certificate of acreage attribution plat must be attached: (CO-7 for oil wells; CG-8 for gas wells).