

FOR KCC USE:

FORM C-1 7/91

EFFECTIVE DATE: 6-7-94

State of Kansas

DISTRICT # 1

NOTICE OF INTENTION TO DRILL

SEA? Yes No

Must be approved by the K.C.C. five (5) days prior to commencing well

FORM MUST BE TYPED

FORM MUST BE SIGNED

ALL BLANKS MUST BE FILLED

Expected Spud Date June 10, 1994

Spot N/A East
E 1/2 SW Sec 13, Twp 34 S, Rg 15 West

OPERATOR: License # 5010
Name: Knighton Oil Company, Inc.
Address: 221 South Broadway Suite #710
City/State/Zip: Wichita, Kansas 67202
Contact Person: Earl M. Knighton, Jr.
Phone: (316) 264-7918

1445 feet from South / North line of Section
1080 feet from East / West line of Section
IS SECTION X REGULAR IRREGULAR?

(NOTE: Locate well on the Section Plat on Reverse Side)

County: Barber

Lease Name: Davis Ranch Well #: 5

Field Name: Aetna

Is this a Prorated/Spaced Field? yes X no

Target Formation(s): Viola

Nearest lease or unit boundary: 1080'

Ground Surface Elevation: 1694 feet MSL

Water well within one-quarter mile: yes X no

Public water supply well within one mile: yes X no

Depth to bottom of fresh water: 80'

Depth to bottom of usable water: 180'

Surface Pipe by Alternate: X 1 2

Length of Surface Pipe Planned to be set: 200'

Length of Conductor pipe required: None

Projected Total Depth: 5300'

Formation at Total Depth: Viola

Water Source for Drilling Operations:

well X farm pond other

DWR Permit #: _____

Will Cores Be Taken?: yes X no

If yes, proposed zone: _____

Well Drilled For: Well Class: Type Equipment:

X Oil ... Enh Rec X Infield X Mud Rotary
X Gas ... Storage ... Pool Ext. ... Air Rotary
... OWD ... Disposal ... Wildcat ... Cable
... Seismic; ... # of Holes ... Other
... Other

If OWD: old well information as follows:

Operator: _____

Well Name: _____

Comp. Date: _____ Old Total Depth _____

Directional, Deviated or Horizontal wellbore? yes no

If yes, true vertical depth: _____

Bottom Hole Location: _____

RECEIVED

AFFIDAVIT

The undersigned hereby certifies that the drilling, completion and eventual plugging of this well will comply with K.S.A. 55-101, et. seq.

It is agreed that the following minimum requirements will be met:

- 1. Notify the appropriate district office prior to spudding of well;
- 2. A copy of the approved notice of intent to drill shall be posted on each drilling rig;
- 3. The minimum amount of surface pipe as specified below shall be set by circulating cement to the top; in all cases surface pipe shall be set through all unconsolidated materials plus a minimum of 20 feet into the underlying formation;
- 4. If the well is dry hole, an agreement between the operator and the district office on plug length and placement is necessary prior to plugging;
- 5. The appropriate district office will be notified before well is either plugged or production casing is cemented in;
- 6. IF AN ALTERNATE IS COMPLETION, PRODUCTION PIPE SHALL BE CEMENTED FROM BELOW ANY USABLE WATER TO SURFACE WITHIN 120 DAYS OF SPUD DATE. IN ALL CASES, NOTIFY DISTRICT OFFICE PRIOR TO ANY CEMENTING.

I hereby certify that the statements made herein are true and to the best of my knowledge and belief.

Date: 6/02/94 Signature of Operator or Agent: David D. Montagna Title: Geologist

FOR KCC USE:
API # 15- 007-22444-00-00
Conductor pipe required NONE feet
Minimum surface pipe required 200' feet per Alt. ① X
Approved by: CB 6-2-94
This authorization expires: 12-2-94
(This authorization void if drilling not started within 6 months of effective date.)
Spud date: _____ Agent: _____

REMEMBER TO:

- File Drill Pit Application (form CDP-1) with Intent to Drill;
- File Completion Form ACO-1 within 120 days of spud date;
- File acreage attribution plat according to field proration orders;
- Notify appropriate district office 48 hours prior to workover or re-entry;
- Submit plugging report (CP-4) after plugging is completed;
- Obtain written approval before disposing or injecting salt water.

Mail to: Conservation Division, 200 Colorado Derby Building, 202 W. First St., Wichita, Kansas 67202-1286.

13
34
15

IN ALL CASES PLOT THE INTENDED WELL ON THE PLAT BELOW

PLAT OF ACREAGE ATTRIBUTABLE TO A WELL IN A PRORATED OR SPACED FIELD

If the intended well is in a prorated or spaced field, please fully complete this side of the form. If the intended well is in a prorated or spaced field complete the plat below showing that the well will be properly located in relationship to other wells producing from the common source of supply. Please show all the wells within 1 mile of the boundaries of the proposed acreage attribution unit for gas wells and within 1/2 mile of the boundaries of the proposed acreage attribution unit for oil wells.

API NO. 15- _____

OPERATOR _____

LEASE _____

WELL NUMBER _____

FIELD _____

LOCATION OF WELL: COUNTY _____

_____ feet from south/north line of section

_____ feet from east/west line of section

SECTION _____ TWP _____ RG _____

NUMBER OF ACRES ATTRIBUTABLE TO WELL _____

IS SECTION _____ REGULAR or _____ IRREGULAR

QTR/QTR/QTR OF ACREAGE _____

IF SECTION IS IRREGULAR, LOCATE WELL FROM NEAREST CORNER BOUNDARY.

Section corner used: _____ NE _____ NW _____ SE _____ SW

PLAT

(Show location of the well and shade attributable acreage for prorated or spaced wells.)
 (Show footage to the nearest lease or unit boundary line.)

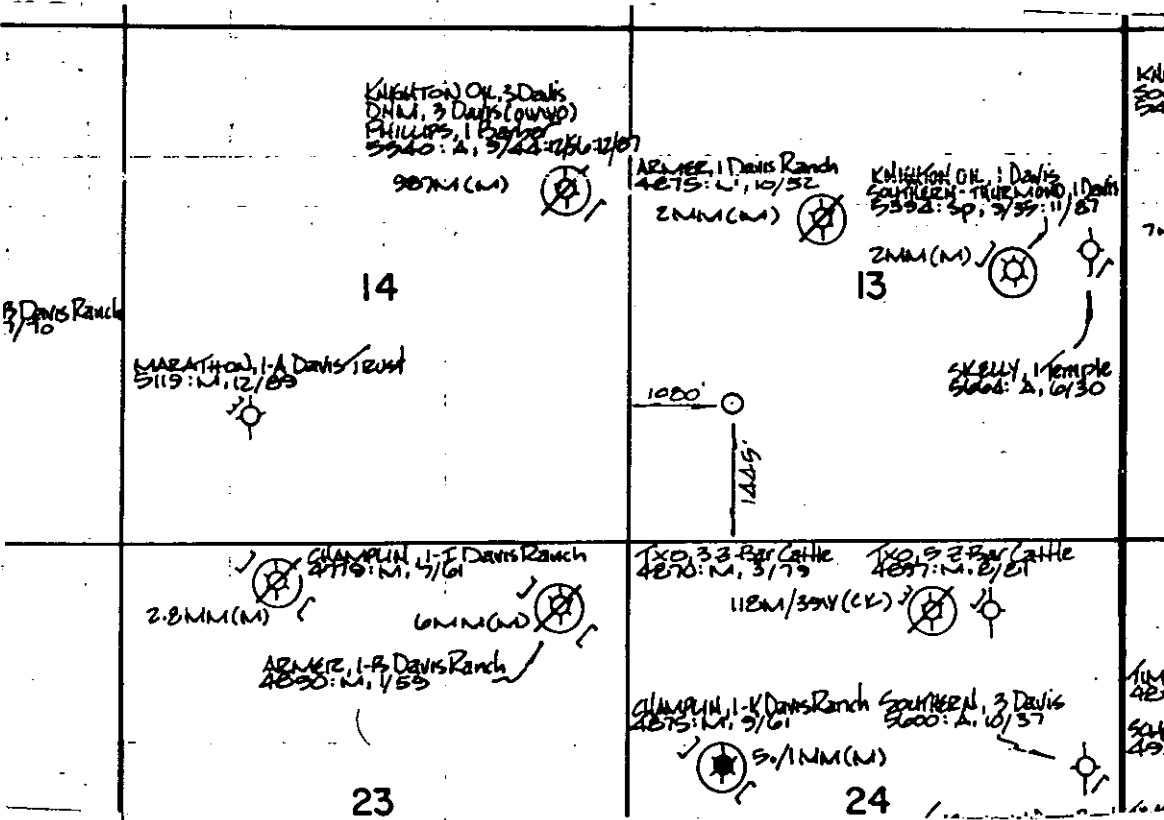

In plotting the proposed location of the well you must show:

- 1) The manner in which you are using the depicted plat by identifying section lines, i.e. 1 section, 1 section with 8 surrounding sections, 4 sections, etc.;
- 2) the distance of the proposed drilling location from the section's south/north and east/west lines; and
- 3) the distance to the nearest lease or unit boundary line.