

**KANSAS CORPORATION COMMISSION
OIL & GAS CONSERVATION DIVISION**

For KCC Use:

Effective Date: 6.30.03

District # 1

SGA? Yes No

Must be approved by KCC five (5) days prior to commencing well

Expected Spud Date June 25, 2003
month day year

**Spot 135'S & 10'E of East
C NW NW Sec. 5 Twp. 34 S. R. 15 West

OPERATOR: License# 5050
Name: Hummon Corporation
Address: 950 North Tyler Road
City/State/Zip: Wichita, Kansas 67212-3240
Contact Person: Brent B. Reinhardt
Phone: 316/773-2300

**795 feet from S (N circle one) Line of Section
670 feet from E (W circle one) Line of Section
Is SECTION Regular Irregular?

(Note: Locate well on the Section Plat on reverse side)

CONTRACTOR: License# 5929
Name: Duke Drilling Co., Inc.

County: Barber
Lease Name: PLATT Well #: 1-5A
Field Name: Wildcat

Is this a Prorated / Spaced Field? Yes No
Target Formation(s): Arbuckle

Well Drilled For: Oil Enh Rec Infield Mud Rotary
 Gas Storage Pool Ext. Air Rotary
 OWWO Disposal Wildcat Cable
 Seismic; # of Holes Other

Nearest Lease or unit boundary: 670'
Ground Surface Elevation: Approx. 1624 feet MSL

Water well within one-quarter mile: Yes No

Public water supply well within one mile: Yes No

Depth to bottom of fresh water: 150'

Depth to bottom of usable water: 180'

Surface Pipe by Alternate: X 1 2

Length of Surface Pipe Planned to be set: 900'

Length of Conductor Pipe required: 130'+

Projected Total Depth: 5350'

Formation at Total Depth: Arbuckle

Water Source for Drilling Operations:
Well X Farm Pond Other Haul water

DWR Permit #: _____

(Note: Apply for Permit with DWR)

Will Cores be taken? Yes No

If Yes, proposed zone: _____

If OWWO: old well information as follows:

Operator: _____

Well Name: _____

Original Completion Date: _____ Original Total Depth: _____

Directional, Deviated or Horizontal wellbore? Yes No

If Yes, true vertical depth: RECEIVED

Bottom Hole Location: KANSAS CORPORATION COMMISSION

KCC DKT #: _____

JUN 25 2003

* LOOK FOR LOST CIRC ZONES 600'-800'

** Conductor pipe is advised

AFFIDAVIT

SKID RIG: PLATT 1-5 15-007-22747

The undersigned hereby affirms that the drilling, completion and eventual plugging of this well will comply with K.S.A. 55-101, et. seq.

It is agreed that the following minimum requirements will be met:

1. Notify the appropriate district office **prior** to spudding of well;
2. A copy of the approved notice of intent to drill **shall be** posted on each drilling rig;
3. The minimum amount of surface pipe as specified below **shall be set** by circulating cement to the top; in all cases surface pipe **shall be set** through all unconsolidated materials plus a minimum of 20 feet into the underlying formation.
4. If the well is dry hole, an agreement between the operator and the district office on plug length and placement is necessary **prior to plugging**;
5. The appropriate district office will be notified before well is either plugged or production casing is cemented in;
6. If an ALTERNATE II COMPLETION, production pipe shall be cemented from below any usable water to surface within **120 days** of spud date. **In all cases, NOTIFY district office** prior to any cementing.

I hereby certify that the statements made herein are true and to the best of my knowledge and belief.

Date: June 25, 2003 Signature of Operator or Agent: Sally R. Byers Title: Agent

Sally R. Byers

For KCC Use ONLY

API # 15 - 007-22752-0000

** Conductor pipe required NONE feet

Minimum surface pipe required 200 feet per Alt. ①

Approved by: RJPG-25-03

This authorization expires: 12-25-03

(This authorization void if drilling not started within 6 months of effective date.)

Spud date: _____ Agent: _____

Remember to:

- File Drill Pit Application (form CDP-1) with Intent to Drill;
- File Completion Form ACO-1 within 120 days of spud date;
- File acreage attribution plat according to field proration orders;
- Notify appropriate district office 48 hours prior to workover or re-entry;
- Submit plugging report (CP-4) after plugging is completed;
- Obtain written approval before disposing or injecting salt water.

5
34
15W

IN ALL CASES PLOT THE INTENDED WELL ON THE PLAT BELOW

Plat of acreage attributable to a well in a prorated or spaced field

If the intended well is in a prorated or spaced field, please fully complete this side of the form. If the intended well is in a prorated or spaced field complete the plat below showing that the well will be properly located in relationship to other wells producing from the common source of supply. Please show all the wells and within 1 mile of the boundaries of the proposed acreage attribution unit for gas wells and within 1/2 mile of the boundaries of the proposed acreage attribution unit for oil wells.

API No. 15 - _____
 Operator: _____
 Lease: _____
 Well Number: _____
 Field: _____
 Number of Acres attributable to well: _____
 QTR / QTR / QTR of acreage: C - NW - NW

Location of Well: County: _____
 795 _____ feet from S **(N)** (circle one) Line of Section
 670 _____ feet from E **(W)** (circle one) Line of Section
 Sec. 5 Twp. 34 S., R. 15 East West

Is Section Regular or _____ Irregular
If Section is Irregular, locate well from nearest corner boundary.
 Section corner used: ___ NE ___ NW ___ SE ___ SW

PLAT

*(Show location of the well and shade attributable acreage for prorated or spaced wells.)
 (Show footage to the nearest lease or unit boundary line.)*

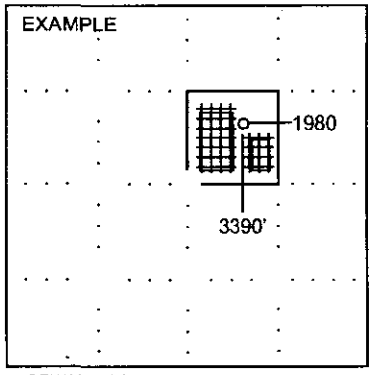
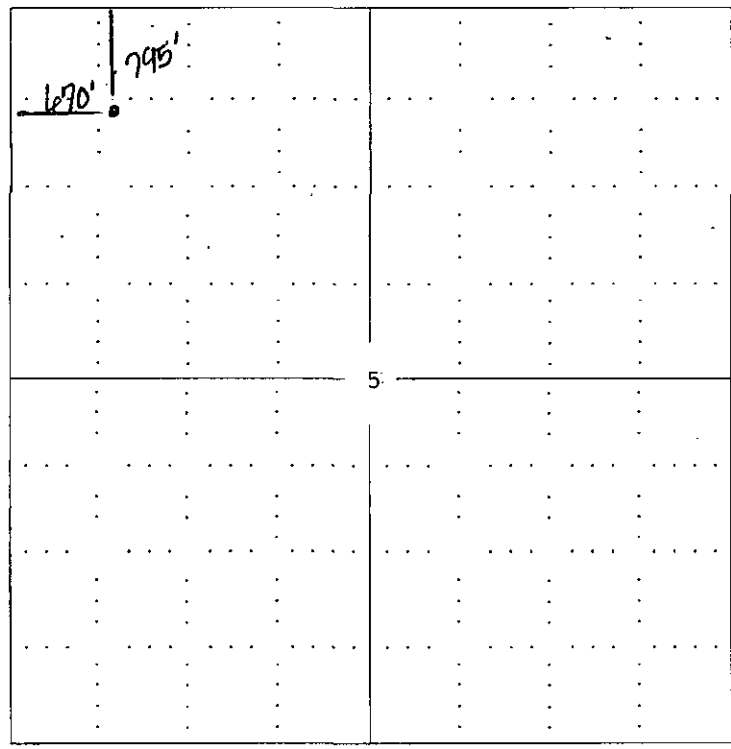

NOTE: In all cases locate the spot of the proposed drilling location.

BARBER COUNTY

In plotting the proposed location of the well, you must show:

1. The manner in which you are using the depicted plat by identifying section lines, i.e. 1 section, 1 section with 8 surrounding sections, 4 sections, etc.
2. The distance of the proposed drilling location from the section's south / north and east / west.
3. The distance to the nearest lease or unit boundary line.
4. If proposed location is located within a prorated or spaced field a certificate of acreage attribution plat must be attached: (C0-7 for oil wells; CG-8 for gas wells).