

owwo

FORM MUST BE TYPED

FORM MUST BE SIGNED

ALL BLANKS MUST BE FILLED

FOR KCC USE:

EFFECTIVE DATE: 7-18-95

DISTRICT #

SGA? Yes No

State of Kansas
NOTICE OF INTENTION TO DRILL

Must be approved by the K.C.C. five (5) days prior to commencing well

Spot APPROX East
NW NE SW Sec 2 Twp 34 S, Rg 14 West

Expected Spud Date August 8 1995
month day year

3000 feet from / North line of Section
3440 feet from East / line of Section
IS SECTION X REGULAR IRREGULAR?
(NOTE: Locate well on the Section Plat on Reverse Side)

OPERATOR: License # 5447
Name: OXY USA INC.
Address: 110 S. Main #800
City/State/Zip: Wichita, Kansas 67202
Contact Person: Tim Voss
Phone: (316) 265-5624

County: Barber

Lease Name: Sooter "B" Well #: 1

Field Name: Aetna

Is this a Prorated/Spaced Field? yes X no

Target Formation(s): Mississippi

Nearest lease or unit boundary: 360'

Ground Surface Elevation: 1677' feet MSL

Water well within one-quarter mile: yes X no

Public water supply well within one mile: yes X no

Depth to bottom of fresh water: 180'

Depth to bottom of usable water: 180'

Surface Pipe by Alternate: X 1 2

Length of Surface Pipe Planned to be set: 373'

Length of Conductor pipe required:

Projected Total Depth: 5280'

Formation at Total Depth: Simpson

Water Source for Drilling Operations:

well farm pond X other

DWR Permit #:

Will Cores Be Taken?: yes X no

If yes, proposed zone:

CONTRACTOR: License # *ADVISE ON ACO-1
Name: Unknown

Well Drilled For:	Well Class:	Type Equipment:
Oil	Enh Rec	X Infield X Mud Rotary
X Gas	Storage	Pool Ext. Air Rotary
OWWO	Disposal	Wildcat Cable
Seismic;	# of Holes	Other
Other		

If OWWO: old well information as follows:
Operator: Skelly Oil Company
Well Name: Sooter "A" #1
Comp. Date: 08-26-65

Directional, Deviated or Horizontal wellbore? yes X no
If yes, true vertical depth:
Bottom Hole Location:

AFFIDAVIT

RECEIVED
KANSAS CORPORATION COMMISSION

JUL 07 1995

7-7-95

CONSERVATION DIVISION

The undersigned hereby affirms that the drilling, completion and eventual plugging of this well will comply with K.S.A. 55-101, et. seq.

It is agreed that the following minimum requirements will be met:

1. Notify the appropriate district office prior to spudding of well;
2. A copy of the approved notice of intent to drill shall be posted on each drilling rig;
3. The minimum amount of surface pipe as specified below shall be set by circulating cement to the top, with a cases surface pipe shall be set through all unconsolidated materials plus a minimum of 20 feet into the underlying formation;
4. If the well is dry hole, an agreement between the operator and the district office on plug length and placement is necessary prior to plugging;
5. The appropriate district office will be notified before well is either plugged or production casing is cemented in;
6. IF AN ALTERNATE II COMPLETION, PRODUCTION PIPE SHALL BE CEMENTED FROM BELOW ANY USABLE WATER TO SURFACE WITHIN 120 DAYS OF SPUD DATE. IN ALL CASES, NOTIFY DISTRICT OFFICE PRIOR TO ANY CEMENTING.

I hereby certify that the statements made herein are true and to the best of my knowledge and belief.

Date: 07-05-94 Signature of Operator or Agent: Tim Voss Title: Operations Engineer

FOR KCC USE:
 API # 15- 007-01-0460001
 Conductor pipe required NONE feet
 Minimum surface pipe required 373' feet per Alt. 1 X
 Approved by: JK 7-13-95
 This authorization expires: 1-13-96
 (This authorization void if drilling not started within 6 months of effective date.)
 Spud date: Agent:

2
34
140

REMEMBER TO:

- File Drill Pit Application (form CDP-1) with Intent to Drill;
- File Completion Form ACO-1 within 120 days of spud date;
- File acreage attribution plat according to field proration orders;
- Notify appropriate district office 48 hours prior to workover or re-entry;
- Submit plugging report (CP-4) after plugging is completed;
- Obtain written approval before disposing or injecting salt water.

Mail to: Conservation Division, 200 Colorado Derby Building, 202 W. First St., Wichita, Kansas 67202-1286.

IN ALL CASES PLOT THE INTENDED WELL ON THE PLAT BELOW

PLAT OF ACREAGE ATTRIBUTABLE TO A WELL IN A PRORATED OR SPACED FIELD

If the intended well is in a prorated or spaced field, please fully complete this side of the form. If the intended well is in a prorated or spaced field complete the plat below showing that the well will be properly located in relationship to other wells producing from the common source of supply. Please show all the wells within 1 mile of the boundaries of the proposed acreage attribution unit for gas wells and within 1/2 mile of the boundaries of the proposed acreage attribution unit for oil wells.

API NO. 15- _____
 OPERATOR OXY USA INC.
 LEASE Sooter "B"
 WELL NUMBER 1
 FIELD Aetna

LOCATION OF WELL: COUNTY Barber
3000 feet from /north line of section
3440 feet from east/ line of section
 SECTION 2 TWP 34S RG 14W

NUMBER OF ACRES ATTRIBUTABLE TO WELL 160
 QTR/QTR/QTR OF ACREAGE NW - NE - SW

IS SECTION X REGULAR or _____ IRREGULAR
IF SECTION IS IRREGULAR, LOCATE WELL FROM NEAREST CORNER BOUNDARY.

Section corner used: _____ NE _____ NW _____ SE _____ SW

PLAT

(Show location of the well and shade attributable acreage for prorated or spaced wells.)
 (Show footage to the nearest lease or unit boundary line.)

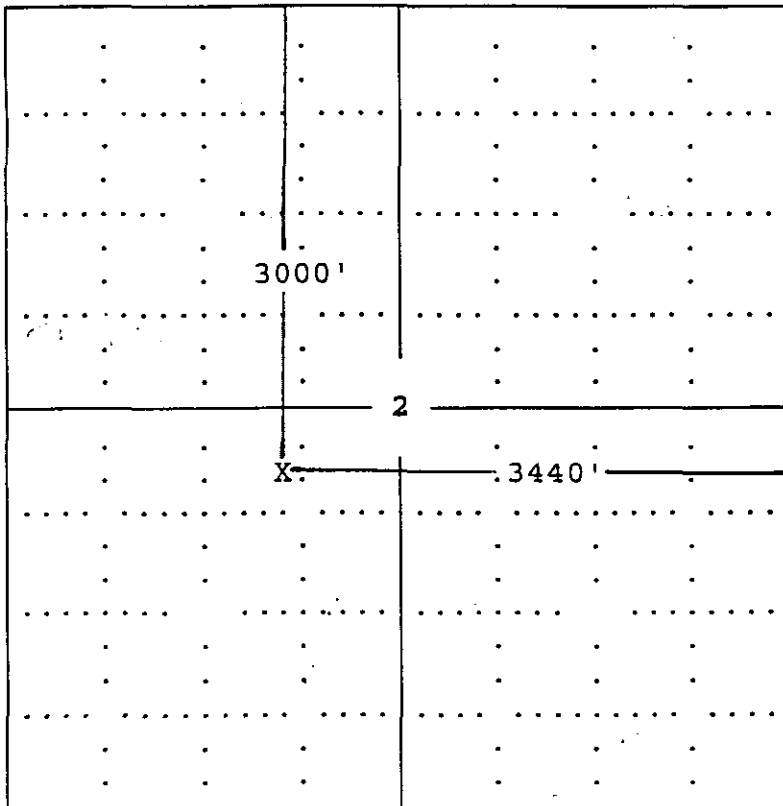

RECEIVED
 KANSAS CORPORATION COMMISSION
 JUL 07 1995
 CONSERVATION DIVISION
 WICHITA, KS

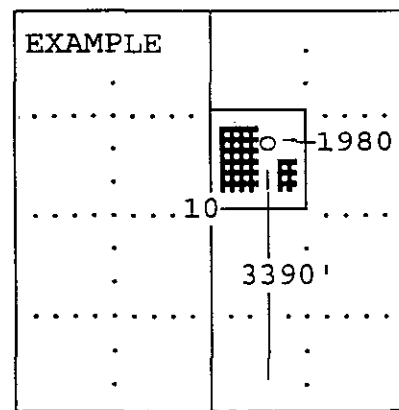

SEWARD CO.

BARBER County

In plotting the proposed location of the well, you must show:

- 1) The manner in which you are using the depicted plat by identifying section lines, i.e. 1 section, 1 section with 8 surrounding sections, 4 sections, etc.;
- 2) the distance of the proposed drilling location from the section's south/north and east/west; and
- 3) the distance to the nearest lease or unit boundary line.