

STATE OF KANSAS  
STATE CORPORATION COMMISSION

WELL PLUGGING RECORD

Give All Information Completely  
Make Required Affidavit  
Mail or Deliver Report to  
Conservation Division  
State Corporation Comm.  
245 North Water  
Wichita, KS 67202

Barber County, Sec. 17 Twp. 34 Rge. 14 E/W  
Location as "NE/CNW $\frac{1}{2}$ SW $\frac{1}{2}$ " or footage from lines  
1000' FSL & 330' FWL

Lease Owner Texas West Oil & Gas Corporation  
Lease Name Z-Bar Ranch Well No. 17 #1

Office Address 1480 Midland National Bank Tower  
Character of Well (Completed as Oil, Gas or Dry Hole)  
Location Abandoned

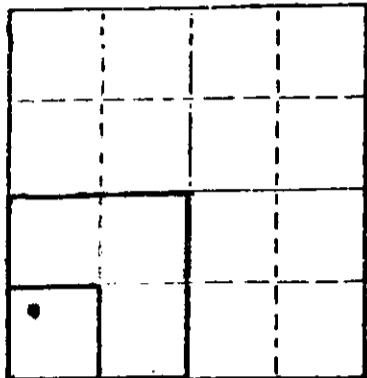

Locate well correctly on above  
Section Plot

Date Well ~~completed~~ abandoned April 13, 1981  
Application for plugging filed - 19  
Application for plugging approved - 19  
Plugging commenced - 19  
Plugging completed April 13 1981

Reason for abandonment of well or producing formation  
Earth washed out under Rig.

If a producing well is abandoned, date of last production  
19

Was permission obtained from the Conservation Division or  
its agents before plugging was commenced? No

Name of Conservation Agent who supervised plugging of this well  
Producing formation \_\_\_\_\_ Depth to top \_\_\_\_\_ Bottom \_\_\_\_\_ Total Depth of Well \_\_\_\_\_  
Show depth and thickness of all water, oil and gas formations.

OIL, GAS OR WATER RECORDS

CASING RECORD

FORMATION	CONTENT	FROM	TO	SIZE	PUT IN	PULLED OUT
Hard Rock		0'	56'	16"	56'	NONE

Describe in detail the manner in which the well was plugged, indicating where the mud fluid was placed and the method or methods used in introducing it into the hold. If cement or other plugs were used, state the character of same and depth placed, from \_\_\_\_\_ feet to \_\_\_\_\_ feet for each plug set.

Plugged Rat-Hole & Mouse-Hole; drilled 24" hole to 56' and set 16" Conductor pipe @ 56' & Cmtd w/ready-mix by rathole machine; dug working pit & cleaned up location; skidded rig to new hole.

(If additional description is necessary, use BACK of this sheet)

Name of Plugging Contractor Dunne-Gardner Petroleum, Inc.

STATE OF Texas COUNTY OF Midland, ss.  
Alice Sandell (employee of owner) ~~brother of owner~~

of the above-described well, being first duly sworn on oath, says: That I have knowledge of the facts, statements, and matters herein contained and the log of the above-described well as filed and that the same are true and correct. So help me God.

(Signature) by: Alice Sandell Texas West Oil & Gas Corporation  
1480 Midland National Bank Tower, Midland, TX  
(Address)

SUBSCRIBED AND SWORN TO before me this 5th day of May, 1981

My commission expires 06/06/84

J. Yvonne Edwards  
J. Yvonne Edwards Notary Public in and  
for Midland County, Texas

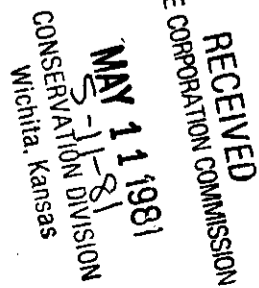

KANSAS

WELL COMPLETION REPORT AND  
DRILLER'S LOG

S. 17 T. 34S R. 14 <sup>E</sup> W

Loc. NW<sup>1</sup>/<sub>4</sub> SW<sup>1</sup>/<sub>4</sub> SW<sup>1</sup>/<sub>4</sub>

County Barber

API No. 15 — 007 — 21,083-0000  
County Number

Operator  
Texas West Oil & Gas Corporation

Address  
1480 Midland National Bank Tower

Well No. 1-17 Lease Name Z-Bar Ranch

Footage Location  
1000 feet from (N) (S) line 330 feet from (E) (W) line

Principal Contractor Dunne-Gardner Petroleum, Inc. Geologist Ed Sander

Spud Date 04/10/81 Date Completed 04/13/81 Total Depth 100' P.B.T.D.

Directional Deviation Oil and/or Gas Purchaser

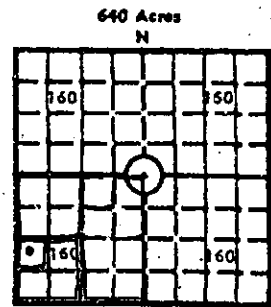

Locate well correctly  
Elev.: Gr. 1610'

DF KB

CASING RECORD

Report of all strings set — surface, intermediate, production, etc.

Purpose of string	Size hole drilled	Size casing set (in O.D.)	Weight lbs/ft.	Setting depth	Type cement	Sacks	Type and percent additives
Conductor	24"	16"		56'	Ready-Mix		
(Location washed out rig skidded)							

LINER RECORD

PERFORATION RECORD

Top, ft.	Bottom, ft.	Sacks cement	Shots per ft.	Size & type	Depth interval
TUBING RECORD					
Size	Setting depth	Packer set at			

ACID, FRACTURE, SHOT, CEMENT SQUEEZE RECORD

Amount and kind of material used	Depth interval treated

INITIAL PRODUCTION

Date of first production		Producing method (flowing, pumping, gas lift, etc.)			
RATE OF PRODUCTION PER 24 HOURS	Oil	Gas	Water	Gas-oil ratio	
	bbls.	MCF	bbls.	CFPB	
Disposition of gas (vented, used on lease or sold)			Producing interval(s)		

INSTRUCTIONS: As provided in KCC Rule 82-2-125, within 90 days after completion of a well, one completed copy of this Drillers Log shall be transmitted to the State Geological Survey of Kansas, 4150 Monroe Street, Wichita, Kansas 67209. Copies of this form are available from the Conservation Division, State Corporation Commission, 245 No. Water, Wichita, Kansas 67202. Phone AC 316-522-2206. If confidential custody is desired, please note Rule 82-2-125. Drillers Logs will be on open file in the Oil and Gas Division, State Geological Survey of Kansas, Lawrence, Kansas 66044.

Operator

Texas West Oil & Gas Corporation

DESIGNATE TYPE OF COMP.: OIL, GAS, DRY HOLE, SWDW, ETC.:

Location washed out; skidded ri

Well No.

1-17

Lease Name

Z-Bar Ranch

S 17 T 34S R 14 W

WELL LOG

Show all important zones of porosity and contents thereof; cored interval, and all drill-stem tests, including depth interval tested, cushion used, time tool open, flowing and shut-in pressures, and recoveries.

SHOW GEOLOGICAL MARKERS, LOGS RUN, OR OTHER DESCRIPTIVE INFORMATION.

FORMATION DESCRIPTION, CONTENTS, ETC.	TOP	BOTTOM	NAME	DEPTH
Surface Rock	0	100' TD		

USE ADDITIONAL SHEETS, IF NECESSARY, TO COMPLETE WELL RECORD.

Date Received

*Wes Small*

Signature

Office Manager

Title

7 May 1981

Date