

STATE OF KANSAS  
STATE CORPORATION COMMISSION  
200 Colorado Derby Building  
Wichita, Kansas 67202

WELL PLUGGING RECORD  
K.A.R.-82-3-117

15-007-21049-00-00

API NUMBER \_\_\_\_\_

LEASE NAME Brownback #1-29

TYPE OR PRINT  
NOTICE: Fill out completely  
and return to Cons. Div.  
office within 30 days.

WELL NUMBER \_\_\_\_\_

SPOT LOCATION C SE

SEC 29 TWP. 34 RGE. 15w(E) or (W)

COUNTY Barber

Date Well Completed \_\_\_\_\_

LEASE OPERATOR Midwestern Supply Co., Inc.

ADDRESS 300 Patton Rd. Great Bend, Ks. 67530

PHONE # (316) 793-8521 OPERATORS LICENSE NO. 8778

Plugging Commenced 9/14/84

Plugging Completed 9/27/84

Character of Well \_\_\_\_\_  
(Oil, Gas, D&A, SWD, Input, Water Supply Well)

Did you notify the KCC/KDHE Joint District Office prior to plugging this well? Yes

Which KCC/KDHE Joint Office did you notify? Dodge City

Is ACO-1 filed? \_\_\_\_\_ If not, is well log attached? \_\_\_\_\_

Producing formation \_\_\_\_\_ Depth to top \_\_\_\_\_ bottom T.D. 4950'

Show depth and thickness of all water, oil and gas formations.

OIL, GAS OR WATER RECORDS

CASING RECORD

Formation	Content	From	To	Size	Put in	Pulled out
				8 5/8 4 1/2"	894' 4950'	none 3250'

Describe in detail the manner in which the well was plugged, indicating where the mud fluid was placed and the method or methods used in introducing it into the hole. If cement or other plugs were used state, the character of same and depth placed, from feet to feet each set.

Pushed plug to 4650', sanded to 4600', & ran 4 sacks cement. Shot pipe at 3617', 3407', & 3250'. Pulled 79 joints of pipe. Plugged well with 3 hulls, 15 gel, 50 cement, 10 gel, 1 hull; released plug & 150 sacks cement.

Plugging complete.

(If additional description is necessary, use BACK of this form.)

Name of Plugging Contractor Kelso Casing Pulling License No. 6050  
Address Box 347, Chase, Ks. 67524

STATE OF Kansas COUNTY OF Rice, ss.

R. Darrell Kelso (employee of operator) or (operator) of above-described well, being first duly sworn on oath, says: That I have knowledge of the facts, statements, and matters herein contained and the log of the above-described well as filed that the same are true and correct, so help me God.

(Signature) R. Darrell Kelso

(Address) Box 347, Chase, Ks. 67524

SUBSCRIBED AND SWORN TO before me this 1st day of October, 1984



My Commission expires: \_\_\_\_\_

RECEIVED  
STATE CORPORATION DIVISION

OCT 04 1984

Form CP-4 / 1-8  
Revised 06-83

API No. 15 107 22146  
 County Ember

Lease Ember  
 County Ember

Operator  
**F.C.D. OIL CORPORATION**

Address  
**P.O. Box 5589 Enid, OK 73702**

Well No. 1-29 Lease Name Brownback

Footage Location  
1320 feet from XX (S) line 1320 feet from (E) XX line

Principal Contractor DaMac Drilling, Inc. Geologist Walter L. Baker

Spud Date 11-16-80 Date Completed 6-3-81 Total Depth 4950' P.B.T.D. 4885'

Directional Deviation None Oil and/or Gas Purchaser Western Crude - oil

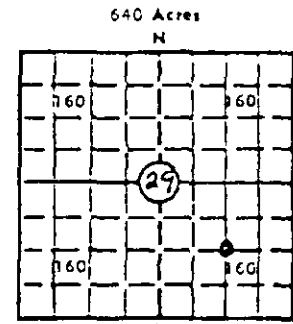

Elev.: Gr. 1606  
 DF - KB 1616

**CASING RECORD**

Report of all strings set— surface, intermediate, production, etc.

Purpose of string	Size hole drilled	Size casing set (in O.D.)	Weight lbs/ft.	Setting depth	Type cement	Sacks	Type and percent additives
Surface	7 7/8	8 5/8	20#	894'	Class H	500	2% CC, 1/4# Flo
Production	7 7/8	4 1/2	10.5#	4950'	Rodman Mix	300	None

**LINER RECORD**

**PERFORATION RECORD**

Top, ft.	Bottom, ft.	Sacks cement	Shots per ft.	Size & type	Depth interval
-	-	-	4	Jet - 1/2"	4876-4885'

Size	Setting depth	Packer set at
2 3/8	4804'	None

**ACID, FRACTURE, SHOT, CEMENT SQUEEZE RECORD**

Amount and kind of material used	Depth interval treated
Acidized w/2000 gal 15% DS-30	4876-4885'
Frac w/20,000 gal gel KCL water & 20,000#, 20/40 sd	4876-4885'

**RECEIVED**  
 STATE CORPORATION COMMISSION

**INITIAL PRODUCTION**

Date of first production 8/3/81 Producing method (flowing, pumping, gas lift, etc.) Pumping

RATE OF PRODUCTION PER 24 HOURS  
 Oil 6 bbls. Gas 150 MCF Water 40 bbls. Gas-oil 25,000 CFPB

Disposition of gas (vented, used on lease or sold) venting Producing interval (s) 4876-4885'

SEP 07 1981

CONSERVATION DIVISION

INSTRUCTIONS: As provided in KCC Rule 82-2-125, within 90 days after completion of a well, one completed copy of this Drillers Log shall be transmitted to the State Geological Survey of Kansas, 4150 Monroe Street, Wichita, Kansas 67209. Copies of this form are available from the Conservation Division, State Corporation Commission, 245 No. Water, Wichita, Kansas 67202. Phone AC 316-522-2206. If confidential custody is desired, please note Rule 82-2-125. Drillers Logs will be an open file in the Oil and Gas Division, State Geological Survey of Kansas, Lawrence, Kansas 66044.