

STATE OF KANSAS
STATE CORPORATION COMMISSION

Give All Information Completely
Make Required Affidavit
Mail or Deliver Report to:
Conservation Division
State Corporation Commission
211 No. Broadway
Wichita, Kansas

WELL PLUGGING RECORD

NORTH

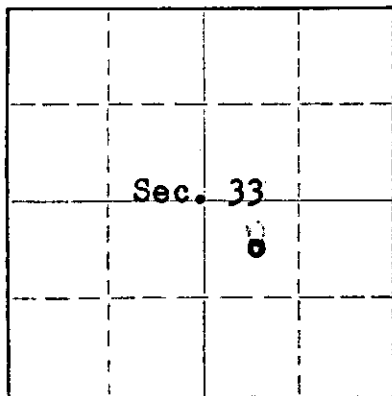

Locate well correctly on above
Section Plat

BARBER County. Sec. 33 Twp. 34 Rge. 12 (X W(W)
Location as "NE/CNWxSWx" or footage from lines C NW SE
Lease Owner PETROLEUM, INC.
Lease Name GRAVES "F"
Office Address ROUTE 2, GREAT BEND, KANSAS
Character of Well (completed as Oil, Gas or Dry Hole) DRY HOLE
Date well completed April 10, 1958
Application for plugging filed April 10, 1958
Application for plugging approved April 10, 1958
Plugging commenced April 10, 1958
Plugging completed April 10, 1958
Reason for abandonment of well or producing formation
No Produccible Zones
If a producing well is abandoned, date of last production None 19
Was permission obtained from the Conservation Division or its agents before plugging was commenced? Yes

Name of Conservation Agent who supervised plugging of this well W.L. Lackamp, Route 1, Stafford, Kansas
Producing formation ----- Depth to top --- Bottom --- Total Depth of Well 4843' Feet
Show depth and thickness of all water, oil and gas formations.

OIL, GAS OR WATER RECORDS

CASING RECORD

FORMATION	CONTENT	FROM	TO	SIZE	PUT IN	PULLED OUT
				8-5/8"	310'	None

Describe in detail the manner in which the well was plugged, indicating where the mud fluid was placed and the method or methods used in introducing it into the hole. If cement or other plugs were used, state the character of same and depth placed, from ----- feet to ----- feet for each plug set.

Mud up with heavy mud to 300' pushed down 1/3 sack hulls to 300' followed by wooden plug, placed 20 sacks cement through drill pipe on to plug. Mud up to 40' and placed 1/3 sack hulls at 40' followed by wooden plug and 10 sacks cement to base of well cellar.

RECEIVED
STATE CORPORATION COMMISSION

APR 19 1958

4-19-58

CONSERVATION DIVISION

Wichita, Kansas

Name of Plugging Contractor GARVEY DRILLING COMPANY
Address ROUTE 2, GREAT BEND, KANSAS

STATE OF KANSAS, COUNTY OF BARTON, SS.
Don Searle

(employee of owner) or (owner) of the above-described well, being first duly sworn on oath, says: That I have knowledge of the facts, statements, and matters herein contained and the log of the above-described well as filed and that the same are true and correct. So help me God.

(Signature)

Route 2, Great Bend, Kansas

(Address)

SUBSCRIBED AND SWORN to before me this 18th day of April 1958

My commission expires July 11, 1960

Notary Public.

PLUGGING

FILE SEC. 33 T. 34 R. 12W
BOOK PAGE 92 LINE 42

15-007-61683-0000
WELL LOG

COMPANY PETROLEUM, INCORPORATED

SEC. 33 T. 34S R. 12W

FARM GRAVES "F" NO. 1

LOC. C-NW, SE

TOTAL DEPTH 4843'

COUNTY BARBER CO. & KANSAS

COMM. March 26, 1958

COMP. April 10, 1958

CONTRACTOR GARVEY DRILLING COMPANY

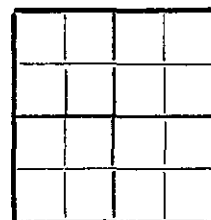

CASING 8 5/8" @ 310' W/200 sax.

ELEVATION 1439' DF

PRODUCTION D & A

FIGURES INDICATE BOTTOM OF FORMATIONS

140	Clay, red bed & shale
719	Red bed & shale
1485	Shale & shells
1520	Anhydrite
1560	Shale & shells
1700	Shale
2547	Lime & shale
3030	Shale & lime
3848	Lime & shale
3917	Lime
4435	Lime & shale
4750	Lime
4760	Lime & shale
4795	Lime & chert
4837	Lime & shale
4843	Chert
4843	T. D.

RECEIVED
STAT. CORPORATION COMMISSION

APR 19 1958
4-19-58
CONSERVATION DIVISION
Wichita, Kansas

State of KANSAS }
County of BARTON } ss:

PLUGGING

FILE SEC 33 T. 34 R. 12W
BOOK PAGE 92 LINE 32

I, VERNE A. MORRIS of GARVEY DRILLING COMPANY

upon oath state that the above and foregoing is a true and correct copy of the log of the #1 GRAVES "F" well

Subscribed and sworn to before me this 18th day of April 19 58

My Commission Expires: July 11, 1960

Verne A. Morris
Ed J. Brown
NOTARY PUBLIC