

STATE CORPORATION COMMISSION OF KANSAS
OIL & GAS CONSERVATION DIVISION

WELL COMPLETION OR RECOMPLETION FORM
ACO-1 WELL HISTORY

DESCRIPTION OF WELL AND LEASE

Operator: License # 5701
Name National Oil Company
Address Box 272
City/State/Zip Russell, Kansas 67665

Purchaser KOCH OIL K.C.C.

Operator Contact Person Larry Sutherland
Phone 913-483-6278

Contractor: License # 5671
Name Revlin Drilling, Inc.

Wellsite Geologist STATE CORPORATION COMMISSION
Phone

Designate Type of Completion
 New Well Re-Entry Workover
 Oil SWD Temp Abd
 Gas Inj Delayed Comp.
 Dry Other (Core, Water Supply etc.)

If OWWO: old well info as follows:
Operator
Well Name
Comp. Date Old Total Depth

WELL HISTORY

Drilling Method:
 Mud Rotary Air Rotary Cable
Spud Date 11-14-84 Date Reached TD 11-22-84 Completion Date 3/11/85
Total Depth 4882 PBD none
Amount of Surface Pipe Set and Cemented at 343 feet
Multiple Stage Cementing Collar Used? Yes No
If yes, show depth set feet
If alternate 2 completion, cement circulated from feet depth to W/SX cmt

API NO. 15-033-20,665-00-00
County Comanche
C NE NE Sec. 35 Twp. 31 Rge. 16 East West

4620 Ft North from Southeast Corner of Section
660 Ft West from Southeast Corner of Section
(Note: Locate well in section plat below)

Lease Name Schuette Well # 6

Field Name Schuette

Producing Formation Pawnee

Elevation: Ground 1996 KB 2001
Section Plat K.C.C.

RECEIVED
MAY 06 1985
STATE CORPORATION COMMISSION
Wichita, Kansas

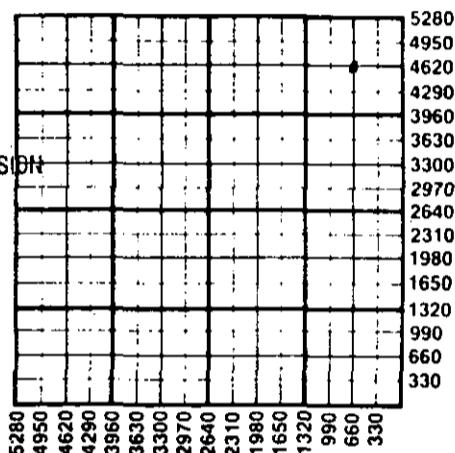

WATER SUPPLY INFORMATION

Disposition of Produced Water: Disposal Repressuring
Docket #

Questions on this portion of the ACO-1 call:
Water Resources Board (913) 296-3717

Source of Water:
Division of Water Resources Permit #
 Groundwater (Well) Ft North from Southeast Corner
Ft West from Southeast Corner
Sec Twp Rge East West
 Surface Water (Stream, pond etc) Ft North from Southeast Corner
Ft West from Southeast Corner
Sec Twp Rge East West
 Other (explain) Farmers Pond (purchased from city, R.W.D. #)

INSTRUCTIONS: This form shall be completed in duplicate and filed with the Kansas Corporation Commission, 200 Colorado Derby Building, Wichita, Kansas 67202, within 90 days after completion or recompletion of any well. Rule 82-3-130 and 82-3-107 apply. Information on side two of this form will be held confidential for a period of 12 months if requested in writing and submitted with the form. See rule 82-3-107 for confidentiality in excess of 12 months. One copy of all wireline logs and drillers time log shall be attached with this form. Submit CP-4 form with all plugged wells. Submit CP-111 form with all temporarily abandoned wells.

All requirements of the statutes, rules and regulations promulgated to regulate the oil and gas industry have been fully complied with and the statements herein are complete and correct to the best of my knowledge.

Signature [Signature]
Title Reservoir Engineer Date 5-1-85

Subscribed and sworn to before me this 1st day of May 1985
Notary Public Kathy A. Case
Date Commission Expires 4/30/86

K.C.C. OFFICE USE ONLY
F Letter of Confidentiality Attached
C Wireline Log Received
C Drillers Timelog Received
Distribution
 KCC SWD/Rep NGPA
 KGS Plug Other (Specify)

Sec 35 Twp 31 Rge 16 W

SIDE TWO

Operator Name **National Oil Company** Lease Name..... **Schuetz** Well #... **6**...

Sec. **35** Twp. **31** Rge. **16** East West County..... **Comanche**

WELL LOG

INSTRUCTIONS: Show important tops and base of formations penetrated. Detail all cores. Report all drill stem tests giving interval tested, time tool open and closed, flowing and shut-in pressures, whether shut-in pressure reached static level, hydrostatic pressures, bottom hole temperature, fluid recovery, and flow rates if gas to surface during test. Attach extra sheet if more space is needed. Attach copy of log.

Drill Stem Tests Taken Yes No
 Samples Sent to Geological Survey Yes No
 Cores Taken Yes No

Formation Description
 Log Sample

DST #1 4755-4815', OP-16, SI-22, OP-31, SI-60
 ISIP-886, IFP-112, IHP-2342, FSIP-886, FFP-97,
 FHP-2321, BHT-110°F. Rec 100' mud.

Name	Top	Bottom
Heebner	4114	
Lansing	4288	
Pawnee	4767	
Ft. Scott	4812	
T/Miss.	4850	

CASING RECORD <input checked="" type="checkbox"/> New <input type="checkbox"/> Used								
Report all strings set-conductor, surface, intermediate, production, etc.								
Purpose of String	Size Hole Drilled	Size Casing Set (in O.D.)	Weight Lbs/Ft.	Setting Depth	Type of Cement	#Sacks Used	Type and Percent Additives	
Surface	12 1/4	8 5/8	240	343	Sup. Set. Common	200 100		
Production	7 7/8	9 1/2	15.54	6881.07	Class A	170	2% gel. 2% CC 7% sil. par. sk.	
PERFORATION RECORD				Acid, Fracture, Shot, Cement Squeeze Record				
Shots Per Foot	Specify Footage of Each Interval Perforated			Amount and Kind of Material Used			Depth	
2 spf	4812-16			500 gals 15% Mud acid			4790	
2 spf	4768-72, 4780-82, 4785-88			500 gals 15% Mud acid			4755	
TUBING RECORD				Liner Run	<input checked="" type="checkbox"/> Yes <input type="checkbox"/> No			
Size		Set At	Packer at					
2 7/8		4785	4755					
Date of First Production		Producing Method						
3/11/85		<input type="checkbox"/> Flowing <input checked="" type="checkbox"/> Pumping <input type="checkbox"/> Gas Lift <input type="checkbox"/> Other (explain).....						
Estimated Production Per 24 Hours		Oil	Gas	Water	Gas-Oil Ratio	Gravity		
		1 Bbls	13.1MCF	25 Bbls	CFPB			

METHOD OF COMPLETION

Production Interval

Disposition of gas: Vented Open Hole Perforation Other (Specify) 4768-88
 Sold Other (Specify)
 Used on Lease Dually Completed Commingled

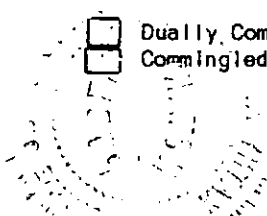



Dual Induction Log

FILE NO.	COMPANY NATIONAL OIL COMPANY		
	WELL SCHUETTE NO. 6		
	FIELD		
	COUNTY COMMANCHE	STATE KANSAS	
	LOCATION: C-NE-NE		OTHER SERVICES
	SEC 35	TWP 31S	RGE 16W

Permanent Datum GROUND LEVEL	Elev 2001	Elevations
Log Measured from KELLY BUSHING 5 Ft Above Permanent Datum		KB 2001
Drilling Measured from KELLY BUSHING		DF - -
		GL 1996

Date	11-22-84				
Run No.	ONE				
Depth-Driller	4820				
Depth-Logger	4822				
Bottom Logged Interval	4881				
Top Logged Interval	SURFACE				
Casing-Driller	8-5/8 @ 350				
Casing-Logger	- -				
Bit Size	7-7/8				
Type Fluid in Hole	DRILLING MUD				
	PPM 11,000				
Density and Viscosity	9.3 40				
pH and Fluid Loss	10.0 11.2cc		cc		cc
Source of Sample	FLOWLINE				
Rm @ Meas. Temp.	.95 @ 51 °F				
Rmf @ Meas. Temp.	.60 @ 51 °F				
Rmc @ Meas. Temp.	1.2 @ 51 °F				
Source of Rmf and Rmc	MEAS				
Rm @ BHT	.39 @ 123 °F				
Time Since Circ.	3.0 HOURS				
Max. Rec. Temp. Deg. F	123				
Equip. No. and Location	47 M.L.				
Recorded By	C. WISE				
Witnessed By	B. SEDAN				

0661
 STARTED
 10 NOV 1984
 NATIONAL OIL COMPANY
 SPEAKER
 0661