

WELL PLUGGING RECORD

Give All Information Completely
Make Required Affidavit
Mail or Deliver Report to:
Conservation Division
State Corporation Commission
211 No. Broadway
Wichita, Kansas

COMANCHE County, Sec. 8 Twp. 31s Rge. 16w (X) (W)

Location as "NE/CNWxSWx" or footage from lines APP. W/2 W/2 W/2 NW

Lease Owner PETROLEUM, INC.,

Lease Name TRUMMEL UNIT Well No. 1

Office Address ROUTE 2, GREAT BEND, KANSAS

Character of Well (completed as Oil, Gas or Dry Hole) DRY HOLE

Date well completed MAY 19, 19 63

Application for plugging filed MAY 19, 19 63

Application for plugging approved MAY 19, 19 63

Plugging commenced MAY 19, 19 63

Plugging completed MAY 19, 19 63

Reason for abandonment of well or producing formation NO PRODUCIBLE FORMATIONS

If a producing well is abandoned, date of last production NONE 19

Was permission obtained from the Conservation Division or its agents before plugging was commenced? YES

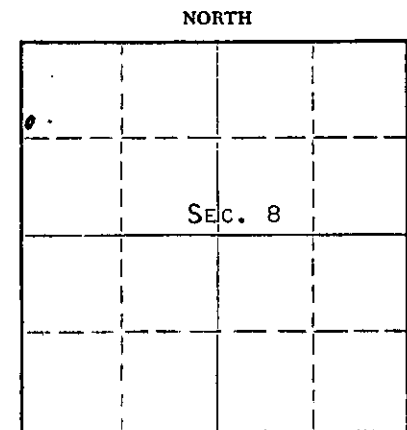

Locate well correctly on above Section Plat

Name of Conservation Agent who supervised plugging of this well ARCHIE ELVING

Producing formation - - Depth to top - - Bottom - - Total Depth of Well 5015 Feet

Show depth and thickness of all water, oil and gas formations.

OIL, GAS OR WATER RECORDS

CASING RECORD

FORMATION	CONTENT	FROM	TO	SIZE	PUT IN	PULLED OUT
				8-5/8"	502'	NONE

Describe in detail the manner in which the well was plugged, indicating where the mud fluid was placed and the method or methods used in introducing it into the hole. If cement or other plugs were used, state the character of same and depth placed, from feet to feet for each plug set.

MUDDED UP WITH HEAVY MUD TO 240' FOLLOWED BY WOODEN PLUG AND 1/4 SACK HULLS. PLACED 20 SACKS CEMENT ONTO HULLS THROUGH DRILL PIPE. MUDDED UP WITH HEAVY MUD TO 40' FOLLOWED BY WOODEN PLUG AND 10 SACKS CEMENT TO BASE OF WELL CELLAR.

RECEIVED
STATE CORPORATION COMMISSION

MAY 28 1963

CONSERVATION DIVISION
Wichita, Kansas

(If additional description is necessary, use BACK of this sheet)

Name of Plugging Contractor GARVEY DRILLING COMPANY

Address ROUTE 2, GREAT BEND, KANSAS

STATE OF KANSAS COUNTY OF BARTON, ss.

(employee of owner) or (owner or operator) of the above-described well, being first duly sworn on oath, says: That I have knowledge of the facts, statements, and matters herein contained and the log of the above-described well as filed and that the same are true and correct. So help me God.

(Signature) DON SEARLE, DIST. PROD. SUPT.

ROUTE 2, GREAT BEND, KANSAS (Address)

SUBSCRIBED AND SWORN TO before me this 24TH day of MAY, 19 63

My commission expires APRIL 14, 1967

(Signature) Notary Public.

WELL LOG

COMPANY Petroleum Inc

SEC. 8 T. 31S R. 16W

FARM Trummel NO. Unit #1

LOC. App W/2 W/2 W/2 NW

TOTAL DEPTH 5015'

COUNTY Commanche

COMM. 5-4-63 COMP. 5-19-63

CONTRACTOR Garvey Drilling Company

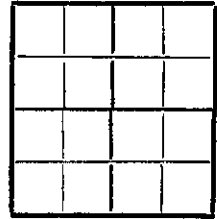

CASING 8 5/8" @ 502' w/300 sx

ELEVATION 2067' D.F.

PRODUCTION D & A

FIGURES INDICATE BOTTOM OF FORMATIONS

40' Surface Soil and Clay
70' Sand
160' Shale and Shells
420' Gyp Rock and Red Bed
440' Sand
1000' Red Bed
2025' Shale and Shells
2055' Shale
2290' Shale and Lime
2690' Lime
3725' Lime and Shale
3730' Lime
4025' Lime and Shale
4275' Lime
4355' Lime and Shale
5015' Lime
5015' RTD

RECEIVED
STATE CORPORATION COMMISSION

MAY 28 1963

CONSERVATION DIVISION
Wichita, Kansas

State of Kansas }
County of Barton } ss

I, Sam N. Stephens of Garvey Drilling Company

upon oath state the above and foregoing is a true and correct copy of the log of the Trummel Unit #1 well.

Sam N. Stephens

Subscribed and sworn to before me this 23rd day of May 19 63

My Commission Expires: April 14th, 1967

Arthur J. Wiles
NOTARY PUBLIC