

FOR KCC USE:

FORM C-1 7/91

EFFECTIVE DATE: 8-19-96

State of Kansas

FORM MUST BE TYPED

DISTRICT # 1

NOTICE OF INTENTION TO DRILL

FORM MUST BE SIGNED

SGA? Yes No

Must be approved by the K.C.C. five (5) days prior to commencing well

ALL BLANKS MUST BE FILLED

Spot

Expected Spud Date ... September ... 3 ... 1996 ... month day year

Sec ..36. Twp ..34. S, Rg ..14. X West

.....330..... feet from North Line of Section 1850..... feet from West Line of Section

OPERATOR: License # ... 5447 ... Name: ... OXY USA INC ... Address: ... 110 S. Main #800 ... City/State/Zip: ... Wichita, Kansas ..67202 ... Contact Person: ... Tim Voss ... Phone: ... (316) ..265-2040

IS SECTION X REGULAR IRREGULAR?

(NOTE: Locate well on the Section Plat on Reverse Side)

CONTRACTOR: License #: ... Name: ... (Unknown at this time) Advice on ACO-1

County: ... Barber ...

Lease Name: ... Sutton "C" ... Well #: ... 2 ...

Field Name: ... Aetna ...

Is this a Prorated/Spaced Field? ... yes ..X. no

Target Formation(s): ... Mississippi ...

Nearest lease or unit boundary: ... 330' ...

Ground Surface Elevation: ... 1598' ... feet MSL

Water well within one-quarter mile: ... yes ..X. no

Public water supply well within one mile: ... yes ..X. no

Depth to bottom of fresh water: ... 140' ...

Depth to bottom of usable water: ... 180' ...

Surface Pipe by Alternate: ... X. 1 2

Length of Surface Pipe Planned to be set: ... 400' ...

Length of Conductor pipe required: ...

Projected Total Depth: ... 5070' ...

Formation at Total Depth: ... Mississippi ...

Water Source for Drilling Operations: ... well ... farm pond ..X. other

DWR Permit #: ...

Will Cores Be Taken?: ... yes ..X. no

If yes, proposed zone: ...

Well Drilled For: Well Class: Type Equipment:

Oil Enh Rec X. Infield X. Mud Rotary

X. Gas Storage Pool Ext. Air Rotary

OWWO Disposal Wildcat Cable

Seismic; # of Holes Other

Other

If OWWO: old well information as follows:

Operator: ...

Well Name: ...

Comp. Date: ... Old Total Depth

Directional, Deviated or Horizontal wellbore? ... yes ..X. no

If yes, true vertical depth: ...

Bottom Hole Location: ...

AFFIDAVIT

The undersigned hereby affirms that the drilling, completion and eventual plugging of this well will comply with K.S.A. 55-101, et. seq.

It is agreed that the following minimum requirements will be met:

- 1. Notify the appropriate district office prior to spudding of well;
2. A copy of the approved notice of intent to drill shall be posted on each drilling rig;
3. The minimum amount of surface pipe as specified below shall be set by circulating cement to the top; in all cases surface pipe shall be set through all unconsolidated materials plus a minimum of 20 feet into the underlying formation;
4. If the well is dry hole, an agreement between the operator and the district office on plug length and placement is necessary prior to plugging;
5. The appropriate district office will be notified before well is either plugged or production casing is cemented in;
6. IF AN ALTERNATE II COMPLETION, PRODUCTION PIPE SHALL BE CEMENTED FROM BELOW ANY USABLE WATER TO SURFACE WITHIN 120 DAYS OF SPUD DATE. IN ALL CASES, NOTIFY DISTRICT OFFICE PRIOR TO ANY CEMENTING.

I hereby certify that the statements made herein are true and to the best of my knowledge and belief.

Date: ... 8-13-96 ... Signature of Operator or Agent: Timothy J. Voss Title: Engineer

FOR KCC USE: API # 15- 007-225170000 Conductor pipe required NONE feet Minimum surface pipe required 200 feet per Alt. DX Approved by: DPW 8-14-96 This authorization expires: 2-14-97 (This authorization void if drilling not started within 6 months of effective date.) Spud date: Agent:

REMEMBER TO:

- File Drill Pit Application (form CDP-1) with Intent to Drill;
- File Completion Form ACO-1 within 120 days of spud date;
- File acreage attribution plat according to field prorations orders;
- Notify appropriate district office 48 hours prior to workover or re-entry;
- Submit plugging report (CP-4) after plugging is completed;
- Obtain written approval before disposing or injecting salt water.

Mail to: Conservation Division, Wichita State Office Bldg, 130 S. Market, Rm 2078 Wichita, Kansas 67202-1286.

RECEIVED CORPORATION COMMISSION 8-13-96 AUG 13 1996

36 34 14w

IN ALL CASES PLOT THE INTENDED WELL ON THE PLAT BELOW

PLAT OF ACREAGE ATTRIBUTABLE TO A WELL IN A PRORATED OR SPACED FIELD

If the intended well is in a prorated or spaced field, please fully complete this side of the form. If the intended well is in a prorated or spaced field complete the plat below showing that the well will be properly located in relationship to other wells producing from the common source of supply. Please show all the wells within 1 mile of the boundaries of the proposed acreage attribution unit for gas wells and within 1/2 mile of the boundaries of the proposed acreage attribution unit for oil wells.

API NO. 15- _____
 OPERATOR _____ OXY USA INC. _____
 LOCATION OF WELL: COUNTY Barber
 LEASE Sutton "C" _____ 330 feet from /North line of section
 WELL NUMBER 2 _____ 1850 feet from /West line of section
 FIELD Aetna _____ SECTION 36 TWP 34S RG 14W

NUMBER OF ACRES ATTRIBUTABLE TO WELL _____ IS SECTION X REGULAR or IRREGULAR
 QTR/QTR/QTR OF ACREAGE - - - - - NW IF SECTION IS IRREGULAR, LOCATE WELL FROM NEAREST CORNER BOUNDARY.
 Section corner used: _____ NE _____ NW _____ SE _____ SW

PLAT

(Show location of the well and shade attributable acreage for prorated or spaced wells.)
 (Show footage to the nearest lease or unit boundary line.)

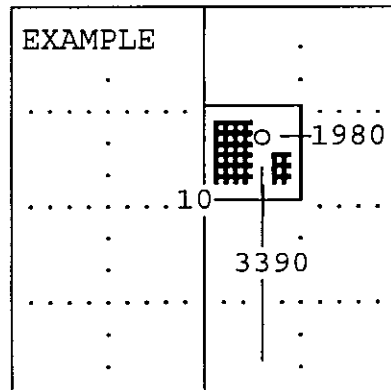
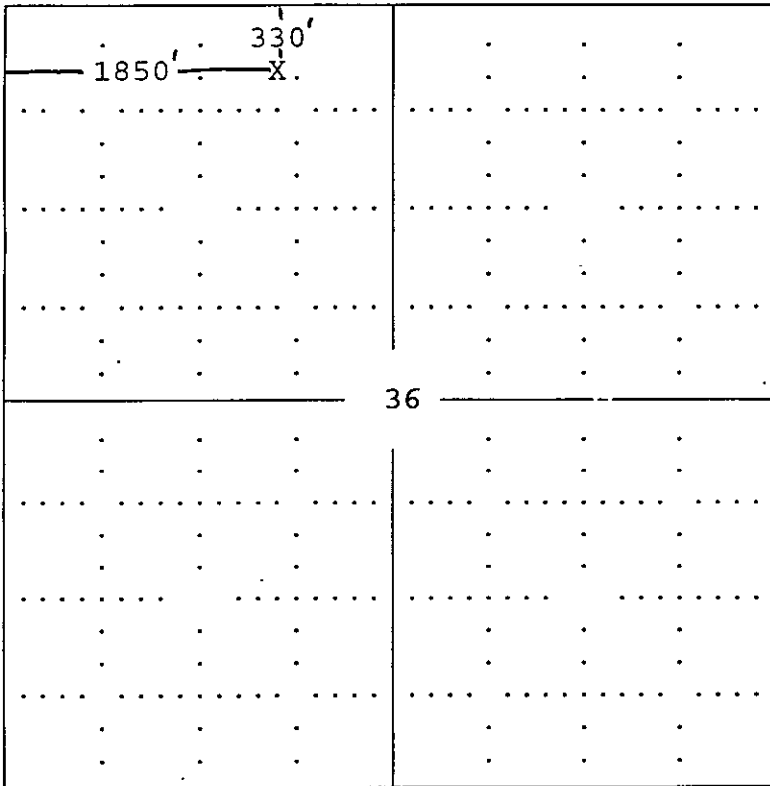

SEWARD CO.

BARBER County

In plotting the proposed location of the well, you must show:

- 1) The manner in which you are using the depicted plat by identifying section lines, i.e. 1 section, 1 section with 8 surrounding sections, 4 sections, etc.;
- 2) the distance of the proposed drilling location from the section's south/north and east/west; and
- 3) the distance to the nearest lease or unit boundary line.

RECEIVED
 STATE CORPORATION COMMISSION

AUG 1 3 1996

STATE CORPORATION COMMISSION
 STATE OF OKLAHOMA