

STATE CORPORATION COMMISSION OF KANSAS
OIL & GAS CONSERVATION DIVISION
WELL COMPLETION OR RECOMPLETION FORM
ACO-1 WELL HISTORY
DESCRIPTION OF WELL AND LEASE

S

API NO. 15-007-22-148-000

County Barber

East
C NE Sec. 35 Twp 33S Rge 14 X West

3960 Ft North from Southeast Corner of Section
1320 Ft West from Southeast Corner of Section
(Note: Locate well in section plat below)

Lease Name LEROY CATTLE COMPANY B Well # 1

Field Name Aetna

Producing Formation Dry Hole

Elevation: Ground 1803' KB 1815'

Operator: License # 5171
Name TXQ Production Corp
Address 155 N. Market, Suite 1000
City/State/Zip Wichita, Kansas 67202

Purchaser D & A

Operator Contact Person Doug Clark
Phone 316 269-7600

Contractor: License # 5380
Name Eagle Drilling, Inc.

Wellsite Geologist Ken LeBlanc
Phone 316 269-7600

Designate Type of Completion
X New Well Re-Entry Workover
Oil SWD Temp Abd
Gas Inj Delayed Comp.
X Dry Other (Core, Water Supply etc.)

If ONWO: old well info as follows:
Operator
Well Name
Comp. Date Old Total Depth

WELL HISTORY

Drilling Method:
X Mud Rotary Air Rotary Cable

12-20-86 12-30-86 12-31-86
Spud Date Date Reached TD Completion Date
4910' N/A
Total Depth PBTD

8-5/8" @ 430'
Amount of Surface Pipe Set and Cemented at feet
Multiple Stage Cementing Collar Used? Yes X No
If yes, show depth set feet
If alternate 2 completion, cement circulated N/A
from feet depth to w/ SX cmt
Cement Company Name
Invoice #

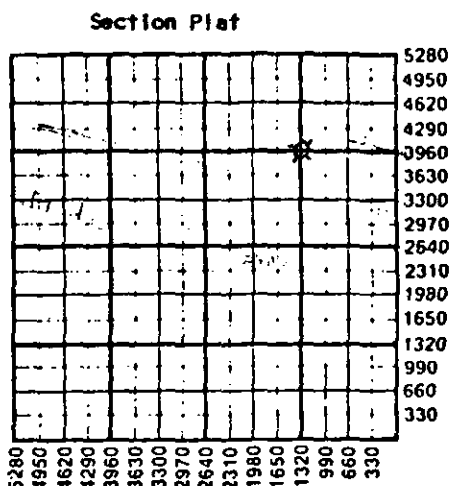

WATER SUPPLY INFORMATION

Disposition of Produced Water: Disposal
Docket # Repressuring

Questions on this portion of the ACO-1 call:

Water Resources Board (913) 296-3717

Source of Water:
Division of Water Resources Permit #

Groundwater Ft North from Southeast Corner (Well)
Ft West from Southeast Corner of Sec Twp Rge East West

Surface Water Ft North from Southeast Corner (Stream, pond etc.)
Ft West from Southeast Corner Sec Twp Rge East West

Other (explain)
(purchased from city, R.W.D. #)

INSTRUCTIONS: This form shall be completed in triplicate and filed with the Kansas Corporation Commission, 200 Colorado Derby Building, Wichita, Kansas 67202, within 120 days of the spud date of any well. Rule 82-3-130, 82-3-107 and 82-3-106 apply. Information on side two of this form will be held confidential for a period of 12 months if requested in writing and submitted with the form. See rule 82-3-107 for confidentiality in excess of 12 months. One copy of all wireline logs and drillers time log shall be attached with this form. Submit CP-4 form with all plugged wells. Submit CP-111 form with all temporarily abandoned wells.

All requirements of the statutes, rules and regulations promulgated to regulate the oil and gas industry have been fully complied with and the statements herein are complete and correct to the best of my knowledge.

Signature Doug Clark
Title District Geologist Date 1-7-87

Subscribed and sworn to before me this 7th day of January 1987
Notary Public Stephanie R. Stuber

Date Commission Expires 8-31-88

STEPHANIE R. STUBER
NOTARY PUBLIC
STATE OF KANSAS CORPORATION COMMISSION
My Appl. Exp. 8-31-88

K.C.C. OFFICE USE ONLY
F Letter of Confidentiality Attached
C Wireline Log Received
C Drillers Timelog Received
Distribution
KCC SWD/Rep NGPA
KGS Plug Other (Specify)

JAN 8 1987
CONSERVATION DIVISION
Wichita, Kansas

Sec 35 Twp 33 Rge 14 W

Operator Name TXO Production Corp. Lease Name LeRoy Cattle Co. B Well # 1

Sec. 35 Twp. 33S Rge. 14 East West County Barber

WELL LOG

INSTRUCTIONS: Show important tops and base of formations penetrated. Detail all cores. Report all drill stem tests giving interval tested, time tool open and closed, flowing and shut-in pressures, whether shut-in pressure reached static level, hydrostatic pressures, bottom hole temperature, fluid recovery, and flow rates if gas to surface during test. Attach extra sheet if more space is needed. Attach copy of log.

Drill Stem Tests Taken Yes No
 Samples Sent to Geological Survey Yes No
 Cores Taken Yes No

Formation Description
 Log Sample

DST #1, 4830-70': Misrun

DST #2, 4795-4870' (Mississippi):
 IFP/30"=50-50 psig, weak blow.
 ISIP/60"=203 psig.
 FFP/45"=60-60 psig, weak blow.
 FSIP/90"=208 psig.
 Rec: 240' GIP & 65' GCM.

Name	Top	Bottom
Kanwaka	3865	-2050
Elgin Sandstone	3918	-2103
Oread	4024	-2209
Heebner	4061	-2246
Douglas Shale	4097	-2282
Douglas Sandstone	4116	-2301
Brown Lime	4246	-2431
Lansing	4255	-2440
Stark Shale	4628	-2813
Hush Shale	4662	-2847
B/KC	4726	-2911
Marmaton	4740	-2925
Cherokee	4806	-2991
Mississippi	4826	-3011
Mississippi Dolomite	4848	-3033
RTD	4910	
LTD	4911	

CASING RECORD <input checked="" type="checkbox"/> New <input type="checkbox"/> Used Report all strings set-conductor, surface, intermediate, production, etc.							
Purpose of String	Size Hole Drilled	Size Casing Set (in O.D.)	Weight Lbs/Ft.	Setting Depth	Type of Cement	#Sacks Used	Type and Percent Additives
Surface	12-1/4"	8-5/8"	24#	430'	Class A	300	3% gel, 2% CaCl ₂
PERFORATION RECORD				Acid, Fracture, Shot, Cement Squeeze Record			
Shots Per Foot	Specify Footage of Each Interval Perforated			(Amount and Kind of Material Used)		Depth	
N/A							
TUBING RECORD		Size	Set At	Packer at	Liner Run	<input type="checkbox"/> Yes <input type="checkbox"/> No	
N/A							
Date of First Production	Producing Method						
N/A	<input type="checkbox"/> Flowing <input type="checkbox"/> Pumping <input type="checkbox"/> Gas Lift <input type="checkbox"/> Other (explain).....						
Estimated Production Per 24 Hours	Oil		Gas		Water		Gas-Oil Ratio
	N/A	Bbls	N/A	MCF	N/A	Bbls	CFPB

METHOD OF COMPLETION

Production Interval

Disposition of gas: Vented Open Hole Perforation
 Sold Other (Specify)
 Used on Lease Dually Completed Commingled

D. & A. 12-31-86