

EFFECTIVE DATE: 6-23-97

FORM MUST BE TYPED

DISTRICT # 2

State of Kansas  
NOTICE OF INTENTION TO DRILL

FORM MUST BE SIGNED

SGA?  Yes  No

Must be approved by the K.C.C. five (5) days prior to commencing well.

ALL BLANKS MUST BE FILLED

Expected Spud Date 5 20 1997  
month day year

Spot Approx 190' S OF East  
SW SW NW Sec 4 Twp 16 S Rg 3 West

OPERATOR: License # 31852  
Name: Bonneville Fuels Corporation  
Address: 1660 Lincoln - Suite 1800  
City/State/Zip: Denver, CO 80264  
Contact Person: R. A. Schwering  
Phone: (303) 863-1555 Ext. 213

2,500 feet from ~~South~~ / North line of Section  
330 feet from ~~East~~ / West line of Section  
IS SECTION  REGULAR  IRREGULAR?

CONTRACTOR: License #: 5420  
Name: White & Ellis Drilling, Inc.

(NOTE: Locate well on the Section Plat on Reverse Side)  
County: Saline  
Lease Name: MacDonald Well #: 1  
Field Name: Wildcat

Well Drilled For: Well Class: Type Equipment:  
 Oil ... Enh Rec ... Infield  Mud Rotary  
... Gas ... Storage ... Pool Ext. ... Air Rotary  
... OWWO ... Disposal  Wildcat ... Cable  
... Seismic; ... # of Holes ... Other

Is this a Prorated/Spaced Field? ... yes  no   
Target Formation(s): Arbuckle  
Nearest lease or unit boundary: 330'  
Ground Surface Elevation: 1313' feet MSL

If OWWO: old well information as follows:  
Operator: \_\_\_\_\_  
Well Name: \_\_\_\_\_  
Comp. Date: \_\_\_\_\_ Old Total Depth \_\_\_\_\_

Water well within one-quarter mile: ... yes  no  
Public water supply well within one mile: ... yes  no  
Depth to bottom of fresh water: 80'  
Depth to bottom of usable water: 130'

Directional, Deviated or Horizontal wellbore? ... yes  no  
If yes, true vertical depth: \_\_\_\_\_  
Bottom Hole Location: \_\_\_\_\_

Surface Pipe by Alternate:  1'  2'  
Length of Surface Pipe Planned to be set: 350'  
Length of Conductor pipe required: 100'  
Projected Total Depth: 3,500'  
Formation at Total Depth: Arbuckle  
Water Source for Drilling Operations:  
... well ... farm pond  other

Will Cores Be Taken?: ... yes  no  
If yes, proposed zone: \_\_\_\_\_

AFFIDAVIT

The undersigned hereby affirms that the drilling, completion and eventual plugging of this well will comply with K.S.A. 55-101, et. seq.  
It is agreed that the following minimum requirements will be met:

1. Notify the appropriate district office prior to spudding of well;
2. A copy of the approved notice of intent to drill shall be posted on each drilling rig;
3. The minimum amount of surface pipe as specified below shall be set by circulating cement to the top; in all cases surface pipe shall be set through all unconsolidated materials plus a minimum of 20 feet into the underlying formation;
4. If the well is dry hole, an agreement between the operator and the district office on plug length and placement is necessary prior to plugging;
5. The appropriate district office will be notified before well is either plugged or production casing is cemented in;
6. IF AN ALTERNATE II COMPLETION, PRODUCTION PIPE SHALL BE CEMENTED FROM BELOW ANY USABLE WATER TO SURFACE WITHIN 120 DAYS OF SPUD DATE. IN ALL CASES, NOTIFY DISTRICT OFFICE PRIOR TO ANY CEMENTING.

I hereby certify that the statements made herein are true and to the best of my knowledge and belief.

Date: 5-7-97 Signature of Operator/Agent: Michael L. Considine Title: Sec.-Treas. for White & Ellis Drlg.

FOR KCC USE:  
API # 15- 169-203160000  
Conductor pipe required 100 feet  
Minimum surface pipe required 200' feet per Alt. (1)  
Approved by: SK 6-18-97  
This authorization expires: 12-18-97  
(This authorization void if drilling not started within 6 months of effective date.)  
Spud date: \_\_\_\_\_ Agent: \_\_\_\_\_

REMEMBER TO:

- File Drill Pit Application (form CDP-1) with Intent to Drill;
- File Completion Form ACO-1 within 120 days of spud date;
- File acreage attribution plat according to field proration orders;
- Notify appropriate district office 48 hours prior to workover or re-entry;
- Submit plugging report (CP-4) after plugging is completed;
- Obtain written approval before disposing or injecting salt water.

Mail to: KCC - Conservation Division, 130 S. Market - Room 2078, Wichita, Kansas 67202.

RECEIVED  
KANSAS  
MAY - 8 1997

4  
16  
300

**IN ALL CASES PLOT THE INTENDED WELL ON THE PLAT BELOW**

**PLAT OF ACREAGE ATTRIBUTABLE TO A WELL IN A PRORATED OR SPACED FIELD**

If the intended well is in a prorated or spaced field, please fully complete this side of the form. If the intended well is in a prorated or spaced field complete the plat below showing that the well will be properly located in relationship to other wells producing from the common source of supply. Please show all the wells within 1 mile of the boundaries of the proposed acreage attribution unit for gas wells and within 1/2 mile of the boundaries of the proposed acreage attribution unit for oil wells.

API NO. 15- \_\_\_\_\_  
 OPERATOR Bonneville Fuels Corporation LOCATION OF WELL: COUNTY Saline  
 LEASE MacDonald 2,500 feet from ~~east~~/north line of section  
 WELL NUMBER #1 330 feet from ~~east~~/west line of section  
 FIELD Wildcat SECTION 4 TWP 16S RG 3W

NUMBER OF ACRES ATTRIBUTABLE TO WELL 10 IS SECTION X REGULAR or \_\_\_\_\_ IRREGULAR  
 QTR/QTR/QTR OF ACREAGE SW - SW - NW **IF SECTION IS IRREGULAR, LOCATE WELL FROM NEAREST CORNER BOUNDARY.**  
 Approximate Section corner used: NE X NW SE SW

**PLAT**

(Show location of the well and shade attributable acreage for prorated or spaced wells.)  
 (Show footage to the nearest lease or unit boundary line.)

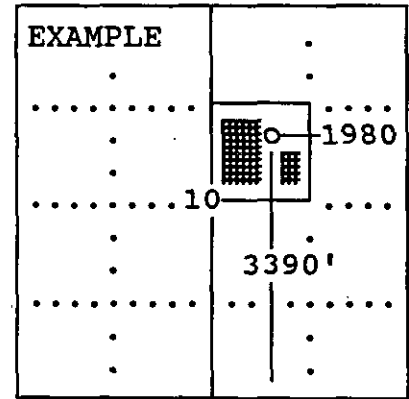
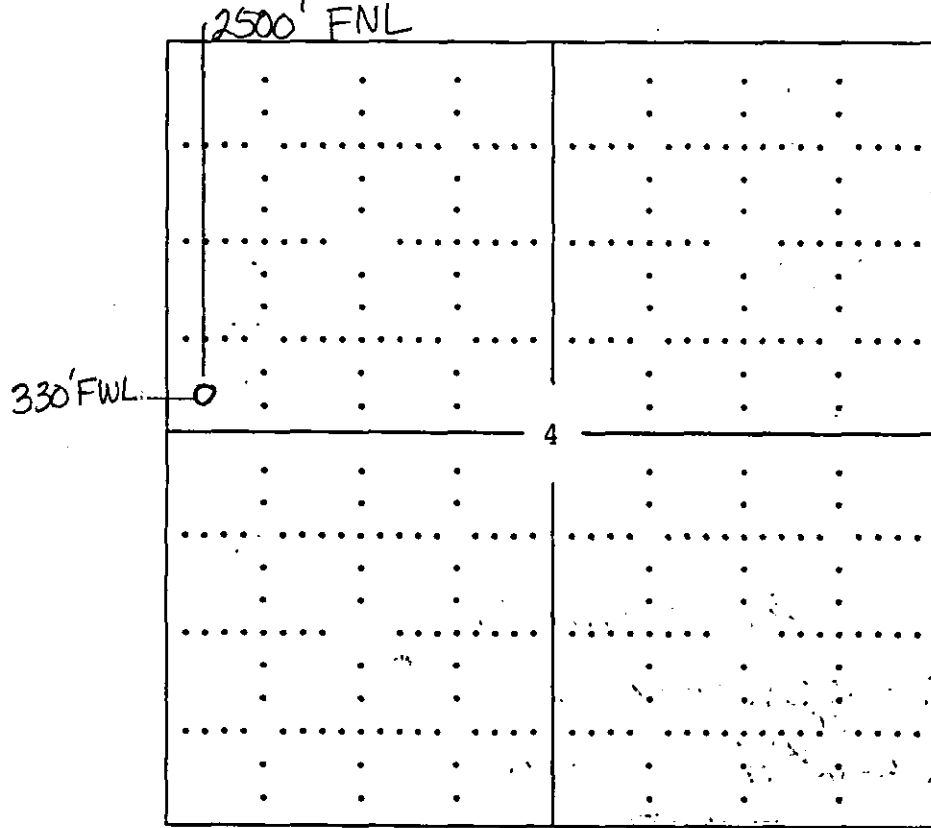

SEWARD CO.

**In plotting the proposed location of the well, you must show:**

- 1) The manner in which you are using the depicted plat by identifying section lines, i.e. 1 section, 1 section with 8 surrounding sections, 4 sections, etc.;
- 2) the distance of the proposed drilling location from the section's south/north and east/west; and
- 3) the distance to the nearest lease or unit boundary line.