

EFFECTIVE DATE: 6-8-97

State of Kansas

DISTRICT # 2

NOTICE OF INTENTION TO DRILL

SGA? Yes No

Must be approved by the K.C.C. five (5) days prior to commencing well.

Expected Spud Date 5 20 1997
month day year

Spot Approx East
SW SE NE Sec 4 Twp 16 S, Rg 3 West

OPERATOR: License # 31852
Name: Bonneville Fuels Corporation
Address: 1660 Lincoln - Suite 1800
City/State/Zip: Denver, CO 80264
Contact Person: R. A. Schwering
Phone: (303) 863-1555 Ext. 213

2,310 feet from South North line of Section
800 feet from East West line of Section
IS SECTION REGULAR IRREGULAR?

CONTRACTOR: License #: 5420
Name: White & Ellis Drilling, Inc.

(NOTE: Locate well on the Section Plat on Reverse Side)
County: Saline

Well Drilled For: Well Class: Type Equipment:

Lease Name: Marilyn Johnson Well #: 1
Field Name: Olsson

- Oil ... Enh Rec ... Infield Mud Rotary
- ... Gas ... Storage Pool Ext. ... Air Rotary
- ... OWMO ... Disposal ... Wildcat ... Cable
- ... Seismic; ... # of Holes ... Other
- ... Other

Is this a Prorated/Spaced Field? ... yes no

If OWMO: old well information as follows:

Target Formation(s): Arbuckle
Nearest lease or unit boundary: 330'

Operator: _____
Well Name: _____
Comp. Date: _____ Old Total Depth _____

Ground Surface Elevation: 1290' feet MSL
Water well within one-quarter mile: ... yes no

Directional, Deviated or Horizontal wellbore? ... yes no

Public water supply well within one mile: ... yes no
Depth to bottom of fresh water: 80'

If yes, true vertical depth: _____

Depth to bottom of usable water: 130'
Surface Pipe by Alternate: 1 2

Bottom Hole Location: _____

Length of Surface Pipe Planned to be set: 350'
Length of Conductor pipe required: 100'

Projected Total Depth: 3,500'
Formation at Total Depth: Arbuckle

Water Source for Drilling Operations:
... well ... farm pond other

Will Cores Be Taken? ... yes no

If yes, proposed zone: _____

AFFIDAVIT

The undersigned hereby affirms that the drilling, completion and eventual plugging of this well will comply with K.S.A. 55-101, et. seq.
It is agreed that the following minimum requirements will be met:

1. Notify the appropriate district office prior to spudding of well;
2. A copy of the approved notice of intent to drill shall be posted on each drilling rig;
3. The minimum amount of surface pipe as specified below shall be set by circulating cement to the top; in all cases surface pipe shall be set through all unconsolidated materials plus a minimum of 20 feet into the underlying formation;
4. If the well is dry hole, an agreement between the operator and the district office on plug length and placement is necessary prior to plugging;
5. The appropriate district office will be notified before well is either plugged or production casing is cemented in;
6. IF AN ALTERNATE II COMPLETION, PRODUCTION PIPE SHALL BE CEMENTED FROM BELOW ANY USABLE WATER TO SURFACE WITHIN 120 DAYS OF SPUD DATE. IN ALL CASES, NOTIFY DISTRICT OFFICE PRIOR TO ANY CEMENTING.

I hereby certify that the statements made herein are true and to the best of my knowledge and belief.

Date: 5-7-97 Signature of Michael L. Considine Agent: Michael L. Considine Title: Sec.-Treas. for White & Ellis Drlg.

FOR KCC USE:
 API # 15- 169-203150000
 Conductor pipe required 100' feet
 Minimum surface pipe required 200' feet per Alt.
 Approved by: JK 6-3-97
 This authorization expires: 12-3-97
 (This authorization void if drilling not started within 6 months of effective date.)
 Spud date: _____ Agent: _____

REMEMBER TO:

- File Drill Pit Application (form CDP-1) with Intent to Drill;
- File Completion Form ACO-1 within 120 days of spud date;
- File acreage attribution plat according to field proration orders;
- Notify appropriate district office 48 hours prior to workover or re-entry;
- Submit plugging report (CP-4) after plugging is completed;
- Obtain written approval before disposing or injecting salt water.

Mail to: KCC - Conservation Division, 130 S. Market - Room 2078, Wichita, Kansas 67202.

RECEIVED
KANSAS CORP COMM
1997 MAY -8 A 11: 17

4 16 3W

IN ALL CASES PLOT THE INTENDED WELL ON THE PLAT BELOW

PLAT OF ACREAGE ATTRIBUTABLE TO A WELL IN A PRORATED OR SPACED FIELD

If the intended well is in a prorated or spaced field, please fully complete this side of the form. If the intended well is in a prorated or spaced field complete the plat below showing that the well will be properly located in relationship to other wells producing from the common source of supply. Please show all the wells within 1 mile of the boundaries of the proposed acreage attribution unit for gas wells and within 1/2 mile of the boundaries of the proposed acreage attribution unit for oil wells.

API NO. 15- _____
 OPERATOR Bonneville Fuels Corporation LOCATION OF WELL: COUNTY Saline
 LEASE Marilyn Johnson 2310 feet from ~~SOMKX~~/north line of section
 WELL NUMBER #1 800 feet from east/west line of section
 FIELD Wildcat SECTION 4 TWP 16S RG 3W

NUMBER OF ACRES ATTRIBUTABLE TO WELL 10 IS SECTION X REGULAR or _____ IRREGULAR
 QTR/QTR/QTR OF ACREAGE SW - SE - NE **IF SECTION IS IRREGULAR, LOCATE WELL FROM NEAREST CORNER BOUNDARY.**
 Approximate

Section corner used: X NE _____ NW _____ SE _____ SW

PLAT

(Show location of the well and shade attributable acreage for prorated or spaced wells.)
 (Show footage to the nearest lease or unit boundary line.)

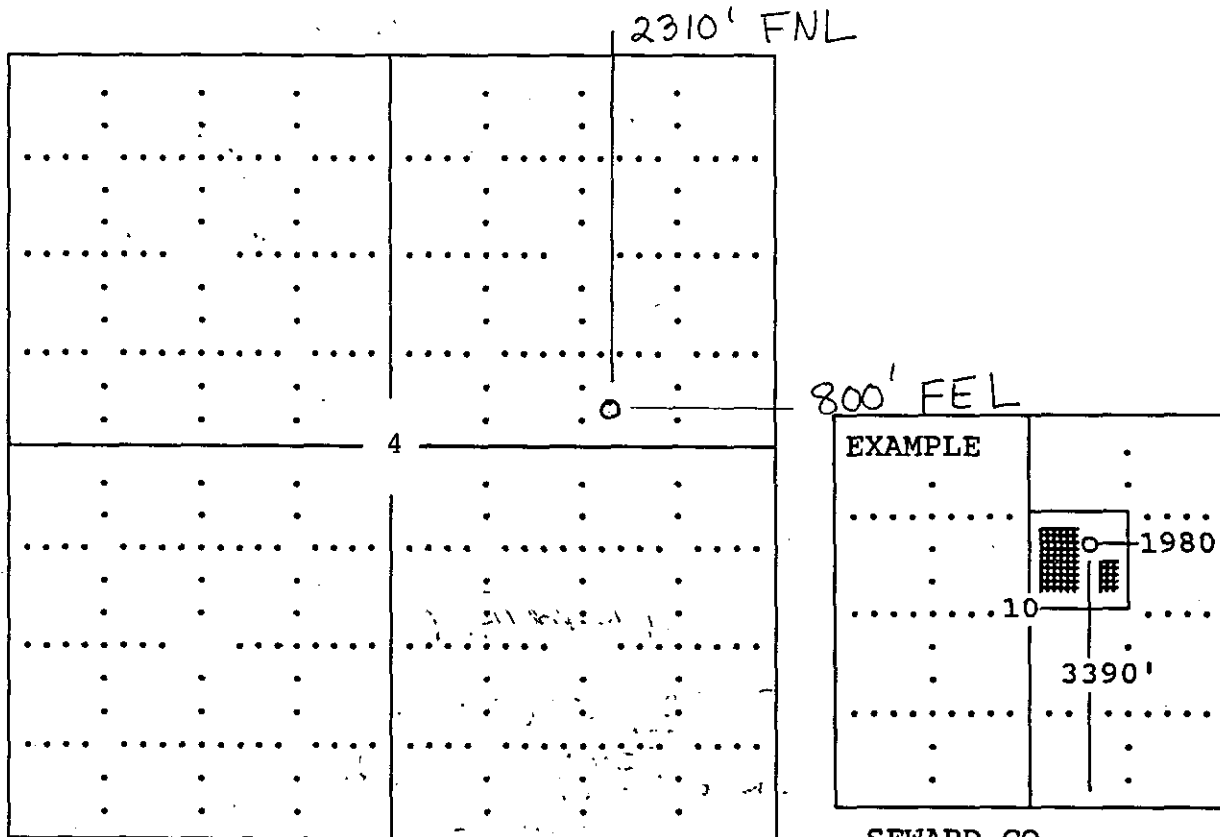

In plotting the proposed location of the well, you must show:

- 1) The manner in which you are using the depicted plat by identifying section lines, i.e. 1 section, 1 section with 8 surrounding sections, 4 sections, etc.;
- 2) the distance of the proposed drilling location from the section's south/north and east/west; and
- 3) the distance to the nearest lease or unit boundary line.