

EFFECTIVE DATE: 2-21-93

DISTRICT # 2  
35A7... Yes  No

State of Kansas  
NOTICE OF INTENTION TO DRILL

FORM C-1 7/91  
FORM MUST BE TYPED  
FORM MUST BE SIGNED  
ALL BLANKS MUST BE FILLED

Must be approved by the K.C.C. five (5) days prior to commencing well

Expected Spud Date February 21 1993  
month day year

Spot SE NW SW Sec 35 Twp 32 S. Rg 6 Eas Weas

OPERATOR: License # 4538  
Name: Boswell Energy Corporation  
Address: 501 W. I-44, MidFirst Plaza, Suite 300  
City/State/Zip: Oklahoma City, OK 73118-6081  
Contact Person: R.P. Brandenburg  
Phone: 405/840-4073

1650' feet from South / North line of Section  
990' feet from East / West line of Section  
IS SECTION X REGULAR IRREGULAR?

(NOTE: Locate well on the Section Plat on Reverse Side  
County: Harper  
Lease Name: Fisher Well #: 1-35  
Field Name: Unnamed

CONTRACTOR: License # *advise prior to spudding*  
Name: Duke Drilling Co.

Is this a Prorated/Spaced Field? yes X no  
Target Formation(s): Arbuckle  
Nearest lease or unit boundary: 990'  
Ground Surface Elevation: 1325' feet MSL

Well Drilled For: Well Class: Type Equipment:  
X Oil ... Enh Rec ... Infield X Mud Rotary  
Gas ... Storage ... Pool Ext. ... Air Rotary  
DUWD ... Disposal X Wildcat ... Cable  
Seismic; ... # of Holes ... Other

Water well within one-quarter mile: yes X no  
Public water supply well within one mile: yes X no  
Depth to bottom of fresh water: 50'  
Depth to bottom of usable water: 180'

If DUWD: old well information as follows:  
Operator:  
Well Name:  
Comp. Date: Old Total Depth

Surface Pipe by Alternate: X 1 2  
Length of Surface Pipe Planned to be set: 200'  
Length of Conductor pipe required: None  
Projected Total Depth: 5,000'  
Formation at Total Depth: Arbuckle  
Water Source for Drilling Operations: Creek X well farm pond other

Directional, Deviated or Horizontal wellbore? yes X no  
If yes, true vertical depth:  
Bottom Hole Location:

DWR Permit #:  
Will Cores Be Taken?: yes X no  
If yes, proposed zone:

AFFIDAVIT

The undersigned hereby affirms that the drilling, completion and eventual plugging of this well will comply with K.S.A. 55-101, et. seq.  
It is agreed that the following minimum requirements will be met:

- 1. Notify the appropriate district office prior to spudding of well;
- 2. A copy of the approved notice of intent to drill shall be posted on each drilling rig;
- 3. The minimum amount of surface pipe as specified below shall be set by circulating cement to the top; in all cases surface pipe shall be set through all unconsolidated materials plus a minimum of 20 feet into the underlying formation;
- 4. If the well is dry hole, an agreement between the operator and the district office on plug length and placement is necessary prior to plugging;
- 5. The appropriate district office will be notified before well is either plugged or production casing is cemented in;
- 6. IF AN ALTERNATE IS COMPLETED, PRODUCTION PIPE SHALL BE CEMENTED FROM BELOW ANY USABLE WATER TO SURFACE WITHIN 120 DAYS OF SPUD DATE. IN ALL CASES, NOTIFY DISTRICT OFFICE PRIOR TO ANY CEMENTING.

I hereby certify that the statements made herein are true and to the best of my knowledge and belief.

Date: Feb. 11, 1993 Signature of Operator or Agent: *David C. Stacy* Title: Vice President

FOR KCC USE:  
API # 15- 077-21267-00-0  
Conductor pipe required None feet  
Minimum surface pipe required 200' feet per Alt. X  
Approved by: 2-26-93  
This authorization expires: 8-16-93  
(This authorization void if drilling not started within 6 months of effective date.)  
Spud date: Agent:

RECEIVED  
STATE CORPORATION COMMISSION  
FEB 16 1993  
CONSERVATION DIVISION  
Wichita, Kansas

REMEMBER TO:

- File Drill Pit Application (form CDP-1) with Intent to Drill;
- File Completion Form ACO-1 within 120 days of spud date;
- File acreage attribution plat according to field proration orders;
- Notify appropriate district office 48 hours prior to workover or re-entry;
- Submit plugging report (CP-4) after plugging is completed;
- Obtain written approval before disposing or injecting salt water.

Mail to: Conservation Division, 200 Colorado Derby Building, 202 W. First St., Wichita, Kansas 67202-1286.

IN ALL CASES PLOT THE INTENDED WELL ON THE PLAT BELOW

PLAT OF ACREAGE ATTRIBUTABLE TO A WELL IN A PRORATED OR SPACED FIELD

If the intended well is in a prorated or spaced field, please fully complete this side of the form. If the intended well is in a prorated or spaced field complete the plat below showing that the well will be properly located in relationship to other wells producing from the common source of supply. Please show all the wells within 1 mile of the boundaries of the proposed acreage attribution unit for gas wells and within 1/2 mile of the boundaries of the proposed acreage attribution unit for oil wells.

API NO. 15- \_\_\_\_\_  
 OPERATOR Boswell Energy Corporation  
 LEASE Fisher  
 WELL NUMBER 1-35  
 FIELD Unnamed

LOCATION OF WELL: COUNTY Harper  
1,650 feet from south/north line of section  
990 feet from east/west line of section  
 SECTION 35 TWP 32 South RG 6 West

NUMBER OF ACRES ATTRIBUTABLE TO WELL 160  
 QTR/QTR/QTR OF ACREAGE \_\_\_\_\_ SW/4

IS SECTION X REGULAR or \_\_\_\_\_ IRREGULAR  
 IF SECTION IS IRREGULAR, LOCATE WELL FROM NEAREST  
 CORNER BOUNDARY.

Section corner used: \_\_\_\_\_ NE \_\_\_\_\_ NW \_\_\_\_\_ SE \_\_\_\_\_ SW

**PLAT**

(Show location of the well and shade attributable acreage for prorated or spaced wells.)  
 (Show footage to the nearest lease or unit boundary line.)

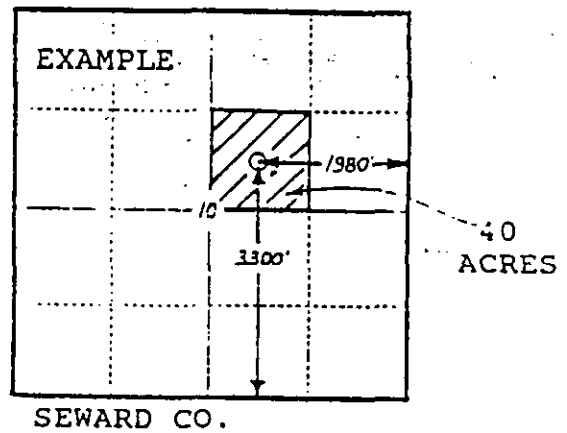
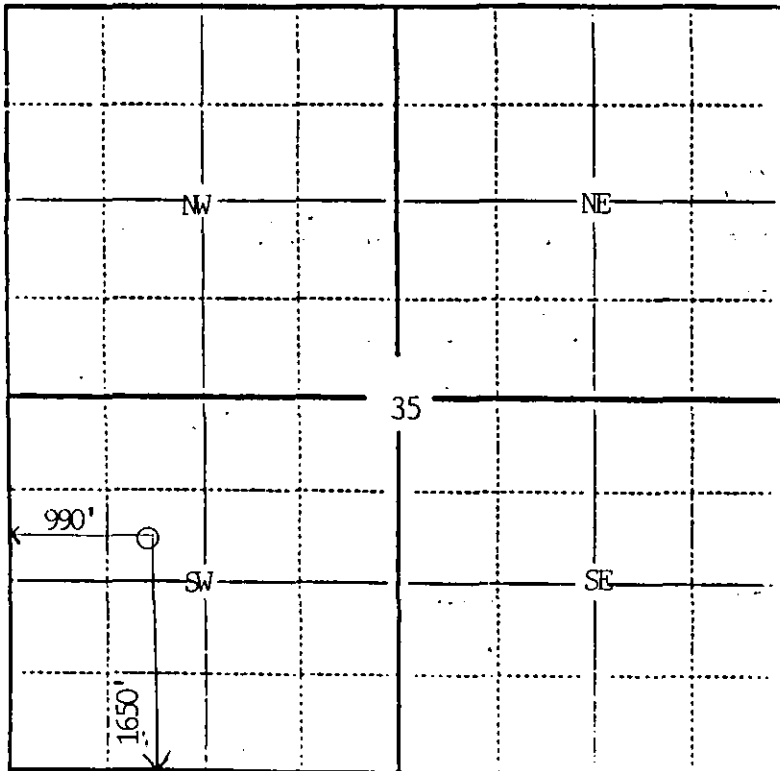

In plotting the proposed location of the well, you must show:

- 1) The manner in which you are using the depicted plat by identifying section lines, i.e. 1 section, 1 section with 8 surrounding sections, 4 sections, etc.;
- 2) the distance of the proposed drilling location from the section's south/north and east/west lines; and
- 3) the distance to the nearest lease or unit boundary line.