

FOR KCC USE:

FORM C-1 7/91

EFFECTIVE DATE: 4-28-96

State of Kansas
NOTICE OF INTENTION TO DRILL

FORM MUST BE TYPED

FORM MUST BE SIGNED

ALL BLANKS MUST BE FILLED

DISTRICT # 1
SGA? Yes No

Must be approved by the K.C.C. five (5) days prior to commencing well.

Expected Spud Date: ..MAY.....15TH.....1996.....
month day year

Spot East
150' S of SW SE NE. Sec ..34. Twp ..33.. S, Rg ..14. XX West

OPERATOR: License # 5506.....
Name: ..WOOLSEY PETROLEUM CORPORATION.....
Address:107 NORTH MARKET, SUITE 600.....
City/State/Zip: ..WICHITA, KANSAS 67202-1807.....
Contact Person: ..DEBRA K. CLINGAN.....
Phone:(316) 267-4379.....

..2460' FNL..... feet from South / North line of Section
..990' FEL..... feet from East / West line of Section
IS SECTION _____ REGULAR XX IRREGULAR?

(NOTE: Locate well on the Section Plat on Reverse Side)

County: ..BARBER.....

Lease Name: ..ELLIS."G"..... Well #: ..5.....

Field Name: ..AETNA.....

Is this a Prorated/Spaced Field? yes XX no

Target Formation(s): ..MISSISSIPPIAN.....

Nearest lease or unit boundary: ..990'.....

Ground Surface Elevation: ..1699'..... feet MSL

Water well within one-quarter mile: yes X no

Public water supply well within one mile: yes X no

Depth to bottom of fresh water: 140'.....

Depth to bottom of usable water: 180'.....

Surface Pipe by Alternate: ..XX. 1 2

Length of Surface Pipe Planned to be set: ..200'.....

Length of Conductor pipe required: ..n/a.....

Projected Total Depth: ..5360'.....

Formation at Total Depth: ..ARBUCKLE.....

Water Source for Drilling Operations:
..... well farm pond XX other

Well Drilled For:	Well Class:	Type Equipment:
... Oil	... Enh Rec	<u>X</u> . Infield
<u>X</u> . Gas	... Storage	... Pool Ext.
... OWWO	... Disposal	... Wildcat
... Seismic;	... # of Holes	... Other
... Other		

If OWWO: old well information as follows:

Operator: n/a.....

Well Name:

Comp. Date: Old Total Depth

Directional, Deviated or Horizontal wellbore? yes XX no

If yes, true vertical depth:.....

Bottom Hole Location:.....

Will Cores Be Taken? yes XX no

If yes, proposed zone:

AFFIDAVIT

The undersigned hereby affirms that the drilling, completion and eventual plugging of this well will comply with K.S.A. 55-1101 through 55-1104 et. seq.

It is agreed that the following minimum requirements will be met:

1. Notify the appropriate district office prior to spudding of well;
2. A copy of the approved notice of intent to drill shall be posted on each drilling rig;
3. The minimum amount of surface pipe as specified below shall be set by circulating cement to the top; in all cases surface pipe shall be set through all unconsolidated materials plus a minimum of 20 feet into the underlying formation;
4. If the well is dry hole, an agreement between the operator and the district office on plug length and placement is necessary prior to plugging;
5. The appropriate district office will be notified before well is either plugged or production casing is cemented in;
6. IF AN ALTERNATE II COMPLETION, PRODUCTION PIPE SHALL BE CEMENTED FROM BELOW ANY USABLE WATER TO SURFACE WITHIN 120 DAYS OF SPUD DATE. IN ALL CASES, NOTIFY DISTRICT OFFICE PRIOR TO ANY CEMENTING.

RECEIVED
APR 19 1996
4-19-96
CONSERVATION DIVISION
WICHITA, KS

I hereby certify that the statements made herein are true and to the best of my knowledge and belief.

Date: ..APRIL 19, 1996... Signature of Operator or Agent: Debra K. Clingan Title: ..PRODUCTION SECRETARY...
DEBRA K. CLINGAN

FOR KCC USE:
API # 15- 007-225070000
Conductor pipe required NONE feet
Minimum surface pipe required 200' feet per Alt. 1
Approved by: JK 4-23-96
This authorization expires: 10-23-96
(This authorization void if drilling not started within 6 months of effective date.)
Spud date: _____ Agent: _____

34
33
14

REMEMBER TO:

- File Drill Pit Application (form CDP-1) with Intent to Drill;
- File Completion Form ACO-1 within 120 days of spud date;
- File acreage attribution plat according to field proration orders;
- Notify appropriate district office 48 hours prior to workover or re-entry;
- Submit plugging report (CP-4) after plugging is completed;
- Obtain written approval before disposing or injecting salt water.

Mail to: KCC - Conservation Division, 130 S. Market - Room 2078, Wichita, Kansas 67202.

IN ALL CASES PLOT THE INTENDED WELL ON THE PLAT BELOW

PLAT OF ACREAGE ATTRIBUTABLE TO A WELL IN A PRORATED OR SPACED FIELD

If the intended well is in a prorated or spaced field, please fully complete this side of the form. If the intended well is in a prorated or spaced field complete the plat below showing that the well will be properly located in relationship to other wells producing from the common source of supply. Please show all the wells within 1 mile of the boundaries of the proposed acreage attribution unit for gas wells and within 1/2 mile of the boundaries of the proposed acreage attribution unit for oil wells.

API NO. 15- _____
 OPERATOR WOOLSEY PETROLEUM CORP.
 LEASE ELLIS G
 WELL NUMBER 5
 FIELD AETNA

LOCATION OF WELL: COUNTY BARBER
2460' feet from south/north line of section
990' feet from east/west line of section
 SECTION 34 TWP 33S RG 14W

NUMBER OF ACRES ATTRIBUTABLE TO WELL _____
 QTR/QTR/QTR OF ACREAGE _____

IS SECTION _____ REGULAR or XX IRREGULAR
IF SECTION IS IRREGULAR, LOCATE WELL FROM NEAREST CORNER BOUNDARY.

Section corner used: XX NE _____ NW _____ SE _____ SW

PLAT

(Show location of the well and shade attributable acreage for prorated or spaced wells.)
 (Show footage to the nearest lease or unit boundary line.)

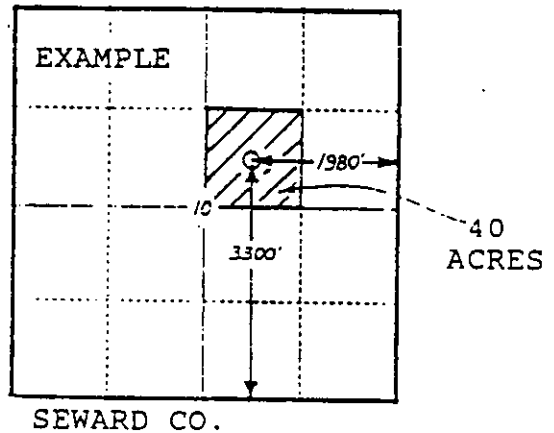
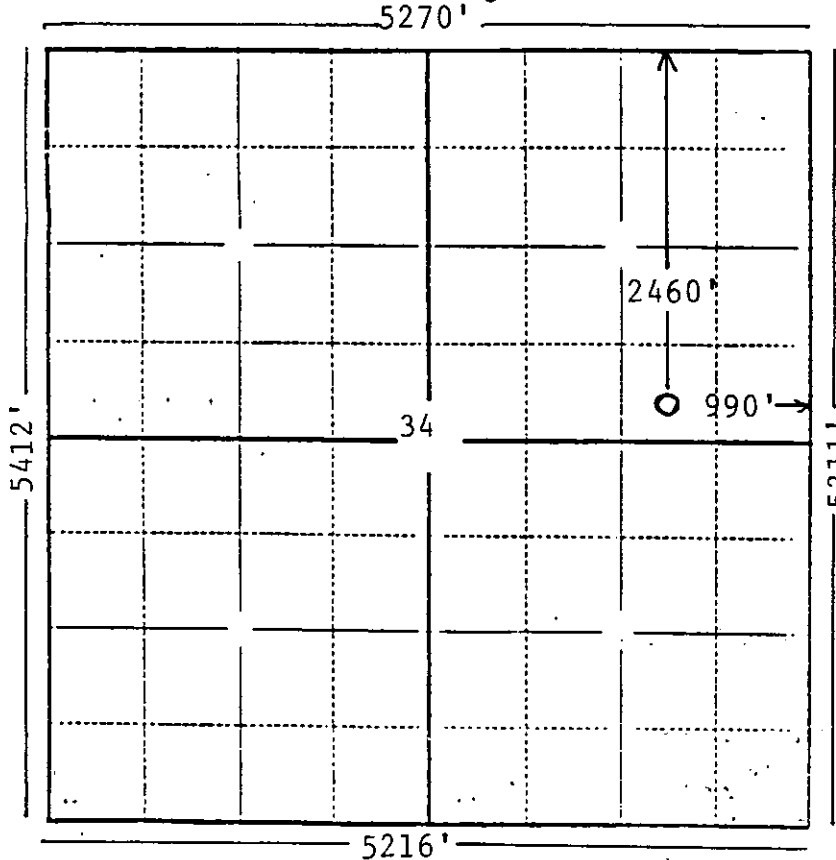

In plotting the proposed location of the well, you must show:

- 1) The manner in which you are using the depicted plat by identifying section lines, i.e. 1 section, 1 section with 8 surrounding sections, 4 sections, etc.;
- 2) the distance of the proposed drilling location from the section's south/north and east/west lines; and
- 3) the distance to the nearest lease or unit boundary line.