

STATE CORPORATION COMMISSION OF KANSAS
OIL & GAS CONSERVATION DIVISION
WELL COMPLETION OR RECOMPLETION FORM
ACO-1 WELL HISTORY
DESCRIPTION OF WELL AND LEASE

API NO. 15-007-22-241-0000

County Barber

C. SE SW Sec. 11 Twp. 34 Rge. 12 East
XX West

Operator: License # 4197
Name Dunne Oil Co
Address 100 S. Main #520
City/State/Zip Wichita, KS 67202

660 Ft North from Southeast Corner of Section
3300 Ft West from Southeast Corner of Section
(Note: Locate well in section plat below)

Purchaser

Lease Name Andrews Well # 3-11

Operator Contact Person Stephen W. Dunne
Phone (316) 267-3448

Field Name Wildcat

Contractor: License # 5929
Name Duke Drilling Co., Inc.

Producing Formation

Elevation: Ground 1489 KB 1497

Wellsite Geologist
Phone

Designate Type of Completion
X New Well Re-Entry Workover

X Oil SWD Temp Abd
Gas Inj Delayed Comp.
X Dry KCC Other (Core, Water Supply etc.)

If OWNED: old well info as follows:
Operator
Well Name
Comp. Date Old Total Depth

RECEIVED
STATE CORPORATION COMMISSION
JUN - 8 1989
6-8-89
CONSERVATION DIVISION
Wichita, Kansas

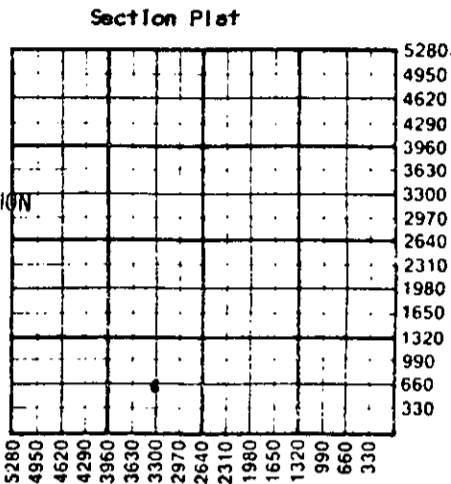

WATER SUPPLY INFORMATION
Disposition of Produced Water: Disposal
Docket # Repressuring

WELL HISTORY

Drilling Method:
X Mud Rotary Air Rotary Cable

5-13-89 5-22-89 5-23-89
Spud Date Date Reached TD Completion Date

5110' PBD
Total Depth

Amount of Surface Pipe Set and Cemented at 326 feet
Multiple Stage Cementing Collar Used? Yes No
If yes, show depth set feet
If alternate 2 completion, cement circulated from feet depth to w/SX cmt
Cement Company Name
Invoice #
AIR I OPA

Questions on this portion of the ACO-1 call:
Water Resources Board (913) 296-3717
Source of Water:
Division of Water Resources Permit #
Groundwater Ft North from Southeast Corner (Well) Ft West from Southeast Corner of Sec Twp Rge East West
X Surface Water 660 Ft North from Southeast Corner (Stream, pond etc) 660 Ft West from Southeast Corner Sec 18 Twp 34 Rge 11 East X West
Other (explain) (purchased from city, R.W.D. #)

INSTRUCTIONS: This form shall be completed in triplicate and filed with the Kansas Corporation Commission, 200 Colorado Derby Building, Wichita, Kansas 67202, within 120 days of the spud date of any well. Rule 82-3-130, 82-3-107 and 82-3-106 apply. Information on side two of this form will be held confidential for a period of 12 months if requested in writing and submitted with the form. See rule 82-3-107 for confidentiality in excess of 12 months. One copy of all wireline logs and drillers time log shall be attached with this form. Submit CP-4 form with all plugged wells. Submit CP-111 form with all temporarily abandoned wells.

All requirements of the statutes, rules and regulations promulgated to regulate the oil and gas industry have been fully complied with and the statements herein are complete and correct to the best of my knowledge.

Signature [Signature]
Title President Date

Subscribed and sworn to before me this 1st day of June 1989
Notary Public Carol S. Benoit

Date Commission Expires

CAROL S. BENOIT
NOTARY PUBLIC
STATE OF KANSAS
My Appt. Exp. 11-24-90

K.C.C. OFFICE USE ONLY
F Letter of Confidentiality Attached
C Wireline Log Received
C Drillers Timelog Received
Distribution
KCC SWD/Rep NGPA
KGS Plug Other
(Specify)
6-8-89
Form ACO-1 (5-86)

Sec. 11, Twp. 34 N, Rge. 12 E

SIDE TWO

Operator Name Dunne Oil Co Lease Name Andrews Well # 3-11

Sec. 11 Twp. 34 Rge. 12 East West County Barber

WELL LOG

INSTRUCTIONS: Show important tops and base of formations penetrated. Detail all cores. Report all drill stem tests giving interval tested, time tool open and closed, flowing and shut-in pressures, whether shut-in pressure reached static level, hydrostatic pressures, bottom hole temperature, fluid recovery, and flow rates if gas to surface during test. Attach extra sheet if more space is needed. Attach copy of log.

Drill Stem Tests Taken Yes No
 Samples Sent to Geological Survey Yes No
 Cores Taken Yes No

Formation Description
 Log Sample

DST#1 - 5032-5058 30-30-30-30
 IFP 216-540, FFP 646-912, ISIP 2006, FSIP 2006
 IHP 2506 FHP-2485
 RECOVERED: 180' OGCM 15%g, 20%oil, 65% oily mud
 180' OGCMW 40%gas, 10% oil, 20% mud, 30% water
 1,440' SW

Name	Top	Bottom
Elgin	3602	
Heebner	3787	
Toronto	3807	
Lansing	3974	
Stark Shale	4450	
BKC	4508	
Cherokee	4658	
Mississippi	4678	
Kinderhook	4948	
Woodford Shale	5025	
Misener Sand	5056	
Viola	5080	

CASING RECORD <input checked="" type="checkbox"/> New <input type="checkbox"/> Used							
Report all strings set-conductor, surface, intermediate, production, etc.							
Purpose of String	Size Hole Drilled	Size Casing Set (in O.D.)	Weight Lbs/Ft.	Setting Depth	Type of Cement	#Sacks Used	Type and Percent Additives
Surface	12 1/4"	8-5/8"	20#	326'	60/40 poz	200	2% gel 3% cc
PERFORATION RECORD				Acid, Fracture, Shot, Cement Squeeze Record			
Shots Per Foot	Specify Footage of Each Interval Perforated			Amount and Kind of Material Used		Depth	
TUBING RECORD				Liner Run <input type="checkbox"/> Yes <input type="checkbox"/> No			
Date of First Production	Producing Method <input type="checkbox"/> Flowing <input type="checkbox"/> Pumping <input type="checkbox"/> Gas Lift <input type="checkbox"/> Other (explain).....						
Estimated Production Per 24 Hours	Oil Bbls	Gas MCF	Water Bbls	Gas-Oil Ratio	Gravity CFPB		

METHOD OF COMPLETION

Production Interval

Disposition of gas: Vented Open Hole Perforation
 Sold Other (Specify)
 Used on Lease

Dually Completed
 Commingled

DRILLER'S WELL LOG

DATE COMMENCED: May 13, 1989
DATE COMPLETED: May 22, 1989

Dunne Oil Co,
ANDREWS #3-11
C SE SW
Sec. 11, T34S, R12W
Barber County, Ks.

ELEVATION:

Surface Pipe: Set new
8-5/8", 20# pipe 0326'
w/200 sacks 60/40pbzmf
2% gel 3% cc.

0 -	1520'	Surface Soil, Red Bed, Shale
1520 -	1870'	Shale
1870 -	2165'	Shale w/Lime streaks
2165 -	2453'	Lime s/shale streaks
2453 -	3718'	Lime & Shale
3718 -	3865'	Shale & Lime
3865 -	4140'	Lime & Shale
4140 -	4365'	Lime
4365 -	4730'	Lime & Shale
4730 -	5058'	Chert & Lime
5058 -	5110'	Sand
	5110'	RTD

A F F I D A V I T

STATE OF KANSAS
COUNTY OF BARTON) ss

John Ambruster of lawful age, does swear and state that the facts and statements herein are true and correct to the best of his knowledge.

John Ambruster

Subscribed and sworn to before me this 25 day of May 1989.

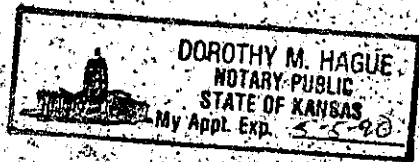

Dorothy M. Hague
Notary Public

RECEIVED
MAY 30 1989
WICHITA DIVISION
CONSERVATION COMMISSION
Wichita, Kansas