

15-009-20282-0000

STATE OF KANSAS
STATE CORPORATION COMMISSION

Form CP-4

Give All Information Completely
Make Required Affidavit
Mail or Deliver Report to:
Conservation Division
State Corporation Commission
212 No. Market
Wichita, Kansas

WELL PLUGGING RECORD

BARTON County, Sec. 28 Twp. 16s Rge. 13w (E) (W)

Location as "NE/CNW/SW" or footage from lines NW NW NE
Lease Owner PETROLEUM, INC.
Lease Name REDETZKE 'B' Well No. 1
Office Address R.R. #2, GREAT BEND, KANSAS
Character of Well (completed as Oil, Gas or Dry Hole) DRY HOLE
Date well completed OCTOBER 9 19 68
Application for plugging filed OCTOBER 9 19 68
Application for plugging approved OCTOBER 9 19 68
Plugging commenced OCTOBER 9 19 68
Plugging completed OCTOBER 9 19 68
Reason for abandonment of well or producing formation NO PRODUCIBLE ZONES

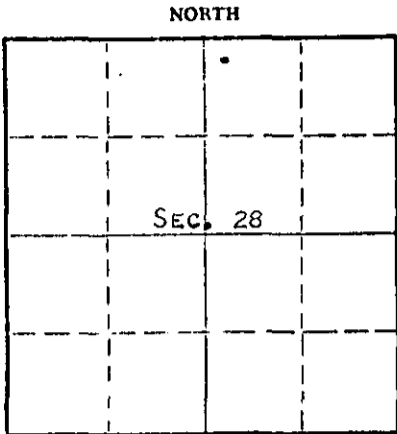

Locate well correctly on above
Section Plat

If a producing well is abandoned, date of last production NONE 19
Was permission obtained from the Conservation Division or its agents before plugging was commenced? YES

Name of Conservation Agent who supervised plugging of this well DONALD TRUAN
Producing formation _____ Depth to top _____ Bottom _____ Total Depth of Well 3443 Feet
Show depth and thickness of all water, oil and gas formations.

OIL, GAS OR WATER RECORDS				CASING RECORD		
FORMATION	CONTENT	FROM	TO	SIZE	PUT IN	PULLED OUT
				8-5/8"	370'	NONE

Describe in detail the manner in which the well was plugged, indicating where the mud fluid was placed and the method or methods used in introducing it into the hole. If cement or other plugs were used, state the character of same and depth placed, from _____ feet to _____ feet for each plug set.

MUDDED UP WITH HEAVY MUD TO 360'. PLACED 25 SACKS CEMENT THROUGH DRILL PIPE AT 360', FOLLOWED BY 1/4 SACK HULLS AND WOODEN PLUG. MUDDED UP WITH HEAVY MUD TO 40', FOLLOWED BY 1/2 SACK HULLS AND 10 SACKS CEMENT TO BASE OF WELL CELLAR. TWO SACKS OF CEMENT IN RAT HOLE AND TWO SACKS CEMENT IN MOUSE HOLE

RECEIVED
STATE CORPORATION COMMISSION
OCT 17 1968
CONSERVATION DIVISION
Wichita, Kansas

(If additional description is necessary, use BACK of this sheet)
Name of Plugging Contractor GARVEY DRILLING COMPANY
Address ROUTE #2, GREAT BEND, KANSAS

STATE OF KANSAS, COUNTY OF BARTON, ss.
MONTE CHADD (employee of owner) or (owner/operator) of the above-described well, being first duly sworn on oath, says: That I have knowledge of the facts, statements, and matters herein contained and the log of the above-described well as filed and that the same are true and correct. So help me God. MONTE CHADD, DIST. PROD. SUPT.
(Signature) *Monte Chadd*
R.R. #2, GREAT BEND, KANSAS
(Address)

SUBSCRIBED AND SWORN TO before me this 16 day of OCTOBER, 19 68

My commission expires APRIL 14, 1971

Arthur J. Miles
Notary Public.

WELL LOG

69

15-009-20282-0000

COMPANY Petroleum, Inc.

SEC. 28 T. 16S R. 13W

FARM Redetzke

NO. B-1

LOC. NW NW NE

TOTAL DEPTH 3443'

COUNTY Barton Co., Kansas

COMM. 10-1-68

COMP. 10-9-68

CONTRACTOR Garvey Drilling Company

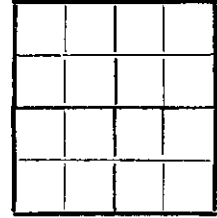

CASING 8 5/8" @ 370' w/200' sx

ELEVATION 1964 D.F.

PRODUCTION D & A

FIGURES INDICATE BOTTOM OF FORMATIONS

- 40' Clay
- 371' Clay & Sand Streaks
- 520' Shale & Shells
- 902' Shale, Shells & Red Bed
- 928' Anhydrite
- 988' Shale & Red Bed
- 1420' Shale, Shells & Salt
- 1755' Shale & Shells
- 1805' Shale
- 1910' Lime
- 2430' Shale & Lime
- 2715' Lime & Shale
- 2840' Shale & Lime
- 2985' Lime & Shale
- 3436' Lime
- 3443' Arbuckle
- 3443' RTD

RECEIVED
 STATE CORPORATION COMMISSION
 OCT 17 1968
 CONSERVATION DIVISION
 Wichita, Kansas

State of Kansas }
 County of Barton } ss

I, Eunice McEachern of Garvey Drilling Company

upon oath state the above and foregoing is a true and correct copy of the log of the Redetzke B-1 well.

Eunice McEachern

Subscribed and sworn to before me this 15th day of October 19 68

My Commission Expires: November 5th, 1969

Richard D. Doy
 NOTARY PUBLIC