

15-007-00143-0000

STATE OF KANSAS
STATE CORPORATION COMMISSION

WELL PLUGGING RECORD

Give All Information Completely
Make Required Affidavit
Mail or Deliver Report to:
Conservation Division
State Corporation Commission
800 Bittling Building
Wichita, Kansas

Barber County. Sec 10 Twp 35 Rge. (E) 11 (W)
Location as "NE/CNW/SW" or footage from lines NW NW SW
Lease Owner Jones, Shelburne & Farmer, Inc.
Lease Name Washburn B Well No. 1
Office Address Russell, Kansas
Character of Well (completed as Oil, Gas or Dry Hole) dry
Date well completed 2-10 19 55
Application for plugging filed 2-10 19 55
Application for plugging approved 2-10 19 55
Plugging commenced 2-10 19 55
Plugging completed 2-10 19 55
Reason for abandonment of well or producing formation dry

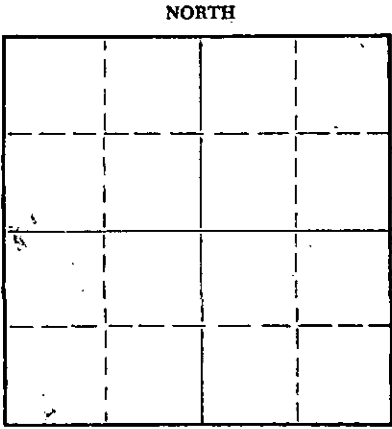

If a producing well is abandoned, date of last production never produced 19
Was permission obtained from the Conservation Division or its agents before plugging was commenced? yes

Name of Conservation Agent who supervised plugging of this well
Producing formation Depth to top Bottom Total Depth of Well 5535 Feet
Show depth and thickness of all water, oil and gas formations.

OIL, GAS OR WATER RECORDS

CASING RECORD

FORMATION	CONTENT	FROM	TO	SIZE	PUT IN	PULLED OUT
				8 5/8	220	none

Describe in detail the manner in which the well was plugged, indicating where the mud fluid was placed and the method or methods used in introducing it into the hole. If cement or other plugs were used, state the character of same and depth placed, from feet to feet for each plug set.

1. Filled hole with heavy mud to bottom surface pipe
2. Pushed plug to within five feet of bottom of surface pipe
3. Pulled drill pipe
4. Dumped in 1/2 sack hulls
5. Ran drill pipe back in and cemented through drill pipe
6. Cemented with 20 sacks on bottom-10 sacks on top
7. Filled hole with mud and then pushed plug to 35 feet.
8. Dumped in 1/2 sack hulls
9. Pumped in 10 sacks through drill pipe to fill hole top.

2-25-55

CONSERVATION DIVISION
Wichita, Kansas

(If additional description is necessary, use BACK of this sheet)
Name of Plugging Contractor Halliburton Oil Well Cementing Co.
Address

STATE OF Kansas, COUNTY OF Russell, ss.
John O. Farmer (employee of owner) or (owner or operator) of the above-described well, being first duly sworn on oath, says: That I have knowledge of the facts, statements, and matters herein contained and the log of the above-described well as filed and that the same are true and correct. So help me God.

(Signature) John O. Farmer
Russell, Kansas (Address)

SUBSCRIBED AND SWORN to before me this 14th day of February, 1955
Bonnie Pratt
Notary Public.

My commission expires July 14, 1958

PLUGGING
FILE SEC 10 T 35 R 11W
BOOK PAGE 96 LINE 43

OPERATOR Jones, Shelburne & Farmer, Inc.

FORMATION RECORD

ADDRESS Russell, Kansas

Give detailed description and thickness of all formations drilled through, contents of sand, whether dry, water, oil or gas.

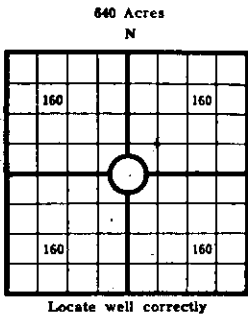

COUNTY Barber SEC 10 TWP 35 RGE 11
 COMPANY OPERATING Jones, Shelburne & Farmer, Inc.
 OFFICE ADDRESS Russell, Kansas
 FARM NAME Washburn B WELL NO. 1
 DRILLING STARTED 1-15-55, DRILLING FINISHED 2-9-55
 DATE OF FIRST PRODUCTION.....COMPLETED.....
 WELL LOCATED NW 1/4 NW 1/4 SW 1/4 North of South
 Line and.....ft. East of West Line of Quarter Section
 Elevation (Relative to sea level) DERRICK FLOOR 1330 ABOVE GROUND
 CHARACTER OF WELL (Oil, gas or dryhole) Dry

Formation	Top	Bottom	Formation	Top	Bottom
Red Bed Sand & Shale	0	600			
Shale	600	955			
Sahle & Shells	955	1075			
Shale & Shells	1075	1700			
Lime & Shale	1700	2750			
Shale & Lime	2750	2900			
Lime & Shale	2900	5535			

2-25-55

STAMPED

PLUGGING

WELL SEC. 10 TWP. 35 RGE. 11

BOOK PAGE 96 LINE 43

TOPS:

Elgin sand 3569
 Heebner 3715
 Douglas Sand 3763
 Douglas Shale 3860
 Stalnaker 4041
 K.C. 4306
 Base of K.C. 4543
 Mississippi 4805
 Chatanooga 5104
 Misener 5131
 Maquoketa 5133
 Viola 5178
 T.D. 5535

OIL OR GAS SANDS OR ZONES

Name	From	To	Name	From	To
1			4		
2			5		
3			6		

Perforating Record If Any

Shot Record

Formation	From	To	No. of Shots	Formation	From	To	Size of Shot

CASING RECORD

Amount Set						Amount Pulled				Packer Record	
Size	Wt.	Thds.	Make	Ft.	In.	Ft.	In.	Size	Length	Depth Set	Make
8 5/8				220							

Liner Record: Amount _____ Kind _____ Top _____ Bottom _____

CEMENTING AND MUDDING

Size	Amount Set		Sacks Cement	Chemical		Method of Cementing	Amount	Mudding Method	Results (See Note)
	Ft.	In.		Gal.	Make				
8 5/8	220		150						

Note: What method was used to protect sands if outer strings were pulled? _____

NOTE: Were bottom hole plugs used? _____ If so, state kind, depth set and results obtained _____

TOOLS USED

Rotary Tools were used from _____ feet to _____ feet to _____ feet, and from _____ feet to _____ feet, and from _____ feet to _____ feet.

Type Rig _____

INITIAL PRODUCTION TEST

Describe initial test: whether by flow through tubing or casing or by pumping _____

Amount of Oil Production _____ bbls. Size of choke, if any _____ Length of test _____ Water Production _____ bbls. Gravity of oil _____ Type of Pump if pump is used, describe _____

I, the undersigned, being first duly sworn upon oath state that this well record is true, correct and complete according to the records of this office and to the best of my knowledge and belief.

John J. Fermentice - Pres.
 Name and title of representative of company

Subscribed and sworn to before me this 15th day of February 1955
 My Commission expires July 14, 1958 *Bonnie Pratt*
 Notary Public.

FARM NAME Washburn B WELL NO. 1 COUNTY Barber SEC 10 TWP 35 RGE 11

15-007-00143-0000