

ORIGINAL

3/26/14

KANSAS CORPORATION COMMISSION  
OIL & GAS CONSERVATION DIVISION

Form ACO-1  
June 2009  
Form Must Be Typed  
Form must be Signed  
All blanks must be Filled

CONFIDENTIAL

WELL COMPLETION FORM  
WELL HISTORY - DESCRIPTION OF WELL & LEASE

OPERATOR: License # 32811  
Name: Osage Resources, L.L.C.  
Address 1: 6209 N. State Rd 61  
Address 2: \_\_\_\_\_  
City: Hutchinson State: KS Zip: 67502 + 8608  
Contact Person: Brooke C. Walter  
Phone: ( 620 ) 860-2224  
CONTRACTOR: License # 33132  
Name: Dan D Drilling  
Wellsite Geologist: Curtis Covey  
Purchaser: \_\_\_\_\_

Designate Type of Completion:  
 New Well     Re-Entry     Workover  
 Oil     WSW     SWD     SIOW  
 Gas     D&A     ENHR     SIGW  
 OG     GSW     Temp. Abd.  
 CM (Coal Bed Methane)  
 Cathodic     Other (Core, Expl., etc.): \_\_\_\_\_

If Workover/Re-entry: Old Well Info as follows:  
Operator: \_\_\_\_\_

Well Name: \_\_\_\_\_

Original Comp. Date: \_\_\_\_\_ Original Total Depth: \_\_\_\_\_  
 Deepening     Re-perf.     Conv. to ENHR     Conv. to SWD  
 Conv. to GSW  
 Plug Back: \_\_\_\_\_ Plug Back Total Depth  
 Commingled    Permit #: \_\_\_\_\_  
 Dual Completion    Permit #: \_\_\_\_\_  
 SWD    Permit #: \_\_\_\_\_  
 ENHR    Permit #: \_\_\_\_\_  
 GSW    Permit #: \_\_\_\_\_

12/15/2011	1/6/2012	1/8/2012
Spud Date or Recompletion Date	Date Reached TD	Completion Date or Recompletion Date

API No. 15 - 007-23780-0100  
Spot Description: \_\_\_\_\_  
NE NE NW NW Sec. 26 Twp. 33 S. R. 15  East  West  
126 Feet from  North /  South Line of Section  
997 Feet from  East /  West Line of Section  
Footages Calculated from Nearest Outside Section Corner:  
 NE  NW  SE  SW  
County: Barber  
Lease Name: Osage No. Well #: 26-07H  
Field Name: Aetna Gas Area  
Producing Formation: Mississippian  
Elevation: Ground: 1807 Kelly Bushing: 1822  
Total Depth: 6945 Plug Back Total Depth: 6900'  
Amount of Surface Pipe Set and Cemented at: 206 Feet  
Multiple Stage Cementing Collar Used?  Yes  No  
If yes, show depth set: \_\_\_\_\_ Feet  
If Alternate II completion, cement circulated from: \_\_\_\_\_  
feet depth to: \_\_\_\_\_ w/ \_\_\_\_\_ sx cmt.

Drilling Fluid Management Plan  
(Data must be collected from the Reserve Pit)  
Chloride content: \_\_\_\_\_ ppm Fluid volume: \_\_\_\_\_ bbls  
Dewatering method used: \_\_\_\_\_  
Location of fluid disposal if hauled offsite:  
Operator Name: \_\_\_\_\_  
Lease Name: \_\_\_\_\_ License #: \_\_\_\_\_  
Quarter CONFIDENTIAL S. R.  East  West  
County: \_\_\_\_\_ Permit #: \_\_\_\_\_  
**MAR 26 2014**  
**KCC**  
**MAR 27 2012**  
**KCC WICHITA**

**INSTRUCTIONS:** An original and two copies of this form shall be filed with the Kansas Corporation Commission, 130 S. Market - Room 2078, Wichita, Kansas 67202, within 120 days of the spud date, recompletion, workover or conversion of a well. Rule 82-3-130, 82-3-106 and 82-3-107 apply. Information of side two of this form will be held confidential for a period of 12 months if requested in writing and submitted with the form (see rule 82-3-107 for confidentiality in excess of 12 months). One copy of all wireline logs and geologist well report shall be attached with this form. ALL CEMENTING TICKETS MUST BE ATTACHED. Submit CP-4 form with all plugged wells. Submit CP-111 form with all temporarily abandoned wells.

**AFFIDAVIT**  
I am the affiant and I hereby certify that all requirements of the statutes, rules and regulations promulgated to regulate the oil and gas industry have been fully complied with and the statements herein are complete and correct to the best of my knowledge.  
Signature: Brooke C. Walter  
Title: Geological Technician Date: 3/26/12

**KCC Office Use ONLY**  
 Letter of Confidentiality Received  
Date: 3-26-12 to 3-26-14  
 Confidential Release Date: \_\_\_\_\_  
 Wireline Log Received  
 Geologist Report Received  
 UIC Distribution  
ALT  I  II  III Approved by: NJ Date: 4/6/12

Operator Name: Osage Resources, L.L.C. Lease Name: Osage No. Well #: 26-07H  
 Sec. 26 Twp. 33 S. R. 15  East  West County: Barber

**INSTRUCTIONS:** Show important tops and base of formations penetrated. Detail all cores. Report all final copies of drill stems tests giving interval tested, time tool open and closed, flowing and shut-in pressures, whether shut-in pressure reached static level, hydrostatic pressures, bottom hole temperature, fluid recovery, and flow rates if gas to surface test, along with final chart(s). Attach extra sheet if more space is needed. Attach complete copy of all Electric Wire-line Logs surveyed. Attach final geological well site report.

Drill Stem Tests Taken <input type="checkbox"/> Yes <input checked="" type="checkbox"/> No <i>(Attach Additional Sheets)</i>  Samples Sent to Geological Survey <input checked="" type="checkbox"/> Yes <input type="checkbox"/> No Cores Taken <input type="checkbox"/> Yes <input checked="" type="checkbox"/> No Electric Log Run <input checked="" type="checkbox"/> Yes <input type="checkbox"/> No Electric Log Submitted Electronically <input type="checkbox"/> Yes <input checked="" type="checkbox"/> No <i>(If no, Submit Copy)</i>  List All E. Logs Run: <b>Density/Neutron, Induction, Sonic, Geo-Perf,</b> <b>Georeport</b>	<input checked="" type="checkbox"/> Log Formation (Top), Depth and Datum <input type="checkbox"/> Sample  <table style="width:100%; border-collapse: collapse;"> <tr> <td style="width:60%;">Name</td> <td style="width:20%;">Top</td> <td style="width:20%;">Datum</td> </tr> <tr> <td>Lansing</td> <td>4260</td> <td>MSL</td> </tr> <tr> <td>BKC</td> <td>4714</td> <td>MSL</td> </tr> <tr> <td>Marmaton</td> <td>4777</td> <td>MSL</td> </tr> <tr> <td>Mississippian</td> <td>5062</td> <td>MSL</td> </tr> </table>	Name	Top	Datum	Lansing	4260	MSL	BKC	4714	MSL	Marmaton	4777	MSL	Mississippian	5062	MSL
Name	Top	Datum														
Lansing	4260	MSL														
BKC	4714	MSL														
Marmaton	4777	MSL														
Mississippian	5062	MSL														

CASING RECORD <input type="checkbox"/> New <input type="checkbox"/> Used							
Report all strings set-conductor, surface, intermediate, production, etc.							
Purpose of String	Size Hole Drilled	Size Casing Set (In O.D.)	Weight Lbs. / Ft.	Setting Depth	Type of Cement	# Sacks Used	Type and Percent Additives
Surface	17.5	13.375	54.5	206	A-Common	240	3% CaCl, 1/4 #/sx celloflake
Intermediate	12.25	9.625	36	2270	A-Con, A-Common	565, 175	3% CaCl, 1/4 #/sx celloflake
Production	8.75	5.5	17	6941	A-Common, Class H	40, 870	10% ash, 0.75% CFR, 0.25% defamer

ADDITIONAL CEMENTING / SQUEEZE RECORD				
Purpose:	Depth Top Bottom	Type of Cement	# Sacks Used	Type and Percent Additives
<input type="checkbox"/> Perforate <input type="checkbox"/> Protect Casing <input type="checkbox"/> Plug Back TD <input type="checkbox"/> Plug Off Zone				

Shots Per Foot	PERFORATION RECORD - Bridge Plugs Set/Type Specify Footage of Each Interval Perforated	Acid, Fracture, Shot, Cement Squeeze Record (Amount and Kind of Material Used)	Depth

RECEIVED  
MAR 27 2012  
KCC WICHITA

TUBING RECORD: Size: _____ Set At: _____ Packer At: _____		Liner Run: <input type="checkbox"/> Yes <input type="checkbox"/> No	
Date of First, Resumed Production, SWD or ENHR. _____		Producing Method: <input type="checkbox"/> Flowing <input type="checkbox"/> Pumping <input type="checkbox"/> Gas Lift <input type="checkbox"/> Other (Explain) _____	
Estimated Production Per 24 Hours	Oil Bbls.	Gas Mcf	Water Bbls. Gas-Oil Ratio Gravity

DISPOSITION OF GAS: <input type="checkbox"/> Vented <input type="checkbox"/> Sold <input type="checkbox"/> Used on Lease <i>(If vented, Submit ACO-18.)</i>	METHOD OF COMPLETION: <input type="checkbox"/> Open Hole <input type="checkbox"/> Perf. <input type="checkbox"/> Dually Comp. <input type="checkbox"/> Commingled <i>(Submit ACO-5)</i> <i>(Submit ACO-4)</i> <input type="checkbox"/> Other (Specify) _____	PRODUCTION INTERVAL: <b>CONFIDENTIAL</b> <b>MAR 26 2014</b>
---	---	---

# BASIC

energy services, L.P.

## TREATMENT REPORT

Customer	OSAGE RES., LLC	Lease No.		Date	12-16-2011
Lease	OSAGE	Well #	26-07H		
Field Order #	05507	Station	PRATT, Ks.	Casing	13 3/8" Depth
Type Job	CNW-13 3/8" C.P.	Formation	TD-230'	County	BARBER State KS.
				Legal Description	26-33-15

PIPE DATA		PERFORATING DATA		FLUID USED		TREATMENT RESUME		
Casing Size	13 3/8"	Tubing Size		Shots/Ft	CMT-240 SK COMMON	RATE	PRESS	ISIP
Depth	220'	Depth		From	To	Pre Pad		5 Min.
Volume	34 BBL	Volume		From	To	Pad	Min	10 Min.
Max Press	500	Max Press		From	To	Frac	Avg	15 Min.
Well Connection	SEV	Annulus Vol.		From	To		HHP Used	Annulus Pressure
Plug Depth	200	Packer Depth		From	To	Flush	Gas Volume	Total Load
						31 BBL		

Customer Representative	JEFF DALE	Station Manager	D. SCOTT	Treater	K. LESLEY
Service Units	37586	19889	19905	19831	19862
Driver Names	LESLEY	LAWRENCE	HUNTER		

Time	Casing Pressure	Tubing Pressure	Bbls. Pumped	Rate	Service Log
12:00AM					ON LOCATION - SAFETY MEETING
5:30AM					RUN 5 JTS. 13 3/8" x 54.5# CSG.
7:20AM					CSG. ON BOTTOM
7:40AM					HOOK UP TO CSG. / BREAK CIRC. W/ RIG
8:10AM	200		5	5	H <sub>2</sub> O AHEAD
8:12AM	100		51	4.5	MIX 240 SK COMMON @ 15.6 PPG
8:23AM	0		0	5	SHUT DOWN - START DISPLACEMENT
8:28AM	100		25	3	SLOW RATE
8:30AM	200		31	3	Pre Pad CMT. @ DESIRED DEPTH

CIRC. THRU JOB RECEIVED  
 CIRC. 10 BBL TO PIT  
 MAR 27 2012  
 KCC WICHITA  
 JOB COMPLETE,  
 THANKS -  
 KEVEN LESLEY

CONFIDENTIAL  
 MAR 26 2014  
 KCC

# BASIC

energy services, L.P.

## TREATMENT REPORT

Customer Osage Resources, LLC Lease No. \_\_\_\_\_ Date 12-21-11  
 Lease Osage Well # 26-07H  
 Field Order # 4967 Station Pratt, Kansas Casing 9 5/8" 36Lb. Depth 2,276 Ft. County Barber State Kansas  
 Type Job C.N.W.-Intermediate Formation \_\_\_\_\_ Legal Description 26-335-15W

PIPE DATA		PERFORATING DATA		CEMENT USED		TREATMENT RESUME		
Casing Size <u>9 5/8"</u>	Tubing Size <u>36 Lb./Ft.</u>	Shots/Ft	<u>565</u>	From	To	Rate	Pressure	ISIP
Depth <u>2,276 Feet</u>	Depth	From	To	12.5 Lb./Gal.	12.28 Gal.	1.1 Stk.	2.17 CU.FT.	5 Min.
Volume <u>176 Bbl.</u>	Volume	From	To			Min		10 Min.
Max Press <u>1,000 PSI</u>	Max Press	From	To	175 sacks	Common with 28 Calcium Chloride	25 Lb./Stk.	cell plate	
Well Connection <u>Plug Container</u>	Annulus Vol	From	To	15.6 Lb./Gal.	5.23 CU.FT.	1.15 Stk.	1.20 CU.FT.	1.15 Stk.
Plug Depth <u>2,234 Feet</u>	Packer Depth	From	To	Flush	172.7 Bbl. Fresh Water	Gas Volume		Total Load

Customer Representative Jeff Dale Station Manager David Scott Treater Clarence R. Messick

Service Units	<u>37,216</u>	<u>19,903</u>	<u>19,905</u>	<u>19,831</u>	<u>19,862</u>	<u>19,889</u>	<u>19,860</u>
Driver Names	<u>Messick</u>	<u>Mattal</u>	<u>Young</u>	<u>Pierson</u>			

Time	Casing Pressure	Tubing Pressure	Bbls. Pumped	Rate	Service Log
9:30					Trucks on location and hold safety meeting.
1:30					Dan D Drilling start to run <del>54</del> Regular Shoe, Shoe Joint with AutoFill Insert screwed into collar and a total of 54 Joint new 36 Lb./Ft. 9 5/8" casing. A Basket was installed above collars #11 and #31. Turbolizers were installed on collars #2, 10, and #30.
3:30					Casing in well. Circulate for 1.5 Hours. Shut in well. Pressure Test. Open well.
5:08	300			5	Start Fresh water Pre-Flush.
			10	6.5	Start mixing 565 sacks A-CON Blend cement.
			228	5	Start mixing 175 sacks common cement.
	-0-		265		Stop pumping. Shut in well. Release Top Rubber Plug. Open Well.
5:52	200			6.5	Start Fresh water Displacement. Start to lift cement.
6:20	700		172.7		Plug down. - <del>CEMENT</del> CEMENT Pressure up.
	1,000				Release pressure. Insert held. Wash up pump truck.
7:00					Job Complete. Thank You. Clarence, Mike, Steve, Jesse

CONFIDENTIAL  
MAR 26 2014

RECEIVED  
MAR 27 2012  
KCC WICHITA

Customer <b>OSAGE RESOURCES LLC</b>	Lease No. <b>OSAGE</b>	Lease # <b>26-07H</b>	Date <b>1-8-12</b>
Field Order # <b>5404</b>	Station <b>PLATT KS</b>	Casing <b>5 1/2</b>	Depth <b>6940</b>
Type Job <b>CRIN - LOWCSTRONG</b>	Formation <b>TD-6945</b>	County <b>BARBER</b>	State <b>KS</b>
Legal Description <b>26-33-15</b>			

PIPE DATA		PERFORATING DATA		FLUID USED		TREATMENT RESUME		
Casing Size <b>5 1/2</b>	Tubing Size <b>6940</b>	Shots/Ft		Acid <b>TD-6945</b>		RATE	PRESS	ISIP
Depth <b>6940</b>	Depth	From	To	Pre-Pad <b>70C?</b>	Max			5 Min.
Volume	Volume	From	To	Pad <b>3700'</b>	Min			10 Min.
Max Press	Max Press	From	To	Frac	Avg			15 Min.
Well Connection	Annulus Vol.	From	To		HHP Used			Annulus Pressure
Plug Depth	Packer Depth	From	To	Flush	Gas Volume			Total Load

Customer Representative <b>JEFF</b>	Station Manager <b>SCOTT</b>	Treater <b>GOULD</b>
Service Units <b>1990</b>	<b>27283</b>	<b>27463</b>
Driver Names <b>KE</b>	<b>DREW</b>	<b>BLAD</b>
<b>1990-1998</b>	<b>19826-19860</b>	<b>19831-19862</b>
<b>OSAGE</b>	<b>MILIBON</b>	<b>JESSE</b>

Time	Casing Pressure	Tubing Pressure	Bbls. Pumped	Rate	Service Log
0800					ON LOCATION
					RUN 6940' 5 1/2" 17" N-80 - 172 JTS
					DOUBLE WAVE WASH ON FRONT SIDE
					CONCENTRATOR - 2-10-20-30-40-50-60-
					71-80-90-100
					PRECISE FOR 2 HOURS
	400				PSI TEST LEVE - HEAD
0900	300		12	5	PUMP 12 bbl MILDFOUR
	300		5	5	PUMP 5 bbl H <sub>2</sub> O
	300		14	5	PUMP 40 SK SCAVENGER CEMENT
	300		192	5	PUMP 870 SK 'H' CEMENT
			206		10% SPRT 34% CER, 14% DEFORMER,
					19% WEA-1 AT 15.6 PPG
					STOP WASH LEVE W/ SUCR H <sub>2</sub> O
					DROP PUMP
	0		0	6 1/2	START DESP W/ 2% HCC SUCR H <sub>2</sub> O
	400		75	6 1/2	PLAUGHT LEFT PSI
	1000		151	4	SLOW RATE
1030	1500		161	4	PLUG DOWN - HEAD
1035	3500			2 1/2	BURST DISK AT 3500
					RECEIVED
					MAR 27 2012
					KCC WICHITA
1130					JOB COMPLETE - KEVIN

Osage  
26-07H

Lat 37.1510772  
Long -98.9250515

424'

Miss. 5,062'

NW/4  
26-T33S-R15W

Osage  
116

FTF  
No. 13

Lat 37.1451118  
Long -98.9250404

361'



ACO-1 Plat Map

Osage No. 26-07H

Barber County, KS

CONFIDENTIAL

COPYRIGHT 2012

By: Brooke C. Walter

MAP PROJECTION

Datum: WGS 1984

April 10, 2012

CONFIDENTIAL

MAR 26 2014

KCC

RECEIVED

APR 11 2012

KCC WICHITA



Osage 26-07H

Barber County, Kansas

WELL PROFILE DATA rev1							
MD	Inc.	Azi.	TVD	N-S	E-W	DLS	Comment
4518	0.00	180.00	4518	0	0	0.00	KOP Begin 13.48°/100' Build
5178	88.91	180.00	4943	-417	0	13.48	Begin 88.91° Lateral Section
6941	88.91	180.00	4977	-2180	0	0.00	PBHL/TD

WELL PROFILE DATA svys							
MD	Inc.	Azi.	TVD	N-S	E-W	DLS	Comment
6945	87.20	179.30	4973	-2171	5	0.00	Survey Proj. to 6945 MD



1 inch = 500 ft <= West East =>

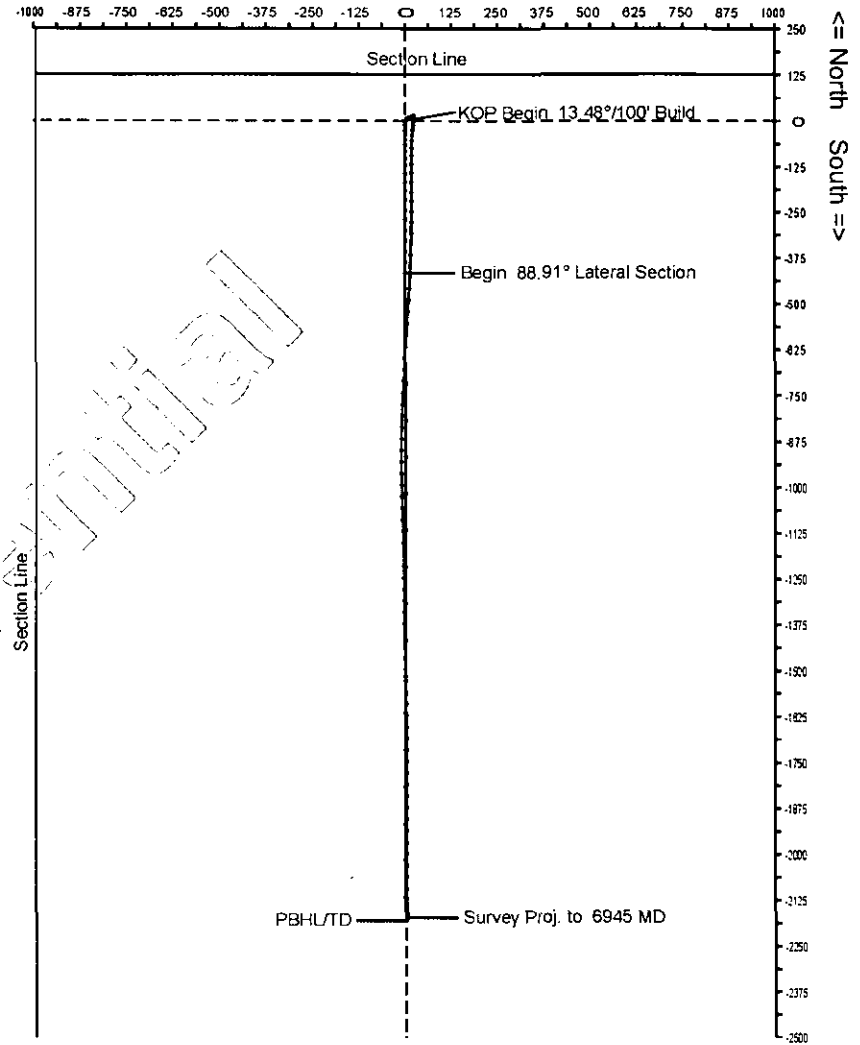

True Vertical Depth 1 inch = 300 ft

<=>

MAR 27 2012

RECEIVED

KCC WICHITA

CONFIDENTIAL  
MAR 26 2014  
KCC

5100

Vertical Section on 180 deg azimuth with reference 0.00 N, 0.00 E

Calmena Energy Services

Company: Osage Resources  
 Well: Osage 26-07H  
 Location: Barber County, Kansas

Date: 7-Jan-2012  
 Surveys  
 Page 1  
 Job#: 6088

MD (feet)	Inclination (degrees)	Azimuth (degrees)	TVD (feet)	N-S (feet)	E-W (feet)	DLS (deg/100')	VS @ 180.00° Az (feet)	Comments
Surface Location								
0.00	0.00	0.00	0.00	0.00	0.00	0.00	0.00	
2357.00	0.30	32.60	2356.99	5.20	3.32	0.01	-5.20	
2734.00	0.30	127.20	2733.99	5.43	4.64	0.12	-5.43	
3113.00	0.20	35.30	3112.98	5.37	5.82	0.10	-5.37	
3490.00	0.80	67.30	3489.97	6.93	8.62	0.17	-6.93	
3868.00	1.00	74.80	3867.92	8.81	14.24	0.06	-8.81	
4247.00	0.60	40.50	4246.89	11.19	18.72	0.16	-11.19	
4445.00	1.20	60.00	4444.86	13.01	21.19	0.34	-13.01	
4477.00	1.10	72.10	4476.85	13.27	21.77	0.82	-13.27	
4507.00	1.00	110.30	4506.85	13.27	22.29	2.31	-13.27	
4538.00	3.40	172.10	4538.83	12.23	22.68	9.55	-12.23	
4570.00	7.30	179.70	4569.69	9.35	22.82	12.76	-9.35	
4601.00	11.50	185.00	4601.25	4.14	22.55	13.39	-4.14	
4632.00	15.80	186.00	4632.34	-3.38	21.82	13.46	3.38	
4662.00	20.40	187.00	4662.75	-13.25	20.68	14.41	13.25	
4692.00	25.00	186.20	4692.26	-25.51	19.27	14.41	25.51	
4729.00	29.70	184.20	4719.79	-39.69	18.00	15.45	39.69	
4760.00	34.30	181.60	4746.07	-56.09	17.20	15.49	56.09	
4792.00	39.30	180.40	4771.69	-75.25	16.87	15.79	75.25	
4823.00	43.90	180.70	4794.86	-95.83	16.67	14.85	95.83	
4855.00	48.20	181.00	4817.07	-118.86	16.33	13.45	118.86	
4887.00	52.30	180.30	4837.52	-143.45	16.06	12.92	143.45	
4918.00	55.70	179.40	4855.74	-168.53	16.12	11.22	168.53	
4950.00	59.10	179.60	4872.98	-195.48	16.36	10.64	195.48	
4980.00	62.20	179.90	4887.68	-221.63	16.47	10.37	221.63	
4912.00	64.70	180.20	4901.99	-250.25	16.45	7.86	250.25	
4944.00	66.80	180.90	4915.13	-279.42	16.16	6.86	279.42	
4976.00	69.20	181.40	4927.12	-309.09	15.57	7.64	309.09	
5107.00	72.70	181.90	4937.23	-338.37	14.72	11.39	338.37	
5137.00	76.30	182.00	4945.25	-367.26	13.74	12.00	367.26	

KCC

OSAGE  
 WICHITA  
 MAR 26 2014

KCC WICHITA

MAR 27 2012

RECEIVED



Calmena Energy Services

Company: Osage Resources  
 Well: Osage 26-07H  
 Location: Barber County, Kansas

Date: 7-Jan-2012  
 Surveys  
 Page 2  
 Job#: 6088

MD (feet)	Inclination (degrees)	Azimuth (degrees)	TVD (feet)	N-S (feet)	E-W (feet)	DLS (deg/100')	VS @ 180.00° Az (feet)	Comments
5168.00	77.00	182.00	4952.41	-397.40	12.69	2.26	397.40	
5200.00	79.20	181.80	4959.00	-428.70	11.65	6.90	428.70	
5231.00	82.10	182.40	4964.04	-459.26	10.53	9.55	459.26	
5263.00	85.30	183.50	4967.55	-491.02	8.89	10.57	491.02	
5294.00	86.70	183.90	4969.71	-521.88	6.89	4.70	521.88	
5326.00	87.20	184.20	4971.42	-553.75	4.64	1.82	553.75	
5358.00	89.70	184.20	4972.28	-585.65	2.30	7.81	585.65	
5389.00	90.90	184.20	4972.12	-616.57	0.02	3.87	616.57	
5420.00	91.20	184.30	4971.55	-647.48	-2.27	1.02	647.48	
5452.00	91.70	183.70	4970.74	-679.39	-4.50	2.44	679.39	
5483.00	93.00	183.20	4969.47	-710.31	-6.37	4.49	710.31	
5515.00	93.70	183.00	4967.60	-742.21	-8.10	2.27	742.21	
5547.00	93.60	182.00	4965.56	-774.11	-9.49	3.13	774.11	
5578.00	93.50	181.60	4963.64	-805.04	-10.46	1.33	805.04	
5610.00	94.10	181.10	4961.52	-836.96	-11.21	2.44	836.96	
5641.00	94.70	180.70	4959.14	-867.86	-11.70	2.32	867.86	
5672.00	93.50	180.40	4956.93	-898.78	-11.99	3.99	898.78	
5704.00	92.40	179.70	4955.28	-930.74	-12.02	4.07	930.74	
5735.00	90.40	179.10	4954.52	-961.72	-11.70	6.74	961.72	
5767.00	90.40	179.20	4954.30	-993.72	-11.22	0.31	993.72	
5799.00	89.50	178.40	4954.33	-1025.71	-10.55	3.76	1025.71	
5831.00	89.70	177.90	4954.55	-1057.69	-9.52	1.68	1057.69	
5862.00	90.40	177.70	4954.52	-1088.67	-8.33	2.35	1088.67	
5893.00	90.10	178.10	4954.39	-1119.65	-7.19	1.61	1119.65	
5925.00	89.00	178.90	4954.64	-1151.64	-6.36	4.25	1151.64	
5956.00	89.30	178.80	4955.10	-1182.63	-5.73	1.02	1182.63	
5988.00	89.60	178.90	4955.41	-1214.62	-5.09	0.99	1214.62	
6020.00	89.90	179.40	4955.55	-1246.62	-4.62	1.82	1246.62	
6051.00	90.30	179.20	4955.49	-1277.61	-4.24	1.44	1277.61	
6082.00	90.50	179.00	4955.28	-1308.61	-3.75	0.91	1308.61	

CONFIDENTIAL

MAR 26 2014

KCC

RECEIVED

MAR 27 2012

KCC WICHITA

**Calmena Energy Services**

Company: Osage Resources  
 Well: Osage 26-07H  
 Location: Barber County, Kansas

Date: 7-Jan-2012  
 Surveys  
 Page 3  
 Job#: 6088

MD (feet)	Inclination (degrees)	Azimuth (degrees)	TVD (feet)	N/-S (feet)	E/-W (feet)	DLS (deg/100')	VS @ 180.00° Az (feet)	Comments
6114.00	91.10	179.00	4954.83	-1340.60	-3.19	1.88	1340.60	
6146.00	89.70	179.20	4954.61	-1372.59	-2.69	4.42	1372.59	
6177.00	87.90	179.10	4955.26	-1403.58	-2.23	5.82	1403.58	
6209.00	87.60	179.10	4956.51	-1435.55	-1.73	0.94	1435.55	
6240.00	88.00	178.80	4957.70	-1466.53	-1.16	1.61	1466.53	
6271.00	88.60	178.80	4958.62	-1497.51	-0.51	1.94	1497.51	
6301.00	88.80	178.50	4959.30	-1527.49	0.19	1.20	1527.49	
6333.00	88.00	179.10	4960.20	-1559.47	0.86	3.12	1559.47	
6364.00	88.10	179.10	4961.25	-1590.45	1.35	0.32	1590.45	
6396.00	88.60	178.80	4962.17	-1622.43	1.94	1.82	1622.43	
6427.00	89.00	179.20	4962.82	-1653.42	2.48	1.82	1653.42	
6458.00	89.40	179.20	4963.25	-1684.41	2.91	1.29	1684.41	
6490.00	90.00	179.50	4963.42	-1716.41	3.27	2.10	1716.41	
6521.00	90.60	179.30	4963.26	-1747.41	3.60	2.04	1747.41	
6552.00	89.70	179.80	4963.18	-1778.41	3.84	3.32	1778.41	
6583.00	89.50	180.10	4963.40	-1809.40	3.87	1.16	1809.40	
6615.00	89.40	180.20	4963.70	-1841.40	3.79	0.44	1841.40	
6646.00	89.50	180.30	4964.00	-1872.40	3.65	0.46	1872.40	
6678.00	89.60	180.10	4964.25	-1904.40	3.54	0.70	1904.40	
6709.00	89.80	180.30	4964.41	-1935.40	3.43	0.91	1935.40	
6741.00	90.30	180.10	4964.39	-1967.40	3.32	1.68	1967.40	
6772.00	89.30	179.90	4964.49	-1998.40	3.32	3.29	1998.40	
6804.00	86.90	179.60	4965.55	-2030.38	3.46	7.56	2030.38	
6835.00	86.80	179.40	4967.26	-2061.33	3.73	0.72	2061.33	
6867.00	86.70	179.50	4969.07	-2093.28	4.03	0.44	2093.28	
6894.00	87.20	179.30	4970.51	-2120.24	4.32	1.99	2120.24	
6945.00	87.20	179.30	4973.00	-2171.17	4.94	0.00	2171.17	Survey Proj. to 6945 MD

KCC  
 MAR 26 2014  
 CONFIDENTIAL