

KANSAS

**WELL COMPLETION REPORT AND DRILLER'S LOG**

S. 15 T. 32S R. 8E E

Loc. NE NE NE

County CHAUTAUQUA

API No. 15 — 019 — 21413 -06-06  
County Number

Operator  
Paul Kloberdanz

Address  
504 Park/Harvey Center Oklahoma City, OK 73102

Well No. #6 Lease Name MK&O

Footage Location 180' from North line 330' from East line  
feet from (N) (S) line 4987 PSL feet from (E) (W) line 343 FEL

Principal Contractor B & N Drilling Co. Geologist OPS-LCC-DLG - 4/8/14  
Paul E. Kloberdanz

Spud Date 10-3-79 Date Completed 10-11-79 Total Depth 2650' P.B.T.D. 1952'

Directional Deviation NONE Total Petroleum - Oil  
Union Gas System - Gas

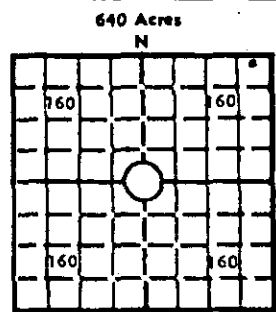

Elev.: Gr. 1294

DF. 1299' KB

**CASING RECORD**

Report of all strings set— surface, intermediate, production, etc.

Purpose of string	Size hole drilled	Size casing set (in O.D.)	Weight lbs/ft.	Setting depth	Type cement	Sacks	Type and percent additives
Surface	9 7/8"	7"		102'	Reg.	60	CaCl <sub>2</sub>
Production	6 1/4"	4 1/2"	9.5#	1951.75'	50-50 poz	75	10% salt

**LINER RECORD**

**PERFORATION RECORD**

Top, ft.	Bottom, ft.	Sacks cement	Shots per ft.	Size & type	Depth interval
			3 holes/ft.	Jet	1746-50

**TUBING RECORD**

Size	Setting depth	Packer set at
2 3/8"	1750'	NONE

**ACID, FRACTURE, SHOT, CEMENT SQUEEZE RECORD**

Amount and kind of material used	Depth interval treated
250 gal. mud acid	1746-50
1000 Gal. oil and 1000# sand	1746-50

**INITIAL PRODUCTION**

Date of first production <u>1-10-80</u>	Producing method (flowing, pumping, gas lift, etc.) <u>Flowing</u>	Gas-oil ratio <u>JUN 18 2012</u> CFPB
RATE OF PRODUCTION PER 24 HOURS	Oil <u>1</u> bbls. Gas <u>300</u> MCF Water <u>6</u> bbls.	
Disposition of gas (vented, used on lease or sold) <u>Sold</u>	Producing interval (s) <u>1746-50 (Layton)</u>	<b>KCC WICHITA</b>

INSTRUCTIONS: As provided in KCC Rule 82-2-125, within 90 days after completion of a well, one completed copy of this Drillers Log shall be transmitted to the State Geological Survey of Kansas, 4150 Monroe Street, Wichita, Kansas 67209. Copies of this form are available from the Conservation Division, State Corporation Commission, 245 No. Water, Wichita, Kansas 67202. Phone AC 316-522-2206. If confidential custody is desired, please note Rule 82-2-125. Drillers Logs will be on an open file in the Oil and Gas Division, State Geological Survey of Kansas, Lawrence, Kansas 66044.

Operator **Paul Kloberdanz** DESIGNATE TYPE OF COMP.: OIL, GAS, DRY HOLE, SWDW, ETC.:

Well No. #6 Lease Name MKO Gas

S 15 T 32 S R 8 <sup>E</sup>/<sub>W</sub>

**WELL LOG**

Show all important zones of porosity and contents thereof; cored intervals, and all drill-stem tests, including depth interval tested, cushion used, time tool open, flowing and shut-in pressures, and recoveries.

SHOW GEOLOGICAL MARKERS, LOGS RUN, OR OTHER DESCRIPTIVE INFORMATION.

FORMATION DESCRIPTION, CONTENTS, ETC.	TOP	BOTTOM	NAME	DEPTH
Soil	0	6		
lime	6	35		
shale	35	73		
lime	73	76		
shale	76	106		
shale	106	368		
lime	368	375		
shale	375	637		
lime with shale	637	670		
lime	670	907		
shale	907	961		
lime	961	972		
shale	972	1041		
lime	1041	1048		
shale	1048	1087		
lime	1087	1089		
shale	1089	1117		
lime	1117	1127		
sand	1127	1298		
shale	1298	1367		
lime	1367	1373		
shale	1373	1405		
shale with lime	1405	1496		
lime	1496	1538		
shale & sand	1538	1765		
shale w/ lime	1765	1808		
shale	1808	1868		
lime	1868	1910		
shale	1910	1980		
lime	1980	2075		
shale w/ lime	2075	2238		
lime	2238	2318		
lime & shale	2318	2595		
mississippi	2595	2650		

USE ADDITIONAL SHEETS, IF NECESSARY, TO COMPLETE WELL RECORD.

Date Received		
	Operator	RECEIVED
	February 25, 1980	JUN 10 2012
	Date	