

STATE CORPORATION COMMISSION OF KANSAS  
OIL & GAS CONSERVATION DIVISION  
WELL COMPLETION FORM  
ACD-1 WELL HISTORY  
DESCRIPTION OF WELL AND LEASE

API NO. 15- 033-20877-0000 **CONFIDENTIAL**

County Comanche

150' -N/C - SW -SW Sec. 9 Twp. 31S Rge. 18 X <sup>E</sup> <sub>W</sub>

**ORIGINAL**

Operator: License # 5050

680 Feet from S (circle one) Line of Section

Name: Hummon Corporation

670 Feet from E/W (circle one) Line of Section

Address 200 W Douglas, Suite 1020  
Wichita, KS 67202

Footages Calculated from Nearest Outside Section Corner:  
NE, SE, NW or SW (circle one)

City/State/Zip \_\_\_\_\_

Lease Name Swarner Well # 2

Purchaser: Koch Oil Company

Field Name Alford Ext.

Operator Contact Person: Byron E. Hummon, Jr.

Producing Formation Mississippian

Phone (316 ) 263-8521

Elevation: Ground 2139 KB 2144

Contractor: Name: VAL Energy, Inc.

Total Depth 5180 PBDT 5149.60'

License: 5822

Amount of Surface Pipe Set and Cemented at 658 Feet

Wellsite Geologist: Byron E. Hummon, Jr.

Multiple Stage Cementing Collar Used? \_\_\_\_\_ Yes X No

Designate Type of Completion  
X New Well \_\_\_\_\_ Re-Entry \_\_\_\_\_ Workover

If yes, show depth set \_\_\_\_\_ Feet

X Oil \_\_\_\_\_ SWD \_\_\_\_\_ SIOW \_\_\_\_\_ Temp. Abd.  
\_\_\_\_\_ Gas \_\_\_\_\_ ENHR \_\_\_\_\_ SIGW  
\_\_\_\_\_ Dry \_\_\_\_\_ Other (Core, WSW, Expl., Cathodic, etc)

If Alternate II completion, cement circulated from NA

feet depth to \_\_\_\_\_ w/ \_\_\_\_\_ sx cmt.

If Workover/Re-Entry: old well info as follows:

Drilling Fluid Management Plan  
(Data must be collected from the Reserve Pit)

Operator: RELEASED

Chloride content 46,000 ppm Fluid volume 240 bbls

Well Name: \_\_\_\_\_

Dewatering method used Hauled

Comp. Date \_\_\_\_\_ Old Total Depth NOV 21 1994

Location of fluid disposal if hauled offsite: \_\_\_\_\_

\_\_\_\_\_ Deepening \_\_\_\_\_ Re-perf. \_\_\_\_\_ Copy to Inj/SWD  
\_\_\_\_\_ Plug Back \_\_\_\_\_ **FROM CONFIDENTIAL**  
\_\_\_\_\_ Commingled \_\_\_\_\_ Docket No. \_\_\_\_\_  
\_\_\_\_\_ Dual Completion \_\_\_\_\_ Docket No. \_\_\_\_\_  
\_\_\_\_\_ Other (SWD or Inj?) \_\_\_\_\_ Docket No. \_\_\_\_\_

Operator Name Peter H. Beren

Lease Name V.H. Coehen #12 SWD license No. 03051

9/3/93 9/12/93 9/13/93  
Spud Date Date Reached TD Completion Date

SW Quarter Sec. 28 Twp. 29 S Rng. 18 E/W

County Comanche Docket No. D-5617

**INSTRUCTIONS:** An original and two copies of this form shall be filed with the Kansas Corporation Commission, 200 Colorado Derby Building, Wichita, Kansas 67202, within 120 days of the spud date, recompletion, workover or conversion of a well. Rule 82-3-130, 82-3-106 and 82-3-107 apply. Information on side two of this form will be held confidential for a period of 12 months if requested in writing and submitted with the form (see rule 82-3-107 for confidentiality in excess of 12 months). One copy of all wireline logs and geologist well report shall be attached with this form. ALL CEMENTING TICKETS MUST BE ATTACHED. Submit CP-4 form with all plugged wells. Submit CP-111 form with all temporarily abandoned wells.

All requirements of the statutes, rules and regulations promulgated to regulate the oil and gas industry have been fully complied with and the statements herein are complete and correct to the best of my knowledge.

Signature Byron E. Hummon, Jr.

Title Byron E. Hummon, Jr., President Date 10/18/93

Subscribed and sworn to before me this 18th day of October, 19 93.

Notary Public Sandra E. Mendez  
NOTARY PUBLIC  
STATE OF KANSAS  
February 26, 1994  
My Appt. Exp. \_\_\_\_\_

**RECEIVED**  
STATE CORPORATION COMMISSION  
O.C.C. OFFICE USE ONLY  
F \_\_\_\_\_ Letter of Confidentiality Attached  
C \_\_\_\_\_ Wireline Log Received  
C \_\_\_\_\_ Geologist Report Received  
CONSERVATION DIVISION  
Wichita, Kansas  
KCC \_\_\_\_\_ SWD/Rep \_\_\_\_\_ NGPA  
KGS \_\_\_\_\_ Plug \_\_\_\_\_ Other \_\_\_\_\_  
(Specify)

Operator Name Hummon Corporation Lease Name Swarner Well # 2  
 East County Comanche  
 Sec. 9 Twp. 31 Rge. 18  West

INSTRUCTIONS: Show important tops and base of formations penetrated. Detail all cores. Report all drill stem tests giving interval tested, time tool open and closed, flowing and shut-in pressures, whether shut-in pressure reached static level, hydrostatic pressures, bottom hole temperature, fluid recovery, and flow rates if gas to surface during test. Attach extra sheet if more space is needed. Attach copy of log.

Drill Stem Tests Taken (Attach Additional Sheets.)	<input checked="" type="checkbox"/> Yes <input type="checkbox"/> No	<input checked="" type="checkbox"/> Log	Formation (Top), Depth and Datum	<input type="checkbox"/> Sample
Samples Sent to Geological Survey	<input type="checkbox"/> Yes <input checked="" type="checkbox"/> No	Name	Top	Datum
Cores Taken	<input type="checkbox"/> Yes <input checked="" type="checkbox"/> No	Heebner SH	4214	(-2070)
Electric Log Run (Submit Copy.)	<input checked="" type="checkbox"/> Yes <input type="checkbox"/> No	Brown LM	4387	(-2243)
List All E.Logs Run:		Lansing	4407	(-2263)
Dual Induction Log.		B.K.C.	4830	(-2686)
Neutron/Density Por. Log		Altamont	4885	(-2741)
Frac Finder		Cherokee SH	4975	(-2831)
		Mississippi	5040	(-2896)
		LTD	5176	

CASING RECORD <input checked="" type="checkbox"/> New <input checked="" type="checkbox"/> Used							
Report all strings set-conductor, surface, intermediate, production, etc.							
Purpose of String	Size Hole Drilled	Size Casing Set (In O.D.)	Weight Lbs./Ft.	Setting Depth	Type of Cement	# Sacks Used	Type and Percent Additives
Surface	12 1/4"	8-5/8"	28#	658'	60/40 Poz	325sx	2% Gel, 3% CC
Production	7-7/8"	5 1/2"	14# & 15 1/2#	5175'	ASC 60/40 Poz	75sx 125sx	5% salt

ADDITIONAL CEMENTING/SQUEEZE RECORD				
Purpose:	Depth Top Bottom	Type of Cement	#Sacks Used	Type and Percent Additives
<input type="checkbox"/> Perforate				
<input type="checkbox"/> Protect Casing				
<input type="checkbox"/> Plug Back TD				
<input type="checkbox"/> Plug Off Zone				

Shots Per Foot	PERFORATION RECORD - Bridge Plugs Set/Type	Acid, Fracture, Shot, Cement Squeeze Record	
	Specify Footage of Each Interval Perforated	(Amount and Kind of Material Used)	Depth
2 Jets/ft	5046 - 5050		
4 Jets/ft	5049 - 5053		

<b>TUBING RECORD</b>	Size <u>2-3/8"</u>	Set At <u>5074'</u>	Packer At <u>NONE</u>	Liner Run <input type="checkbox"/> Yes <input checked="" type="checkbox"/> No
Date of First, Resumed, Production, SWD or Inj.	Producing Method <input type="checkbox"/> Flowing <input checked="" type="checkbox"/> Pumping <input type="checkbox"/> Gas Lift <input type="checkbox"/> Other (Explain)			
<u>10/12/93</u>				
Estimated Production Per 24 Hours	Oil <u>55</u> Bbls.	Gas	Mcf	Water Bbls. <u>-0-</u> Gravity <u>36°</u>

Disposition of Gas:  Vented  Sold  Used on Lease (If vented, submit ACO-18.)

METHOD OF COMPLETION:  Open Hole  Perf.  Dually Comp.  Commingled  Other (Specify)

Production Interval: 5049 - 5053

ORIGINAL

CONFIDENTIAL

API # 15-033-20877

ACO-1 WELL HISTORY

SIDE TWO (Page Two)

OPERATOR Hummon Corporation LEASE NAME Swarner #2

SEC. 9 TWP. 31S RGE. 18 (W)

FILL IN WELL LOG AS REQUIRED: WELL NO. \_\_\_\_\_

Show all important zones of porosity and contents thereof; cored intervals, and all drill-stem tests, including depth interval tested, cushion used, time tool open, flowing and shut-in pressures, and recoveries.

SHOW GEOLOGICAL MARKERS, LOGS RUN, OR OTHER DESCRIPTIVE INFORMATION.

FORMATION DESCRIPTION, CONTENTS, ETC.	TOP	BOTTOM	NAME	DEPTH
---------------------------------------	-----	--------	------	-------

DST #1: 5050 - 5068

30/60/60/90

Strg blow, GTS in 11 mins. - 1st Flow

In 15 mins GA 68.8 CFG,

in 30 mins decrease to 64 CFG.

2nd flow GA: 10 mins 78.1 CFG

20 mins 68.8 CFG

30 mins 59.2 CFG

40 mins 59.2 CFG

50 mins 47.7 CFG

60 mins 47.7 CFG

Rec. 870' free oil (38° GR)

240' HG&OCM (20% G, 20% M, 60% O)

65' W (87,000 PPM)

SIP 1426/1426

FP 120/151 - 201/332

HP 2545/2446

BHT 124°

KCC

OCT 2 0

DST #2: 5069 - 5082

45/60/60/90

Wk - strg blow in 30 mins - 1st Flow

Strg blow in final Flow

Rec. 180' GIP

5' O

120' SOCMW

60' WM

(Water - 78,000 PPM)

BHP 1446/1446

FP 50/70 - 80/100

HP 2446/2426

BHT 126°

CONFIDENTIAL

RELEASED

NOV 2 1 1994

DST #3: 5080 - 5108

30/60/60/90

1st Flow Gd blow 7 mins in bucket

2nd Flow Gd blow 10 mins in bucket

Rec. 270' W (30,000 PPM)

BHP 1442/1427

FP 40/70 - 91/126

HP 2466/2377

BHT 124°

FROM CONFIDENTIAL

RECEIVED  
STATE CORPORATION COMMISSION

OCT 2 1 1993

CONSERVATION DIVISION  
Wichita, Kansas

483-2627, Russell, Kansas

16-793-5861, Great Bend, Kansas

ORIGINAL CONFIDENTIAL

Phone Plainville 913-434-2812

Phone Ness City 913-798-3843

# ALLIED CEMENTING CO., INC.

2884

Home Office P. O. Box 31

Russell, Kansas 67665

*New*

Date	9-4-93	Sec.	9	FWP.	31s	Range	18W	Called Out	9:15 PM	On Location	11:30 PM	Job Start	7:15 AM	Finish	7:45 AM	
Lease	SWARREN		Well No.	2		Location	COLDWATER SW 7E 1/4N 4S		County	COMANCHE		State	KANSAS			
Contractor	VAL ENERGY #1					Owner	HUMMON CORP.									
Type Job	SURFACE					To Allied Cementing Co., Inc. You are hereby requested to rent cementing equipment and furnish cementer and helper to assist owner or contractor to do work as listed.										
Hole Size	12 1/4"		T.D.	670'												
Csg.	8 7/8" 28#		Depth	658' KCC												
Tbg. Size			Depth													
Drill Pipe			Depth	OCT 20												
Tool			Depth	CONFIDENTIAL												
Cement Left in Csg.			Shoe Joint	37.00'												
Press Max.	700		Minimum	50												
Meas Line			Displace	39 BBLs												
Perf.																
<b>EQUIPMENT</b>																
Pumptrk	No.	Cementer	K. BRUNBARDT													
Pumptrk	265	Helper	C. BALDWIN													
Pumptrk	No.	Cementer														
Pumptrk		Helper														
Bulktrk	256	Driver	M. BRUNBARDT													
Bulktrk		Driver														
DEPTH of Job 658'																
Reference:	PUMP CHARGE		430.00													
	35 WIEASE ON PUMP		78.75													
	1 8 7/8" TOP RUBBER PLUG		83.00													
	358' at .39		139.62													
			Total 731.37													
Remarks:	CEMENT DTD GROUTAGE															
<b>CEMENT</b>																
Amount Ordered	325x 60140: 2 <sup>nd</sup> + 3 <sup>rd</sup> Lot															
Consisting of																
Common	195	5.75	1121.25													
Poz. Mix	130	3.00	390.00													
Gel.	7	7.00	49.00													
Chloride	10	25.00	250.00													
Quickset	RELEASED															
NOV 21 1994																
Handling	325x 60140: 2 <sup>nd</sup> + 3 <sup>rd</sup> Lot													325.00		
Mileage	35													455.00		
															Total 2590.2	
Floating Equipment																
1-8 7/8" RECEIVED STATE CORPORATION COMMISSION																
Total 105.00																
OCT 21 1993																
Disc 85.33																
\$ 2741.29																





P.O. BOX 31  
RUSSELL, KS 67665

# CEMENTING LOG

STAGE NO. **CONFIDENTIAL**

Date 9/13/93 District Med. Lodge Ticket No. 3559  
 Company HUMMON Corp Rig Val Energy  
 Lease SWARNER Well No. 2  
 County COMANCHE State KS  
 Location 9-315-18W Field ORIGIN  
Cold water SW 2E 1/4 N E15

CASING DATA: PTA  Squeeze   
 Surface  Intermediate  Production  Liner   
 Size 5 1/2 Type \_\_\_\_\_ Weight 15.50 #/ft Collar \_\_\_\_\_

Casing Depths: Top 0 **KCC** Bottom 5178  
**OCT 20**

**CONFIDENTIAL**  
 Drill Pipe: Size \_\_\_\_\_ Weight \_\_\_\_\_ Collars \_\_\_\_\_  
 Open Hole: Size 7 7/8 T.D. 5190 ft. P.B. to \_\_\_\_\_ ft.  
 CAPACITY FACTORS:  
 Casing: Bbls/Lin. ft. .0244 Lin. ft./Bbl. 40.9796  
 Open Holes: Bbls/Lin. ft. .0602 Lin. ft./Bbl. 16.5993  
 Drill Pipe: Bbls/Lin. ft. \_\_\_\_\_ Lin. ft./Bbl. \_\_\_\_\_  
 Annulus: Bbls/Lin. ft. .0309 Lin. ft./Bbl. 32.4065  
 Bbls/Lin. ft. \_\_\_\_\_ Lin. ft./Bbl. \_\_\_\_\_  
 Perforations: From \_\_\_\_\_ ft. to \_\_\_\_\_ ft. Amt. \_\_\_\_\_

CEMENT DATA:  
 Spacer Type: 300gal Mud Clean 300gal Mud Sweep  
 Amt. \_\_\_\_\_ Skys Yield \_\_\_\_\_ ft<sup>3</sup>/sk Density \_\_\_\_\_ PPG \_\_\_\_\_

LEAD: Pump Time \_\_\_\_\_ hrs. Type 60.40.23.901  
90.90salt 5# Kol-seal 3420 CD-31 Excess \_\_\_\_\_  
 Amt. 125 Skys Yield 1.37 ft<sup>3</sup>/sk Density 14.4 PPG

TAIL: Pump Time \_\_\_\_\_ hrs. Type A.S.C + 5# Kol-seal  
 Excess \_\_\_\_\_  
 Amt. 75 Skys Yield 1.57 ft<sup>3</sup>/sk Density 14.5 PPG  
 WATER: Lead 5.82 gals/sk Tail 7.23 gals/sk Total 30 Bbls.

Pump Trucks Used 255-265 Carl Balding  
 Bulk Equip. 257-249 John Kelley

Float Equip: Manufacturer Baker  
 Shoe: Type Guide Shoe Depth \_\_\_\_\_  
 Float: Type AFU Insert Depth \_\_\_\_\_  
 Centralizers: Quantity 4 Plugs Top Rubber Btm. \_\_\_\_\_  
 Stage Collars \_\_\_\_\_  
 Special Equip. \_\_\_\_\_  
 Disp. Fluid Type H<sub>2</sub>O Amt. 125 Bbls. Weight \_\_\_\_\_ PPG  
 Mud Type \_\_\_\_\_ Weight \_\_\_\_\_ PPG

COMPANY REPRESENTATIVE Byron Hummon CEMENTER Max Ball

TIME	PRESSURES PSI		FLUID PUMPED DATA			REMARKS
	AM/PM	DRILL PIPE CASING	ANNULUS	TOTAL FLUID	Pumped Per Time Period	
9:30						ON Loc Rig up
6:40		400			12	6 Pump Mud Clean
6:42		400			7	6 Pump Mud Sweep
6:43						5 Shut Down H <sub>2</sub> O
6:44		50			25	2 Plug Mat Hole 10sks 60.40.21.10.90salt 5# Kol-seal
6:49		500			28	5.6 Mix Lead cmt 115sks 60.40.21.10.90salt 5# Kol-seal 3420
6:54		300			21	Mix Tail cmt 75sks A.S.C + 5# Kol-seal
6:58						5 Shut Down Wash up Pump + Lines Brox Plug
7:00		100			73	5.6 Start Displacement
7:15		200			52	4 Slow Rate Cmt Turn Shoe
7:28		1100				Land Plug Float Held
						RELEASED
						NOV 21 1994
						FROM CONFIDENTIAL
						RECEIVED STATE CORPORATION COMMISSION OCT 21 1993 CONSERVATION DIVISION

FINAL DISP. PRESS: 650 PSI BUMP PLUG TO 1100 PSI BLEEDBACK 4/1 BBLs. **THANK YOU**

PLAT AND CERTIFICATION OF ACREAGE ATTRIBUTABLE TO AN OIL WELL

State Corporation Commission, Conservation Division  
200 Colorado Derby Bldg. Wichita, Kansas 67202

OPERATOR Hummon Corporation  
LEASE NAME Swarner  
WELL NUMBER #2  
FIELD Alford Extension Mill Creek NE  
NUMBER OF ACRES ATTRIBUTED TO WELL 40

LOCATION OF WELL:  
680 feet north of SE corner  
4620 feet west of SE corner  
9 Sec. 31S T. 18W R.  
COUNTY Comanche

*Miss only*  
PLAT

(Show location of well and shade attributable acreage)  
(Show footage to nearest lease or unit boundary line)

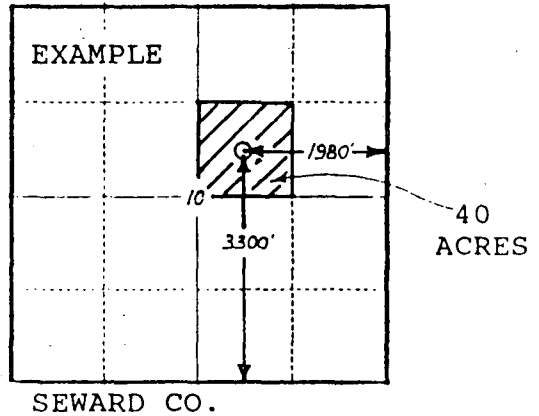
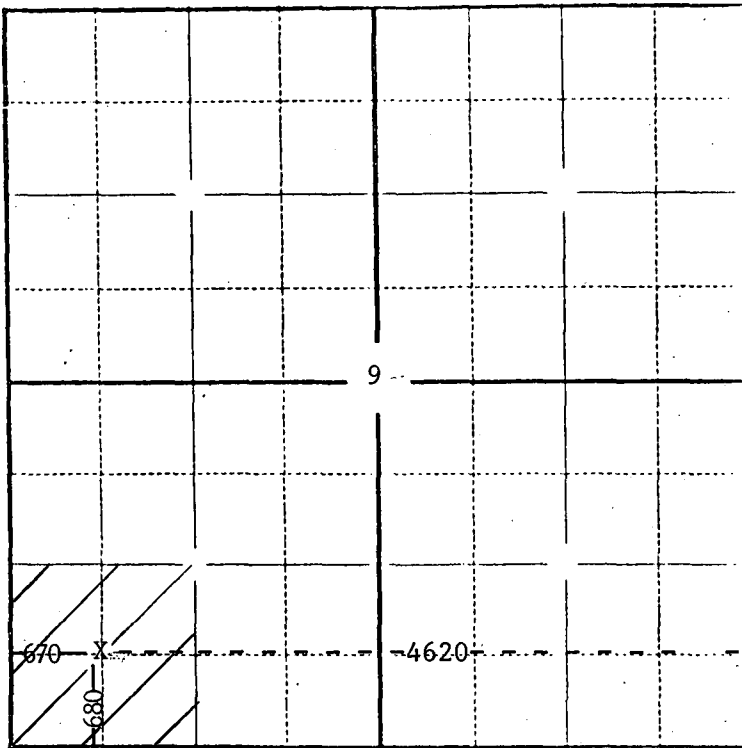

The undersigned hereby certifies that he is Byron E. Hummon, Jr., President for Hummon Corporation (Co.), a duly authorized agent, that all information shown hereon is true and correct to the best of his knowledge and belief, and that all acreage claimed as attributable to the well named herein is held by production from that well.

Subscribed and sworn to before me on this 16th day of August, 1993

*Joyce Cochran*  
Joyce Cochran, Notary Public

My Commission Expires 4-6-95

KANSAS CORPORATION COMMISSION

AUG 26 1993

CONSERVATION DIVISION  
WICHITA, KS

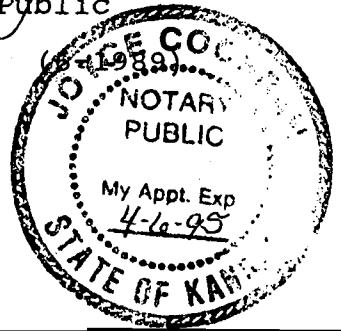

# ADVANTAGE ELEVATIONS

OIL FIELD SURVEYING

BOX 8714  
PRATT, KANSAS 67124  
(316) 672-7156  
(316) 672-6491

81093KP1  
INVOICE NO.

<u>HUMMON OIL CORP.</u>			<u>2</u>	<u>Swarner</u>
OPERATOR			NO.	FARM
<u>Comanche</u>	<u>9</u>	<u>31s</u>	<u>18w</u>	<u>C SW SW</u>
COUNTY	S	T	R	LOCATION
				ELEVATION: <u>2135gr.</u>



HUMMON OIL CORP.  
200 W. Douglas, Suite 1020  
Wichita, KS 67201

AUTHORIZED BY: Joyce

SCALE: 1" = 1000'

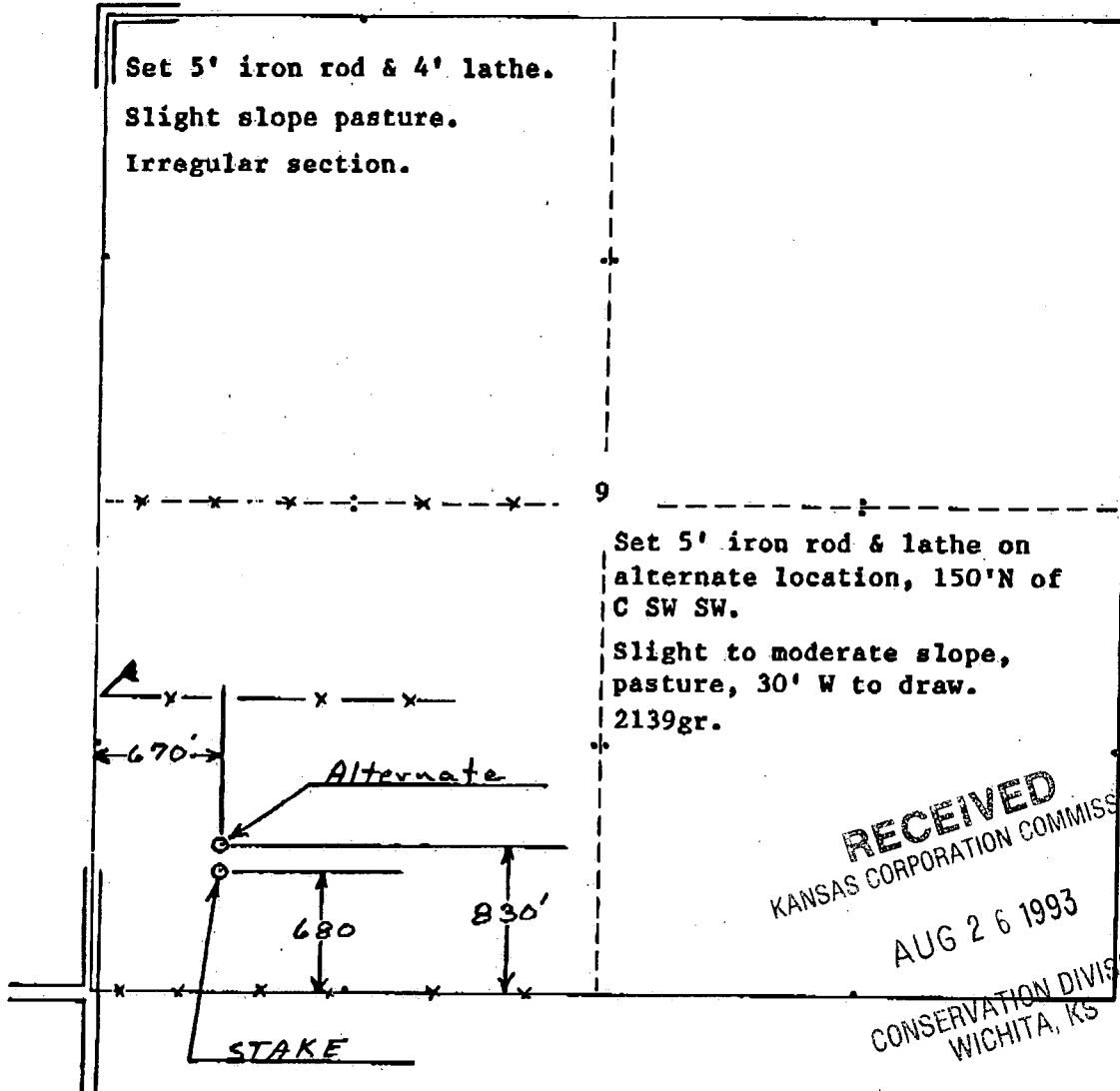

RECEIVED  
KANSAS CORPORATION COMMISSION

AUG 26 1993  
CONSERVATION DIVISION  
WICHITA, KS