

ORIGINAL

SIDE ONE

SEP 24 1990

STATE CORPORATION COMMISSION OF KANSAS
OIL & GAS CONSERVATION DIVISION
WELL COMPLETION OR RECOMPLETION FORM
ACO-1 WELL HISTORY
DESCRIPTION OF WELL AND LEASE

Operator: License # 09408
Name Trans Pacific Oil Corporation
Address 410 One Main Place
City/State/Zip Wichita, KS 67202

Purchaser Clear Creek, Inc.
McPherson, Ks.

Operator Contact Person Alan D. Banta
Phone (316) 262-3596

Contractor: License # 05841
Name Trans Pac Drilling, Inc.

Wellsite Geologist Alan D. Banta
Phone (316) 262-3596

Designate Type of Completion
 New Well Re-Entry Workover
 Oil SWD Temp Abd
 Gas Inj Delayed Comp
 Dry Other (Core, Water Supply etc.)

If OWWO: old well info as follows:
Operator
Well Name
Comp. Date Old Total Depth

WELL HISTORY

Drilling Method:
 Mud Rotary Air Rotary Cable
5/5/89 5/15/89 5/16/89
Spud Date Date Reached TD Completion Date
4810' 4775'
Total Depth PBTD

Amount of Surface Pipe Set and Cemented at 275' feet
Multiple Stage Cementing Collar Used? Yes No
If yes, show depth set feet
If alternate 2 completion, cement circulated from feet depth to w/ SX cmt
Cement Company Name
Invoice #

API NO. 15-007,22,240-0000
County Barber FROM CONFIDENTIAL
C NW NE Sec 5 30 Rge 13 East
..... West
4620 Ft North from Southeast Corner of Section
1980 Ft West from Southeast Corner of Section
(Note: Locate well in section plat below)
Lease Name Lambert "A" Well # 2
Field Name Jem
Producing Formation Arbuckle
Elevation: Ground 1938 1946 KB

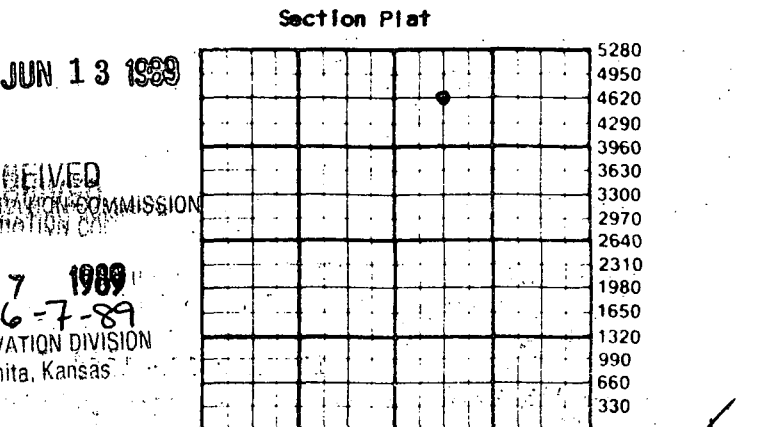

WATER SUPPLY INFORMATION
Disposition of Produced Water: Disposal
Docket # Repressuring

Questions on this portion of the ACO-1 call:
Water Resources Board (913) 296-3717
Source of Water:
Division of Water Resources Permit #
Groundwater Ft North from Southeast Corner (Well) Ft West from Southeast Corner of Sec Twp Rge East West
Surface Water Ft North from Southeast Corner (Stream, pond etc) Ft West from Southeast Corner Sec Twp Rge East West
Other (explain) (purchased from city, R.W.D. #)

INSTRUCTIONS: This form shall be completed in triplicate and filed with the Kansas Corporation Commission, 200 Colorado Derby Building, Wichita, Kansas 67202, within 120 days of the spud date of any well. Rule 82-3-130, 82-3-107 and 82-3-106 apply. Information on side two of this form will be held confidential for a period of 12 months if requested in writing and submitted with the form. See rule 82-3-107 for confidentiality in excess of 12 months. One copy of all wireline logs and drillers time log shall be attached with this form. Submit CP-4 form with all plugged wells. Submit CP-111 form with all temporarily abandoned wells.

All requirements of the statutes, rules and regulations promulgated to regulate the oil and gas industry have been fully complied with and the statements herein are complete and correct to the best of my knowledge.

Signature Alan D. Banta
Title Vice President Date 6/2/89

Subscribed and sworn to before me this 27th day of June 1989
Notary Public Sondra J. Follis
Date Commission Expires May 13, 1991

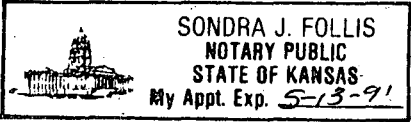

K.C.C. OFFICE USE ONLY
 Letter of Confidentiality Attached
 Wireline Log Received
 Driller's Timelog Received
Distribution
 KCC SWD/Rep NGPA
 KGS Plug Other (Specify)

ALT I
9-24-90

Sec 5 Twp 30 Rge 13

21

Operator Name Trans Pacific Oil Corporation Lease Name..... Well #.....

RELEASED

Sec. C Twp. NW Rge. NE East West County Barber

SEP 24 1989

WELL LOG

FROM CONFIDENTIAL

INSTRUCTIONS: Show important tops and base of formations penetrated. Detail all cores. Report all drill stem tests giving interval tested, time tool open and closed, flowing and shut-in pressures, whether shut-in pressure reached static level, hydrostatic pressures, bottom hole temperature, fluid recovery, and flow rates if gas to surface during test. Attach extra sheet if more space is needed. Attach copy of log.

Drill Stem Tests Taken Yes No
 Samples Sent to Geological Survey Yes No
 Cores Taken Yes No

Formation Description
 Log Sample

DST #1 4416-4475 (Marm) 45-60-45-60
 Stg blo with GTS in 45" GA 9'
 MCF Rec. 40' CGO 50' MCO
 ISIP 766# FSIP 766# IFP 22-33# FFP 44-55#
 DST #2 4537-4557 (Miss) 30-45-30-45
 Fr. blo dec to wk. Rec 15' M (SFO on Tool)
 ISIP 165# FSIP 198# IFP 18-18# FFP 22-22#
 DST #3 4606-4653 (Viola) 45-60-45-60
 GTS in 15" GA 23. MCF dec to 7.5 MCF @ end
 of flo. Rec. 20: OCM 124' HO & GCM 434:
 CGO ISIP 1202 FSIP 1115 IFP
 IFP 185-195# FFP 243-263#
 DST #4 4656-4680 (Simp) 45-45-45-45
 Stg blo dec to wk Rec. 885' GIP 45' SOCM
 (Good SFO in tool) ISIP 176# FSIP 176#
 IFP 22-22# FFP 22-22#

Name	Top	Bottom
Heeb	3821	(-1875)
Brown Limestone	4009	(-2063)
Lans	4027	(-2081)
BKC	4420	(-2474)
Miss	4522	(-2576)
Kind	4559	(-2613)
Viola	4596	(-2650)
Viola Chert	4616	(-2670)
Simp Shale	4650	(-2704)
Arb	4756	(-2810)
RTD	4810	(-2864)

CASING RECORD <input type="checkbox"/> New <input type="checkbox"/> Used							
Report all strings set-conductor, surface, intermediate, production, etc.							
Purpose of String	Size Hole Drilled	Size Casing Set (in O.D.)	Weight Lbs/Ft.	Setting Depth	Type of Cement	#Sacks Used	Type and Percent Additives
Surface		10 3/4"		275'	60/40	200	3 CC 2% GEL
Production		5 1/2"		4812'			
PERFORATION RECORD				Acid, Fracture, Shot, Cement Squeeze Record			
Shots Per Foot	Specify Footage of Each Interval Perforated			(Amount and Kind of Material Used)		Depth	
2 per. ft	4621-25			750 GA DSFE 15% Frac. 18,000 sand w 500 BBLS of water			
TUBING RECORD				Liner Run <input type="checkbox"/> Yes <input checked="" type="checkbox"/> No			
Date of First Production		Size	Set At	Packer at			
5/28/89		2 3/8"	149' jts				
Date of First Production		Producing Method					
5/28/89		<input type="checkbox"/> Flowing <input checked="" type="checkbox"/> Pumping <input type="checkbox"/> Gas Lift <input type="checkbox"/> Other (explain).....					
Estimated Production Per 24 Hours		Oil	Gas	Water	Gas-Oil Ratio	Gravity	
		50 Bbls	MCF	30 Bbls			

METHOD OF COMPLETION

Production Interval

Disposition of gas: Vented Open Hole Perforation
 Sold Other (Specify) 4621-25
 Used on Lease Dually Completed Commingled

TRANS PACIFIC OIL CORPORATION
410 One Main Place
Wichita, Kansas 67202

RELEASED

SEP 24 1990

DRILLERS LOG

FROM CONFIDENTIAL

#2 Lambert "A"
C NW NE
5-30S-13W
Barber, County Kansas

Spudded: 5/5/89
Completed : 5/15/89

0-783	Soil and Red Beds
783-1065	Shale
1065-2135	Shale
2135-2715	Shale & Lime
2715-3315	Shale
3315-3945	Shale & Lime
3945-4315	Shale & Lime
4315-4475	Shale & Lime
4475-4680	Shale & Lime
4680-4814	Shale & Lime
4814-TD.	

RECEIVED
STATE CORPORATION COMMISSION

MAY 7 1989
6-7-89
CONSERVATION DIVISION
Wichita, Kansas

Surface Pipe: Ran 7 jts of 10 3/4" set @ 275' Cemented w 200
sxs 60/40 posmix

Production Casing: Ran 114 jts of used 5 1/2" 14# set @ 4808 w
125 sxs 60/40 posmix

AFFIDAVIT KANSAS GEOLOGICAL SURVEY
WICHITA BRANCH

STATE OF KANSAS
COUNTY OF SEDGWICK

Alan D. Banta of lawful age does swear and state that the facts
and statements herein are true and correct to the best of his
knowledge.

Alan D. Banta
Alan D. Banta

Subscribed and sworn to before me this 2nd day of June 1989

My Commission Expires: 5/13/1991 Sandra J. Follis
Sandra J. Follis, Notary Public

