

ORIGINAL

5/24/90

SIDE ONE

RELEASED

STATE CORPORATION COMMISSION OF KANSAS
OIL & GAS CONSERVATION DIVISION
WELL COMPLETION OR RECOMPLETION FORM
ACO-1 WELL HISTORY
DESCRIPTION OF WELL AND LEASE

Operator: License # 09408
Name Trans Pacific Oil Corporation
Address 410 One Main Place
City/State/Zip Wichita, KS 67220

Purchaser Clear Creek

Operator Contact Person Alan D. Banta
Phone (316) 262-3596

Contractor: License # 05841
Name Trans. Pac. Drilling Inc.

Wellsite Geologist Ernie Morrison
Phone (316) 262-3596

Designate Type of Completion
New Well Re-Entry Workover
 Oil SWD Temp Abd
 Gas Inj Delayed Comp
 Dry Other (Core, Water Supply etc.)

If OWO: old well info as follows:
Operator
Well Name
Comp. Date Old Total Depth

WELL HISTORY

Drilling Method: Mud Rotary Air Rotary Cable

Spud Date 3/13/89 Date Reached TD 3/24/89 Completion Date 3/24/89

Total Depth 4,800' PBD 4775'

Amount of Surface Pipe Set and Cemented at 310' feet
Multiple Stage Cementing Collar Used? Yes No
If yes, show depth set
If alternate 2 completion, cement circulated from
Cement Company Name
Invoice #

API No. 15-007-22,230-0000 SEP 2 5 1990

County Barber FROM CONFIDENTIAL

W 1/2 NE NE Sec 5 Twp 30 Rge 13 West
4620 Ft North from Southeast Corner of Section
990 Ft West from Southeast Corner of Section
(Note: Locate well in section plat below)

Lease Name Lambert "B" Well # 1

Field Name Jem Southwest

Producing Formation Arbuckle

Elevation: Ground 1925 KB 1933

Section Plat

KANSAS GEOLOGICAL SURVEY
WICHITA BRANCH
RECEIVED
STATE CORPORATION COMMISSION
Wichita, Kansas
4 1989
5-24-89

MAY 23 1989

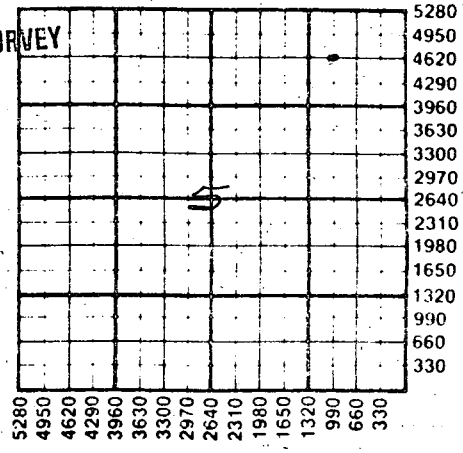

WATER SUPPLY INFORMATION

Disposition of Produced Water: Disposal
Docket # Repressuring

Questions on this portion of the ACO-1 call:

Water Resources Board (913) 296-3717

Source of Water:
Division of Water Resources Permit #

Groundwater Ft North from Southeast Corner (Well) Ft West from Southeast Corner of Sec Twp Rge East West

Surface Water Ft North from Southeast Corner (Stream, pond etc) Ft West from Southeast Corner Sec Twp Rge East West

Other (explain) (purchased from city, R.W.D. #)

INSTRUCTIONS: This form shall be completed in triplicate and filed with the Kansas Corporation Commission, 200 Colorado Derby Building, Wichita, Kansas 67202, within 120 days of the spud date of any well. Rule 82-3-130, 82-3-107 and 82-3-106 apply. Information on side two of this form will be held confidential for a period of 12 months if requested in writing and submitted with the form. See rule 82-3-107 for confidentiality in excess of 12 months. One copy of all wireline logs and drillers time log shall be attached with this form. Submit CP-4 form with all plugged wells. Submit CP-111 form with all temporarily abandoned wells.

All requirements of the statutes, rules and regulations promulgated to regulate the oil and gas industry have been fully complied with and the statements herein are complete and correct to the best of my knowledge.

Signature Alan D. Banta
Title Vice President Date 4-27-89

Subscribed and sworn to before me this 27th day of April 1989
Notary Public Sondra J. Follis
Date Commission Expires 5-13-91

SONDRA J. FOLLIS
NOTARY PUBLIC
STATE OF KANSAS
My Appt. Exp. 5-13-91

K.C.C. OFFICE USE ONLY
 Letter of Confidentiality Attached
 Wireline Log Received
 Drillers Timelog Received
Distribution
 KCC SWD/Rep NGPA
 KGS Plug Other (Specify)

Sec. 5 Twp 30 Rge 13 W

Trans Pacific Oil Corporation

Lambert "B"

Operator Name Lease Name..... Well #.....

Sec. 5 Twp. 30 Rge. 13 East West County Barber RELEASED

SEP 2 5 1990

WELL LOG

INSTRUCTIONS: Show important tops and base of formations penetrated. Detail all cores. Report all drill stem tests giving interval tested, time tool open and closed, flowing and shut-in pressures, whether shut-in pressure reached static level, hydrostatic pressures, bottom hole temperature, fluid recovery, and flow rates if gas to surface during test. Attach extra sheet if more space is needed. Attach copy of log.

FROM CONFIDENTIAL

Drill Stem Tests Taken [X] Yes [] No
Samples Sent to Geological Survey [X] Yes [] No
Cores Taken [] Yes [X] No

Formation Description [] Log [X] Sample

DST #1 4378-4433 (Marm.) 45-60-45-60
1st GTS in 25" GA 57 MCF and stab.
2nd 31 MCF dec. 6.5 MCF Rec. 984' CGO 34 Grav.
62' MCO (50% O) 62' HOCM (50% O) 61' OCM (20% O)
ISIP 723# FSIP 706# IFP 121-198# FFP 220-341#
DST #2 4450-4540 (Miss) 45-60-45-60
Stg Blo Rec. 60' M (spks of O)
ISIP 810# FSIP 454# IFP 30-48# FFP 20-20#
DST #3 4602-4649 (Viola) 45-60-45-60
1st open GTS in 15" 55 MCF & Stab. 2nd open
58 MCF decr. to 34.7 MCF Rec. 300' FO 240
SMCGO (80% O) ISIP 1552# FSIP 1552# IFP 62-80#
FFP 158-180#
DST #4 4640-4670 (Smip) 45-60-45-60
1st open GTS 25" 31 MCF 2nd open 22.8 MCF
160' HO & GCM (30% O) 120' SOCGW (5% O 75% W)
250' GW ISIP 681# FSIP 665# FP 92-160#
FFP 197-238#

Table with 3 columns: Name, Top, Bottom. Rows include Anhy, HB, Brn Lm, Lans, Stark Sh., BKC, Miss, Kh Sh, Viola, Viola Ch, Simp. Sd, Arb, RTD.

CASING RECORD, PERFORATION RECORD, TUBING RECORD, Date of First Production, Producing Method, Estimated Production Per 24 Hours

METHOD OF COMPLETION

Production Interval

Disposition of gas: [] Vented [] Sold [] Used on Lease [] Open Hole [X] Perforation [] Other (Specify) [] Dually Completed [] Commingled