

ORIGINAL

10/30/89  
RELEASED

SIDE ONE

JAN 18 1991

STATE CORPORATION COMMISSION OF KANSAS  
OIL & GAS CONSERVATION DIVISION  
WELL COMPLETION FORM  
ACO-1 WELL HISTORY  
DESCRIPTION OF WELL AND LEASE

API NO. 15- 007-01,026-00-01  
County Barber FROM CONFIDENTIAL  
C NE SE Sec. 5 Twp. 30 Rge. 13 East XX West

Operator: License # 09408

1980 Ft. North from Southeast Corner of Section

Name: Trans Pacific Oil Corporation

660 Ft. West from Southeast Corner of Section

Address 410 One Main Place

(NOTE: Locate well in section plat below.)

Wichita, Ks. 67202

Lease Name Lambert "C" Well # 2

City/State/Zip

Field Name Jem Southwest

Purchaser: Clear Creek, Inc.

Producing Formation Viola

Operator Contact Person: Alan D. Banta

Elevation: Ground KB

Phone (316) 262-3596

Total Depth 4800' PBDT 4798'

Contractor: Name: Trans Pac Drilling, Inc.

License: 05841

Wellsite Geologist:

Designate Type of Completion  
New Well Re-Entry  Workover  
 Oil SWD Temp. Abd.  
 Gas Inj Delayed Comp.  
 Dry Other (Core, Water Supply)

If ~~CHANG~~ old well info as follows:

Operator: Graybol Oil Corporation

Well Name: Lambert #1

Comp. Date 9/4/63 Old Total Depth 4800

Drilling Method:  
 Mud Rotary  Air Rotary  Cable

7/25/89 7/27/89 8/3/89

Spud Date Date Reached TD Completion Date

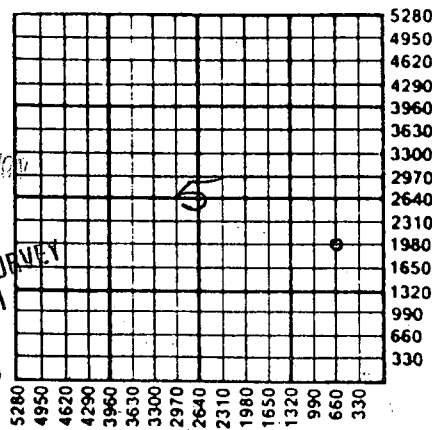

ALT I  
1-18-91

Amount of Surface Pipe Set and Cemented at 461' Feet

Multiple Stage Cementing Collar Used? Yes  No

If yes, show depth set Feet

If Alternate II completion, cement circulated from

feet depth to w/ sx cmt.

INSTRUCTIONS: This form shall be completed in triplicate and filed with the Kansas Corporation Commission, 200 Colorado Derby Building, Wichita, Kansas 67202, within 120 days of the spud date of any well. Rule 82-3-130, 82-3-107 and 82-3-106 apply. Information on side two of this form will be held confidential for a period of 12 months if requested in writing and submitted with the form. See rule 82-3-107 for confidentiality in excess of 12 months. One copy of all wireline logs and drillers time log shall be attached with this form. ALL CEMENTING TICKETS MUST BE ATTACHED. Submit CP-4 form with all plugged wells. Submit CP-111 form with all temporarily abandoned wells. Any recompletion, workover or conversion of a well requires filing of ACO-2 within 120 days from commencement date of such work.

All requirements of the statutes, rules and regulations promulgated to regulate the oil and gas industry have been fully complied with and the statements herein are complete and correct to the best of my knowledge.

Signature Alan D. Banta

Title Vice President Date 10/3/89

Subscribed and sworn to before me this 3rd day of October 19 89.

Notary Public Sondra J. Follis

Date Commission Expires May 13, 1991

K.C.C. OFFICE USE ONLY  
 Letter of Confidentiality Attached  
 Wireline Log Received  
 Drillers Timelog Received  
Distribution  
 KCC  SWD/Rep  NGPA  
 KGS  Plug  Other  
(Specify)

SONDRA J. FOLLIS  
NOTARY PUBLIC  
STATE OF KANSAS  
My Appt. Exp. 5-13-91

**SIDE TWO**

Operator Name Trans Pacific Oil Corporation Lease Name Lambert "C" Well # 2  
 Sec. 5 Twp. 30 Rge. 13  East  West  
 County Barber

**INSTRUCTIONS:** Show important tops and base of formations penetrated. Detail all cores. Report all drill stem tests giving interval tested, time tool open and closed, flowing and shut-in pressures, whether shut-in pressure reached static level, hydrostatic pressures, bottom hole temperature, fluid recovery, and flow rates if gas to surface during test. Attach extra sheet if more space is needed. Attach copy of log.

**RELEASED**

Drill Stem Tests Taken  Yes  No  
 (Attach Additional Sheets.)  
 Samples Sent to Geological Survey  Yes  No  
 Cores Taken  Yes  No  
 Electric Log Run  Yes  No  
 (Submit Copy.)

**Formation Description**  
 JAN 18 1991  
 Log  Sample  
 Name \_\_\_\_\_ Top \_\_\_\_\_ Bottom \_\_\_\_\_  
 Per Attached \_\_\_\_\_

**FROM CONFIDENTIAL**

**CASING RECORD**  New  Used  
 Report all strings set-conductor, surface, intermediate, production, etc.

Purpose of String	Size Hole Drilled	Size Casing Set (In O.D.)	Weight Lbs./Ft.	Setting Depth	Type of Cement	# Sacks Used	Type and Percent Additives
Surface		8"		461'		275	
Production		5 1/2"		4808.6	60/40		

PERFORATION RECORD		Acid, Fracture, Shot, Cement Squeeze Record	
Shots Per Foot	Specify Footage of Each Interval Perforated	(Amount and Kind of Material Used)	Depth
2 shots per'	4399-4403	Acid 28% NE 1000 ga	
	4560-65'	Acid 1500 ga 28% DSFB	

**TUBING RECORD** Size 2 3/8" Set At 146 jts Packer At \_\_\_\_\_ Liner Run  Yes  No

Date of First Production 8/7/89 Producing Method  Flowing  Pumping  Gas Lift  Other (Explain) \_\_\_\_\_

Estimated Production Per 24 Hours	Oil Bbls.	Gas Mcf	Water Bbls.	Gas-Oil Ratio	Gravity
	35	NA	NA	NA	NA

Disposition of Gas:  Vented  Sold  Used on Lease (If vented, submit ACO-18.)  
**METHOD OF COMPLETION**  Open Hole  Perforation  Dually Completed  Commingled  
 Other (Specify) \_\_\_\_\_ Production Interval 4560-65

ORIGINAL

RELEASED

JAN 18 1991

FROM CONFIDENTIAL

OLD INFORMATION

HEEB	3794	-1872
DOUG SD	3845	-1923
LANS	3992	-2070
B KC	4380	-2458
MISS	4474	-2552
KIND	4500	-2578
VIO	4540	-2618
SIMP SH	4646	-2724
SIMP SD	4654	-2732
ARB	4739	-2817
LTD	4797	-2875
RTD	4800	-2878

RECEIVED  
STATE CONSERVATION COMMISSION

OCT 30 1989  
10-30-89  
CONSERVATION DIVISION  
Wichita, Kansas