

Fax Transmittal Memo 7672

To: **Janice K.C.C.**  
Company: **K.C.C.**  
Location:

No. of Pages: **2**  
Today's Date: **2-13-96**  
From: **Rhonda H**  
Company: **RGS**  
Location:

Fax # **337-6205** Telephone #

Fax # **265-1013** Telephone # **265-8676**

Comments

Original Disposition:  Destroy  Return  Call for pickup

**KANSAS DRILLERS LOG**

API No. 15 — 033 — 20,174-0003  
County Number

S. 10 T. 31 R. 18 W  
Loc. (- NE NW)  
County Comanche

Operator: **Anadarko Production Co.** **KANSAS GEOLOGICAL SOCIETY**  
Address: **Box 351 Liberal, Kansas** **Wichita, Kansas**  
Well No. **#4** Lease Name **Meyers "A"**  
Footage Location: **660** feet from (N) **230** line **1980** feet from (W) line  
Principal Contractor: **Gabbart-Jones, Inc.** Geologist:  
Spud Date: **5-12-75** Total Depth: **5085'** P.D.T.O.:  
Date Completed: **6-17-75** Oil Purchaser:

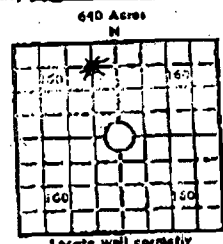

Elev. Gr. **2094'**  
DF      KB     

**CASING RECORD**

Report of all strings set — surface, intermediate, production, etc.

Purpose of string	Size hole drilled	Size casing set (in O.D.)	Weight lbs/ft.	Setting depth	Type cement	Socks	Type and percent additives
Surface	12-1/4"	8-5/8"	24#	460'	Common	500	3% CC
Production	7-7/8"	4-1/2"	10.5#	5083'	Pozmix	140	0.5% CFR-2

**LINER RECORD**

**PERFORATION RECORD**

Top, ft.	Bottom, ft.	Socks cement	Shots per ft.	Size & type	Depth interval
			4 SPF		4994'-5003'

**TUBING RECORD**

Size	Setting depth	Packer set at
2-3/8"	4997'	

**ACID, FRACTURE, SHOT, CEMENT SQUEEZE RECORD**

Amount and kind of material used	Depth interval treated
Acidized w/1000 gallons 28%	4994'-5003'

**INITIAL PRODUCTION**

Date of first production: **6-12-75** Producing method (flowing, pumping, gas lift, etc.): **Pumping**

RATE OF PRODUCTION PER 24 HOURS	Oil	Gas	Water	Gas-oil ratio
	<b>43.5</b> bbls.		<b>6.5</b> bbls.	<b>2205</b> CPB

Disposition of gas (vented, used on lease or sold): **Mississippian 4994'-5003'**  
**Will be sold**

INSTRUCTIONS: As provided in MCC Rule 82-2-125, within 90 days after completion of a well, one completed copy of this Driller Log shall be transmitted to the State Geological Survey of Kansas, 4150 Monroe Street, Wichita, Kansas 67209. Copies of this form are available from the Conservation Division, State Corporation Commission, 3830 So. Main Street (P.O. Box 17027), Wichita, Kansas 67217. Phone AC 316-522-2206. If confidential custody is desired, please note Rule 82-2-125. Driller Logs will be on open file in the Oil and Gas Division, State Geological Survey of Kansas, Lawrence, Kansas 66044.

15-033-20174-0000

Operator <b>Anadarko Production Company</b>		DESIGNATE TYPE OF COMP.: OIL, GAS, DRY HOLE, SWDOW, ETC.:	
Well No. #4	Lease Name Myers "A"	Oil	
S 10 T 31S R 18 W			
<b>WELL LOG</b>		SHOW GEOLOGICAL MARKERS, LOGS RUN, OR OTHER DESCRIPTIVE INFORMATION.	
Show all important zones of porosity and contents thereof; cored intervals, and all drill-stem tests, including depth interval tested, cushion used, time tool open, flowing and shut-in pressures, and recoveries.			
FORMATION DESCRIPTION, CONTENTS, ETC.	TOP	BOTTOM	NAME
DEPTH			
Soil-Sand-Shells	0	220	
Sand-Shells-Shale	220	740	
Redbed-Shale	740	1192	
Shale	1192	2070	
Shale-Shells	2070	2300	
Lime-Shale	2300	2390	
Shale-Lime	2390	2720	
Lime	2720	5085	
Total Depth		5085	
			LOG TOPS:      DEPTH:
			Anh              1024
			Heeb            4155
			Br Lm           4328
			Lans            4342
			Marm           4816
			Cher            4907
			Miss (sp-war) 4961
			Rtd             5085
			Ltd             5088
USE ADDITIONAL SHEETS, IF NECESSARY, TO COMPLETE WELL RECORD.			
Date Received	<i>T. W. Williams</i> T. W. Williams      Signature Division Office Supervisor Title June 23, 1975 Date		