

STATE OF KANSAS  
STATE CORPORATION COMMISSION  
200 Colorado Derby Building  
Wichita, Kansas 67202

WELL PLUGGING RECORD  
K.A.R.-82-3-117

20415-0000  
API NUMBER 15-007-2045

LEASE NAME Loren Rolf

WELL NUMBER C-1

3300 Ft. from S Section Line

1320 Ft. from E Section Line

SEC. 3 TWP. 30S RGE. 11 (E) or (W)

COUNTY Barber

Date Well Completed 10-29-76

Plugging Commenced 5-29-90

Plugging Completed 6-6-90

TYPE OR PRINT  
NOTICE: Fill out completely  
and return to Cons. Div.  
office within 30 days.

LEASE OPERATOR Rupe Oil Co.

ADDRESS Box 438 Ohio Wichita, Ks 67201

PHONE# (316) 262-3748 OPERATORS LICENSE NO. 5047

Character of Well Gas - SWD

(Oil, Gas, D&A, SWD, Input, Water Supply Well)

Did you notify the KCC District Office prior to plugging this well? yes

Which KCC Office did you notify? Dodge City

Is ACO-1 filed? \_\_\_\_\_ If not, is well log attached? N/A

Producing Formation \_\_\_\_\_ Depth to Top \_\_\_\_\_ Bottom \_\_\_\_\_ T.D. 3750

Show depth and thickness of all water, oil and gas formations.

OIL, GAS OR WATER RECORDS

CASING RECORD

Formation	Content	From	To	Size	Put In	Pulled out
				8 5/8	270	None
				5 1/2	3750	1800

Describe in detail the manner in which the well was plugged, indicating where the mud fluid was placed and the method or methods used in introducing it into the hole. If cement or other plugs were used, state the character of same and depth placed, from \_\_\_\_\_ feet to \_\_\_\_\_ feet each set.  
BJ pumped bottom, 100 sx cement and 3 sx hulls, stopped plug at 2500', BJ pumped top, 3 sx hulls, 10 sx gel, 50 sx cement, 10 sx gel, 1 sx hull, 100 sx cement, 60-40 POZ, 6% gel, Phiffer and Elmo on location

(If additional description is necessary, use BACK of this form.)

Name of Plugging Contractor Clarke Corporation License No. 5105

Address Box 187 Medicine Lodge, Ks 67104

STATE OF Kansas COUNTY OF Barber, ss.

Elmo Morgenstern (Employee of Operator) or (Operator) of above-described well, being first duly sworn on oath, says: That I have knowledge of the facts, statements, and matters herein contained and the log of the above-described well as filed that the same are true and correct, so help me God.

(Signature) Elmo Morgenstern

(Address) Medicine Lodge, Ks

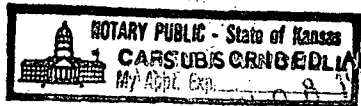

SWORN TO before me this 21st day of June, 19 90  
Gregory W. Winkler  
Notary Public  
June 21, 1991

My Commission Expires: \_\_\_\_\_  
Wichita, Kansas

760

KANSAS DRILLERS LOG

API No. 15 - 007 - 20,415 - 0000  
County Number

S. 3 T. 30S R. 11W  
Loc. C S/2 NE/4  
County Barber

Operator  
Rupe Oil Company, Inc.

Address  
P. O. Box 2273 - 434 Ohio, Wichita, Kansas 67201

Well No. 1  
Lore Name Loren Rolf "C"

Footage Location  
1980 feet from (N) (S) line 1320 feet from (E) (W) line

Principal Contractor H-30 Drilling, Inc.  
Geologist William G. Clement

Spud Date May 7, 1976  
Total Depth 3758' P.B.T.D. 3731'

Date Completed October 29, 1976  
Gas Purchaser Central States Gas Company

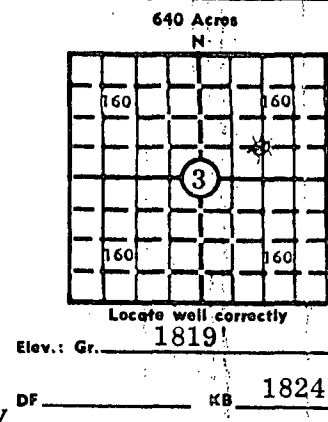

CASING RECORD

Report of all strings set — surface, intermediate, production, etc.

Purpose of string	Size hole drilled	Size casing set (in O.D.)	Weight lbs/ft.	Setting depth	Type cement	Sacks	Type and percent additives
Surface Casing	12 1/4"	8 5/8"	24#	270	Class "A"	275	2% Gel, 3% CC
Production String	7 7/8"	5 1/2"	14# & 15.5#	3756'	50-50 Pozmix	240	10% Salt

LINER RECORD

PERFORATION RECORD

Top, ft.	Bottom, ft.	Sacks cement	Shots per ft.	Size & type	Depth Interval
			4	GJ	3716-26'
			2	DP	2711-21'

TUBING RECORD

2 Strings	Size 2 1/16"	Setting depth 2772'	Packer set at 3035'
	2 1/16"	3634	

ACID, FRACTURE, SHOT, CEMENT SQUEEZE RECORD

Amount and kind of material used	Depth interval treated
1500 gals. 7 1/2% Mud Clean Up Acid	3716-21'
500 Gals. 7 1/2% MCA + 1000 gals. Reg. HF Acid + 250 gals. 7 1/2% MCA	2711'-21'
10,000 gals. KCL Water, 10,000# 20-40 Sand & 143,000 SCF N <sub>2</sub>	

INITIAL PRODUCTION

Date of first production	Producing method (flowing, pumping, gas lift, etc.) Flowing
RATE OF PRODUCTION PER 24 HOURS STATE Oil 6-8-90 10 1990	Gas 2310 bbls. MCF Water trace bbls. Gas-oil ratio CFPB
Disposition of gas (vented, used on lease or sold) Waiting on Pipeline	Producing interval (s) Gas 2711-21' Disposal 3716-21'

INSTRUCTIONS: As provided in KCC Rule 82-2-125, within 90 days after completion of a well, one completed copy of this Drillers Log shall be transmitted to the State Geological Survey of Kansas, 4150 Monroe Street, Wichita, Kansas 67209. Copies of this form are available from the Conservation Division, State Corporation Commission, 3830 So. Marildon (P.O. Box 17027), Wichita, Kansas 66217. Phone AC 316-522-2206. If confidential control is desired, please note Rule 82-2-125. Drillers Logs will be on an open file in the Oil and Gas Division, State Geological Survey of Kansas, Lawrence, Kansas 66044.

760

Handwritten signatures and dates: "Must be signed by..." "A. Annual..." "11/11/76"

Operator  
 Rupe Oil Company, Inc. DESIGNATE TYPE OF COMP.: OIL, GAS,  
 DRY HOLE, SWDW, ETC.:  
 Gas

Well No. #1 Lease Name Loren Rolf "C"

S 3 T 30S R 11W W

**WELL LOG**

Show all important zones of porosity and contents thereof; cored intervals, and all drill-stem tests, including depth interval tested, cushion used, time tool open, flowing and shut-in pressures, and recoveries. SHOW GEOLOGICAL MARKERS, LOGS RUN, OR OTHER DESCRIPTIVE INFORMATION.

FORMATION DESCRIPTION, CONTENTS, ETC.	TOP	BOTTOM	NAME	DEPTH
DST #1 30-45-95-60. Gas to surface in 3 min. Rec. 70' GCMud Stablized at 497 MCF ISIP 1044# IFP 117# & 135# FFP 144# & 126# FSIP 998#	2698'	2750'	Indian Cave	2699'
DST #2 30-45-20-45. Recovered 10' Drilling Mud ISIP 1044# IFP 54# & 54# FFP 54# & 54# FSIP 1044#	2894'	2920'	Tarkio	2894
DST #3 30-45-45-45 Had 1150' gas in pipe, 400' GCMud, 200' GCM Water. ISIP 1279# IFP 68# & 153# FFP 153# & 252# FSIP 1216#	3694'	3758'	Douglas Sand	3713'

USE ADDITIONAL SHEETS, IF NECESSARY, TO COMPLETE WELL RECORD.

Date Received	<p><i>William G. Clement</i>          William G. Clement <small>Signature</small></p> <hr/> <p>Geologist <span style="float: right;"><small>Title</small></span></p> <p>November 2, 1976</p> <hr/> <p style="text-align: right;"><small>Date</small></p>
---------------	--