

STATE OF KANSAS
STATE CORPORATION COMMISSION

Form CP-4

Give All Information Completely
Make Required Affidavit
Mail or Deliver Report to:
Conservation Division
State Corporation Commission
212 No. Market
Wichita, Kansas 67202

WELL PLUGGING RECORD

COMANCHE County. Sec. 27 Twp. 31S Rge. 18 (W) (W)
Location as "NE/CNW/SW" or footage from lines APP. C NE NE
Lease Owner PETROLEUM, INC.,
Lease Name BOISSEAU 'D' Well No. 1 (TWIN)
Office Address ROUTE 2, GREAT BEND, KANSAS
Character of Well (completed as Oil, Gas or Dry Hole) DRY HOLE
Date well completed JUNE 7 19 70
Application for plugging filed JUNE 7 19 70
Application for plugging approved JUNE 7 19 70
Plugging commenced JUNE 7 19 70
Plugging completed JUNE 7 19 70
Reason for abandonment of well or producing formation NO PRODUCING ZONE

If a producing well is abandoned, date of last production NONE 19
Was permission obtained from the Conservation Division or its agents before plugging was commenced? YES

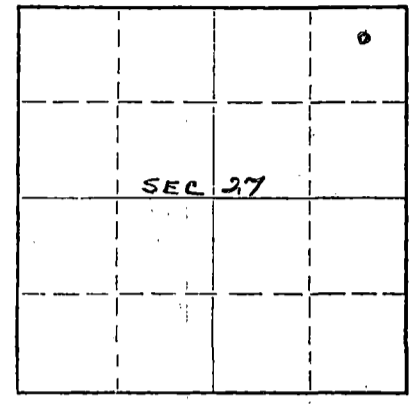

Locate well correctly on above Section Plat

Name of Conservation Agent who supervised plugging of this well G. R. BIBERSTEIN
Producing formation _____ Depth to top _____ Bottom _____ Total Depth of Well 5160 Feet
Show depth and thickness of all water, oil and gas formations.

OIL, GAS OR WATER RECORDS

CASING RECORD

FORMATION	CONTENT	FROM	TO	SIZE	PUT IN	PULLED OUT
				8-5/8	565'	NONE

Describe in detail the manner in which the well was plugged, indicating where the mud fluid was placed and the method or methods used in introducing it into the hole. If cement or other plugs were used, state the character of same and depth placed, from _____ feet to _____ feet for each plug set.

HEAVY MUD TO 550', FOLLOWED BY WOODEN PLUG, PLACED 1/2 SACK HULLS, 25 SACKS CEMENT ON TOP OF PLUG. HEAVY MUD TO 40', FOLLOWED BY WOODEN PLUG, PLACED 1/2 SACK HULLS, 10 SACKS CEMENT ON TOP OF PLUG TO BASE OF WELL CELLAR.

RECEIVED
STATE CORPORATION COMMISSION
6-24-70
JUN 24 1970
CONSERVATION DIVISION
Wichita, Kansas

(If additional description is necessary, use BACK of this sheet)
Name of Plugging Contractor GABBERT-JONES, INC.,
Address 830 SUTTON PLACE, WICHITA, KANSAS

STATE OF KANSAS, COUNTY OF BARTON, ss.
MONTE CHADD (employee of owner) or (owner or operator) of the above-described well, being first duly sworn on oath, says: That I have knowledge of the facts, statements, and matters herein contained and the log of the above-described well is filled out that the same are true and correct. So help me God. MONTE CHADD, DIST. PROD. SUPT.

(Signature) *Monte Chadd*
R.R. #2, GREAT BEND, KANSAS
(Address)

Subscribed and sworn to before me this 23 day of JUNE, 1970

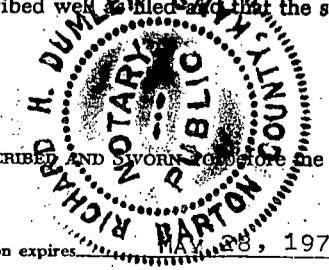

Richard H. Dumlaker
Notary Public.

My commission expires MAY 28, 1973

