

STATE OF KANSAS  
STATE CORPORATION COMMISSION

WELL PLUGGING RECORD

Give All Information Completely  
Make Required Affidavit  
Mail or Deliver Report to  
Conservation Division  
State Corporation Comm.  
245 North Water  
Wichita, KS 67202

Comanche County, Sec. 10 Twp. 32 S Rge. 17W E/W  
Location as "NE/CNW $\frac{1}{4}$ /SW $\frac{1}{4}$ " or footage from lines

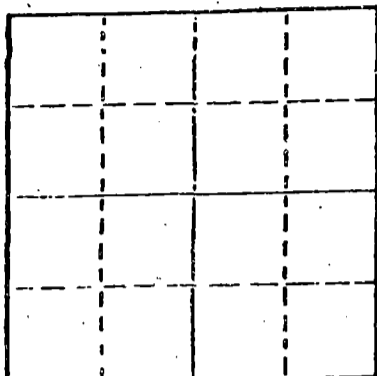

Locate well correctly on above  
Section Plat

C NE NE  
Lease Owner Woolsey Petroleum Corporation  
Lease Name McCay Well No. 2  
Office Address 300 West Douglas, Suite 400, Wichita, Ks 6720  
Character of Well (Completed as Oil, Gas or Dry Hole)  
Dry

Date Well completed 10-13 1980  
Application for plugging filed 10-13 1980  
Application for plugging approved 10-12 1980  
Plugging commenced 10-13 1980  
Plugging completed 10-13 1980  
Reason for abandonment of well or producing formation  
Dry

If a producing well is abandoned, date of last production  
19

Was permission obtained from the Conservation Division or  
its agents before plugging was commenced? Yes

Name of Conservation Agent who supervised plugging of this well Duane Rankin  
Producing formation \_\_\_\_\_ Depth to top \_\_\_\_\_ Bottom \_\_\_\_\_ Total Depth of Well 5270  
Show depth and thickness of all water, oil and gas formations.

OIL, GAS OR WATER RECORDS

CASING RECORD

FORMATION	CONTENT	FROM	TO	SIZE	PUT IN	PULLED OUT
		0	346	10 3/4		

Describe in detail the manner in which the well was plugged, indicating where the mud fluid  
was placed and the method or methods used in introducing it into the hold. If cement or other  
plugs were used, state the character of same and depth placed, from \_\_\_\_\_ feet to  
\_\_\_\_\_ feet for each plug set.

Plugged: 40 sacks @ 480  
40 sacks @ 330  
15 sacks @ 40  
5 sacks in rathole; 5 sacks in mousehole  
Completed @ 6:30 PM 10-13-80

(If additional description is necessary, use BACK of this sheet)

Name of Plugging Contractor DaMac Drilling Inc.  
Box 1164, Great Bend, Ks. 67530

STATE OF Kansas COUNTY OF Barton ss.  
Martha J. McKown (employee of owner) or (owner or operator) of the above-described  
well, being first duly sworn on oath, says: That I have knowledge of the facts, statements, and matters herein contained and the log of the  
above-described well as filed and that the same are true and correct. So help me God.

(Signature) Martha J. McKown  
Box 1164, Great Bend, Kansas 67530  
(Address)

Subscribed and sworn to before me this 13th day of October, 1980

Vada I. Sullivan  
Notary Public.

My commission expires \_\_\_\_\_

RECEIVED  
STATE CORPORATION COMMISSION

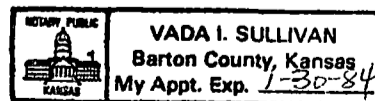

NOV 13 1980  
11-13-80  
CONSERVATION DIVISION  
Wichita, Kansas

IMPORTANT

Kans. Geo. Survey request samples on this well.

KANSAS

WELL COMPLETION REPORT AND DRILLER'S LOG

API No. 15 - 033 - 20376-0000
County Number

S. 10 T. 32S R. 17 W
Loc. 40'S, 135'E of C NE NE

County Comanche

Operator: WOOLSEY PETROLEUM CORPORATION
Address: 300 W. Douglas, Suite 400, Wichita, Kansas 67202
Well No. 2 Lease Name McCay
Footage Location
Principal Contractor DaMac Drilling, Inc. Geologist David Kirk
Spud Date Date Completed Total Depth 5350' P.B.T.D.
Directional Deviation Oil and/or Gas Purchaser

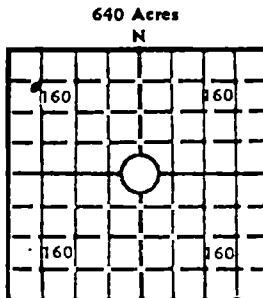

Locate well correctly
Elev.: Gr. 2104'
DF KB 2115'

CASING RECORD

Report of all strings set — surface, intermediate, production, etc.

Table with 8 columns: Purpose of string, Size hole drilled, Size casing set (in O.D.), Weight lbs/ft., Setting depth, Type cement, Sacks, Type and percent additives. Row 1: Surface, 15", 10-3/4", 32.75#, 346', Class A, 325, Class A 3% cc 2% Gel.

LINER RECORD

PERFORATION RECORD

Tables for Liner Record (Top, Bottom, Sacks cement) and Tubing Record (Size, Setting depth, Packer set at).

ACID, FRACTURE, SHOT, CEMENT SQUEEZE RECORD

Table with 2 columns: Amount and kind of material used, Depth interval treated.

RECEIVED STATE CORPORATION COMMISSION

NOV 13 1980

11-13-80 CONSERVATION DIVISION

INITIAL PRODUCTION

Date of first production Producing method (flowing, pumping, gas lift, etc.)
RATE OF PRODUCTION PER 24 HOURS Oil Gas Water Gas-oil ratio
Disposition of gas (vented, used on lease or sold) Producing interval (s)

INSTRUCTIONS: As provided in KCC Rule 82-2-125, within 90 days after completion of a well, one completed copy of this Drillers Log shall be trans-

15-033-20376-0000

Operator WOOLSEY PETROLEUM CORPORATION		DESIGNATE TYPE OF COMP.: OIL, GAS, DRY HOLE, SWDW, ETC.: Dry Hole
Well No. 2	Lease Name McCay	
S 10 T 35S R 17 W Comanche County, Kansas		

**WELL LOG**

Show all important zones of porosity and contents thereof; cored intervals, and all drill-stem tests, including depth interval tested, cushion used, time tool open, flowing and shut-in pressures, and recoveries.

SHOW GEOLOGICAL MARKERS, LOGS RUN, OR OTHER DESCRIPTIVE INFORMATION.

FORMATION DESCRIPTION, CONTENTS, ETC.	TOP	BOTTOM	NAME	DEPTH
Topeka	(-1717')			3832'
Lecompton	(-1977')			4092'
Kanwaka	(-2048')			4163'
Oread	(-2139')			4254'
Heebner	(-2183')			4298'
Toronto	(-2203')			4318'
Douglas	(-2249')			4364'
Brown Lime	(-2355')			4470'
Lansing	(-2373')			4488'
Lansing 'B'	(-2404')			4519'
Iola	(-2568')			4683'
Dennis	(-2667')			4782'
Base Kansas City	(-2816')			4931'
Marmaton	(-2873')			4988'
Pawnee	(-2921')			5036'
Cherokee	(-2964')			5079'
Mississippian Warsaw	(-3012')			5127'
Porosity	(-3018')			5133'
Osage	(-3055')			5170'
LTD	(-3151')			5266'

For DST's see following page.

RECEIVED  
STATE CORPORATION COMMISSION  
11-13-80  
NOV 13 1980  
CONSERVATION DIVISION  
Wichita, Kansas

USE ADDITIONAL SHEETS, IF NECESSARY, TO COMPLETE WELL RECORD.

Date Received	Signature
	Title
	Date

DRILLSTEM TESTS RESULTSDST #1 4193'-4233' (Kanwaka Sandstone)

Misrun.

Results of DST #2

DST #2 (Warsaw) 5106'-5144'/45-90-60-120

1st Op.: WB increase to SB in 21 minutes.

2nd Op.: WB throughout

Recovery: 120' Mud

93' Slight oil cut gassy mud

216' Salt water

IH	2583#	FFP	145-208#	BHT	119°F
IFP	52-125#	FSIP	1716#		
ISIP	1716#	FH	2480#		

Results of DST #3

DST #3 (Osage) 5149'-5194'/45-90-60-120

1st Op.: WB

2nd Op.: Very WB

Recovery: 75' SGCM

IH	2556#	FFP	82-103#
IFP	62-82#	FSIP	1438#
ISIP	1614#	FHP	2535#

DST #4 3860'-3882' (Topeka)

Misrun

Results of DST #5

Hookwall Packer (Topeka) 3887'/45-90-60-120

1st Op.: WB increased to 13" in 5 minutes.

2nd Op.: 7" in 4 minutes. GB in 9 minutes.

Recovery: 1708' Saltwater.

IH	1970#	FFP	547-886#	BHT	110°F
IFP	93-534#	FSIP	1390#		
ISIP	1416#	FH	1881#		

RECEIVED  
STATE CORPORATION COMMISSION

NOV 13 1980  
11-13-80  
CONSERVATION DIVISION  
Wichita, Kansas