

STATE OF KANSAS
STATE CORPORATION COMMISSION
200 Colorado Derby Building
Wichita, Kansas 67202

WELL PLUGGING RECORD
K.A.R.-82-3-117

API NUMBER 15-033-20,107-0000

LEASE NAME Griffith "B"

WELL NUMBER 1

1980 Ft. from S Section Line

3300 Ft. from E Section Line

SEC. 3 TWP. 31SRGE. 18 ~~XX~~ or (W)

COUNTY Comanche

Date Well Completed 12/6/71

Plugging Commenced 11/15/94

Plugging Completed 11/17/94

TYPE OR PRINT
NOTICE: Fill out completely
and return to Cons. Div.
office within 30 days.

LEASE OPERATOR Anadarko Petroleum Corporation

ADDRESS P.O. Box 351, Liberal, KS 67905-0351

PHONE#(316) 624-6253 OPERATORS LICENSE NO. 4549

Character of Well Oil

(Oil, Gas, D&A, SWD, Input, Water Supply Well)

The plugging proposal was approved on 11/17/94 (date)

by Richard Lacey (KCC District Agent's Name).

Is ACO-1 filed? Yes If not, Is well log attached? _____

Producing Formation None Depth to Top _____ Bottom _____ T.D. 5130'

Show depth and thickness of all water, oil and gas formations.

OIL, GAS OR WATER RECORDS

CASING RECORD

Formation	Content	From	To	Size	Put in	Pulled out
				8 5/8"	541'	3'
				4 1/2"	5128'	3582'

Describe in detail the manner in which the well was plugged, indicating where the mud fluid was placed and the method or methods used in introducing it into the hole. If cement or other plug were used, state the character of same and depth placed, from _____ feet to _____ feet each set. Set CIBP @ 4900'. Spot 2 sxs cmt plg on CIBP. Shot 4 1/2" csg @ 3582', pulled free. Pull csg to 1100'. Spot 50 sxs cmt plg from 1100-1000'. TOH & spot 50 sxs cmt plg from 580-480'. TOH & spot 10 sxs cmt plg from 40-0'. Cut off 8 5/8" csg 3' below gl & cap. Witnessed by KCC Rep - Richard Lacey.

(If additional description is necessary, use BACK of this form.)

Name of Plugging Contractor Sargent & Horton Plugging, Inc. License No. 11151

Address Rt 1, Box 49BA, Tyrone, OK 73951-9731 (405) 854-6515

NAME OF PARTY RESPONSIBLE FOR PLUGGING FEES: Anadarko Petroleum Corporation

STATE OF Kansas COUNTY OF Seward, ss.

Leslie I. Barnes, Sr. Technical Assistant (Employee of Operator) (Operator) of above-described well, being first duly sworn on oath, says: That I have knowledge of the facts, statements, and matters herein contained and the log of the above-described well as filed that the same are true and correct, so help me God.

(Signature) Leslie I. Barnes

Leslie I. Barnes, Sr. Tech. Asst.

(Address) P.O. Box 351, Liberal, KS 67905-0351

SUBSCRIBED AND SWORN TO before me this 7th day of December, 1994

My Commission Expires: _____



Cheryl Steers
Notary Public

AUG 08 1994

8-8-94

CONSERVATION DIVISION
WICHITA, KS

15-033-20107-0000
DRILLER'S LOG

WELL NAME Griffith "B" No. 1 COMPANY OPERATING Anadarko Production Company
ADDRESS OF COMPANY Box 351 Liberal, Kansas 67901

WELL LOCATION C 1/4 NE 1/4 SW 1/4
1980 Ft. North of South Line,
1980 Ft. East of West Line, Sec. 3, Twp. 31S, Rge. 18W, Comanche County, Kansas

DRILLING STARTED 11/4, 19 71, DRILLING COMPLETED 11/20, 19 71
WELL COMPLETED 12/6, 19 71, WELL CONNECTED 12/23, 19 71

ELEVATION 2105.0 Ft. Ground Level CHARACTER of WELL (Oil, Gas, Dry Hole) OIL

OIL OR GAS SANDS OR ZONES - PERFORATIONS - ACIDIZING AND FRACTURING INFORMATION					
Name	From	To	No. of Shots	Gallons Used	Kind Used
Mississippi	5002	5006	8	Acidized 500	15% NE
				Acidized 4000	Mod 202

CASING RECORD

Size	Amount Set	Sacks of Cement	Amount Pulled
8 5/8	541'	400	NONE
4 1/2	5128'	160	NONE
2 3/8	4980'	SN @ 4947	NONE

FORMATION RECORD

Formation	Top	Bottom	Formation	Top	Bottom
Clay, Sand & Red Bed	0	510	Lime & Shale	4465	4985
Shale & Red Bed	510	1317	Lime	4985	4999
Shale	1317	1850	Cherty Lime	4999	5040
Shale & Lime	1850	2355	Lime	5040	5090
Lime & Shale	2355	2455	Lime & Shale	5090	5130
Lime	2455	2800	TOTAL DEPTH	5130.	
Lime & Shale	2800	2935			
Shale & Lime	2935	3095			
Lime & Shale	3095	3235			
Shale & Lime	3235	3810			
Lime & Shale	3810	4178			
Shale & Lime	4178	4285			
Lime	4285	4465			

RESULTS OF INITIAL PRODUCTION TEST: Pumped 66.85 BO - 28% Water.

15-033-20107-0000
KANSAS CORPORATION COMMISSION AUG 08 1994

WELL RECORD

8-8-94
CONSERVATION DIVISION
WICHITA, KS

(Mail to Kansas Geological Survey, 4150 Monroe Street, Wichita, Kansas 67209)

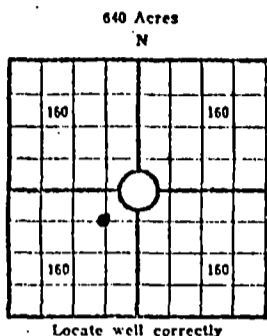

Lease Name: Griffith "B" Well No. 1
 Well Located: 1980'FWL & 1980'FSL
SEC 3 TWP 31S RGE 18W
 Operator: Anadarko Production Company
 Address: Box 351 Liberal, Kansas 67901
 Elevation: Ground 2105.0 D.F. K.B.
 Type Well: (Oil, gas, dry hole) Oil

Drilling Commenced: 11-4 19 71 Drilling Completed: 11-20 19 71
 Well Completed: 12-6 19 71 Total Depth 5130
 Initial Production: Pumped 66.85 BO - 28% Water.

Casing Record

Size: 8 5/8 Set at 541 Size: 2 3/8 Set at 4980
 Size: 4 1/2 Set at 5128 Size: _____ Set at _____

Liner Record

Size: _____ Set from _____ To _____

Cementing

<u>Casing Size</u>	<u>Sacks</u>	<u>Type Cement and Additives</u>
<u>8 5/8</u>	<u>400</u>	<u>Common W/3% HA-5</u>
<u>4 1/2</u>	<u>160</u>	<u>Salt Sat. Poz W/5% CFR-2</u>
<u>2 3/8</u>	<u>SN @ 4947</u>	

Perforations

<u>Formation</u>	<u>Perforated Interval and Number Shots</u>
<u>Mississippi</u>	<u>5002 - 5006 W/2SPT</u>
_____	_____
_____	_____

Electric Log Run (Show type log and depths covered)

Dresser Atlas - Dual Induction Focused Log (536-5120')
BHC Acoustilog (2400 - 5122')

(Fill in formation and related information on reverse side)

RECEIVED
KANSAS CORPORATION COMMISSION

FORMATION, TESTING AND COMPLETION RECORD AUG 0 8 1994

8-8-94
CONSERVATION DIVISION
WICHITA, KS

Show Drill Stem Tests,
Well Stimulation and
Production Tests

Formation	Top	Bottom	
Clay, Sand & Red Bed	0	510	<p>DST #1 4930-4999' (Miss) 10 minute preflow with gas to surface in one minute, 5 minute gauge 5000 MCFD, 10 minute gauge 7000 MCFD. Tool open 50 minutes, 5 minute gauge, 5000 MCFD, 10 minute gauge 7000 MCFD, 15 minute gauge 7500 MCFD & stab. Recovered no fluid. ISIP 1500# (30) FP's 1041-1041#, 1017-1017#, FSIP 1524# (40).</p> <p>DST #2 5000-5024' (Miss) 10 minute preflow with very weak blow. Tool open 40 minutes with good blow throughout, no gas to surface. Recovered 60' HO & GCM. ISIP, 1331# (40) FP 24-24#, FSIP 581# (40).</p> <p>DST #3 5020-5060' (Miss) 20 minute preflow with very weak blow for one minute & died. Tool open 40 minutes with no blow. Bypassed tool after 10 minutes with no blow. Recovered 90' heavy mud -- no shows. ISIP 1486# (40). FP 42-63#, 63-104#, FSIP 1297# (40).</p>
Shale & Red Bed	510	1317	
Shale	1317	1850	
Shale & Lime	1850	2355	
Lime & Shale	2355	2455	
Lime	2455	2800	
Lime & Shale	2800	2935	
Shale & Lime	2935	3095	
Lime & Shale	3095	3235	
Shale & Lime	3235	3810	
Lime & Shale	3810	4178	
Shale & Lime	4178	4285	
Lime	4285	4465	
Lime & Shale	4465	4985	
Lime	4985	4999	
Cherty Lime	4999	5040	
Lime	5040	5090	
Lime & Shale	5090	5130	
TOTAL DEPTH	5130		